

CONTRACT NO. 98950

F.A. RTE.	SECTION	COUNTY	TOTAL SHEETS	SHEET NO.
*	*	WILLIAMSON	917	585

STA. TO STA.
 FED. ROAD DIST. NO. ILLINOIS FED. AID PROJECT
 * I-57, & OLD IL 13 (FAU 9629)
 ** (X1-6-2)VB-2,(X1-6)HBK-2



NOTE:
 MILL THIS REGION TO CREATE SWALE FOR DRAINAGE, SEE MILLING DETAIL RAMP E

FOR DRAINAGE SYSTEM
 SEE DETAIL SHEET

NOTE:
 MILL THIS REGION TO CREATE SWALE FOR DRAINAGE, SEE MILLING DETAIL RAMP F

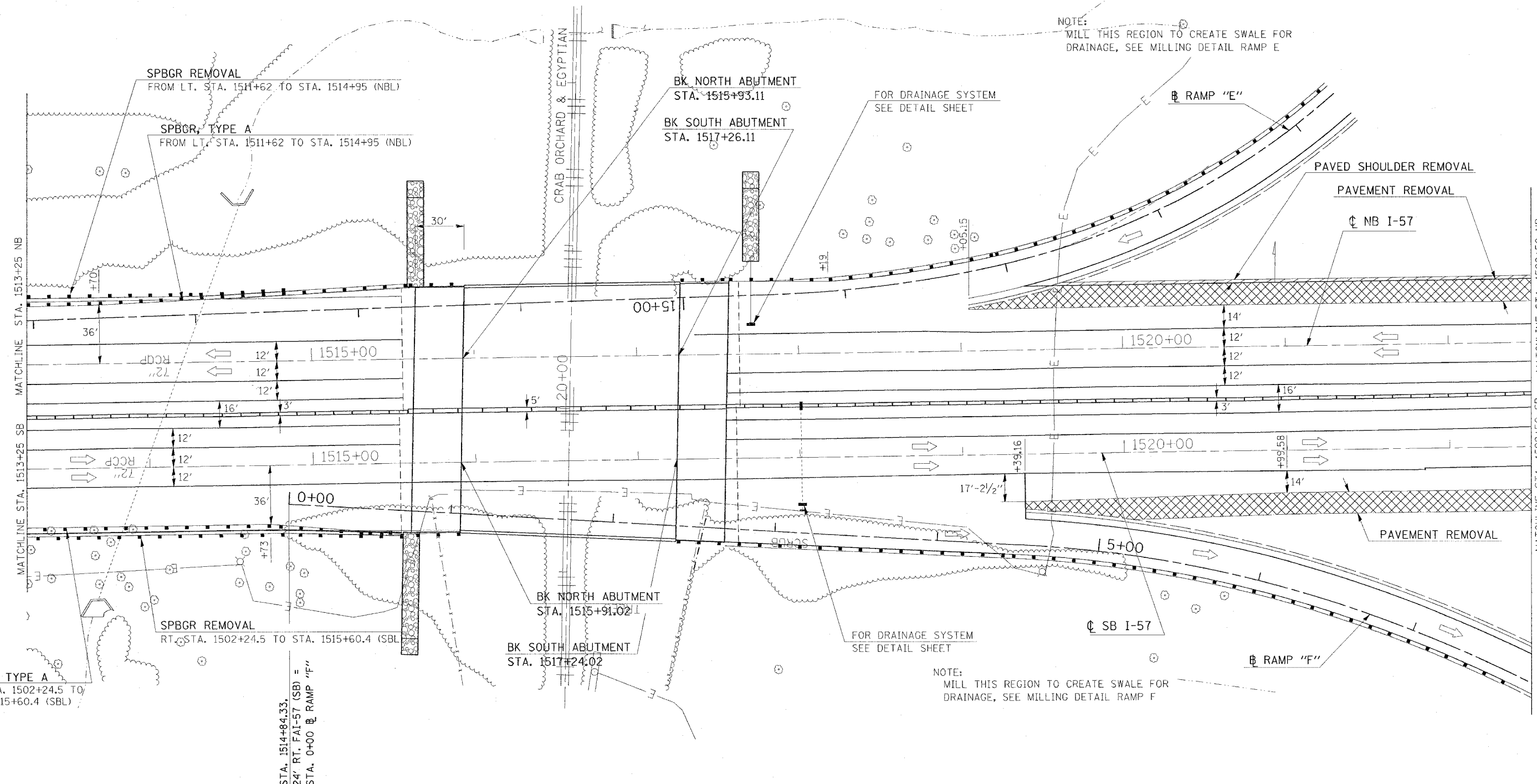

SPBGR, TYPE A
 RT. STA. 1502+24.5 TO
 STA. 1515+60.4 (SBL)

STA. 1514+84.33.
 24' RT. FAI-57 (SB) =
 STA. 0+00 @ RAMP "F"

REVISIONS	
NAME	DATE

ILLINOIS DEPARTMENT OF TRANSPORTATION
FAI-57
STAGE 8
STA. 1513+25 TO STA. 1522+50
SHEET 11 OF 15

SCALE: VERT. APPROX. 30
 HORIZ. DRAWN BY CNH
 DATE CHECKED BY

PLOT DATE = 11/17/2006
 FILE NAME = c:\projects\fa157\stage08\plot11.dwg
 PLOT SCALE = 30.0000 / IN.
 USER NAME = hudson