

F.A. RT. SECTION	COUNTY	TOTAL SHEETS	SHEET NO.
** ** WILLIAMSON	917	608	
STA. TO STA.	ILLINOIS FED. AID PROJECT		
FED. ROAD DIST. NO.	* I-57, & OLD IL 13 (FAU 9629)		
	** (X1-6-2)VB-2,(X1-6)HBK-2		

DATE: \_\_\_\_\_  
 BY: \_\_\_\_\_  
 CHECKED: \_\_\_\_\_  
 DATE: \_\_\_\_\_  
 NO. \_\_\_\_\_

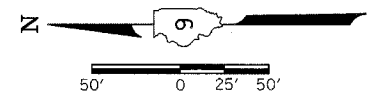

**NORTHBOUND**

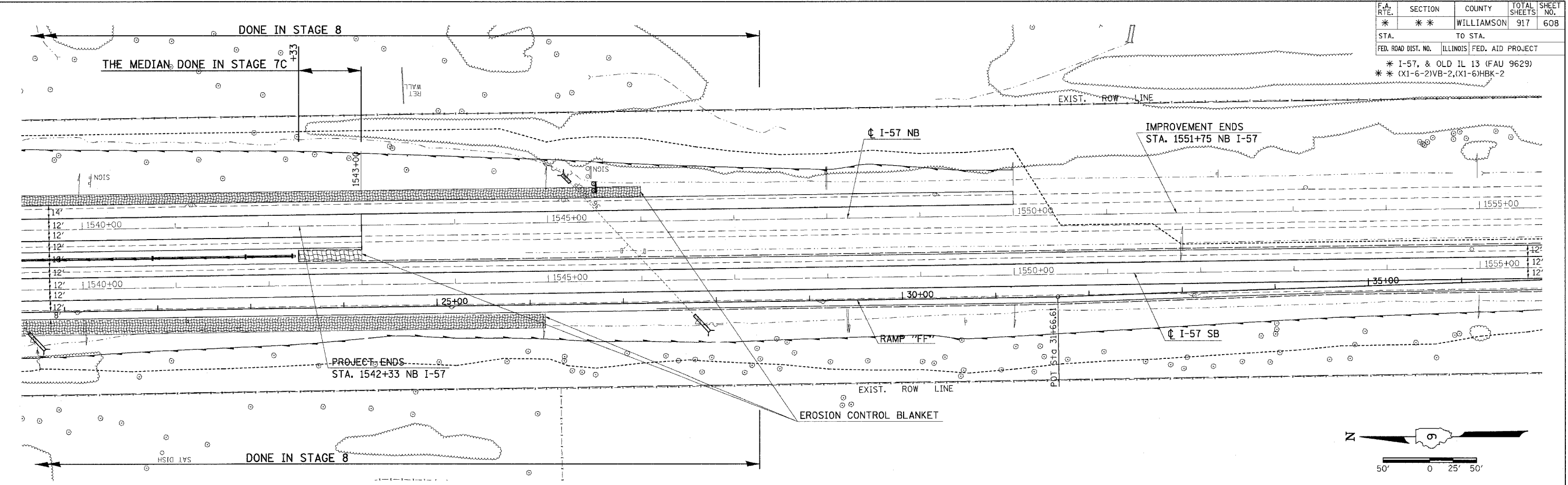

**SOUTHBOUND**

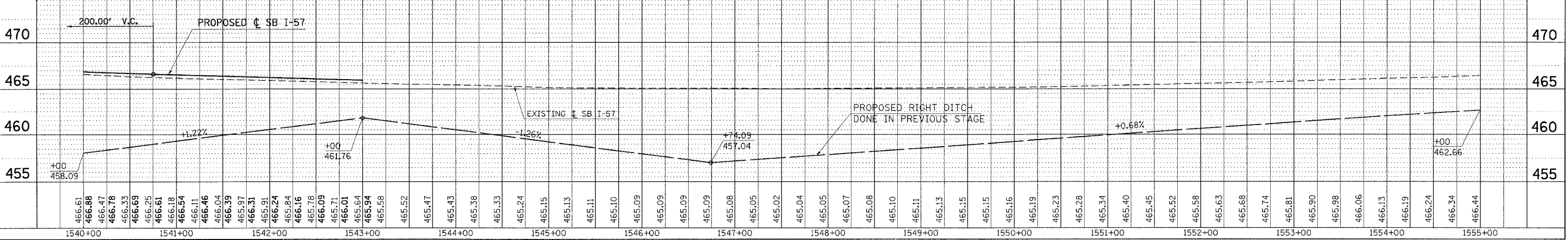

DATE: 12/7/2006  
 FILE NAME: c:\p\projects\98950\1540\1540.dgn  
 PLOT SCALE: 1/8" = 10'-0"  
 PLOT: P1540.dwg  
 PLOT: P1540.dwg

**TEMPORARY EROSION CONTROL FAI-57 FOR STAGES 7, 7A, 7B, 7C, 8 - STA. 1540+00 TO STA. 1555+00**