

F.A. RTE.	SECTION	COUNTY	TOTAL SHEETS	SHEET NO.
*	**	WILLIAMSON	917	648
STA. TO STA.		ILLINOIS FED. AID PROJECT		
* I-57, & OLD IL 13 (FAU 9629)		** (X1-6-2)VB-2,(X1-6)HBK-2		

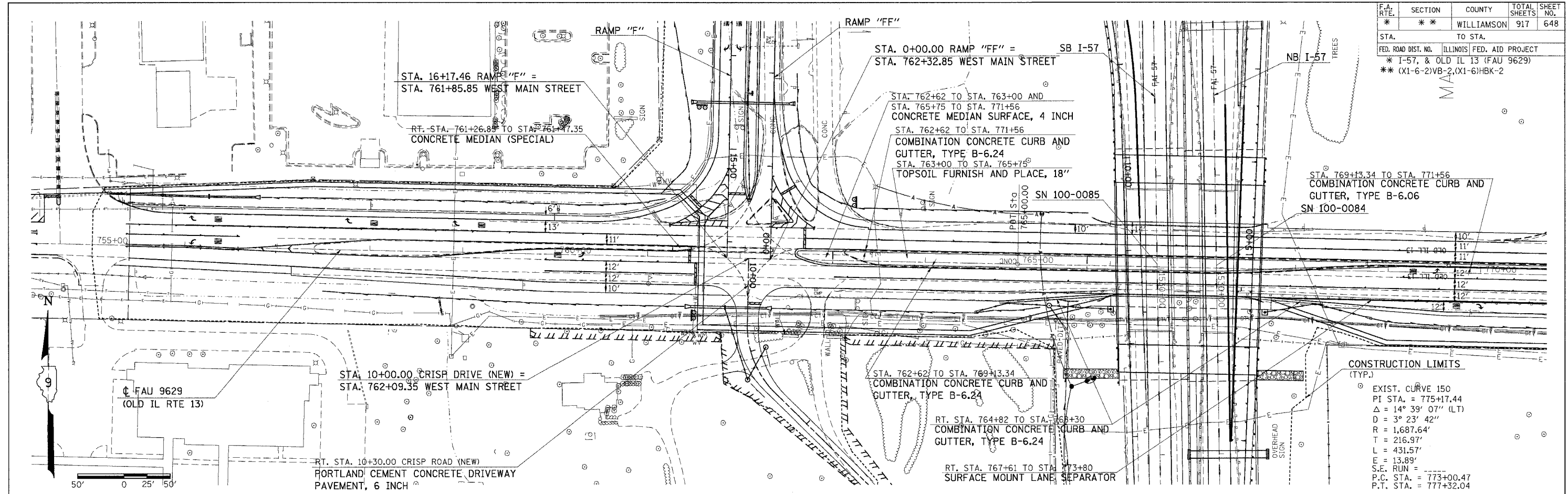

CONSTRUCTION LIMITS (TYP.)

- EXIST. CURVE 150
- PI STA. = 775+17.44
- $\Delta = 14^\circ 39' 07''$ (LT)
- $D = 3^\circ 23' 42''$
- $R = 1,687.64'$
- $T = 216.97'$
- $L = 431.57'$
- $E = 13.89'$
- S.E. RUN = -----
- P.C. STA. = 773+00.47
- P.T. STA. = 777+32.04

PLAN

SURVEYED	DATE
ALIGNED	BY
CHECKED	
NO.	

PROFILE

SURVEYED	DATE
GRADES CHECKED	BY
STRUCTURE NOTATIONS CHECKED	
NO.	

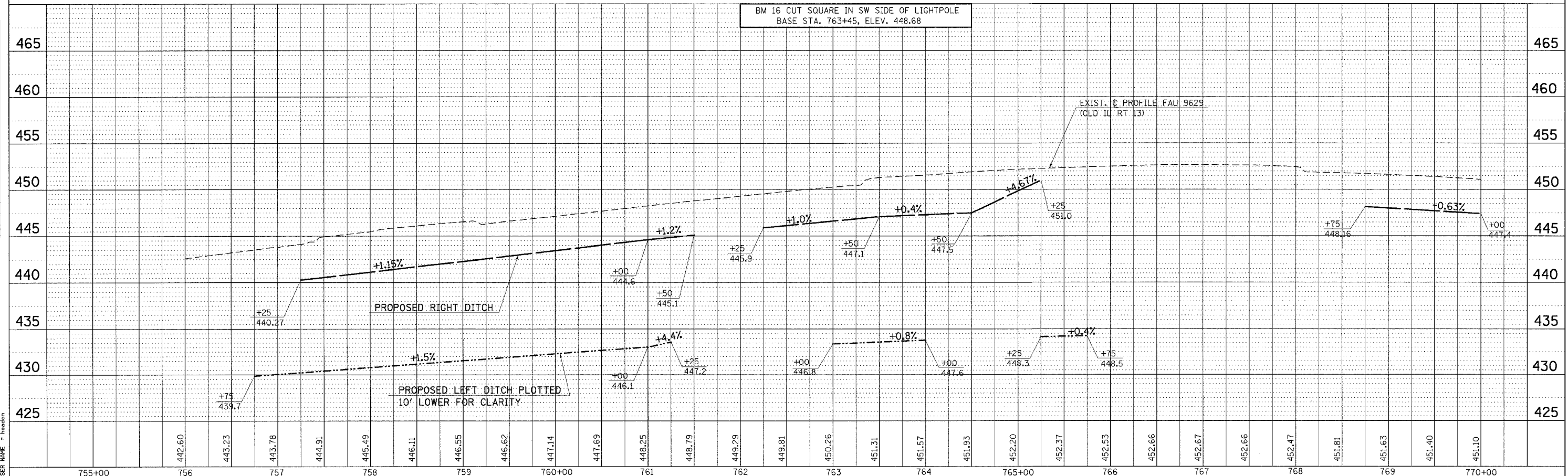

PLOT DATE = 12/16/2006
 FILE NAME = c:\p\proj\98950\plan\98950.dwg
 USER NAME = hanson