

CONTRACT NO. 98950				
F.A. RTE.	SECTION	COUNTY	TOTAL SHEETS	SHEET NO.
*	*	WILLIAMSON	917	722
STA. TO STA.				
FED. ROAD DIST. NO. ILLINOIS FED. AID PROJECT				
* I-57, & OLD IL 13 (FAU 9629)				
** (X1-6-2)VB-2,(X1-6)HBK-2				

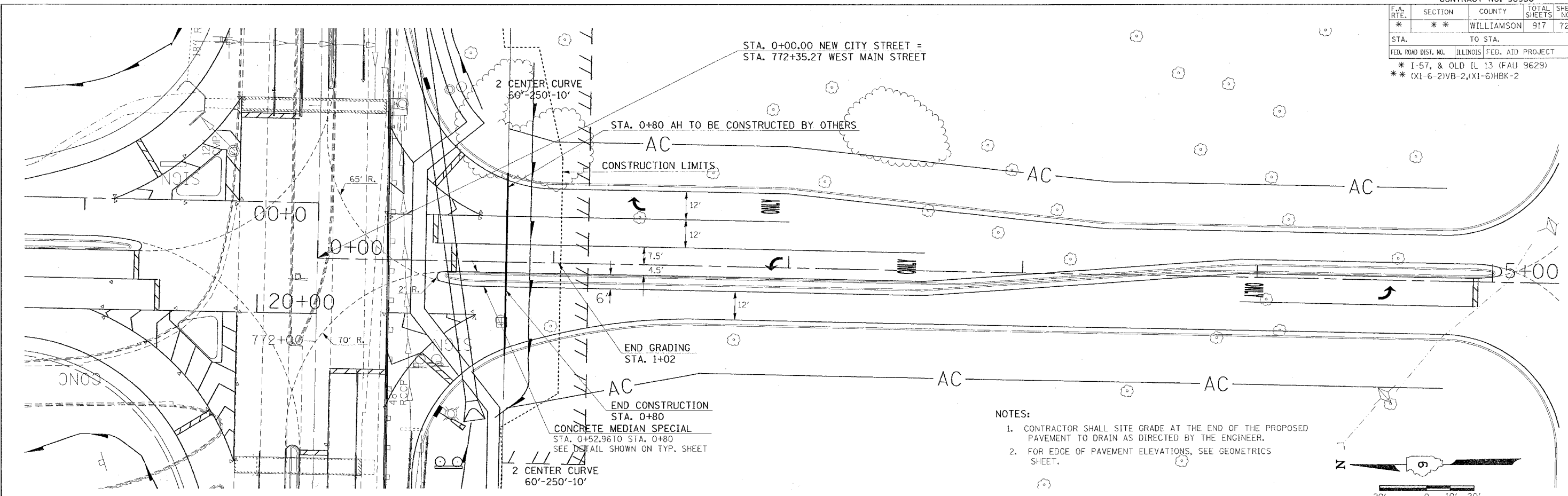

- NOTES:
1. CONTRACTOR SHALL SITE GRADE AT THE END OF THE PROPOSED PAVEMENT TO DRAIN AS DIRECTED BY THE ENGINEER.
 2. FOR EDGE OF PAVEMENT ELEVATIONS, SEE GEOMETRICS SHEET.

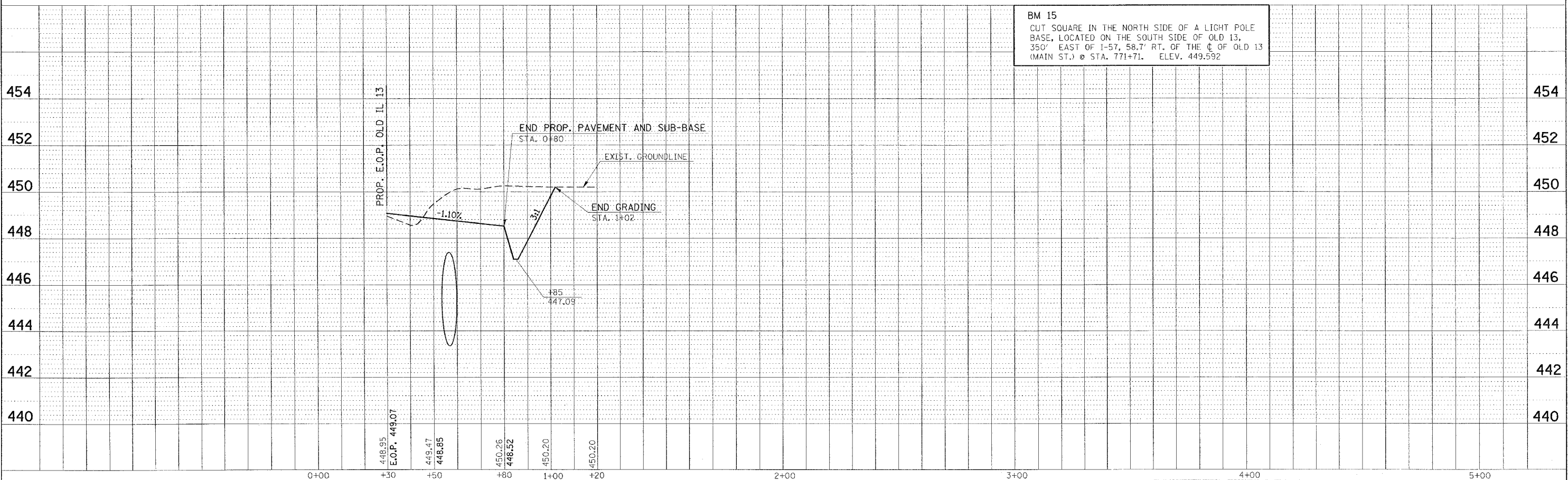
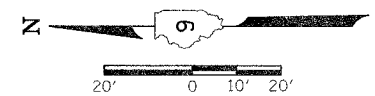

PLAN SURVEYED BY: DATE:
 NOTE BOOK NO.
 ALIGNMENT CHECKED BY:
 STATIONING CHECKED BY:
 ROAD FILE NAME:
 NO.

PROFILE SURVEYED BY: DATE:
 NOTE BOOK NO.
 GRADES CHECKED BY:
 B.M. NOTES:
 PROPOSED VERTICAL CURVE:
 NO.

PLOT DATE = 11/17/2006
 FILE NAME = c:\pfs\mets\080202\old13\old13p2.dgn
 PLOT SCALE = 20/0000 / IN.
 USER NAME = feason

PLAN - PROFILE STA. 0+00.00 TO STA. 5+25.00 NEW CITY STREET