

F.A. RTE.	SECTION	COUNTY	TOTAL SHEETS	SHEET NO.
*	**	WILLIAMSON	917	733

STA. TO STA.  
 FED. ROAD DIST. NO. ILLINOIS FED. AID PROJECT  
 \* I-57, & OLD IL 13 (FAU 9629)  
 \*\* (X1-6-2)VB-2, (X1-6)HBK-2

STATIONING ALONG WEST MAIN ST (IL 13)	OFFSET TO E.P. FEET	EDGE OF PAV'T. ELEV. FEET	STATIONING ALONG RAMP "F" FEET	OFFSET TO E.P. FEET	DISTANCE ALONG RADIUS FEET
LT. 760+37.06	36.00	447.42			10
LT. 760+47.06	36.23	447.52			10
LT. 760+57.03	36.91	447.62			10
LT. 760+66.97	38.04	447.71			10
LT. 760+76.84	39.63	447.78			10
LT. 760+86.63	41.66	447.85			10
LT. 760+96.32	44.13	447.91			10
LT. 761+05.88	47.04	447.96			10
LT. 761+15.31	50.39	448.00			10
		448.04	RT. 15+67.07	70.55	10
		448.04	RT. 15+63.24	61.31	10
		448.04	RT. 15+58.46	52.54	10
		448.09	RT. 15+52.69	44.37	10
		448.19	RT. 15+46.01	36.94	10
		448.32	RT. 15+38.52	30.32	10
		448.47	RT. 15+30.31	24.62	10
		448.63	RT. 15+21.49	19.91	10
		448.80	RT. 15+12.19	16.26	10
		448.99	RT. 15+02.53	13.71	10
		449.18	RT. 14+92.63	12.30	10
					7.18

STATIONING ALONG WEST MAIN ST (IL 13)	OFFSET TO E.P. FEET	EDGE OF PAV'T. ELEV. FEET	STATIONING ALONG RAMP "FF" FEET	OFFSET TO E.P. FEET	DISTANCE ALONG RADIUS FEET
LT. 763+37.85	36.00	450.49			10
LT. 763+27.87	36.53	450.39			10
LT. 763+18.00	38.10	450.28			10
LT. 763+08.35	40.70	450.15			10
LT. 762+99.02	44.30	450.00			10
LT. 762+90.13	48.86	449.83			10
LT. 762+81.76	54.33	449.65			10
LT. 762+74.02	60.64	449.46			10
LT. 762+66.98	67.74	449.26			10
LT. 762+60.72	75.54	449.07	RT. 0+75.54	27.87	10
		448.99	RT. 0+83.95	22.47	10
		449.02	RT. 0+92.88	17.98	10
		449.14	RT. 1+02.23	14.46	10
		449.29	RT. 1+11.80	11.55	10
		449.43	RT. 1+21.46	8.96	10
		449.59	RT. 1+31.20	6.70	10
		449.75	RT. 1+41.01	4.76	10
		449.94	RT. 1+50.88	3.15	10
		450.12	RT. 1+60.80	1.87	10
		450.32	RT. 1+70.75	0.92	10
		450.52	RT. 1+80.73	0.30	10
		450.74	RT. 1+90.73	0.02	3.52

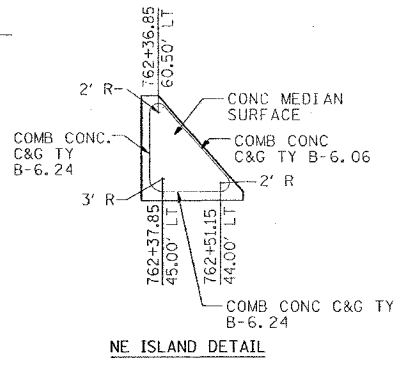
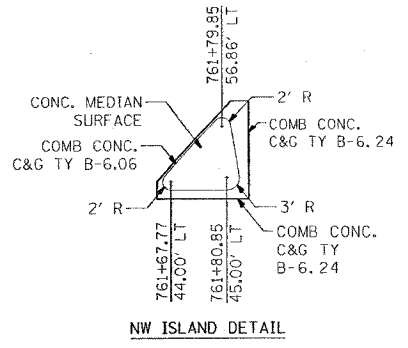
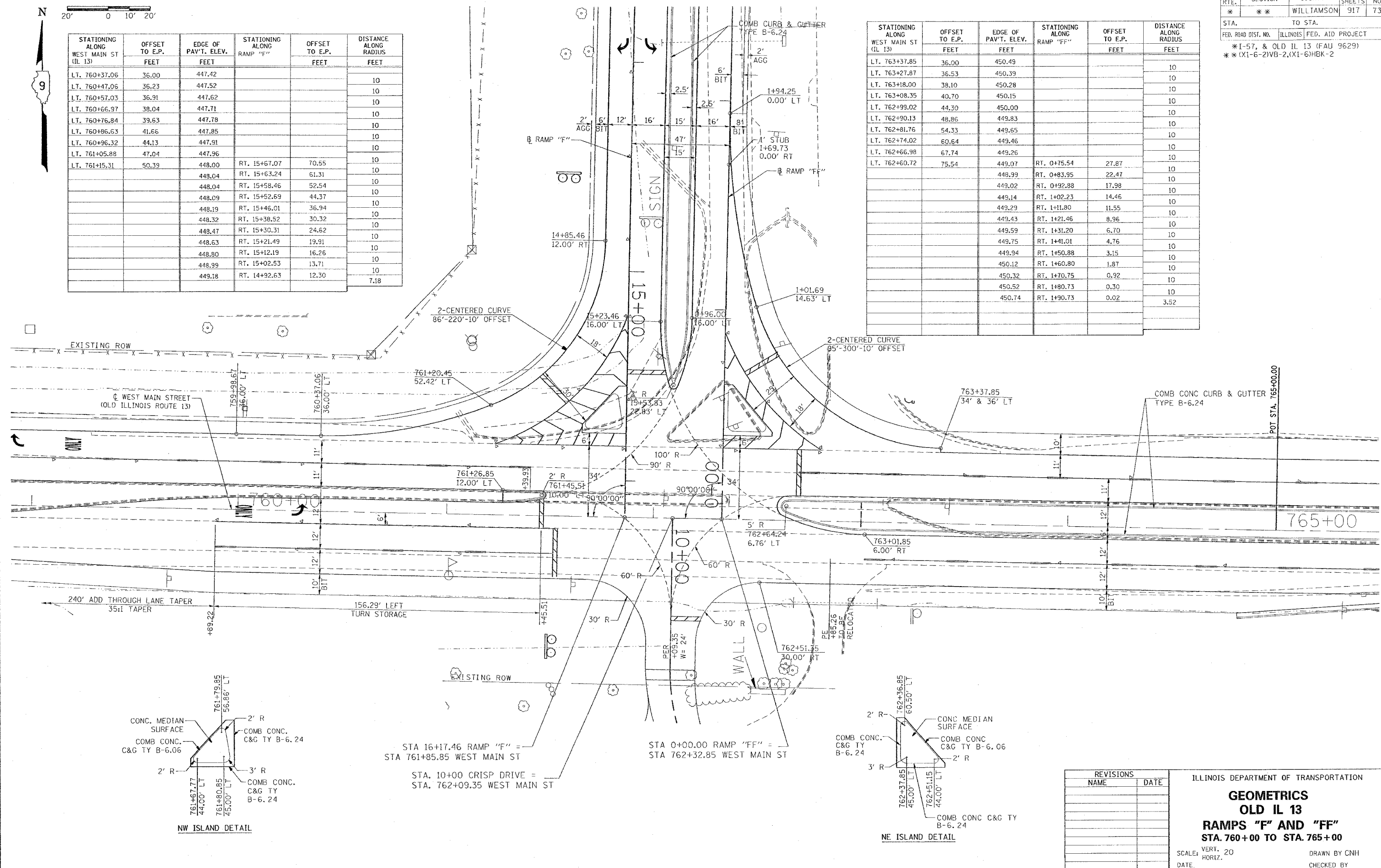

STA 16+17.46 RAMP "F" =  
 STA 761+85.85 WEST MAIN ST

STA 0+00.00 RAMP "FF" =  
 STA 762+32.85 WEST MAIN ST

STA. 10+00 CRISP DRIVE =  
 STA. 762+09.35 WEST MAIN ST

REVISIONS	
NAME	DATE

ILLINOIS DEPARTMENT OF TRANSPORTATION

**GEOMETRICS**  
**OLD IL 13**  
**RAMPS "F" AND "FF"**  
**STA. 760+00 TO STA. 765+00**

SCALE: VERT. 20  
 HORIZ. 1" = 100'

DATE: \_\_\_\_\_ DRAWN BY CNH  
 CHECKED BY \_\_\_\_\_

PLOT DATE = 10/17/2006  
 FILE NAME = c:\projects\982282\old13\old13p6.dgn  
 PLOT SCALE = 20.0000  
 USER NAME = heden