

STATE OF ILLINOIS  
DEPARTMENT OF TRANSPORTATION

ROUTE NO.	SECTION	COUNTY	TOTAL SHEETS	SHEET NO.	SHEET NO. 22 51 SHEETS
F.A.I. 57	XI-6-2) VB-2	WILLIAMSON	917	855	
FED. ROAD DIST. NO. 7	ILLINOIS	FED. AID PROJECT-	Contract #98950		

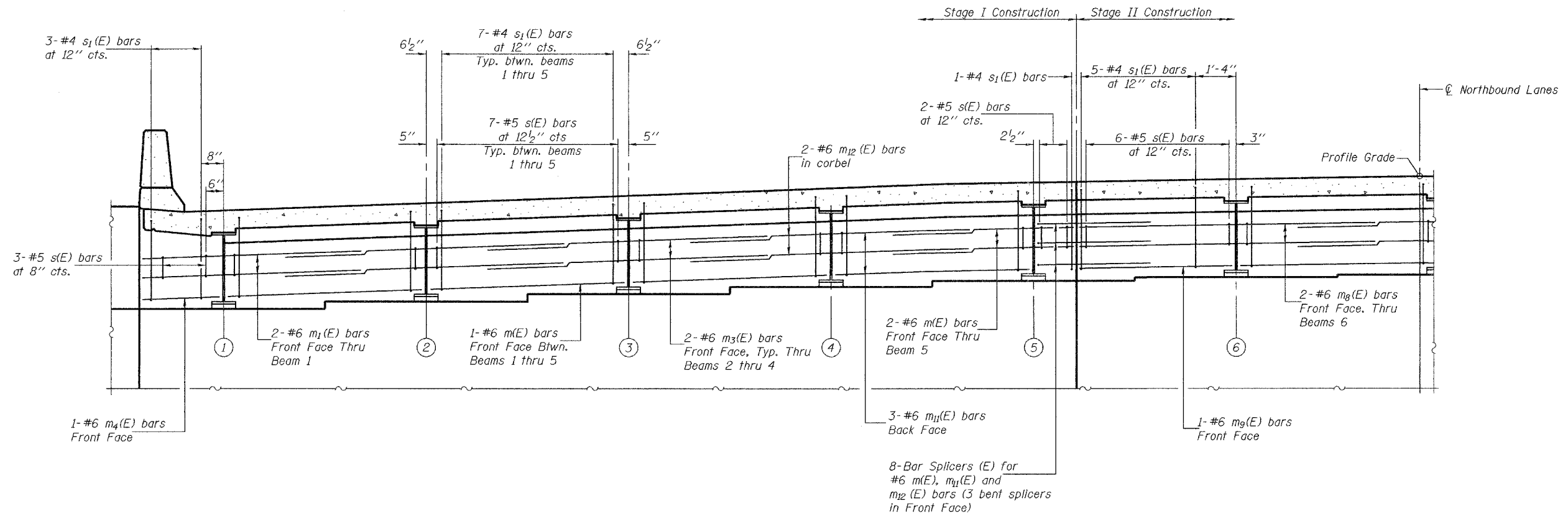

**MIN. BAR LAP**

#6 bar = 2'-9"

**Notes:**

- Reinforcement bars in diaphragm are billed with superstructure on sheet 19 of 51.
- Concrete in diaphragm is included with Concrete Superstructure on sheet 19 of 51.
- For details of bars s(E) & s1(E) see sheet 19 of 51.
- The s(E) and s1(E) bars shall be placed parallel to the beams. Spacing for these bars shall be at right angles to the beams.
- For Bar Splicer Details see sheet 48 of 51.
- For Section A-A see sheet 24 of 51.
- Bars indicated thus 2x2-#6 etc. indicates 2 lines of bars with 2 lengths per line.

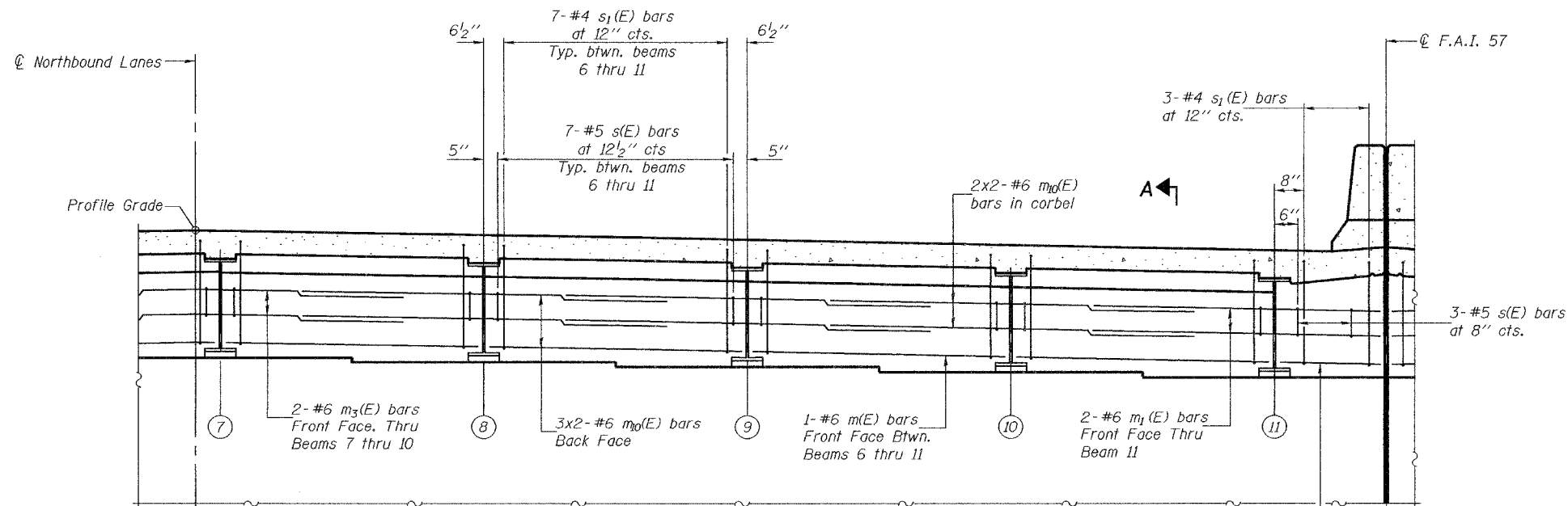

**ELEVATION**

Looking South, at South Abutment, SN 100-0086 (N.B.)

DESIGNED	Michael D. Cima
CHECKED	Fess Teklehaimanot
DRAWN	BECKY M. LEACH
CHECKED	M.D.C. & F.T.

EXAMINED	Thomas J. Domagalaki ENGINEER OF BRIDGE DESIGN
PASSED	Ralph E. Anderson ENGINEER OF BRIDGES AND STRUCTURES

January 22, 2007

**DIAPHRAGM DETAILS**  
F.A.I. RT. 57 SEC. (XI-6-2)VB-2  
WILLIAMSON COUNTY  
STA. 1516+58.56  
S.N. 100-0086 (N.B.)  
S.N. 100-0087 (S.B.)