

F.A.B. RTE.	SECTION	COUNTY	TOTAL SHEETS	SHEET NO.
	02	000	24	3
STA.		TO STA.		
FED. ROAD DIST. NO.		ILLINOIS FED. AID PROJECT		

INDEX OF SHEETS

SHEET NO.	DESCRIPTION
1	COVER SHEET
2	SIGNATURE SHEET
3	INDEX OF SHEETS AND HIGHWAY STANDARDS, CORE SCHEDULE
4	GENERAL NOTES, MIXTURE REQUIREMENTS
5	SUMMARY OF QUANTITIES
6 - 8	TYPICAL SECTIONS
9	SCHEDULES FOR MAINLINE RESURFACING
10 - 11	SCHEDULE FOR PAVEMENT MARKING
12	LOCATION MAP FOR FAP 331 (IL 149) IN MURPHYSBORO
13 - 20	PAVEMENT MARKING DETAIL FOR FAP 331 (IL 149)
21	LOCATION MAP FOR FAP 776 (IL 142) IN MCLEANSBORO
22	PAVEMENT MARKING DETAIL FOR FAP 776 (IL 142)
23	STANDARD DETAILS - ROUGH GROOVED SURFACE SIGN; UNEVEN LANE SIGN; TEMP. BITUMINOUS CONCRETE TRANSITION
24	DELETED

HIGHWAY STANDARDS

442201-02	702001-06
701301-02	780001-01
701311-02	781001-02
701501-03	

CORE SCHEDULE

LOCATION	DESCRIPTION
FAP 331 (IL 149)	
SOUTHEAST QUAD (JACKSON ST. & MAIN ST.)	3.5" BIT. ON BRICK BASE
NORTHEAST QUAD (JACKSON ST. & MARKET ST.)	2.25" BIT. ON BRICK BASE
FAP 776 (IL 142)	
WALNUT ST. & 13TH ST.	2.38" BIT. ON BRICK BASE
WALNUT ST. & 15TH ST.	4" BIT. ON BRICK BASE
WALNUT ST. & 20TH ST.	4" BIT. ON BRICK BASE

•FAP 331 & FAP 776  
 ••101RS-5; (114Z)RS-3  
 •••JACKSON & HAMILTON

PLOT DATE = 2/7/2007  
 FILE NAME = c:\pva\jva\88987\88987pl.dwg  
 USER NAME = jva  
 USER = jva

△ Rev. Sheet 2-20-07

F.A.P. RTE.	SECTION	COUNTY	TOTAL SHEETS	SHEET NO.
0	00	000	24	4
STA.		TO STA.		
FED. ROAD DIST. NO.		ILLINOIS FED. AID PROJECT		

\*FAP 331 & FAP 776  
 \*\*101RS-5; (1142)RS-3  
 \*\*\*JACKSON & HAMILTON

**GENERAL NOTES**

THE THICKNESS OF BITUMINOUS MIXTURE SHOWN ON THE PLANS IS THE NOMINAL THICKNESS. DEVIATIONS FROM THE NOMINAL THICKNESS WILL BE PERMITTED WHEN SUCH DEVIATIONS OCCUR DUE TO IRREGULARITIES IN THE EXISTING SURFACE OR BASE ON WHICH THE HOT-MIX ASPHALT IS PLACED.

FACTORS USED FOR ESTIMATING PLAN QUANTITIES ARE AS FOLLOWS AND SHALL NOT BE USED FOR THE BASIS OF FINAL QUANTITIES EXCEPT FOR QC/QA OF HOT-MIX ASPHALT MIXTURES:

ALL HOT-MIX ASPHALT CONCRETE.....2.016 TONS/CU.YD.  
 ALL AGGREGATE.....2.05 TONS/CU.YD.  
 BITUMINOUS MATERIALS (PRIME COAT)  
     ON PAVEMENT.....0.09 GALS./SQ. YD.  
     ON AGG. SURFACE.....0.32 GALS./SQ. YD.  
 AGGREGATE (PRIME COAT).....0.0015 TONS/SQ. YD.

THE QUANTITY OF SHORT TERM PAVEMENT MARKING SHOWN IN THE PLANS WAS BASED ON ONE APPLICATION EACH FOR THE PRIME COAT AND SURFACE COURSE.

PRIOR TO PLACEMENT OF THE FINAL PAVEMENT MARKINGS, THE RESIDENT ENGINEER SHOULD CONTACT THE BUREAU OF OPERATIONS AND ARRANGE FOR INSPECTION AND APPROVAL OF THE PAVEMENT MARKING LAYOUT.

THE CONTRACTOR SHALL STAMP STATIONING IN THE PROPOSED HOT-MIX ASPHALT SURFACE AT 300 FT. INTERVALS ON ALTERNATING SIDES OF THE PAVEMENT AND AS DIRECTED BY THE ENGINEER. THE STATION SYMBOL STAMPS USED SHALL BE FURNISHED BY THE CONTRACTOR. THEY SHALL BE 5 1/2 " TALL OF A DESIGN APPROVED BY THE ENGINEER AND SHALL REMAIN THE PROPERTY OF THE CONTRACTOR.

UNLESS OTHERWISE DIRECTED BY THE ENGINEER, HOT-MIX ASPHALT RESURFACING SHALL BE PLACED IN A SEQUENCE THAT WILL MINIMIZE THE TIME THE CENTER-LINE EDGE IS EXPOSED TO TRAFFIC.

QUANTITIES SHOWN IN THE PLANS FOR PATCHING ARE ESTIMATES. THE ACTUAL AMOUNT OF PATCHING REQUIRED SHALL BE DETERMINED BY THE ENGINEER IN THE FIELD.

THE CONTRACTOR SHALL COMPLETE ALL PATCHING PRIOR TO THE HOT-MIX ASPHALT SURFACE REMOVAL.

FOR SAWED JOINTS SEE SPECIAL PROVISIONS UNDER HOT-MIX ASPHALT SURFACE REMOVAL, 1 1/2".

THERE ARE EXISTING MANHOLES AND VALVE VAULTS THROUGHOUT THESE TWO LOCATIONS. AFTER THE EXISTING SURFACE IS MILLED 1 1/2", IT WILL BE THE CONTRACTOR'S RESPONSIBILITY AND AT HIS EXPENSE TO PROTECT THESE STRUCTURES DURING THE TIME BETWEEN MILLING AND WHEN RESURFACING IS COMPLETED.

THE USE OF A VIBRATORY ROLLER SHALL BE PROHIBITED FOR THIS PROJECT. THE CONTRACTOR MAY HAVE TO MAKE ADJUSTMENTS TO HIS ROLLING PATTERN TO OBTAIN THE REQUIRED FIELD OF DENSITY.

THE COST OF ANY TEMPORARY RAMPS NEEDED ALONG SIDE STREETS AT THE MURPHYSBORO LOCATION SHALL BE INCLUDED IN THE COST OF THE PAY ITEM HOT-MIX ASPHALT SURFACE REMOVAL, 1 1/2".

**MIXTURE REQUIREMENTS:**

Location(s):	Hot-Mix Asphalt Surface Course (IL 149)
Mixture Use(s):	Polymerized Hot-Mix Asphalt Surface Course, Mixture D, N105
AC/PG:	SBS PG76-22
RAP % (Max.):	0
Design Air Voids:	4.0%, 105 Gyration Superpave Design
Mixture Composition: (Gradation Mixture)	IL-9.5mm or IL 12.5mm
Friction Aggregate:	D Surface

Location(s):	Hot-Mix Asphalt Surface Course (IL 142)
Mixture Use(s):	Hot-Mix Asphalt Surface Course, Mixture C, N90
AC/PG:	PG64-22
RAP % (Max.):	10
Design Air Voids:	4.0%, 90 Gyration Superpave Design
Mixture Composition: (Gradation Mixture)	IL-9.5mm or IL 12.5mm
Friction Aggregate:	C Surface



Rev. 2-20-07

F.A.P. RTE.	SECTION	COUNTY	TOTAL SHEETS	SHEET NO.
..*	..*	..*	24	5
STA. _____		TO STA. _____		
FED. ROAD DIST. NO. _____		ILLINOIS FED. AID PROJECT _____		

- FAP 331 & FAP 776
- 10IRS-5; (1142)RS-3
- JACKSON & HAMILTON

## SUMMARY OF QUANTITIES

PAY CODE	ITEM DESCRIPTION	UNIT	TOTAL QUANTITY	FAP 331 (IL 149)		FAP 776 (IL 142)	
				URBAN	100% STATE	URBAN	100% STATE
40600100	BITUMINOUS MATERIALS (PRIME COAT)	GALLON	617	0		617	
40600115	POLYMERIZED BITUMINOUS MATERIALS (PRIME COAT)	GALLON	1459	1459	▲	0	
40600300	AGGREGATE (PRIME COAT)	TON	35	25		10	
40600990	TEMPORARY RAMP	SO YD	247	38		209	
40603320	HOT-MIX ASPHALT SURFACE COURSE, MIXTURE C, N90	TON	576	0		576	
40603550	POLYMERIZED HOT-MIX ASPHALT SURFACE COURSE, MIXTURE D, N105	TON	1362	1362	▲	0	
44000155	HOT-MIX ASPHALT SURFACE REMOVAL, 1 1/2"	SO YD	23,063	16,208		6855	
44201385	CLASS C PATCHES, TYPE I, 13 INCH	SO YD	13	13		0	
44201389	CLASS C PATCHES, TYPE II, 13 INCH	SO YD	150	136		14	
44201394	CLASS C PATCHES, TYPE III, 13 INCH	SO YD	129	108		21	
44201396	CLASS C PATCHES, TY IV, 13 INCH	SO YD	634	234		400	
67000400	ENGINEER'S FIELD OFFICE, TYPE A	CAL MO	2	1		1	
67100100	MOBILIZATION	L SUM	1	0.5		0.5	
70102620	TRAFFIC CONTROL AND PROTECTION, STANDARD 701501	L SUM	1	0.5		0.5	
70300100	SHORT- TERM PAVEMENT MARKING	FOOT	828	660		168	
70300210	TEMPORARY PAVEMENT MARKING, LETTERS AND SYMBOLS	SO FT	541.6	400		141.6	
70300220	TEMPORARY PAVEMENT MARKING, LINE 4"	FOOT	5700	4805	▲	895	
70300240	TEMPORARY PAVEMENT MARKING, LINE 6"	FOOT	2213	1833		380	
70300260	TEMPORARY PAVEMENT MARKING, LINE 12"	FOOT	170	150		20	
70300280	TEMPORARY PAVEMENT MARKING, LINE 24"	FOOT	287	140		147	
70301000	WORK ZONE PAVEMENT MARKING REMOVAL	SO FT	3901	3551	▲	350	
78000100	THERMOPLASTIC PAVEMENT MARKING - LETTERS AND SYMBOLS	SO FT	541.6	400		141.6	
78000200	THERMOPLASTIC PAVEMENT MARKING - LINE 4"	FOOT	5700	4805	▲	895	
78000400	THERMOPLASTIC PAVEMENT MARKING - LINE 6"	FOOT	2213	1833		380	
78000600	THERMOPLASTIC PAVEMENT MARKING - LINE 12"	FOOT	170	150		20	
78000650	THERMOPLASTIC PAVEMENT MARKING - LINE 24"	FOOT	287	140		147	
78300200	RAISED REFLECTIVE PAVEMENT MARKER REMOVAL	EACH	155	108		47	

\*SPECIALTY ITEMS

▲ Rev. 2-20-07

PLOT DATE = 12/12/2006  
 FILE NAME = c:\prowork\98987\p08107.plm32  
 PLOT SCALE = 1/8"=1'-0"  
 USER NAME = mcdonald

F.A.P. RTE.	SECTION	COUNTY	TOTAL SHEETS	SHEET NO.
*	**	***	24	5
STA. _____ TO STA. _____		FED. ROAD DIST. NO. _____ ILLINOIS FED. AID PROJECT		

# FAP 331 (IL. 149) TYPICAL SECTIONS

FAP 331/IL. 149  
(11th St. to 17th St.)

38' F-F

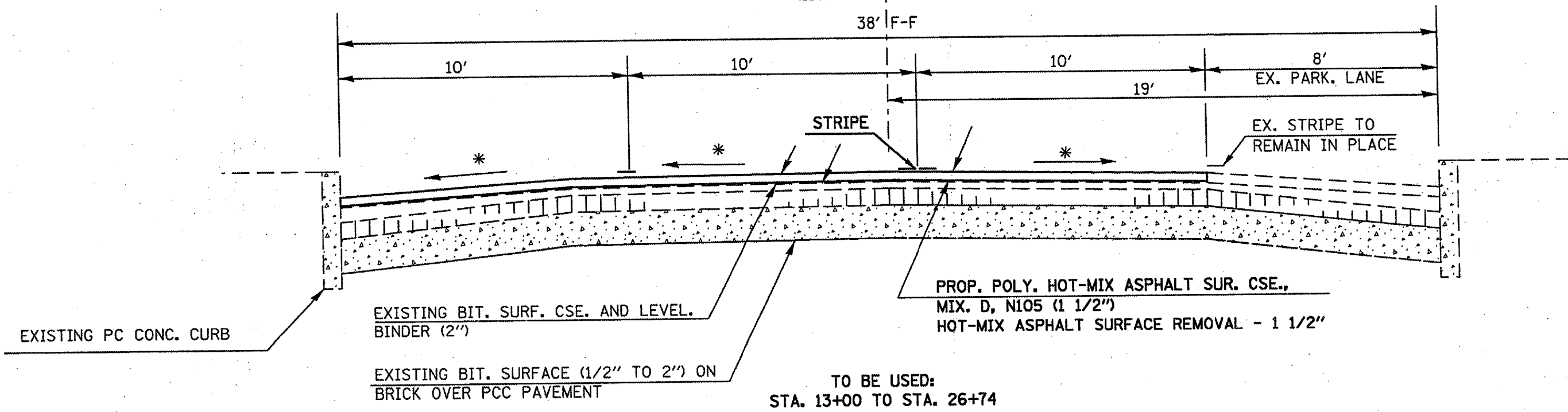

FAP 331/IL. 149  
(17th St. to 22nd ST.)

40' F-F

38" E-E

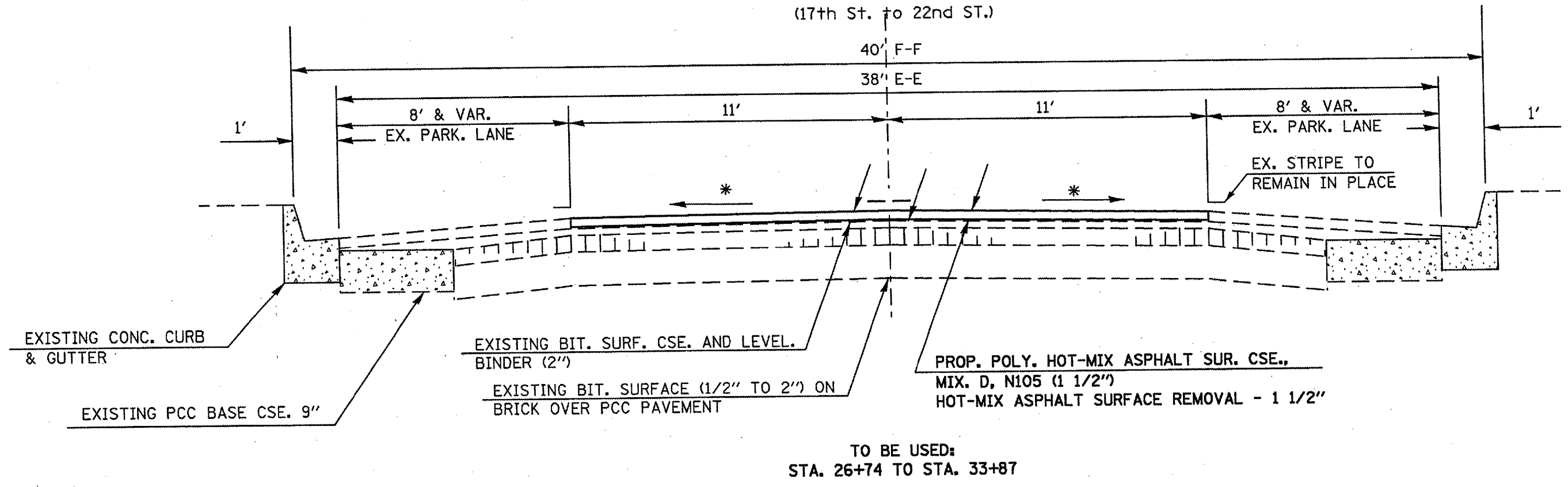

PLOT DATE: 9/7/2007  
 FILE NAME: \\snp\share\project\99997\99997.dwg  
 PLOT SCALE: 1/8" = 1'-0"  
 USER NAME: mcorbett

Rev. Sheet 2-20-07

F.A.D. RTE.	SECTION	COUNTY	TOTAL SHEETS	SHEET NO.
2	02	033	24	9
STA.		TO STA.		
FED. ROAD DIST. NO. ILLINOIS FED. AID PROJECT				

\*FAP 331 & FAP 776  
 \*\*101RS-5; (114Z)RS-3  
 \*\*\*JACKSON & HAMILTON

## MAINLINE RESURFACING SCHEDULE

LOCATION STATION TO STATION	LENGTH	ROADWAY WIDTH		ROADWAY AREA		HOT-MIX ASPH. SURF. REM. 1 1/2"	TEMPORARY RAMP	POLY. HOT-MIX ASPHALT S. C. MIX. D, N105	HOT-MIX ASPHALT S. C. MIX C, N 90	POLY. BIT. MATL. PR. CT	BIT. MAT. PRIME COAT	AGG. PRIME COAT						
		FOR INFORMATIONAL PURPOSE ONLY		SQ YD	SQ YD								SQ YD	TON	TON	GAL	GAL	TON
		FT	FT															
<b>FAP 331 (Murphysboro) - Sta. 13+00 to Sta. 55+62</b>																		
11th St. to 17th St.	13+00.00 TO 33+10.00	2010.0	30.0	6700	6700	16.7	563			603.0		10.0						
17th St. to 22nd St.	33+10.00 TO 55+62.00	2252.0	38.0	9508	9508	21.1	799			856.0		14.3						
<b>Subtotal - FAP 331</b>		<b>4262.0</b>		<b>16,208</b>	<b>16,208</b>	<b>38.0</b>	<b>1362</b>	<b>0</b>		<b>1,459.0</b>	<b>0.0</b>	<b>24.3</b>						
<b>FAP 776 (McLeansboro) - 3 Legs of Square</b>																		
Washington St.	14+62 TO 15+40			615	615	25.0			52		55.4	0.9						
Market St.	200+50 TO 204+80	430.0	45.0	2372	2372	17.0		199			213.5	3.6						
Market St.	Lt. 204+41					30.0												
N. Washington St.	118+15					34.0												
Washington St.	15+40 TO 18+65	325.0	45.0	1620	1624	33.9		136			145.8	2.4						
Jackson St.	204+84 TO 208+84	400.0	45.0	2244	2244	26.0		189			202.0	3.4						
Jackson St.	Lt. 208+69					15.0												
Main St. (EBL)						13.0												
Main St. (Lt. Turn)						15.0												
<b>SUBTOTAL - FAP 776</b>		<b>755.0</b>		<b>6,851</b>	<b>6,855</b>	<b>209.0</b>	<b>0</b>	<b>576</b>	<b>0.0</b>	<b>617</b>	<b>10.3</b>							
<b>TOTALS</b>					<b>23,063</b>	<b>247</b>	<b>1362</b>	<b>576</b>	<b>1,459</b>	<b>617</b>	<b>34.6</b>							

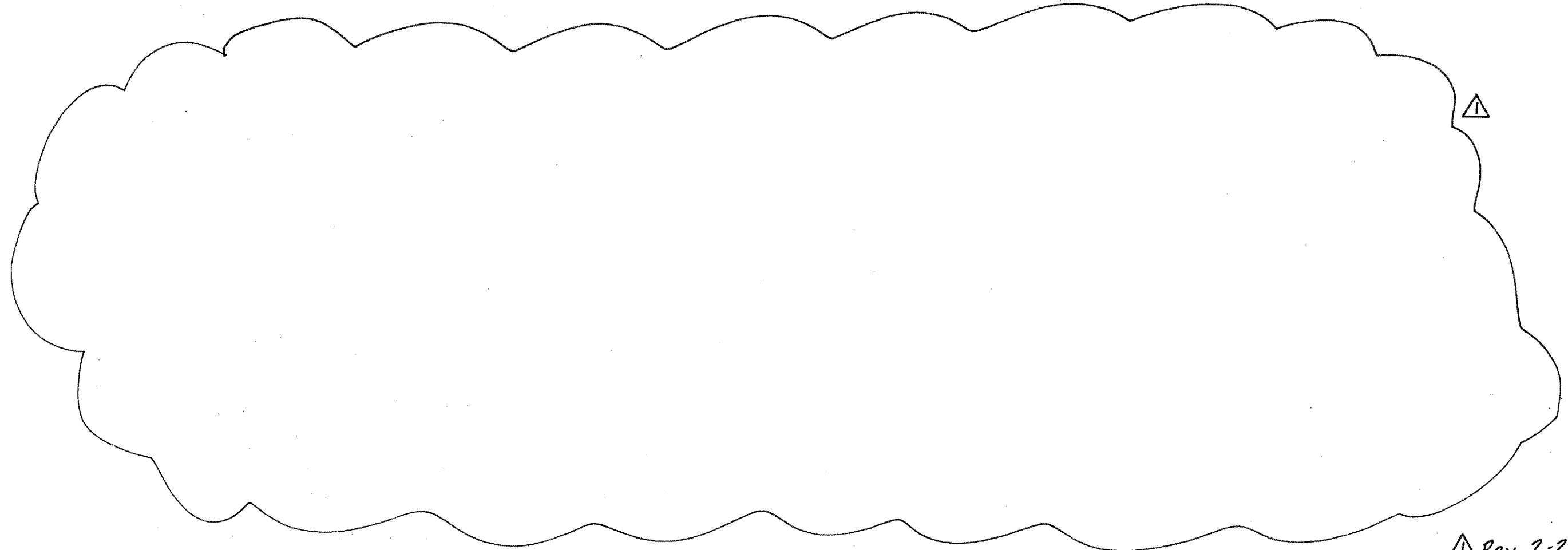

PLOT DATE = 2/7/2007  
 PLOT SCALE = 1/4" = 100'  
 USER NAME = mcorcoran

△ Rev. 2-20-07

CONTRACT NO. 9898T			
F.A.P. RTE.	SECTION	COUNTY	TOTAL SHEETS NO.
•	••	•••	22 / 2
STA.	TO STA.		
FED. ROAD DIST. NO. ILLINOIS FED. AID PROJECT			

•FAP 331 & FAP 776  
 ••10IRS-5;(114Z)RS-3  
 •••JACKSON & HAMILTON COS.

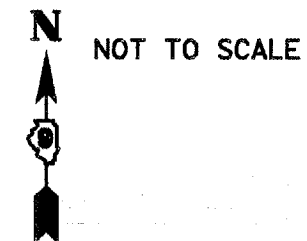

PROP. IMPROVEMENT ENDS  
 STA. 55+62 (BUTT JOINT)

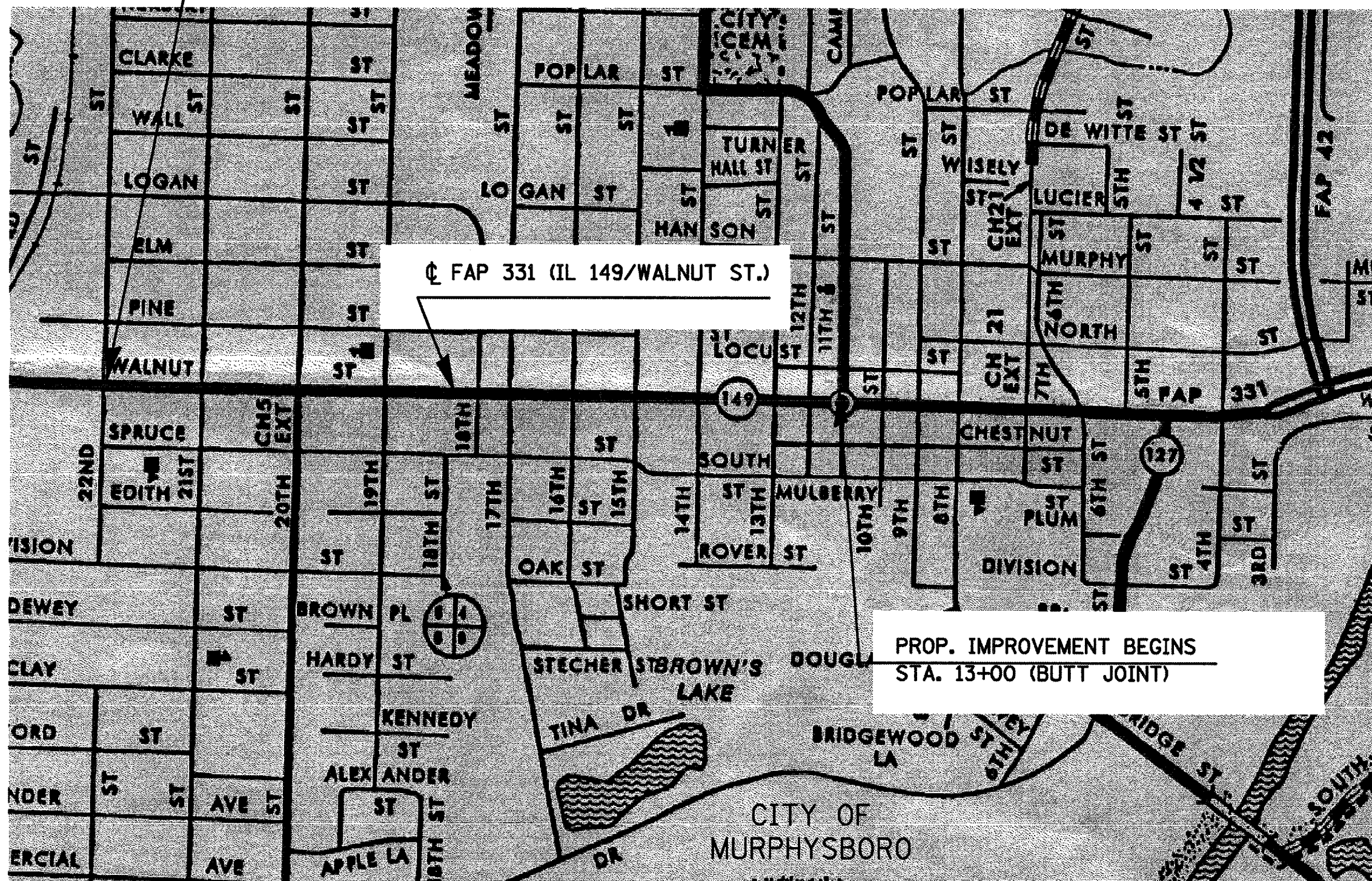

PROP. IMPROVEMENT BEGINS  
 STA. 13+00 (BUTT JOINT)

PLOT DATE: 12/12/2006  
 FILE NAME: \\syracuse\proj\9898T\9898T\_P1.dwg  
 USER: JAC  
 USER: JAC

Rev. 2-20-07

F.A. RTE.	SECTION	COUNTY	TOTAL SHEETS	SHEET NO.
**	**	***	24	13

STA. \_\_\_\_\_ TO STA. \_\_\_\_\_

FED. ROAD DIST. NO. - ILLINOIS FED. AID PROJECT

\*FAP 331 & FAP 776

\*\*101RS-5;(114Z)RS-3

\*\*\*JACKSON & HAMILTON COS.

NOT TO SCALE

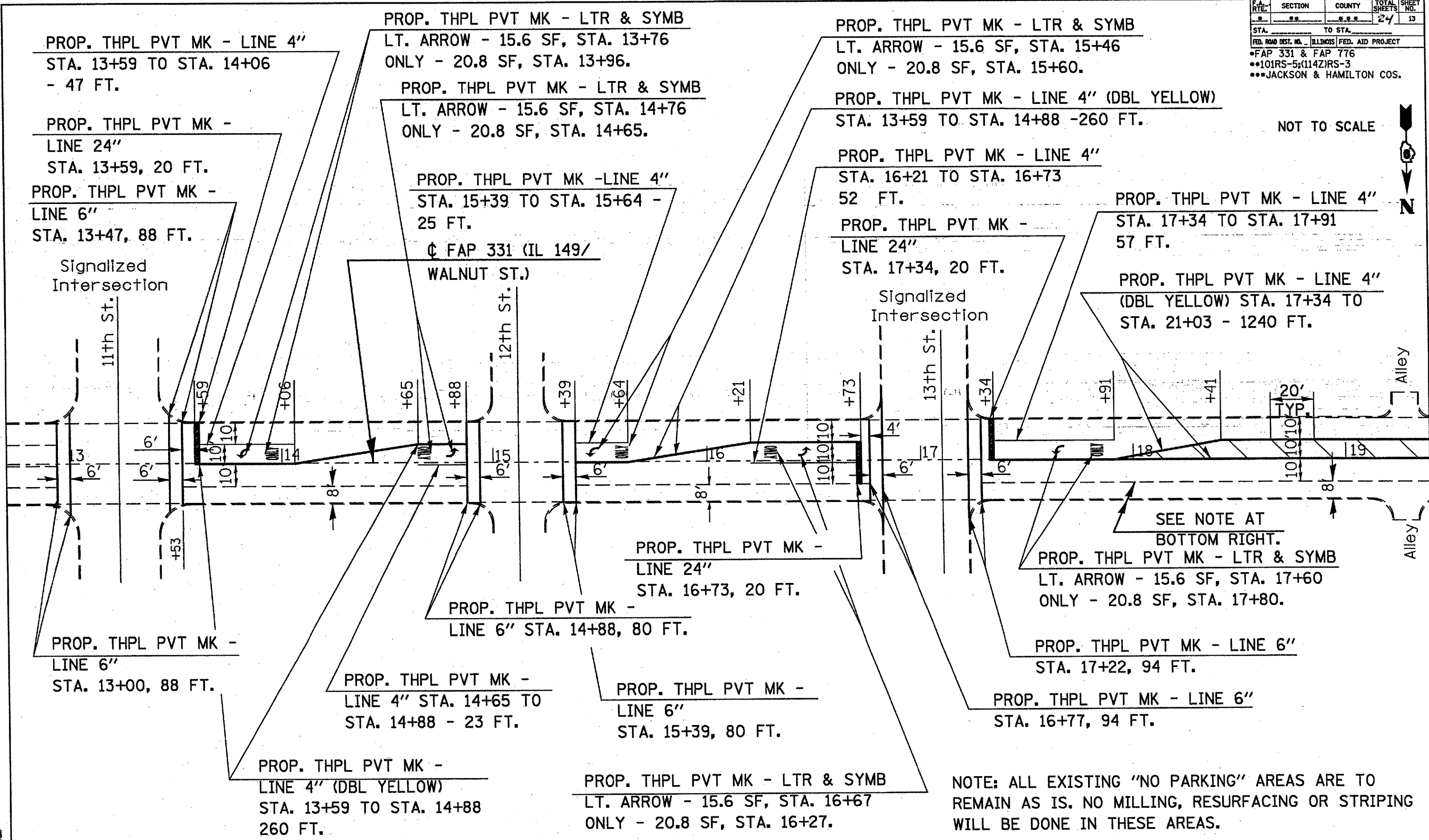

SEE NOTE AT  
BOTTOM RIGHT.  
PROP. THPL PVT MK - LTR & SYMB  
LT. ARROW - 15.6 SF, STA. 17+60  
ONLY - 20.8 SF, STA. 17+80.

NOTE: ALL EXISTING "NO PARKING" AREAS ARE TO REMAIN AS IS. NO MILLING, RESURFACING OR STRIPING WILL BE DONE IN THESE AREAS.

Rev. 2-20-07

PLOT DATE = 2/7/2007  
 PLOT NAME = MURPHYSBORO\_PAVEMENT\_MARKING.dwg  
 PLOT SCALE = 1/8" = 1'-0"  
 USER NAME = mason

F.A. RTE.	SECTION	COUNTY	TOTAL SHEETS	SHEET NO.
**	**	***	24	19
STA. _____		TO STA. _____		
FED. ROAD DIST. NO. _____		ILLINOIS FED. AID PROJECT		
*FAP 331 & FAP 776				
**101RS-5;(114Z)RS-3				
***JACKSON & HAMILTON COS.				

NOT TO SCALE

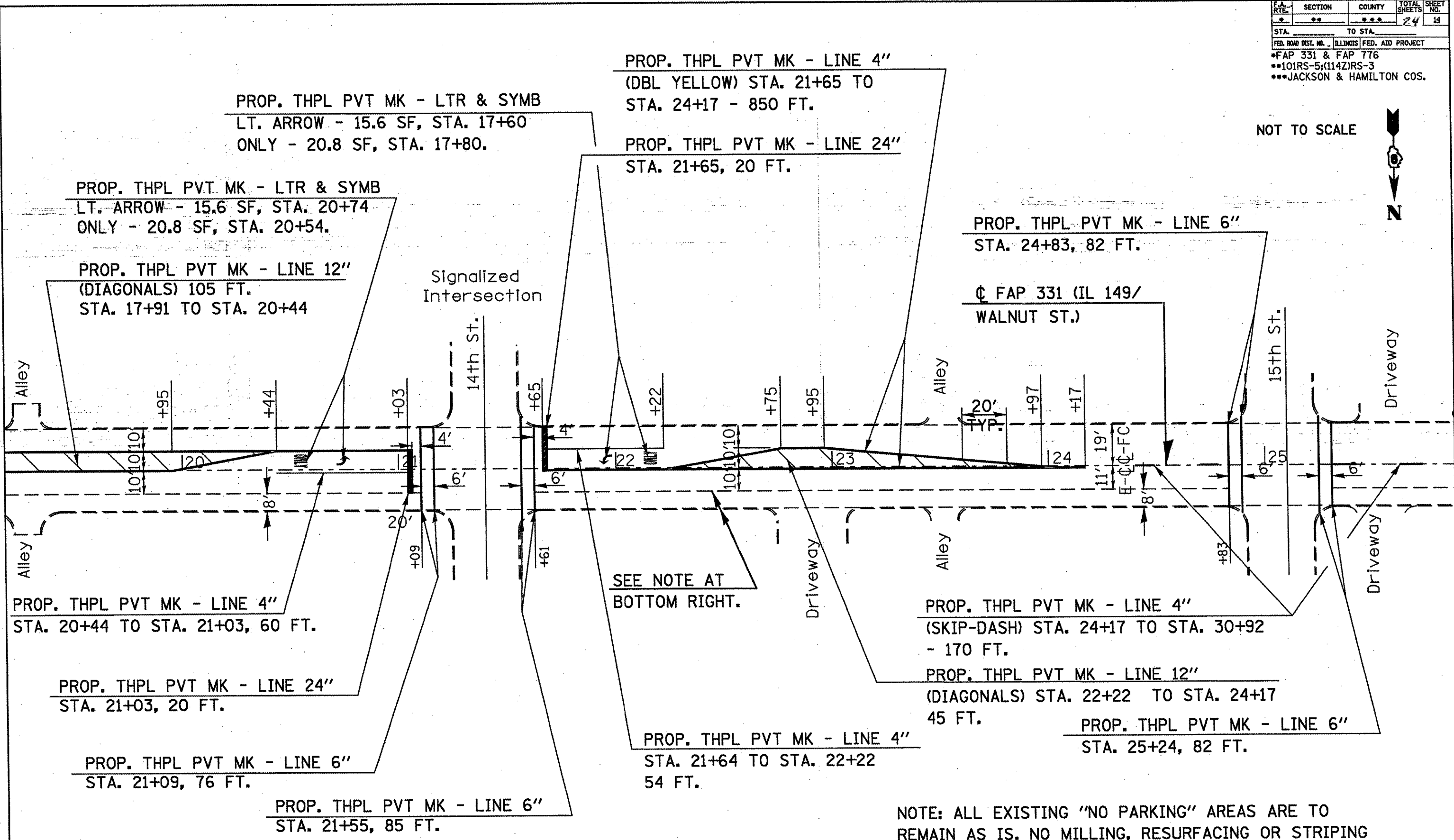

PROP. THPL PVT MK - LTR & SYMB  
LT. ARROW - 15.6 SF, STA. 17+60  
ONLY - 20.8 SF, STA. 17+80.

PROP. THPL PVT MK - LINE 4"  
(DBL YELLOW) STA. 21+65 TO  
STA. 24+17 - 850 FT.

PROP. THPL PVT MK - LINE 24"  
STA. 21+65, 20 FT.

PROP. THPL PVT MK - LINE 6"  
STA. 24+83, 82 FT.

☉ FAP 331 (IL 149/  
WALNUT ST.)

PROP. THPL PVT MK - LTR & SYMB  
LT. ARROW - 15.6 SF, STA. 20+74  
ONLY - 20.8 SF, STA. 20+54.

PROP. THPL PVT MK - LINE 12"  
(DIAGONALS) 105 FT.  
STA. 17+91 TO STA. 20+44

PROP. THPL PVT MK - LINE 4"  
STA. 20+44 TO STA. 21+03, 60 FT.

PROP. THPL PVT MK - LINE 24"  
STA. 21+03, 20 FT.

PROP. THPL PVT MK - LINE 6"  
STA. 21+09, 76 FT.

PROP. THPL PVT MK - LINE 6"  
STA. 21+55, 85 FT.

SEE NOTE AT  
BOTTOM RIGHT.

PROP. THPL PVT MK - LINE 4"  
STA. 21+64 TO STA. 22+22  
54 FT.

PROP. THPL PVT MK - LINE 4"  
(SKIP-DASH) STA. 24+17 TO STA. 30+92  
- 170 FT.

PROP. THPL PVT MK - LINE 12"  
(DIAGONALS) STA. 22+22 TO STA. 24+17  
45 FT.

PROP. THPL PVT MK - LINE 6"  
STA. 25+24, 82 FT.

NOTE: ALL EXISTING "NO PARKING" AREAS ARE TO  
REMAIN AS IS. NO MILLING, RESURFACING OR STRIPING  
WILL BE DONE IN THESE AREAS.

PLOT DATE = 2/7/2007  
 FILE NAME = c:\pavement\99997\pavement.dwg  
 PLOT SCALE = 1/8" = 1'-0"  
 USER NAME = murrphy

Rev. Sheet 2-20-07



F.A. RTE.	SECTION	COUNTY	TOTAL SHEETS	SHEET NO.
*	**	***	24	15

STA. TO STA.  
 ILLINOIS FED. AID PROJECT  
 \*FAP 331 & FAP 776  
 \*\*101RS-5;(114Z)RS-3  
 \*\*\*JACKSON & HAMILTON COS.

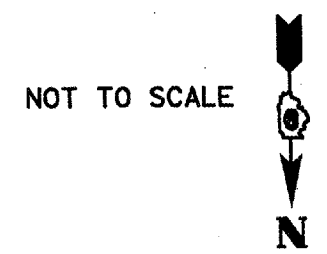

NOT TO SCALE

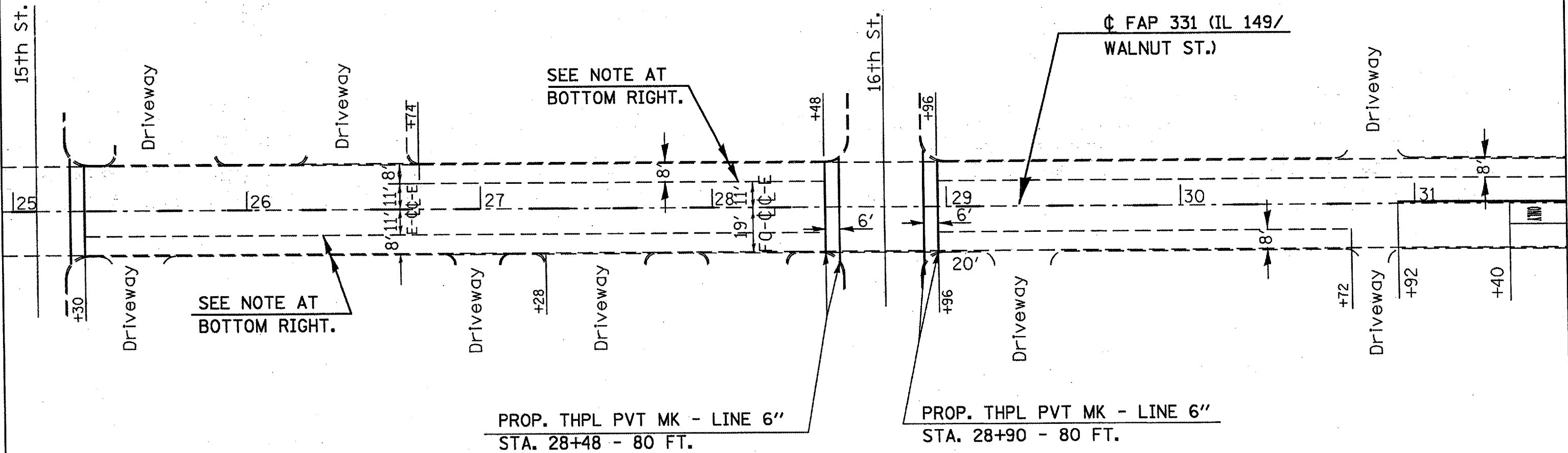

SEE NOTE AT BOTTOM RIGHT.

SEE NOTE AT BOTTOM RIGHT.

PROP. THPL PVT MK - LINE 6"  
 STA. 28+48 - 80 FT.

PROP. THPL PVT MK - LINE 6"  
 STA. 28+90 - 80 FT.

Ø FAP 331 (IL 149/  
 WALNUT ST.)

NOTE: ALL EXISTING "NO PARKING" AREAS ARE TO REMAIN AS IS. NO MILLING, RESURFACING OR STRIPING WILL BE DONE IN THESE AREAS.

Rev. 2-20-07

DATE: 2/7/2007  
 FILE NAME: ...  
 PLOT SCALE: 1/8" = 1'-0"  
 USER NAME: ...

F.A. RYD.	SECTION	COUNTY	TOTAL SHEETS	SHEET NO.
2	**	***	24	16
STA. TO STA.				
FED. ROAD DIST. NO. ILLINOIS FED. AID PROJECT				
*FAP 331 & FAP 776				
**101RS-5;(114Z)RS-3				
***JACKSON & HAMILTON COS.				

NOT TO SCALE

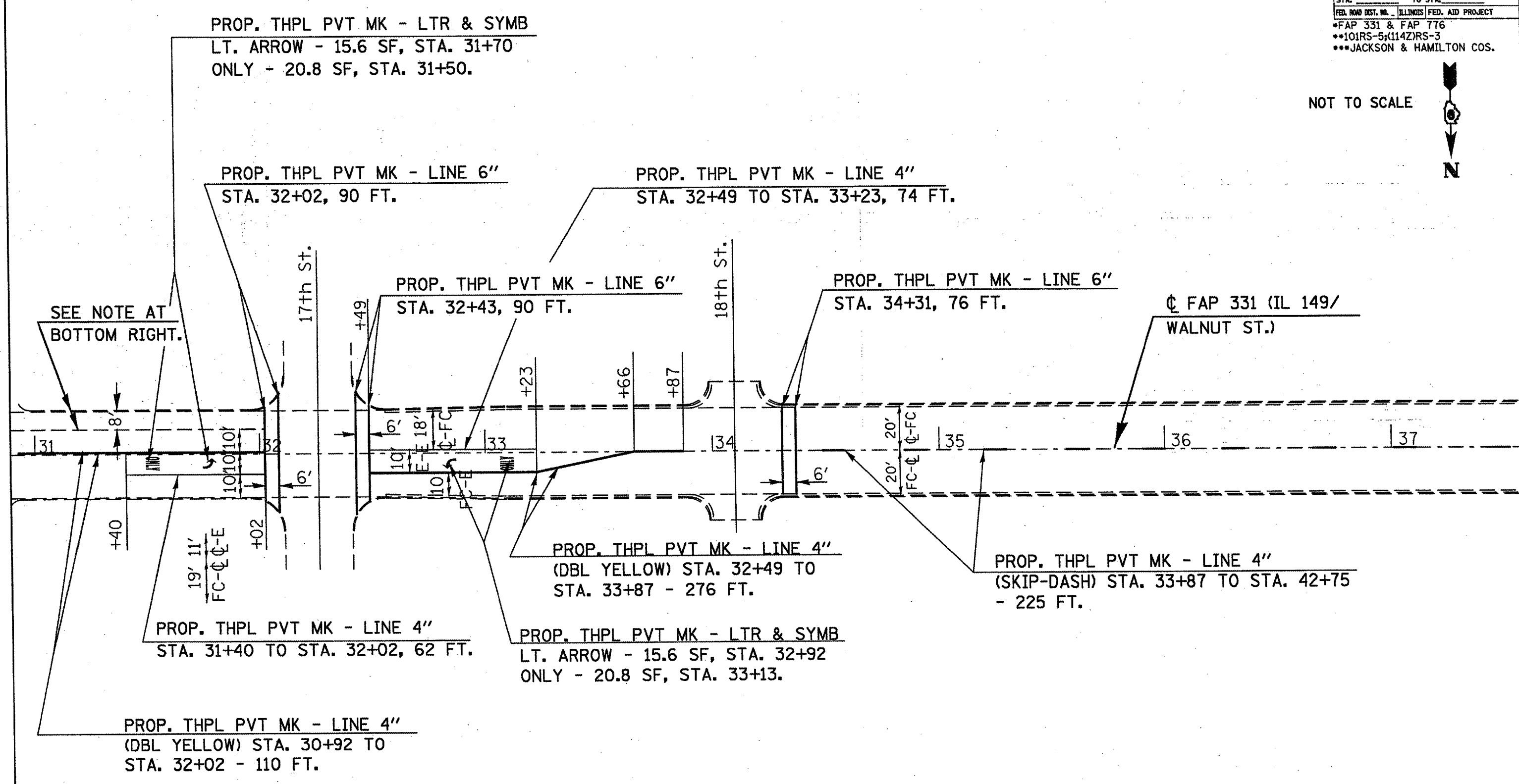

PROP. THPL PVT MK - LTR & SYMB  
 LT. ARROW - 15.6 SF, STA. 31+70  
 ONLY - 20.8 SF, STA. 31+50.

PROP. THPL PVT MK - LINE 6"  
 STA. 32+02, 90 FT.

PROP. THPL PVT MK - LINE 4"  
 STA. 32+49 TO STA. 33+23, 74 FT.

PROP. THPL PVT MK - LINE 6"  
 STA. 32+43, 90 FT.

PROP. THPL PVT MK - LINE 6"  
 STA. 34+31, 76 FT.

☉ FAP 331 (IL 149/  
 WALNUT ST.)

SEE NOTE AT  
 BOTTOM RIGHT.

PROP. THPL PVT MK - LINE 4"  
 (DBL YELLOW) STA. 32+49 TO  
 STA. 33+87 - 276 FT.

PROP. THPL PVT MK - LINE 4"  
 (SKIP-DASH) STA. 33+87 TO STA. 42+75  
 - 225 FT.

PROP. THPL PVT MK - LINE 4"  
 STA. 31+40 TO STA. 32+02, 62 FT.

PROP. THPL PVT MK - LTR & SYMB  
 LT. ARROW - 15.6 SF, STA. 32+92  
 ONLY - 20.8 SF, STA. 33+13.

PROP. THPL PVT MK - LINE 4"  
 (DBL YELLOW) STA. 30+92 TO  
 STA. 32+02 - 110 FT.

NOTE: ALL EXISTING "NO PARKING" AREAS ARE TO  
 REMAIN AS IS. NO MILLING, RESURFACING OR STRIPING  
 WILL BE DONE IN THESE AREAS.

PLOT DATE = 2/7/2007  
 FILE NAME = c:\projects\88987\88987.dwg  
 PLOT SCALE = 1/8" = 1'-0"  
 USER =

Rev. 2-20-07

F.A. RTE.	SECTION	COUNTY	TOTAL SHEETS	SHEET NO.
..	..	..	24	17
STA.		TO STA.		
FED. ROAD DIST. NO.		ILLINOIS FED. AID PROJECT		

- FAP 331 & FAP 776
- 10IRS-5;(114Z)RS-3
- JACKSON & HAMILTON COS.

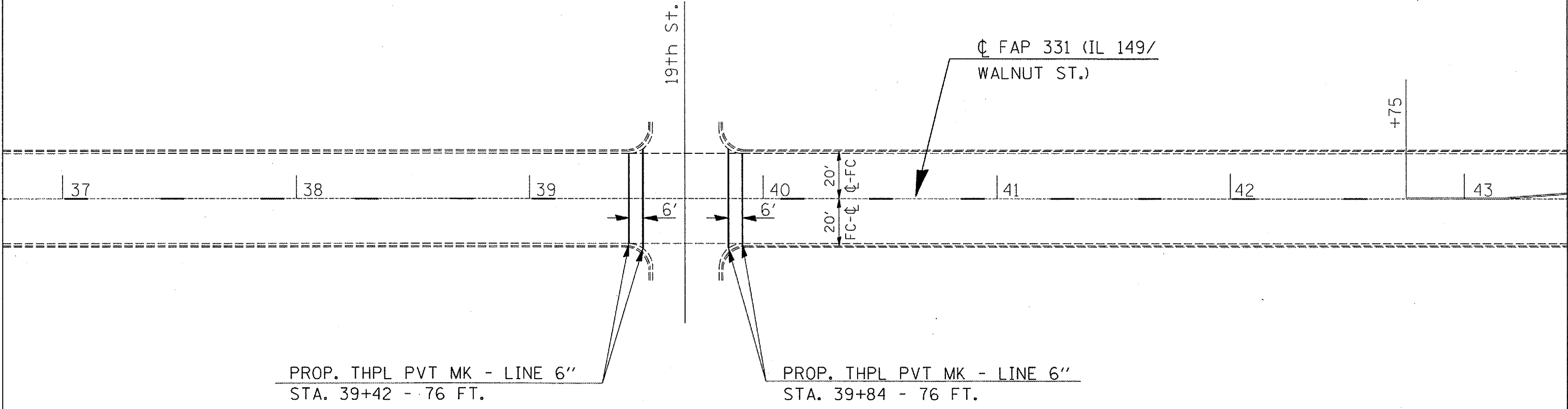
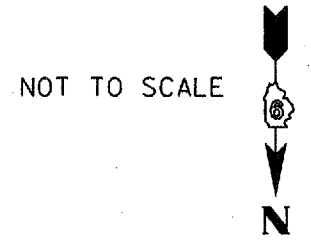

PLOT DATE = 12/12/2006  
 FILE NAME = c:\projects\98987\p17.dwg  
 PLOT SCALE = 42,352.9' / IN.  
 USER NAME = mcborder

Rev. 2-20-07

F.A. RTE.	SECTION	COUNTY	TOTAL SHEETS	SHEET NO.
*	**	***	24	18
STA. _____		TO STA. _____		
FED. ROAD DIST. NO.   ILLINOIS FED. AID PROJECT				
•FAP 331 & FAP 776				
••10IRS-5;(114Z)RS-3				
•••JACKSON & HAMILTON COS.				

NOT TO SCALE

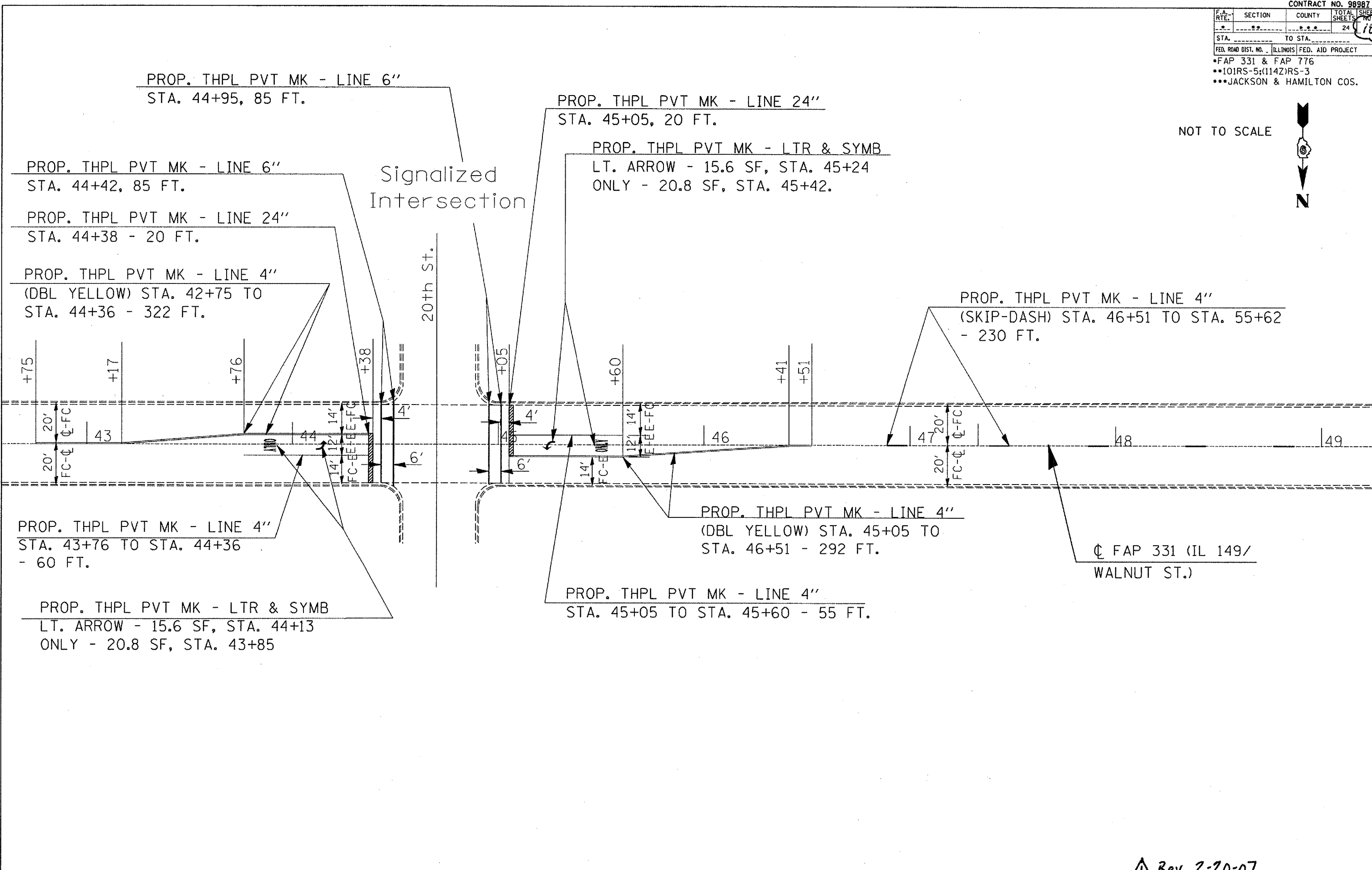

PLOT DATE = 12/12/2006  
 FILE NAME = c:\projects\98987\p18.dwg  
 PLOT SCALE = 42.5293' / IN.  
 USER NAME = mrcorder

Rev. 2-20-07

F.A. RTE.	SECTION	COUNTY	TOTAL SHEETS	SHEET NO.
..	..	..	24	19
STA.		TO STA.		
FED. ROAD DIST. NO.		ILLINOIS FED. AID PROJECT		
•FAP 331 & FAP 776 ••10IRS-5;(114Z)RS-3 •••JACKSON & HAMILTON COS.				

NOT TO SCALE



PROP. THPL PVT MK - LINE 6"  
STA. 50+30 - 85 FT.

PROP. THPL PVT MK - LINE 6"  
STA. 50+72 - 85 FT.

☺ FAP 331 (IL 149/  
WALNUT ST.)

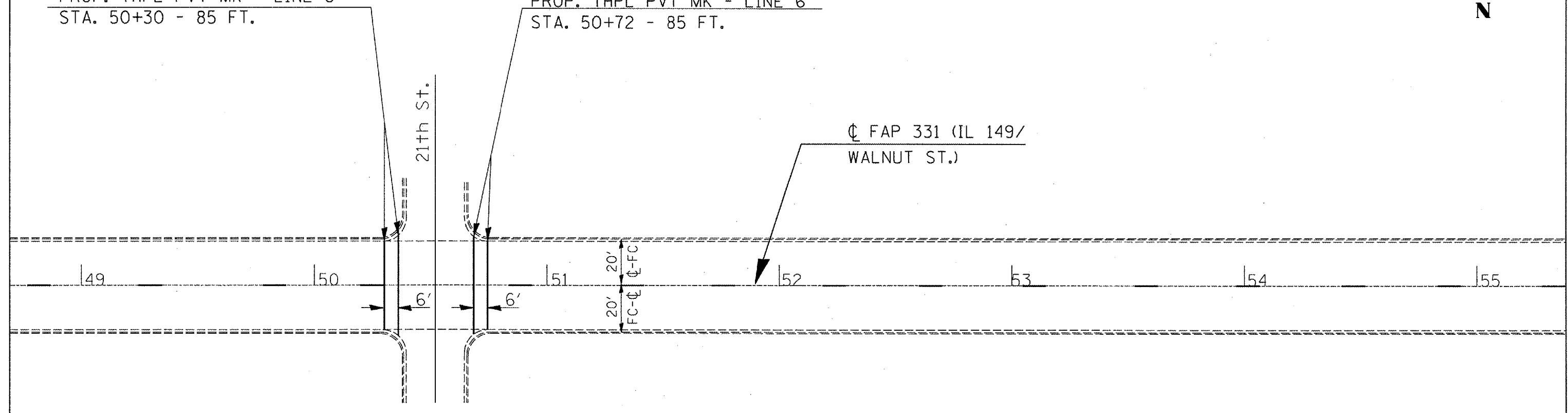

PLOT DATE = 12/12/2006  
 FILE NAME = s:\proj\secta\98987\98987pl.mxd  
 PLOT SCALE = 42.3528' / IN.  
 USER NAME = maceda

Rev. 2-20-07

F.A. RTE.	SECTION	COUNTY	TOTAL SHEETS
**	**	***	24
STA. _____ TO STA. _____			20
FED. ROAD DIST. NO. _____ ILLINOIS FED. AID PROJECT			

- FAP 331 & FAP 776
- 10IRS-5;(114Z)RS-3
- JACKSON & HAMILTON COS.

NOT TO SCALE

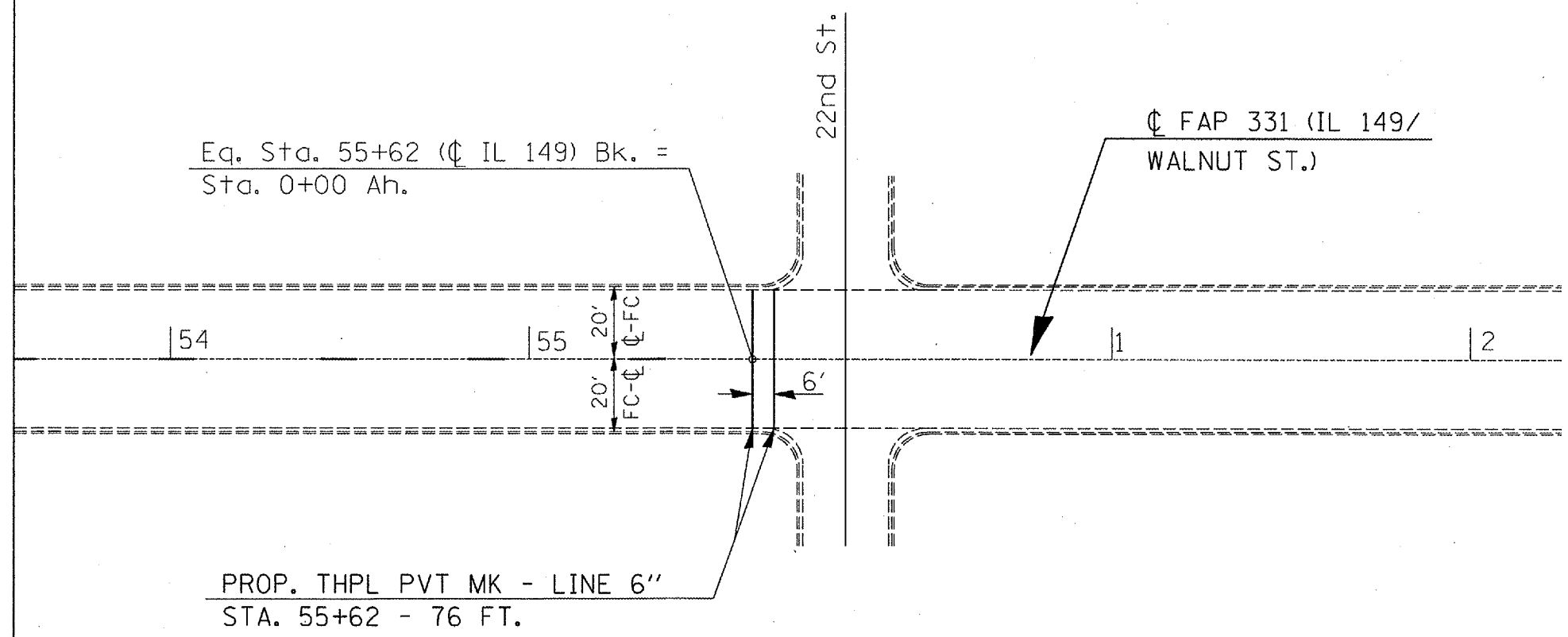

PLOT DATE = 12/12/2006  
 FILE NAME = c:\p\p\mcs\4980287\4980287.plm32  
 PLOT SCALE = 42.5000' / IN.  
 USER NAME = mcordeir

Rev. 2-20-07

F.A.P. RTE.	SECTION	COUNTY	TOTAL SHEETS	SHEET NO.
			24	21
STA. _____		TO STA. _____		
FED. ROAD DIST. NO. _____ ILLINOIS FED. AID PROJECT				

- FAP 331 & FAP 776
- 101RS-5; (1142)RS-3
- JACKSON & HAMILTON

NOTE: PARKING LANES SHALL NOT BE MILLED OR RESURFACED. (SEE TYP., SHT. 8)

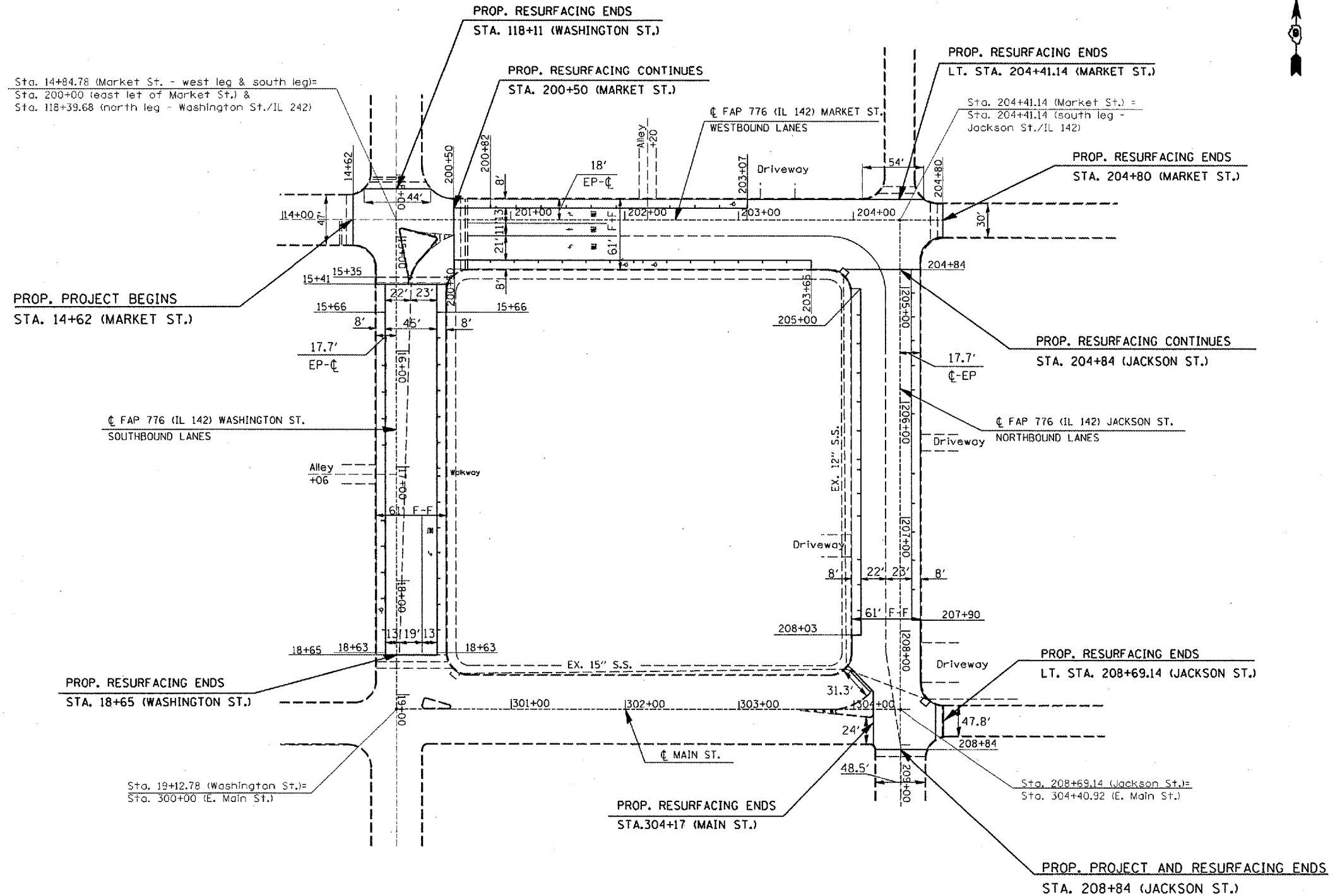

PLOT DATE = 12/12/2006  
 FILE NAME = c:\puro\sect\98987\p100107.plm32  
 PLOT SCALE = 1/8"=1'-0"  
 USER NAME = mcdonald

Rev. 2-20-07

F.A.P. RTE.	SECTION	COUNTY	TOTAL SHEETS	SHEET NO.
---	---	---	24	22
STA. --- TO STA. ---		ILLINOIS FED. AID PROJECT		

•FAP 331 & FAP 776  
 ••10IRS-5; (1142)RS-3  
 •••JACKSON & HAMILTON

TURN LANE DETAILS

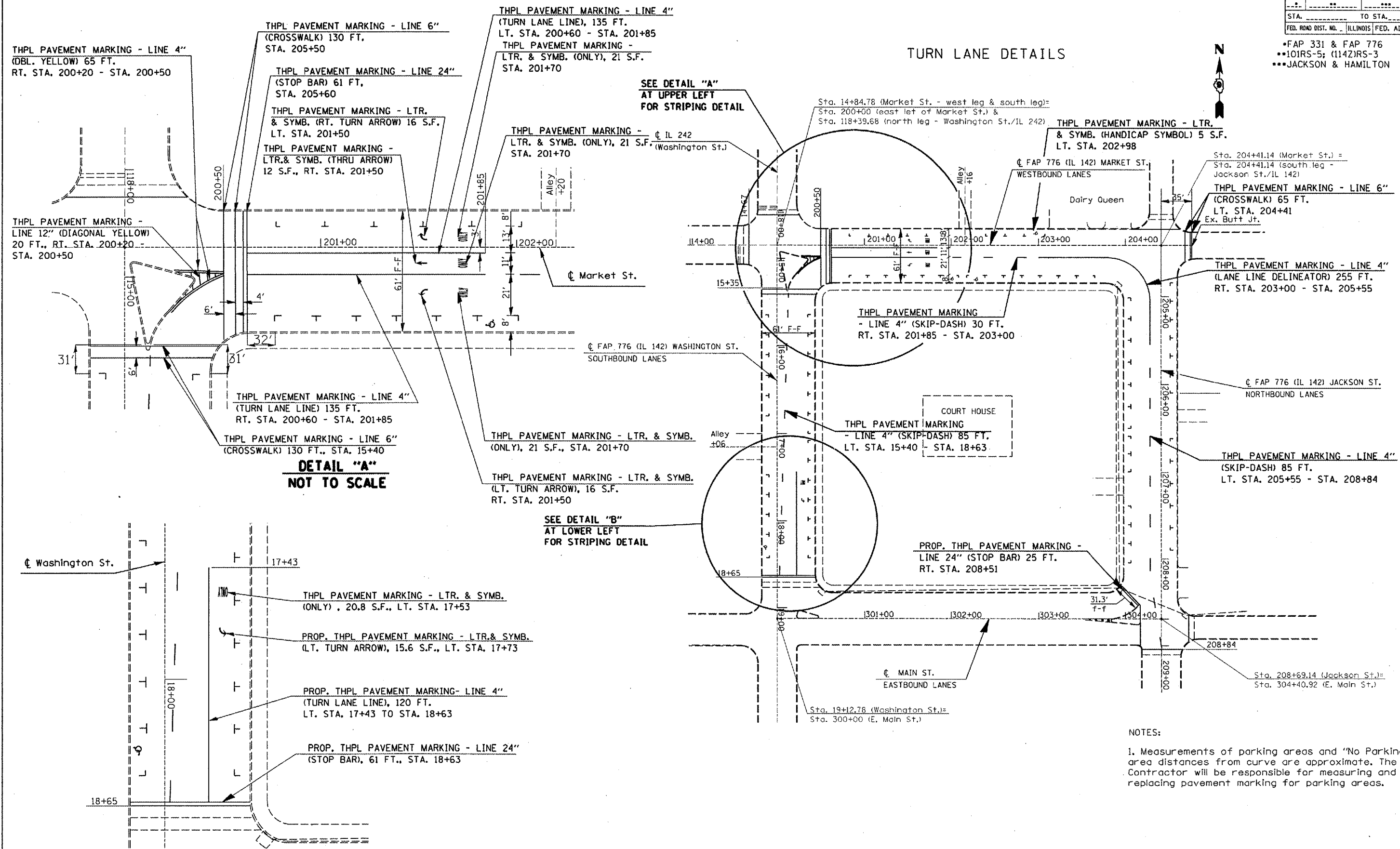

**DETAIL "A"**  
NOT TO SCALE

**SEE DETAIL "B"**  
AT LOWER LEFT  
FOR STRIPING DETAIL

**DETAIL "B"**  
NOT TO SCALE

NOTES:  
 1. Measurements of parking areas and "No Parking" area distances from curve are approximate. The Contractor will be responsible for measuring and replacing pavement marking for parking areas.

PLOT DATE = 12/12/2006  
 FILE NAME = c:\p\ro\mca\p\980207\p\980107.dwg  
 PLOT SCALE = 1/8" = 100'-0"  
 USER NAME = mcaorder



F.A.P. RTE.	SECTION	COUNTY	TOTAL SHEETS	SHEET NO.
			24	23
STA.	TO STA.			
FED. ROAD DIST. NO.	ILLINOIS FED. AID PROJECT			

- FAP 331 & FAP 776
- 101RS-5; (114Z)RS-3
- JACKSON & HAMILTON

## TEMPORARY BITUMINOUS CONCRETE TRANSITIONS

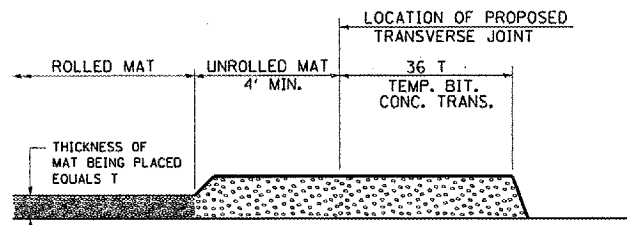

### STEP I

1. PLACE BITUMINOUS MAT, LENGTH 36 TIMES THE THICKNESS OF THE MAT BEING PLACED PAST THE PROPOSED TRANSVERSE JOINT LOCATION USING NORMAL OPERATING PROCEDURES.
2. EXTREME CARE SHOULD BE TAKEN TO MAINTAIN ENOUGH MATERIAL IN FRONT OF THE SCREED TO MAINTAIN REQUIRED PAVING DEPTH.

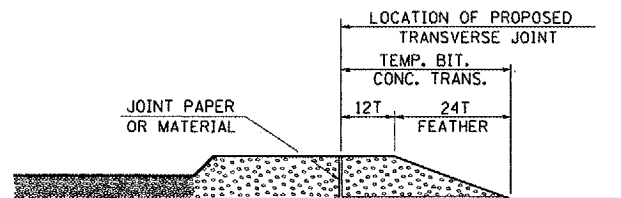

### STEP III

1. JOINT PAPER OR OTHER PRESELECTED JOINT MATERIAL IS THEN PLACED IN THE CLEARED AREA AND THE EXCESS ASPHALT USED TO HAND FORM A TRANSITION TO THE DIMENSIONS SHOWN ABOVE.
2. NOTE THAT IN CONSTRUCTING THE TRANSITION, THE MAT DEPTH IS CONTINUED AS PART OF THE TRANSITION BEFORE FORMING THE FEATHER.

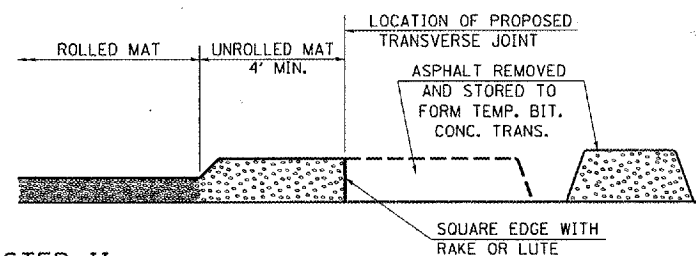

### STEP II

1. MOVE THE PAVER OUT OF THE WAY AND REMOVE THE ASPHALT FROM THE AREA OF THE PROPOSED TEMPORARY BITUMINOUS CONCRETE TRANSITION.
2. SQUARE UP THE END OF THE MAT WITH A RAKE OR LUTE.
3. NOTE THAT THE MAT WITHIN 4' OF THE END OF JOINT IS NOT TO BE ROLLED AT THIS TIME.

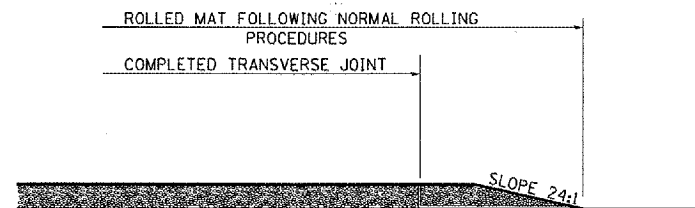

### STEP IV

1. COMPLETE TEMPORARY TRANSITION BY ROLLING.
2. TO RESUME PAVING, AT THE JOINT, REMOVE TEMPORARY TRANSITION AND DISPOSE OF THE MATERIAL ACCORDING TO ART. 202.03 OF THE STD. SPECS. (COST INCLUDED IN THE CONTRACT).
3. CONSTRUCTING THE TEMPORARY TRANSITIONS WILL NOT BE PAID FOR SEPARATELY BUT WILL BE INCLUDED IN THE BITUMINOUS MATERIAL BEING PLACED.

REVISIONS	
REDRAWN	2-15-89
REVISED	8-16-94
REVISED	
REVISED	

STD. 9-26

## UNEVEN LANES SIGN

W8-11 (48" x 48")

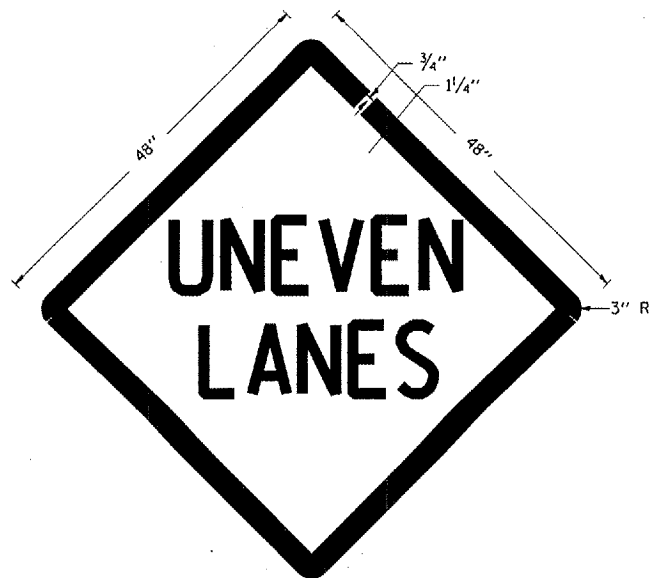

**COLORS:**  
 LEGEND AND BORDER - BLACK NON-REFLECTORIZED  
 BACKGROUND - ORANGE REFLECTORIZED

**NOTE:** PRIOR TO ALLOWING TRAFFIC ON ANY PORTION OF THE ROADWAY THAT HAS BEEN COLD MILLED OR BEFORE RESURFACING OPERATIONS BEGIN, THE CONTRACTOR SHALL HAVE ERECTED "UNEVEN PAVEMENT" SIGNS THAT CONFORM TO THE ABOVE DETAILS. A MINIMUM OF ONE SIGN AT EACH END OF THE IMPROVEMENT WILL BE REQUIRED. THE CONTRACTOR SHALL MAINTAIN THE "UNEVEN PAVEMENT" SIGNS UNTIL THE RESURFACING OPERATIONS ARE COMPLETED.

IF AT ANY TIME THE SIGNS ARE IN PLACE BUT NOT APPLICABLE, THEY SHALL BE TURNED FROM THE VIEW OF MOTORISTS OR COVERED AS DIRECTED BY THE ENGINEER.

THE COST OF FURNISHING, ERECTING, MAINTAINING, AND REMOVING THE REQUIRED SIGNS SHALL BE INCLUDED IN THE CONTRACT.

REVISIONS	
DRAWN	2-15-89
REVISED	2-15-89
REVISED	1-22-94
REVISED	

STD. 9-41