

SEE SHEET NO. 17

PROPOSED C PAVEMENT  
ILLINOIS RTE 31 BYPASS

N2005500

N2005250

N2005000

N2004750

SEE SHEET NO. 14

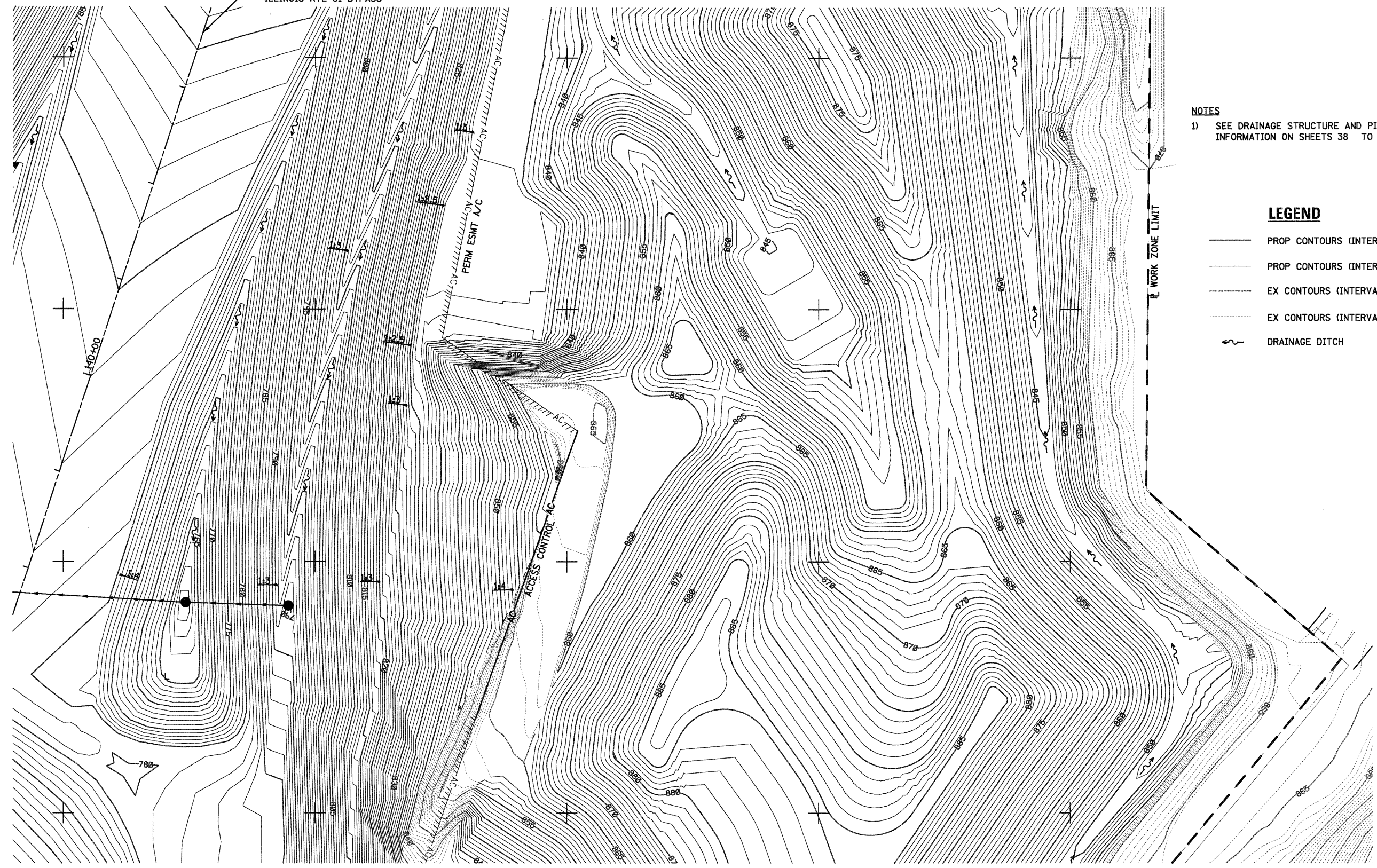

E994500

E994750

SEE SHEET NO. 13

E995000

E995250

E995500

**NOTES**

- 1) SEE DRAINAGE STRUCTURE AND PIPE INFORMATION ON SHEETS 38 TO 47.

**LEGEND**

- PROP CONTOURS (INTERVAL AT 5')
- PROP CONTOURS (INTERVAL AT 1')
- - - EX CONTOURS (INTERVAL AT 5')
- - - EX CONTOURS (INTERVAL AT 1')
- ↪ DRAINAGE DITCH

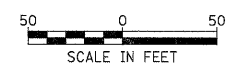

FILE NAME =  
...\\D160F78-sh1-grading-04.dgn

USER NAME = ctb  
PLOT SCALE = 600.0000' / ft.  
PLOT DATE = 1/18/2012

DESIGNED - KWH  
DRAWN - JES  
CHECKED - GAB  
DATE - 1/20/2012

REVISED -  
REVISED -  
REVISED -  
REVISED -

**STATE OF ILLINOIS  
DEPARTMENT OF TRANSPORTATION**

**GRADING PLAN**

SCALE: 1" = 50' SHEET NO. 4 OF 10 SHEETS STA. TO STA.

F.A. RTE.	SECTION	COUNTY	TOTAL SHEETS	SHEET NO.
	18A-1	McHENRY	115	15
ILLINOIS FED. AID PROJECT			CONTRACT NO. 60F78	