

SUMMARY OF QUANTITIES

CODED PAY ITEM NUMBER	PAY ITEM	UNIT	TOTAL QUANTITIES	CONSTRUCTION TYPE CODE	
				ROADWAY 0004	BRIDGE REHABILITATION 0014 0040
20200100	EARTH EXCAVATION	CU YD	50	50	
28100107	STONE RIPRAP, CLASS A4	SQ YD	168		168
28200200	FILTER FABRIC	SQ YD	168		168
31101400	SUBBASE GRANULAR MATERIAL, TYPE B 6"	SQ YD	16	16	
35501316	HOT-MIX ASPHALT BASE COURSE, 8"	SQ YD	22	22	
40600100	BITUMINOUS MATERIALS (PRIME COAT)	GALLON	10	10	
40600300	AGGREGATE (PRIME COAT)	TON	1	1	
40603335	HOT-MIX ASPHALT SURFACE COURSE, MIX "D", N50	TON	3	3	
40603340	HOT-MIX ASPHALT SURFACE COURSE, MIX "D", N70	TON	8	8	
44000200	DRIVEWAY PAVEMENT REMOVAL	SQ YD	22	22	
44201769	CLASS D PATCHES, TYPE III, 10 INCH	SQ YD	16	16	
50102400	CONCRETE REMOVAL	CU YD	25.0		25.0
50200100	STRUCTURE EXCAVATION	CU YD	261		261
50300225	CONCRETE STRUCTURES	CU YD	40.0		40.0
50500405	FURNISHING AND ERECTING STRUCTURAL STEEL	POUND	380		380
50800205	REINFORCEMENT BARS, EPOXY COATED	POUND	8080		8080
54003000	CONCRETE BOX CULVERTS	CU YD	15.4		15.4
64200116	SHOULDER RUMBLE STRIPS, 16 INCH	FOOT	432	432	
67000400	ENGINEER'S FIELD OFFICE, TYPE A	CAL MO	4	4	
67100100	MOBILIZATION	L SUM	1	1	
70103815	TRAFFIC CONTROL SURVEILLANCE	CAL DA	85	85	
70106800	CHANGEABLE MESSAGE SIGN	CAL MO	2	2	
70301000	WORK ZONE PAVEMENT MARKING REMOVAL	SQ FT	680	680	
70400100	TEMPORARY CONCRETE BARRIER	FOOT	100.0	100.0	
* 78000200	THERMOPLASTIC PAVEMENT MARKING - LINE 4"	FOOT	2020	2020	

* INDICATES SPECIALTY ITEMS

CODED PAY ITEM NUMBER	PAY ITEM	UNIT	TOTAL QUANTITIES	CONSTRUCTION TYPE CODE	
				ROADWAY 0004	BRIDGE REHABILITATION 0014 0040
* 78100100	RAISED REFLECTIVE PAVEMENT MARKER	EACH	14	14	
78300100	PAVEMENT MARKING REMOVAL	SQ FT	674	674	
78300200	RAISED REFLECTIVE PAVEMENT MARKER REMOVAL	EACH	14	14	
X0325201	SHOULDER RUMBLE STRIP REMOVAL	SQ YD	60	60	
X7010216	TRAFFIC CONTROL AND PROTECTION, (SPECIAL)	L SUM	1	1	
X7030030	WET REFLECTIVE TEMPORARY TAPE TYPE III, 4 INCH	FOOT	2040	2040	
Z0001903	STRUCTURAL STEEL REMOVAL	POUND	5010		5010
Z0007122	REMOVING AND RE-ERECTING EXISTING RAILING	FOOT	60		60
Z0013798	CONSTRUCTION LAYOUT	L SUM	1	1	
Z0015500	DEBRIS REMOVAL	L SUM	1		1
Z0026407	TEMPORARY SHEET PILING	SQ FT	1802		1802
Z0030250	IMPACT ATTENUATORS, TEMPORARY (NON-REDIRECTIVE), TEST LEVEL 3	EACH	2	2	
Z0030850	TEMPORARY INFORMATION SIGNING	SQ FT	52	52	
Z0062456	TEMPORARY PAVEMENT	SQ YD	204	204	

* INDICATES SPECIALTY ITEMS

FILE NAME = ...\\D168P39-sht-S00-PostFinal.dgn



DESIGNED - ADW
 DRAWN - GEW
 CHECKED - RJD
 DATE - 12/12/2011

REVISED -
 REVISED -
 REVISED -
 REVISED -

**STATE OF ILLINOIS
 DEPARTMENT OF TRANSPORTATION**

**PALATINE ROAD OVER SALT CREEK
 SUMMARY OF QUANTITIES**

SCALE: N/A SHEET NO. 1 OF 1 SHEETS STA. TO STA.

F.A.U. RTE. 1285	SECTION 2011-033-T	COUNTY COOK	TOTAL SHEETS 18	SHEET NO. 3
CONTRACT NO. 60P39				
ILLINOIS FED. AID PROJECT				

Rev. 2-23-12

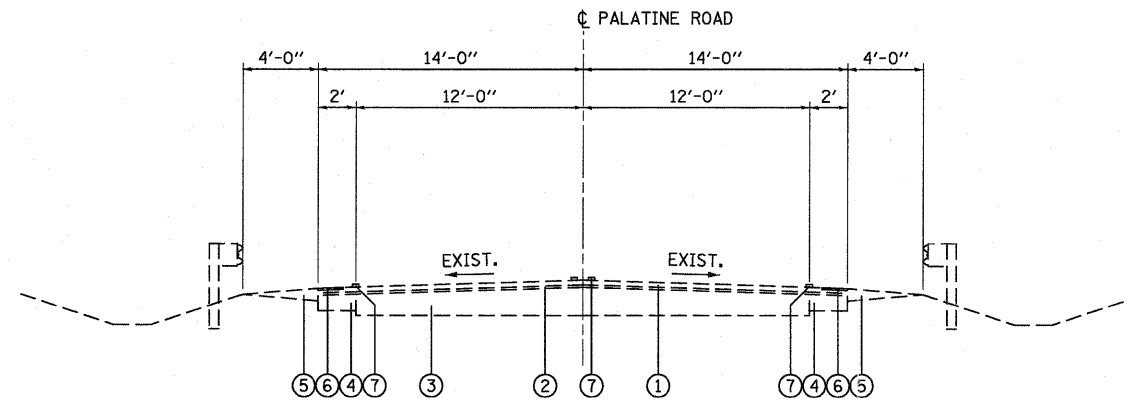

EXISTING TYPICAL SECTION
STA. 69 + 70.00 TO STA. 70 + 35.00

EXISTING LEGEND

- ① EXISTING HMA SURFACE COURSE, 1 1/2"
- ② EXISTING POLYMERIZED LEVELING BINDER, 3/4"
- ③ EXISTING HMA BASE COURSE, 8"
- ④ EXISTING HMA AGGREGATE MIXTURE BASE COURSE
- ⑤ EXISTING AGGREGATE SHOULDERS, TYPE B
- ⑥ EXISTING HMA RUMBLE SHOULDER
- ⑦ EXISTING PAVEMENT MARKING LINE

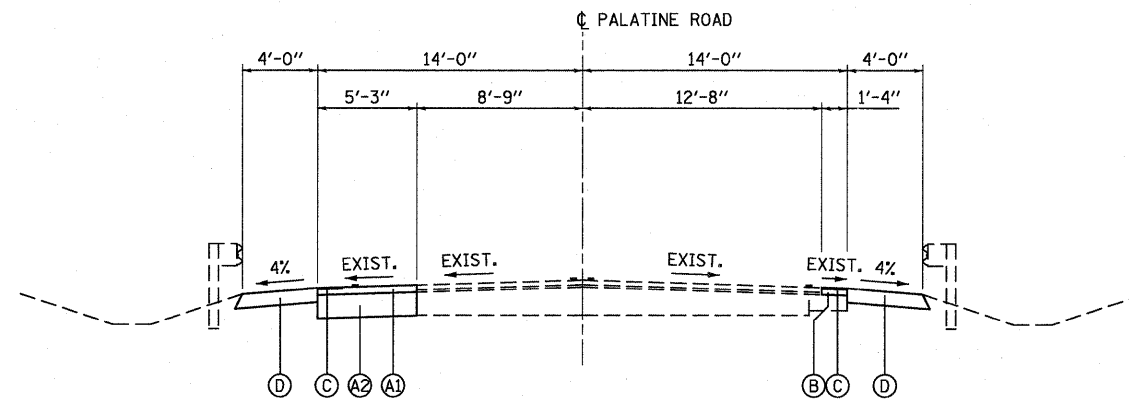

PROPOSED TYPICAL SECTION
STA. 69 + 70.00 TO STA. 70 + 35.00

PROPOSED LEGEND

- △ A CLASS D PATCHES, TYPE III, 10 INCH
- A1 HOT-MIX ASPHALT SURFACE COURSE, MIX "D" N70 (2")
- A2 HOT-MIX ASPHALT BINDER COURSE, IL-19.0, N70 (8")
- B HOT-MIX ASPHALT SURFACE COURSE, MIX "D" N70 (2 1/4")
- C SHOULDER RUMBLE STRIPS, 16 INCH
- D TEMPORARY PAVEMENT (10")

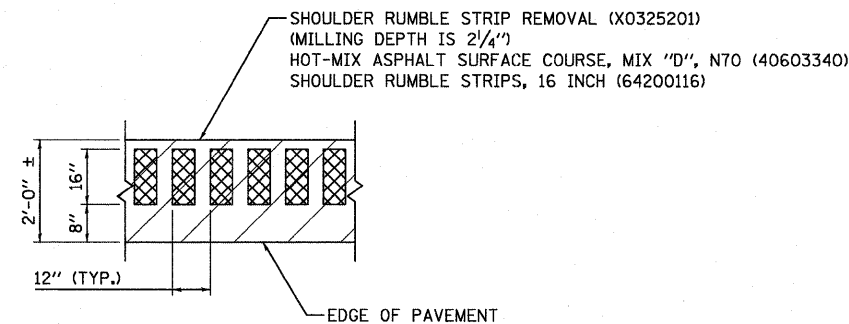

SHOULDER RUMBLE STRIP REMOVAL DETAIL

HOT-MIX ASPHALT MIXTURE REQUIREMENTS	
MIXTURE TYPE	AIR VOIDS
SHOULDER RUMBLE STRIP REPLACEMENT	
HOT-MIX ASPHALT SURFACE COURSE, MIX "D", N70 (IL-9.5mm) 2 1/4"	4% @ 70 Gyr.
CLASS D PATCH	
HOT-MIX ASPHALT SURFACE COURSE, MIX "D", N70 (IL-9.5mm) 2"	4% @ 70 Gyr.
HOT-MIX ASPHALT BINDER COURSE, IL-19.0, N70 8"	4% @ 70 Gyr.
DRIVEWAY PAVEMENT	
HOT-MIX ASPHALT SURFACE COURSE, MIX "D", N50 (IL-9.5mm) 2"	4% @ 50 Gyr.
HOT-MIX ASPHALT BASE COURSE (HMA BINDER IL-19mm) PE-6"; CE-8"	4% @ 50 Gyr.
TEMPORARY PAVEMENT	
HOT-MIX ASPHALT SURFACE COURSE, MIX "D", N50 (IL-9.5mm) 2"	4% @ 50 Gyr.
HOT-MIX ASPHALT BINDER, IL-19mm, N50 8"	4% @ 50 Gyr.

NOTE FOR TEMPORARY PAVEMENT:
When PCC Temporary Pavement is used as an option, it shall consist of Class PV Concrete meeting the requirements of Art. 1020 of the Standard Specifications; typically 10" thick.

THE UNIT WEIGHT USED TO CALCULATE ALL HMA SURFACE MIXTURE QUANTITIES IS:
112 LBS/SQ YD/IN.

The "AC Type" for Polymerized HMA Mixes SHALL BE "SBS/SBR PG 70-22" AND FOR NON-POLYMERIZED HMA THE "AC TYPE" shall be "PG 64-22" UNLESS modified by District ONE Special Provisions.

FOR "PERCENT OF RAP/RAS" SEE DISTRICT ONE SPECIAL PROVISIONS.

FILE NAME = ...\\D160P39-eh-typical.dgn



DESIGNED - ADW	REVISED - RJD 11/15/2011
DRAWN - GEW	REVISED - 2/14/2012, A.D.W.
CHECKED - RJD	REVISED -
DATE - 12/12/2011	REVISED -

STATE OF ILLINOIS
DEPARTMENT OF TRANSPORTATION

PALATINE ROAD OVER SALT CREEK
TYPICAL SECTIONS

SCALE: 1/2" = 5' (HORIZ) 1/4" = 10' (VERT) SHEET NO. 1 OF 1 SHEETS STA. TO STA.

F.A.U. RTE. 1285	SECTION 2011-033-T	COUNTY COOK	TOTAL SHEETS 18	SHEET NO. 4
			CONTRACT NO. 60P39	
[ILLINOIS] FED. AID PROJECT				

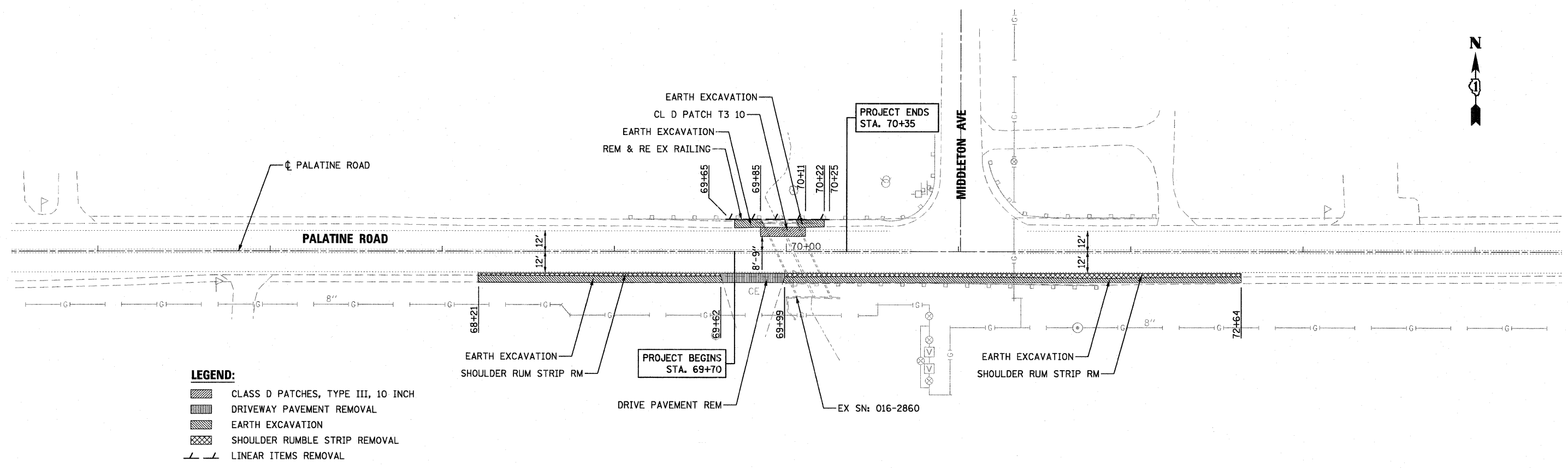

- LEGEND:**
- CLASS D PATCHES, TYPE III, 10 INCH
 - DRIVEWAY PAVEMENT REMOVAL
 - EARTH EXCAVATION
 - SHOULDER RUMBLE STRIP REMOVAL
 - LINEAR ITEMS REMOVAL

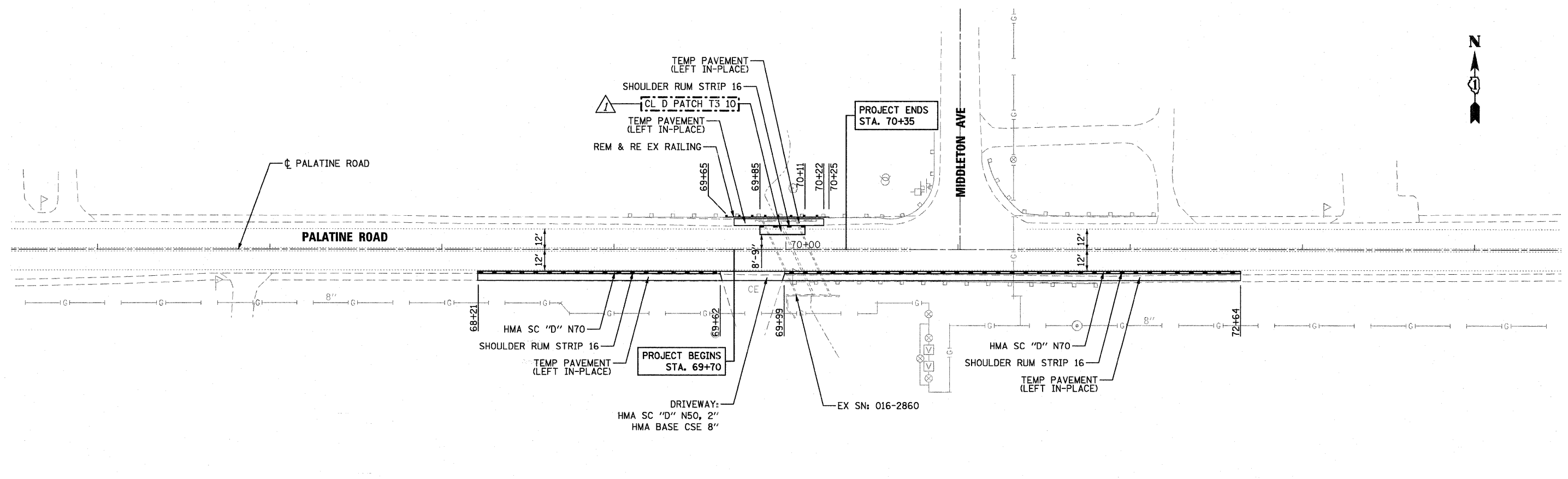

FILE NAME =
...D168P39-sht-plan.dgn



DESIGNED - ADW	REVISED - RJD 11/15/2011
DRAWN - GEW	REVISED - 2/14/2012, A.D.W.
CHECKED - RJD	REVISED -
DATE - 12/12/2011	REVISED -

**STATE OF ILLINOIS
DEPARTMENT OF TRANSPORTATION**

**PALATINE ROAD OVER SALT CREEK
EXISTING & PROPOSED PLAN**

SCALE: 1"=30' SHEET NO. 1 OF 1 SHEETS STA. 69+70 TO STA. 70+35

F.A.U. RTE. 1285	SECTION 2011-033-T	COUNTY COOK	TOTAL SHEETS 18	SHEET NO. 6
CONTRACT NO. 60P39			ILLINOIS FED. AID PROJECT	