

LEGEND

- ① TEMPORARY PAVEMENT MARKING LINE 4" WITH STEADY BURNING BI-DIRECTIONAL LIGHT
 - ② TEMPORARY PAVEMENT MARKING LINE 4"
 - ③ TEMPORARY PAVEMENT MARKING LINE 6"
 - ④ TEMPORARY PAVEMENT MARKING LINE 8"
 - ⑤ TEMPORARY PAVEMENT MARKING LINE 12"
 - ⑥ TEMPORARY PAVEMENT MARKING LINE 24"
 - ⑦ TEMPORARY PAVEMENT MARKING LETTERS & SYMBOLS
- IMPACT ATTENUATOR, TEMPORARY (NON-REDIRECTIVE) TEST LEVEL 2
 - ARROW BOARD
 - TYPE III BARRICADE
 - TRAFFIC SIGNAL & POST
 - TEMPORARY BARRIER
 - TEMPORARY PAVEMENT
 - WORK ZONE

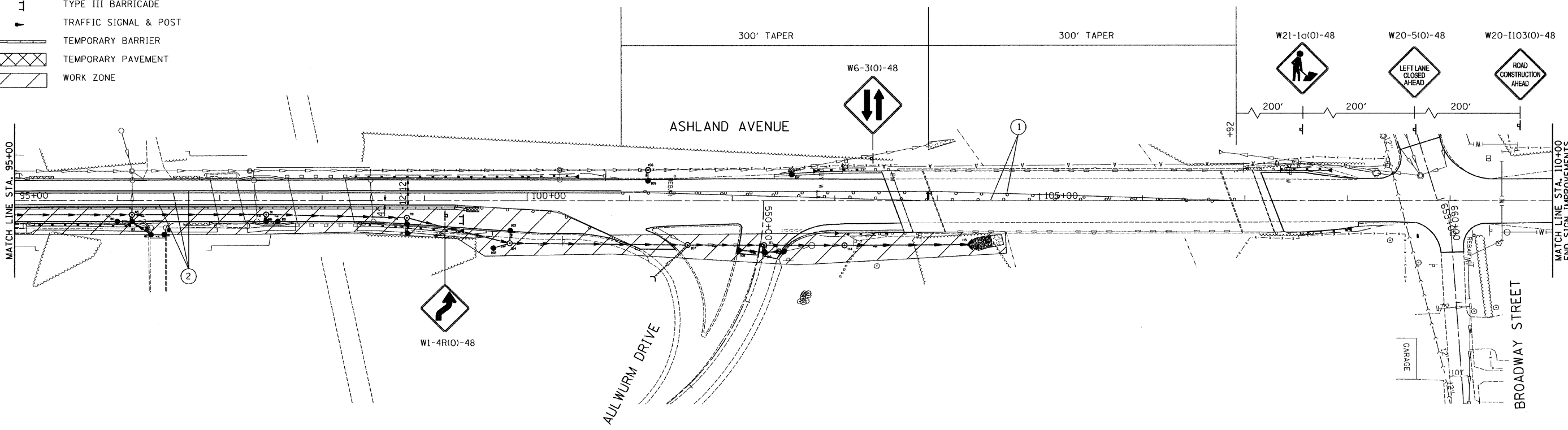

FILE NAME = #FILE#	USER NAME = .USER.	DESIGNED - EF	REVISED -	STATE OF ILLINOIS DEPARTMENT OF TRANSPORTATION	ASHLAND AVE. (THORNTON RD. - BROADWAY ST.) MAINTENANCE OF TRAFFIC - STAGE 1		F.A.U. RTE.	SECTION	COUNTY	TOTAL SHEETS	SHEET NO.
	PLOT SCALE = 50.0000' / IN.	CHECKED - RS	REVISED -				2857	2011-054-1	COOK	81	34
	PLOT DATE = 12/28/2011	DATE - 12-28-2011	REVISED -				CONTRACT NO. 60P24				
							ILLINOIS FED. AID PROJECT				
					SCALE: 1"=50'	SHEET NO. 2 OF 2 SHEETS	STA. 80+00	TO STA. 110+00			