

**LEGEND**

- ① TEMPORARY PAVEMENT MARKING LINE 4" WITH STEADY BURNING BI-DIRECTIONAL LIGHT
- ② TEMPORARY PAVEMENT MARKING LINE 4"
- ③ TEMPORARY PAVEMENT MARKING LINE 6"
- ④ TEMPORARY PAVEMENT MARKING LINE 8"
- ⑤ TEMPORARY PAVEMENT MARKING LINE 12"
- ⑥ TEMPORARY PAVEMENT MARKING LINE 24"
- ⑦ TEMPORARY PAVEMENT MARKING LETTERS & SYMBOLS

- IMPACT ATTENUATOR, TEMPORARY (NON-REDIRECTIVE) TEST LEVEL 2
- ARROW BOARD
- TYPE III BARRICADE
- TRAFFIC SIGNAL & POST
- TEMPORARY BARRIER
- TEMPORARY PAVEMENT
- WORK ZONE

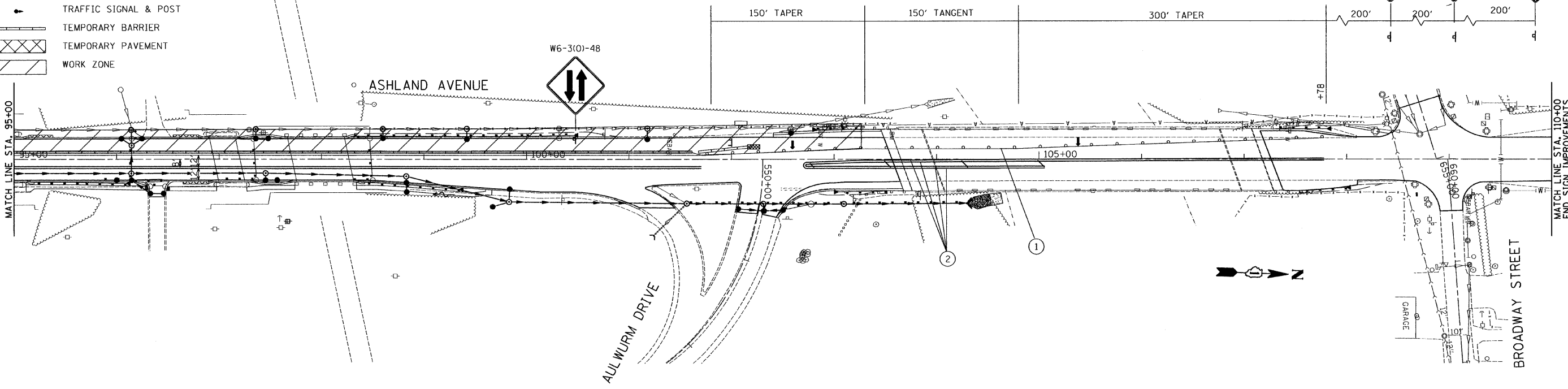

FILE NAME =	USER NAME = JUSER	DESIGNED - EF	REVISED -	<b>STATE OF ILLINOIS DEPARTMENT OF TRANSPORTATION</b>	<b>ASHLAND AVE. (THORNTON RD. - BROADWAY ST.) MAINTENANCE OF TRAFFIC - STAGE 2</b>	F.A.U. RTE.	SECTION	COUNTY	TOTAL SHEETS	SHEET NO.	
#FILEL#	PLOT SCALE = 50.0000' / IN.	DRAWN - EF	REVISED -			2857	2011-054-1	COOK	81	36	
	PLOT DATE = 12/28/2011	CHECKED - RS	REVISED -			CONTRACT NO. 60P24					
		DATE - 12-28-2011	REVISED -			ILLINOIS FED. AID PROJECT					
					SCALE: 1"=50'	SHEET NO. 2 OF 2 SHEETS		STA. 80+00 TO STA. 110+00			