



LEGEND

-  PAVEMENT REMOVAL
-  TEMPORARY PAVEMENT **
-  TRAFFIC LANE
- ① TEMPORARY PAVEMENT MARKING
DOUBLE YELLOW CENTERLINE, 4"
- ② TEMPORARY PAVEMENT MARKING
EDGE LINE, 4" WHITE
- ③ TEMPORARY CONCRETE BARRIER
- ④ VERTICAL PANELS OR DRUMS
WITH STEADY BURNING LIGHT
- ⑤ EXISTING PAVEMENT
- ⑥ PROPOSED POLYMERIZED HOT-MIX ASPHALT SURFACE COURSE,
STONE MATRIX ASPHALT, N80, 2"
- ⑦ PROPOSED POLYMERIZED HOT-MIX ASPHALT BINDER COURSE,
STONE MATRIX ASPHALT, N80, 2"
- ⑧ PROPOSED POLYMERIZED HOT-MIX ASPHALT BINDER COURSE,
IL-19, N90, 5/4"
- ⑨ PROPOSED AGGREGATE SUBGRADE, 12"
- ⑩ PROPOSED RETAINING WALL
- ⑪ PROPOSED HOT-MIX ASPHALT SHOULDER, 4'
- ⑫ PROPOSED HOT-MIX ASPHALT SHOULDER, 6'
- ⑬ PROPOSED HOT-MIX ASPHALT SHOULDER, 8'
- ⑭ PROPOSED STEEL PLATE BEAM GUARDRAIL
- ⑮ PROPOSED GRADING AND SHAPING DITCHES

STAGE II

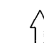
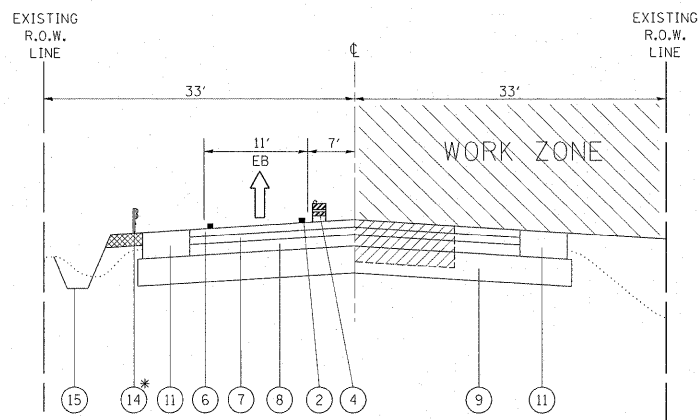

NOTE:
 * PROPOSED STEEL PLATE BEAM GUARDRAIL
 STA. 19+00 TO STA. 22+26
 ** TEMPORARY PAVEMENT
 STA. 16+01 TO STA. 18+89

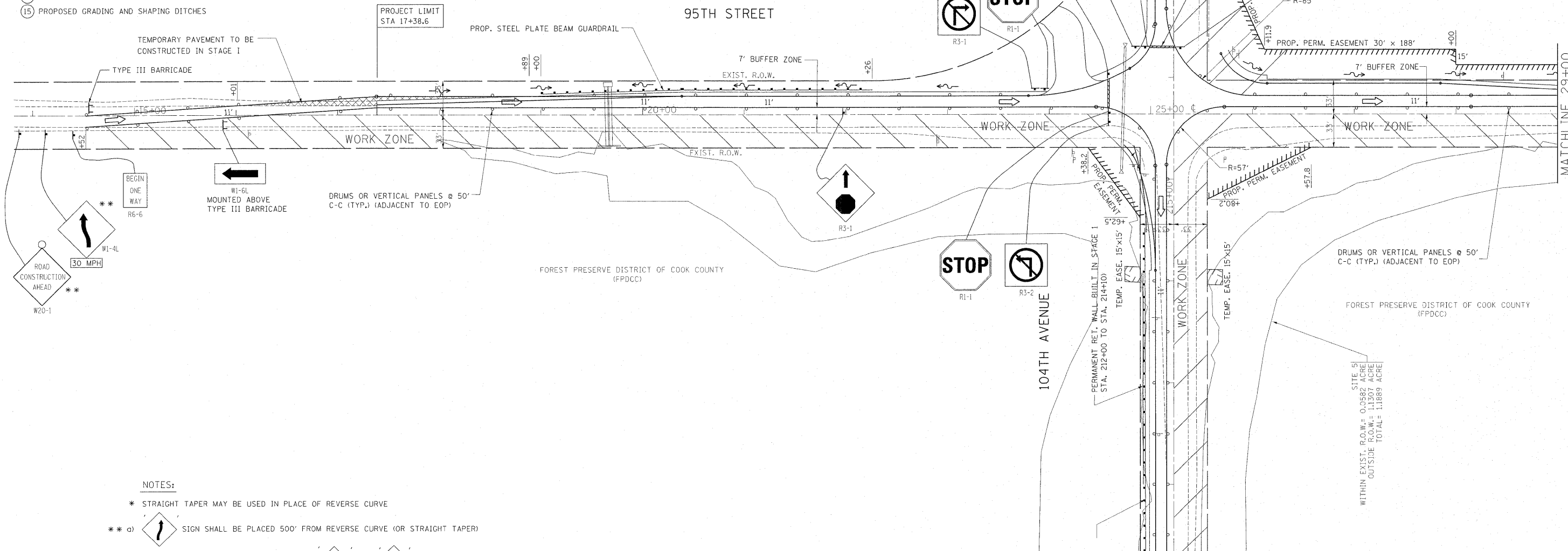

**STAGE II TYPICAL SECTION (95TH ST.)
 STA. 14+52 TO STA. 25+22.4**

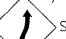

NOTES:

- * STRAIGHT TAPER MAY BE USED IN PLACE OF REVERSE CURVE
- ** a)  SIGN SHALL BE PLACED 500' FROM REVERSE CURVE (OR STRAIGHT TAPER)
- b) THERE SHALL BE 500' SPACING BETWEEN  AND  SIGNS

FILE NAME =	USER NAME = steedpa	DESIGNED -	REVISED -
ct:\pw_work\p14\dot\stedpa\d0159915\p144499-Design.dgn		DRAWN -	REVISED -
PLOT SCALE = 50.0000' / 1"		CHECKED -	REVISED -
PLOT DATE = 12/6/2011		DATE -	REVISED -

**STATE OF ILLINOIS
 DEPARTMENT OF TRANSPORTATION**

**SUGGESTED STAGING AND TRAFFIC CONTROL PLAN - STAGE II
 95th STREET @ 104th AVENUE / FLAVIN ROAD**

SCALE: SHEET NO. OF SHEETS STA. TO STA.

F.A.U. RTE. 1566	SECTION 29 R-N-1	COUNTY COOK	TOTAL SHEETS 120	SHEET NO. 26
CONTRACT NO. 62377				
ILLINOIS FED. AID PROJECT				