

F.A.P. RTE.	SECTION	COUNTY	TOTAL SHEETS	SHEET NO.
856	01-00170-26-TL	WILL	171	84
STA.		TO STA.		
FED. ROAD DIST. NO.		ILLINOIS	FED. AID PROJECT	
CONTRACT NO: 63570				

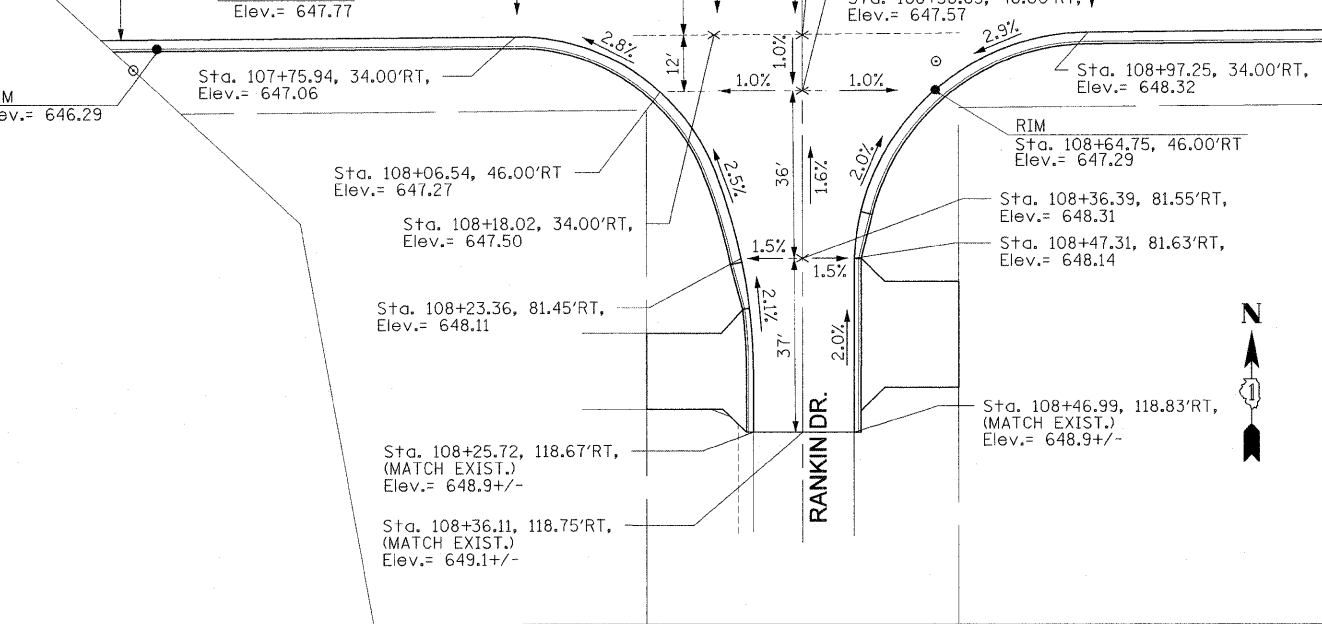
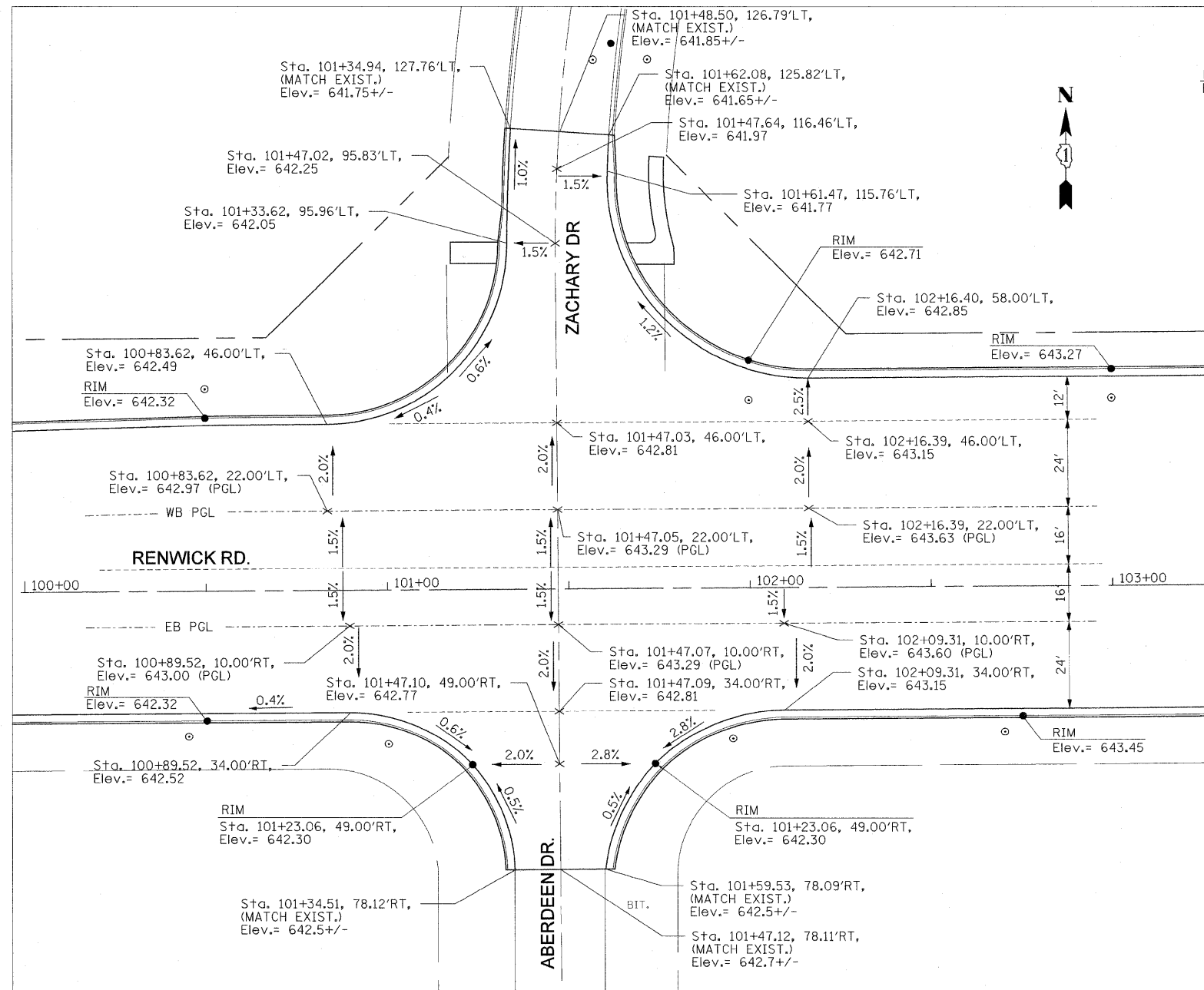
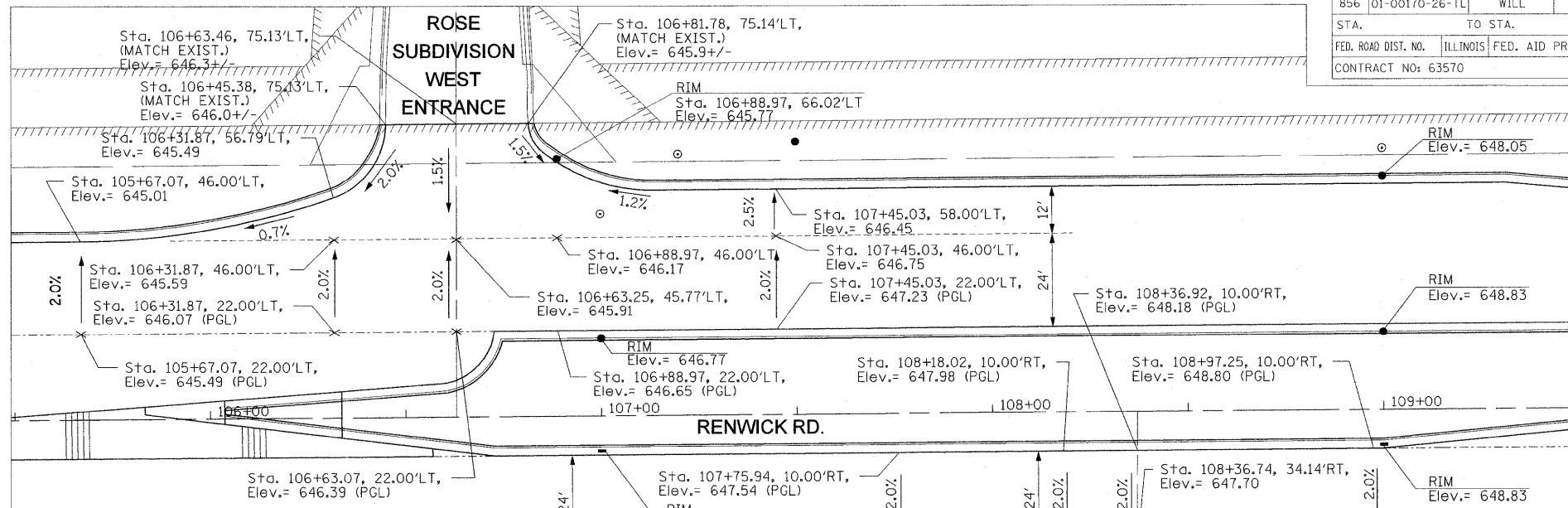

**GRADING PLAN**  
**RANKIN DRIVE / ROSE SUBDIVISION**  
**WEST ENTRANCE AND RENWICK ROAD**

- NOTES:
1. RIM ELEVATIONS FOR STRUCTURES ARE SHOWN AT THE EDGE OF PAVEMENT.
  2. SEE TYPICAL SECTIONS AND CROSS-SECTION SHEETS FOR MEDIAN ELEVATIONS AND TYPICAL SLOPES.

**GRADING PLAN**  
**ZACHARY DRIVE / ABERDEEN DRIVE**  
**AND RENWICK ROAD**

REVISIONS	
NAME	DATE

ILLINOIS DEPARTMENT OF TRANSPORTATION  
**INTERSECTION GRADING PLAN**  
 SHEET 1 OF 2

SCALE: 1" = 20'  
 DATE: APRIL, 2011  
 DRAWN BY: MXF  
 CHECKED BY: MFB

8/22/2011 P:\179766\cadd\drawings\0846\grading\plan01.dgn