

F.A.P. RTE.	SECTION	COUNTY	TOTAL SHEETS	SHEET NO.
856	01-00170-26-TL	WILL	171	88
STA. 112+00		TO STA. 142+00		
FED. ROAD DIST. NO.		ILLINOIS	FED. AID PROJECT	
CONTRACT NO: 63570				

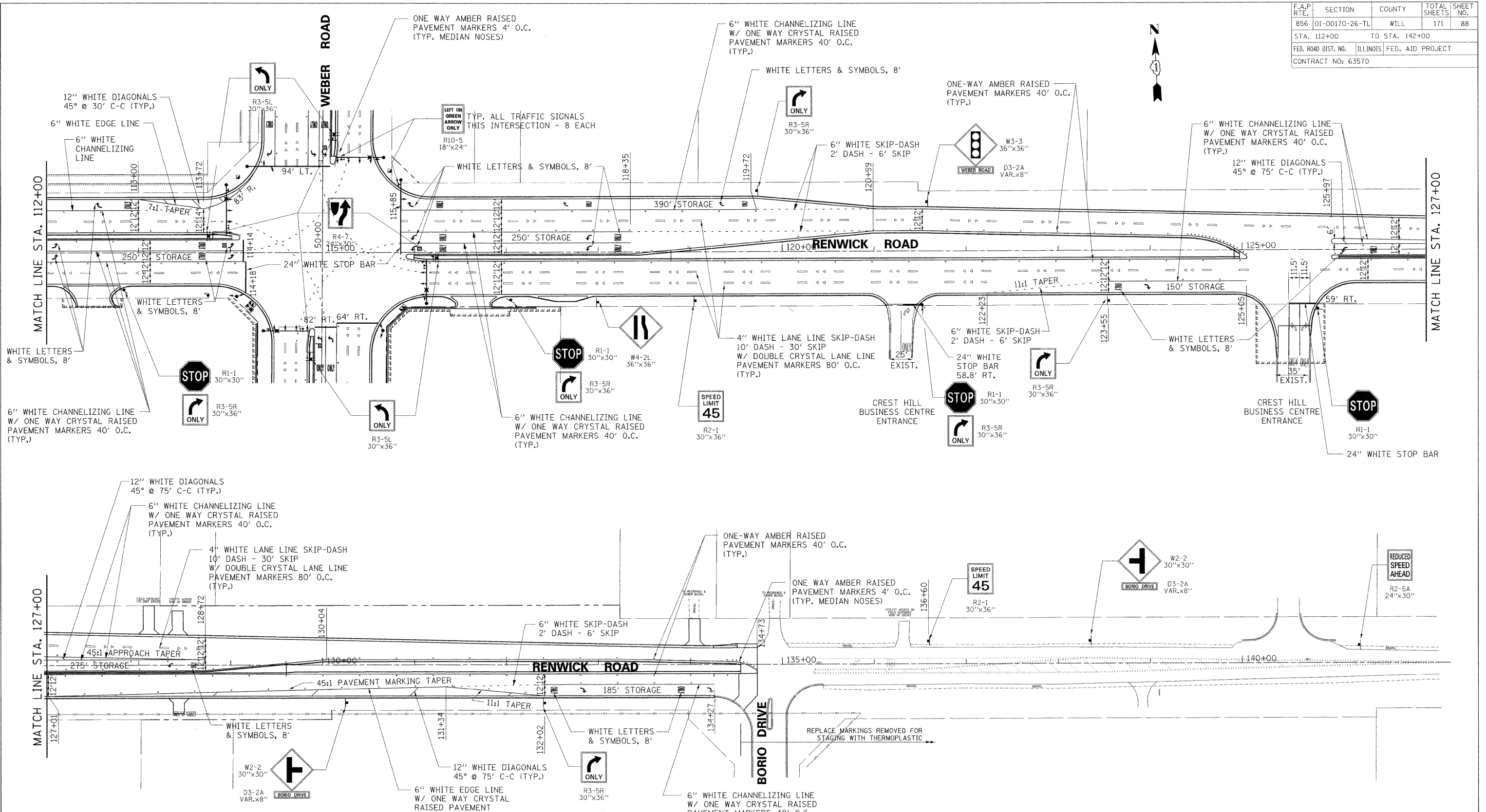

**NOTES:**

ALL PAVEMENT MARKINGS ON PCC ARE POLYUREA TYPE I.

ALL PAVEMENT MARKINGS ON HOT MIX ASPHALT ARE THERMOPLASTIC.

REFER TO DISTRICT STANDARD TC-11 AND IDOT STANDARD 781001 FOR RAISED REFLECTIVE PAVEMENT MARKER DETAILS.

RAISED REFLECTIVE PAVEMENT MARKERS ADJACENT TO WHITE SKIP DASH AND CENTERLINES SHALL BE OFFSET 4 INCHES TOWARD TRAFFIC.

SIGN LOCATIONS AND ORIENTATIONS WILL BE DETERMINED BY THE ENGINEER.

REFER TO DISTRICT STANDARD TC-13 FOR PAVEMENT MARKING DETAILS.

- LEGEND**
- ONE WAY CRYSTAL RAISED PAVEMENT MARKER
  - ONE WAY AMBER RAISED PAVEMENT MARKER
  - TWO WAY AMBER RAISED PAVEMENT MARKER
  - PROPOSED SIGN
  - PROPOSED TRAFFIC SIGNAL MAST ARM
  - PROPOSED TRAFFIC SIGNAL POLE

REVISIONS	
NAME	DATE

ILLINOIS DEPARTMENT OF TRANSPORTATION

**RENWICK ROAD**  
PAVEMENT MARKING & SIGNING PLAN  
STA. 112+00 TO STA. 142+00

SCALE: 1" = 50'

DATE: APRIL, 2011

DRAWN BY: CJO  
CHECKED BY: MFB

8/22/2011 P:\179766\ceda\dr\awings\088pavemark.dgn