

F.A.P. RTE.	SECTION	COUNTY	TOTAL SHEETS	SHEET NO.
856	01-00170-26-TL	WILL	171	106
STA.		TO STA.		
FED. ROAD DIST. NO.	ILLINOIS	FED. AID PROJECT		
CONTRACT NO: 63570				

NOTES:

1. THE PROPOSED TRAFFIC SIGNAL CONTROLLERS AT THE RYAN DRIVE AND RENWICK ROAD INTERSECTIONS AND THE EXISTING TRAFFIC SIGNAL CONTROLLER AT THE GASKIN DRIVE/GRAND HAVEN CIRCLE INTERSECTION ARE PART OF THE WEBER ROAD FIBER OPTIC TRAFFIC SIGNAL SYSTEM THAT EXTENDS FROM DIVISION STREET IN THE SOUTH TO LILY CACHE LANE IN THE NORTH.
2. MASTER CONTROLLERS IN THE WEBER ROAD TRAFFIC SIGNAL SYSTEM ARE LOCATED AT THE TAYLOR ROAD AND NORMANTOWN ROAD INTERSECTIONS.

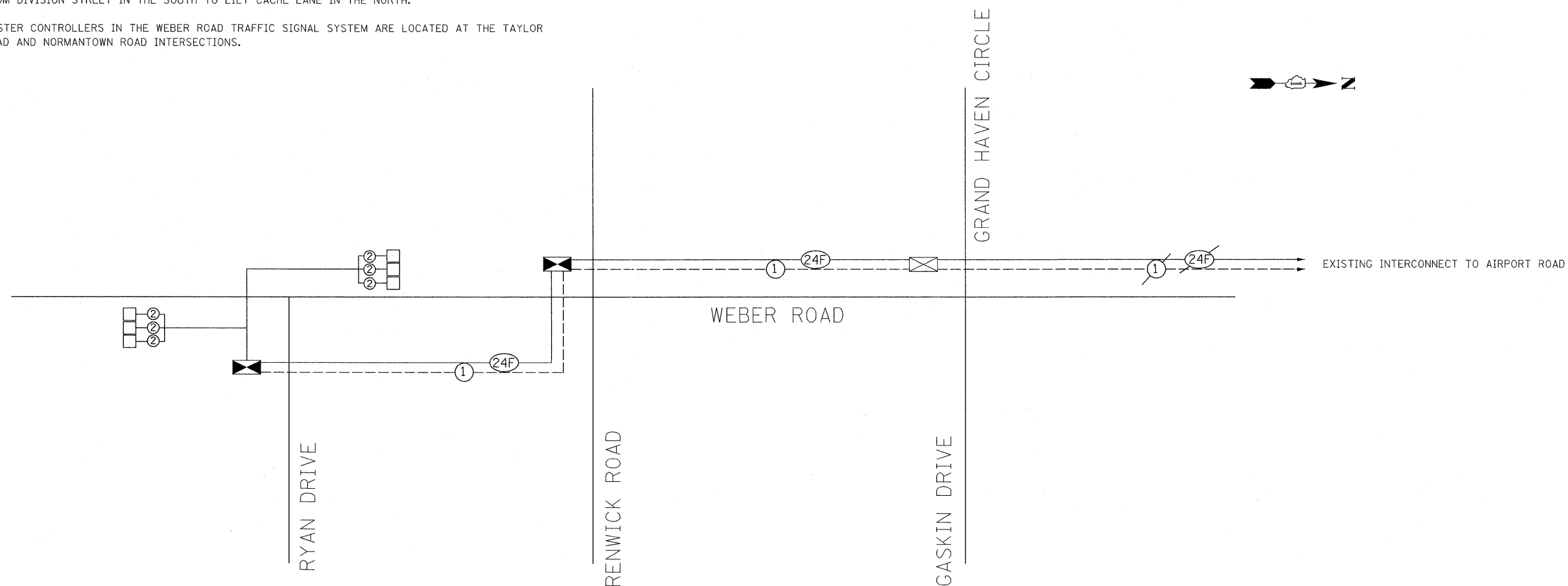

INTERCONNECT SCHEDULE OF QUANTITIES

QTY	UNIT	ITEM DESCRIPTION
1971	FOOT	UNDERGROUND CONDUIT, GALVANIZED STEEL, 2" DIA.
3	EACH	HANDHOLE
3117	FOOT	FIBER OPTIC CABLE IN CONDUIT, NO. 62.5/125, MM12F SM 12F
3068	FOOT	ELECTRIC CABLE IN CONDUIT, TRACER NO. 14 1C
1	EACH	DRILL EXISTING HANDHOLE

REVISIONS	
NAME	DATE

ILLINOIS DEPARTMENT OF TRANSPORTATION
**INTERCONNECT SCHEMATIC
AND SCHEDULE OF QUANTITIES
WEBER ROAD
FROM RYAN DRIVE TO GASKIN DRIVE**

SCALE: 1"=20'
DATE: APRIL, 2011

DRAWN BY: JJS
CHECKED BY: MFB