

Notes:
 See sheet 7 of 18 for Sections C-C & D-D and View E-E.
 a₁(E) and a₁(E) bar spacings measured along ϕ Rdwy.
 See sheet 5 of 18 for Curb Details.
 See sheets 8 and 9 of 18 for Railing Details.
 See sheet 7 of 18 for location of Detail A.

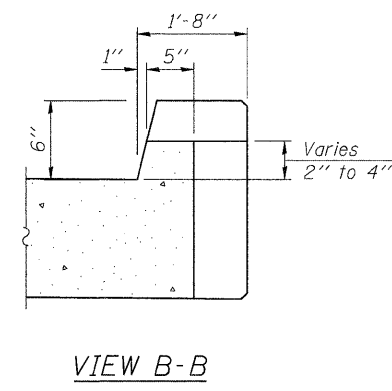
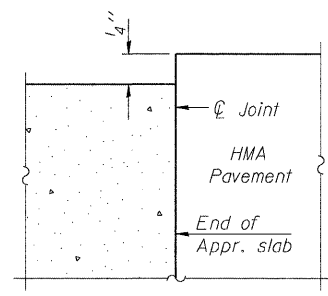
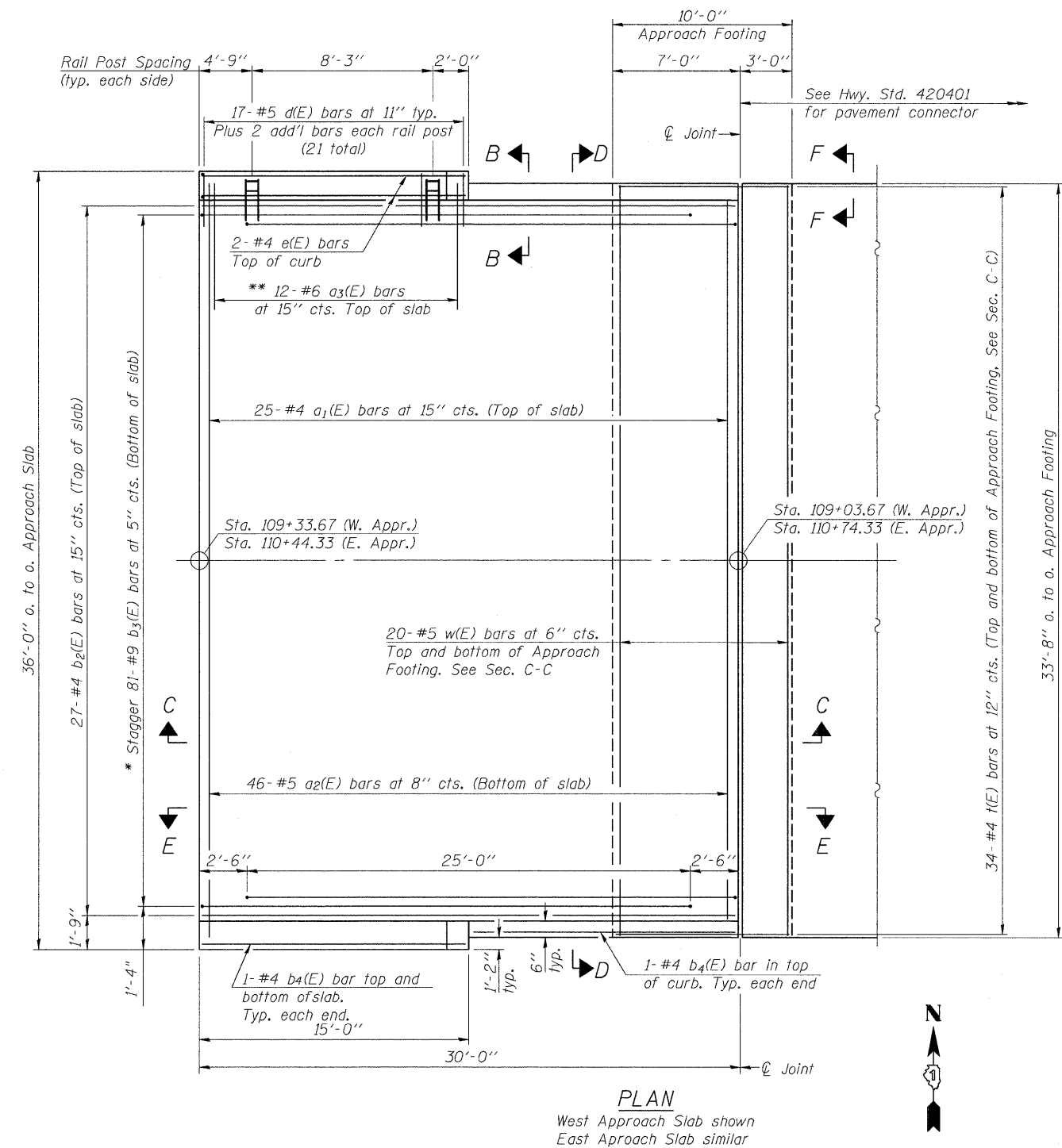

* Tilt #9 b₃(E) bars as required to maintain clearance.
 ** Space between a₁(E) bars, typ. ea. curb.

FILE NAME = w:\p1\6800-6859\6842\007\micron\cadd\sheet\structure\056-3192-63666-006-BAP.dgn

1170 SOUTH HOUBOLT ROAD JOLIET, ILLINOIS 60431 (815) 744-4200	USER NAME = brianf	DESIGNED RRD	REVISED -	MCHENRY COUNTY DIVISION OF TRANSPORTATION HILL ROAD BRIDGE OVER NORTH BRANCH NIPPERSINK CREEK	BRIDGE APPROACH SLAB DETAILS (1 OF 2) STRUCTURE NO. 056-3192	TR	SECTION	COUNTY	TOTAL SHEETS	SHEET NO.
	PLOT SCALE =	CHECKED AJS	REVISED -			21	08-00356-00-BR	MCHENRY	67	36
PLOT DATE = 1/3/2012	DRAWN BJF	REVISED -		SHEET NO. 6 OF 18 SHEETS		CONTRACT NO. 63666				
	CHECKED RRD	REVISED -				ILLINOIS FED. AID PROJECT				