

PLAN	SURVEYED	BY	DATE
	PLOTTED		
	CHECKED		
	REVISIONS		
	NO. OF WAY CHECKED		
	CADD FILE NAME		

PROFILE	SURVEYED	BY	DATE
	PLOTTED		
	CHECKED		
	REVISIONS		
	NO. OF WAY CHECKED		
	CADD FILE NAME		

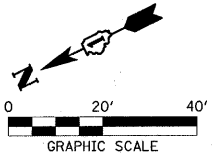
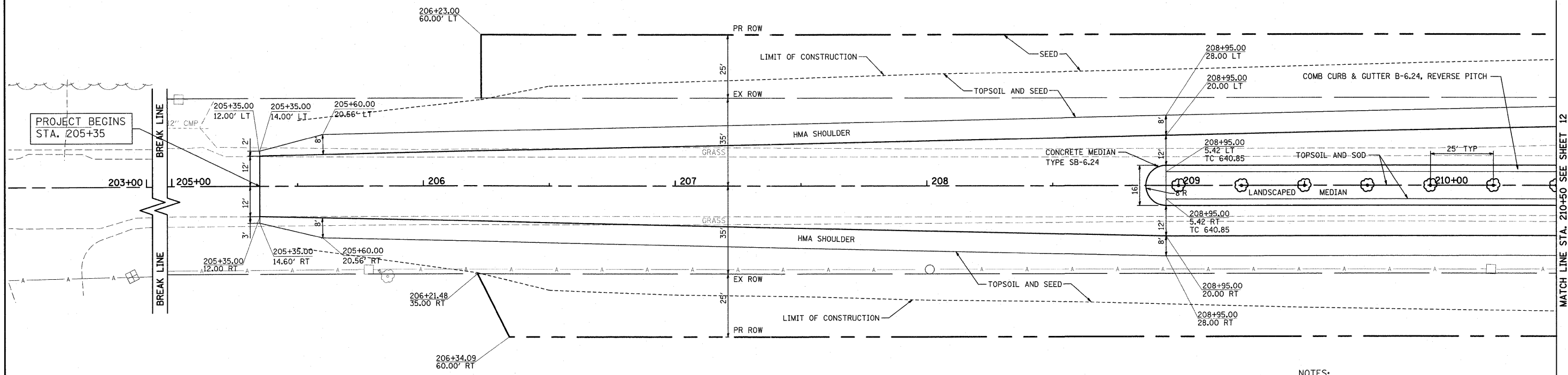

PLAINFIELD NAPERVILLE ROAD

- NOTES:
1. ALL EXISTING PAVEMENT TO BE REMOVED.
 2. PROPOSED ϕ ELEVATIONS HAVE BEEN ESTABLISHED WITHOUT CONSIDERATION OF RAISED MEDIAN IN ORDER TO PROVIDE A UNIFORM PROFILE.
- AT LOCATIONS WITHOUT MEDIAN, PROFILE ELEVATION IS ACTUAL PROPOSED ϕ ELEVATION.
- AT LOCATIONS WITH MEDIAN, PROFILE ELEVATION IS WHAT PROPOSED ϕ ELEVATION WOULD BE WITHOUT MEDIAN.

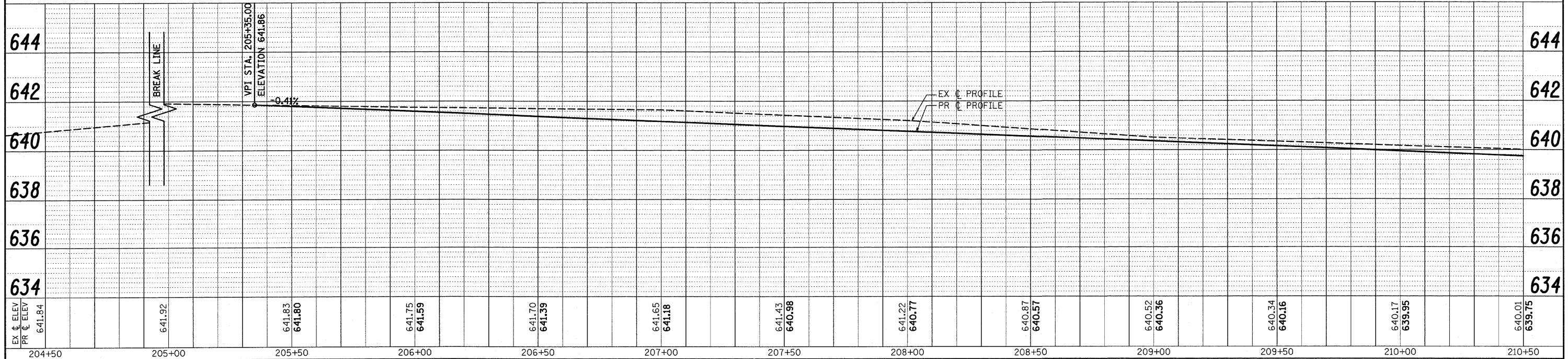

FILE NAME =	USER NAME = #USER#	DESIGNED - CM	REVISED -		ROADWAY PLAN & PROFILE PLAINFIELD NAPERVILLE RD AT 119TH ST / RODEO DR	F.A.U. RTE.	SECTION	COUNTY	TOTAL SHEETS	SHEET NO.
P:\070116\cad\phase 2\dwg\070116-sht-plain	pp01.dgn	DRAWN - JM	REVISED -			324	04-00036-22-TL	WILL	152	11
PLOT SCALE = #SCALE#		CHECKED - CM	REVISED -			CONTRACT NO.				
PLOT DATE = 1/5/2012		DATE - FEBRUARY 2009	REVISED -			ILLINOIS FED. AID PROJECT				

STATE OF ILLINOIS
DEPARTMENT OF TRANSPORTATION

SCALE: 1" = 20'

SHEET NO. 1 OF 8 SHEETS STA. 204+50 TO STA. 210+50

ILLINOIS FED. AID PROJECT