

BENCHMARK "H"
 "H" ON LIGHT POLE BASE AT NE CORNER OF
 FIRST SOUTH ENTRANCE TO PLAINFIELD EAST
 HIGH SCHOOL AND NAPERVILLE ROAD BY SCHOOL SIGN.
 ELEVATION 637.49

| | | |
|------|--------------------|------|
| PLAN | SURVEYED | DATE |
| | PLOTTED | |
| | CHECKED | |
| | BY | |
| | NO. OF WAY CHECKED | |
| | NO. | |
| | DATE | |
| | FILE NAME | |

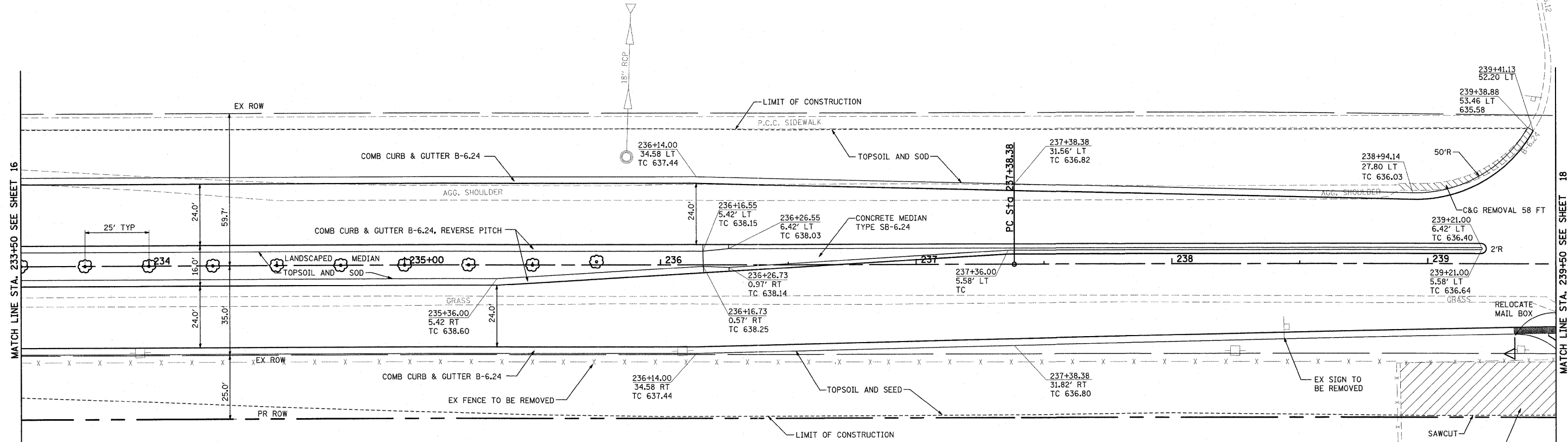

- NOTES:
1. ALL EXISTING PAVEMENT TO BE REMOVED.
 2. PROPOSED ϕ ELEVATIONS HAVE BEEN ESTABLISHED WITHOUT CONSIDERATION OF RAISED MEDIAN IN ORDER TO PROVIDE A UNIFORM PROFILE.
- AT LOCATIONS WITHOUT MEDIAN, PROFILE ELEVATION IS ACTUAL PROPOSED ϕ ELEVATION.
- AT LOCATIONS WITH MEDIAN, PROFILE ELEVATION IS WHAT PROPOSED ϕ ELEVATION WOULD BE WITHOUT MEDIAN.

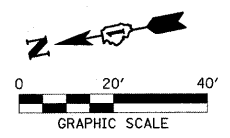

PLAINFIELD NAPERVILLE ROAD

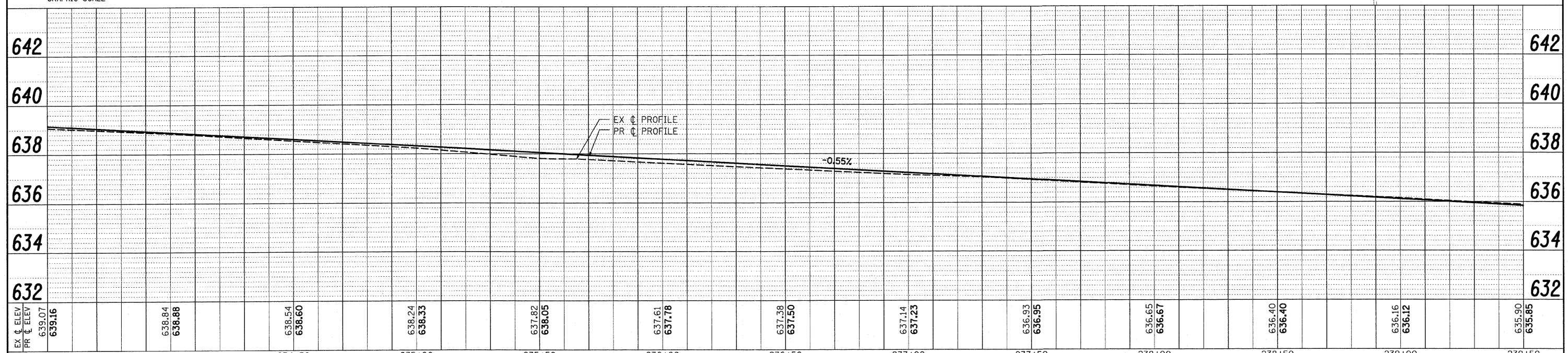

| | | |
|---------|--------------------|------|
| PROFILE | SURVEYED | DATE |
| | PLOTTED | |
| | CHECKED | |
| | BY | |
| | NO. OF WAY CHECKED | |
| | NO. | |
| | DATE | |
| | FILE NAME | |

| | | | | | | | | | | | | |
|---|----------------------|----------------------|-----------|---|--|---------------------------|----------------|-------------|---------|--------|--------------|-----------|
| FILE NAME = | USER NAME = #USER# | DESIGNED - CM | REVISED - | STATE OF ILLINOIS DEPARTMENT OF TRANSPORTATION | | ROADWAY PLAN & PROFILE | | F.A.U. RTE. | SECTION | COUNTY | TOTAL SHEETS | SHEET NO. |
| pr:\070116\cad\phase 2\dwg\070116-shr-plain | pp07.dgn | DRAWN - JM | REVISED - | | | 324 | 04-00036-22-TL | WILL | 152 | 17 | | |
| PLOT SCALE = #SCALE# | DATE - FEBRUARY 2009 | CHECKED - CM | REVISED - | | | CONTRACT NO. 63671 | | | | | | |
| PLOT DATE = 1/5/2012 | | DATE - FEBRUARY 2009 | REVISED - | | | ILLINOIS FED. AID PROJECT | | | | | | |