

PLAN	SURVEYED	DATE
	PLOTTED	
	NOTED	
	BY	
	NO.	
	DATE	

PROFILE	SURVEYED	DATE
	PLOTTED	
	NOTED	
	BY	
	NO.	
	DATE	

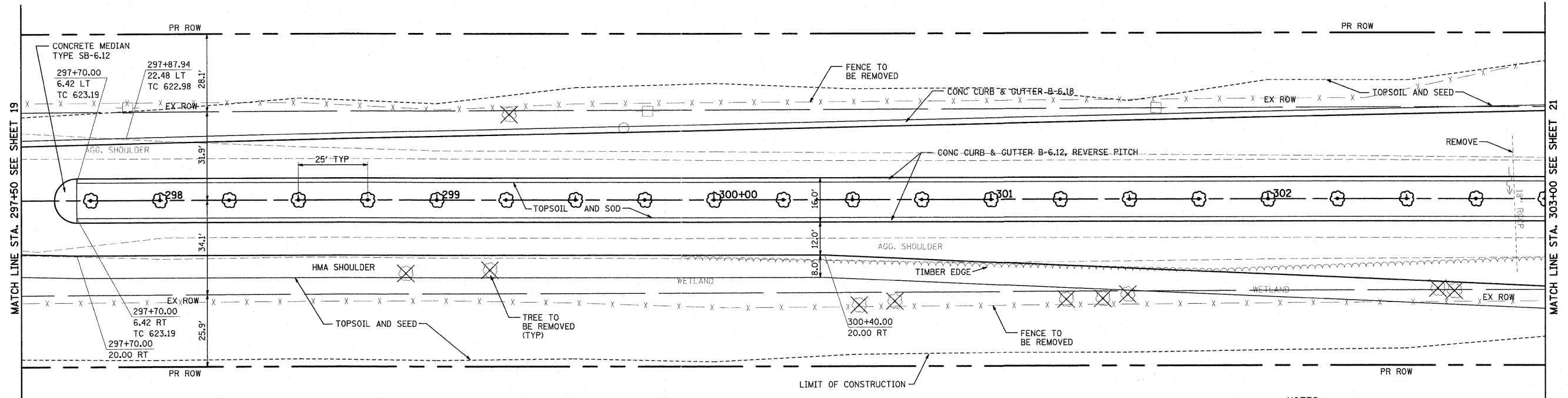
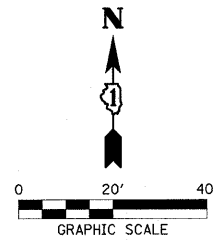

- NOTES:
1. ALL EXISTING PAVEMENT TO BE REMOVED.
 2. PROPOSED ϕ ELEVATIONS HAVE BEEN ESTABLISHED WITHOUT CONSIDERATION OF RAISED MEDIAN IN ORDER TO PROVIDE A UNIFORM PROFILE.
- AT LOCATIONS WITHOUT MEDIAN, PROFILE ELEVATION IS ACTUAL PROPOSED ϕ ELEVATION.
- AT LOCATIONS WITH MEDIAN, PROFILE ELEVATION IS WHAT PROPOSED ϕ ELEVATION WOULD BE WITHOUT MEDIAN.

119TH STREET

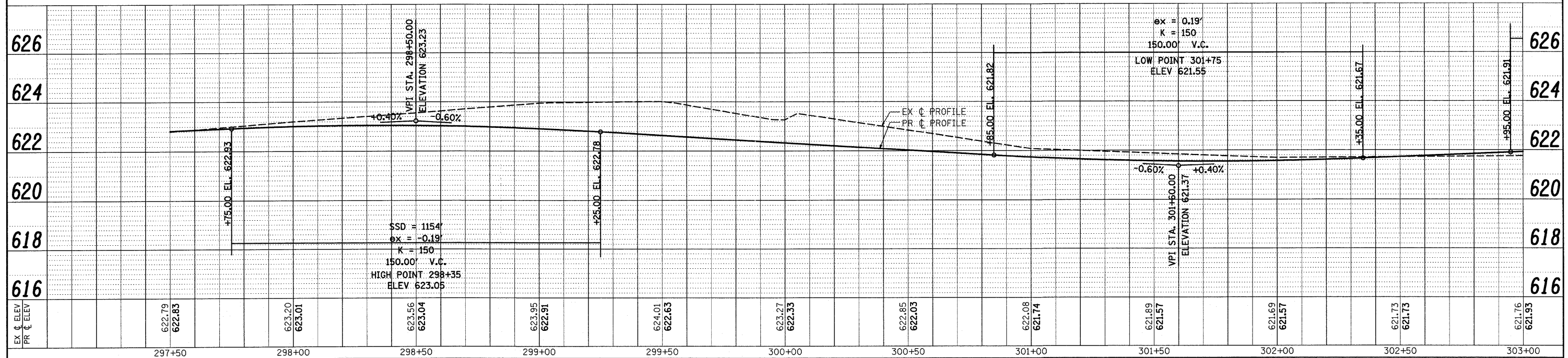

FILE NAME =	USER NAME = #USER#	DESIGNED - CM	REVISED -		ROADWAY PLAN & PROFILE PLAINFIELD NAPERVILLE RD AT 119TH ST / RODEO DR	F.A.U. RTE.	SECTION	COUNTY	TOTAL SHEETS	SHEET NO.	
pa:\070116\oad\phase 2\dwg\070116-sht-119th	pp02.dgn	DRAWN - JM	REVISED -			3767	04-00036-22-TL	WILL	152	20	
PLOT SCALE = #SCALE#	DATE = FEBRUARY 2009	CHECKED - CM	REVISED -			CONTRACT NO. 63671					
PLOT DATE = 1/5/2012	DATE = FEBRUARY 2009	REVISED -	REVISED -			ILLINOIS FED. AID PROJECT					

STATE OF ILLINOIS
DEPARTMENT OF TRANSPORTATION

SCALE: 1" = 20'

SHEET NO. 2 OF 7 SHEETS | STA. 297+50 TO STA. 303+00