

NOTES:
 1. TEMPORARY CONCRETE BARRIER OFFSETS ARE MEASURED TO THE TRAFFIC SIDE OF THE WALL.

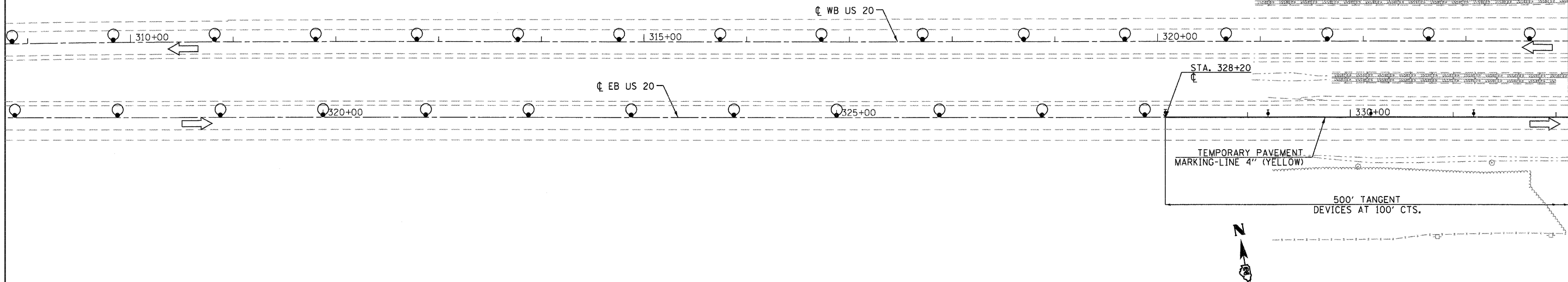

MATCHLINE STA. 324+00

LEGEND

- ARROW BOARD
- WORK AREA
- SIGN
- DIRECTION INDICATOR BARRICADE WITH STEADY BURN MONODIRECTIONAL LIGHT
- TYPE II BARRICADE, DRUM, OR VERTICAL BARRICADE WITH STEADY BURN MONODIRECTIONAL LIGHT
- TYPE III BARRICADE
- TEMPORARY CONCRETE BARRIER
- MONODIRECTIONAL BARRIER WALL/GUARDRAIL MARKER
- IMPACT ATTENUATOR
- DIRECTION OF TRAFFIC
- TEMPORARY PAVEMENT
- DRUMS WITH STEADY BURNING MONODIRECTIONAL LIGHT
- MILL AND RESURFACE

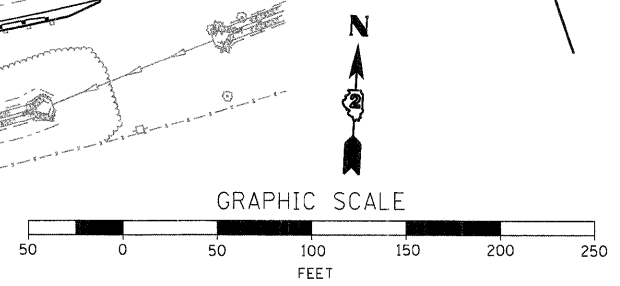
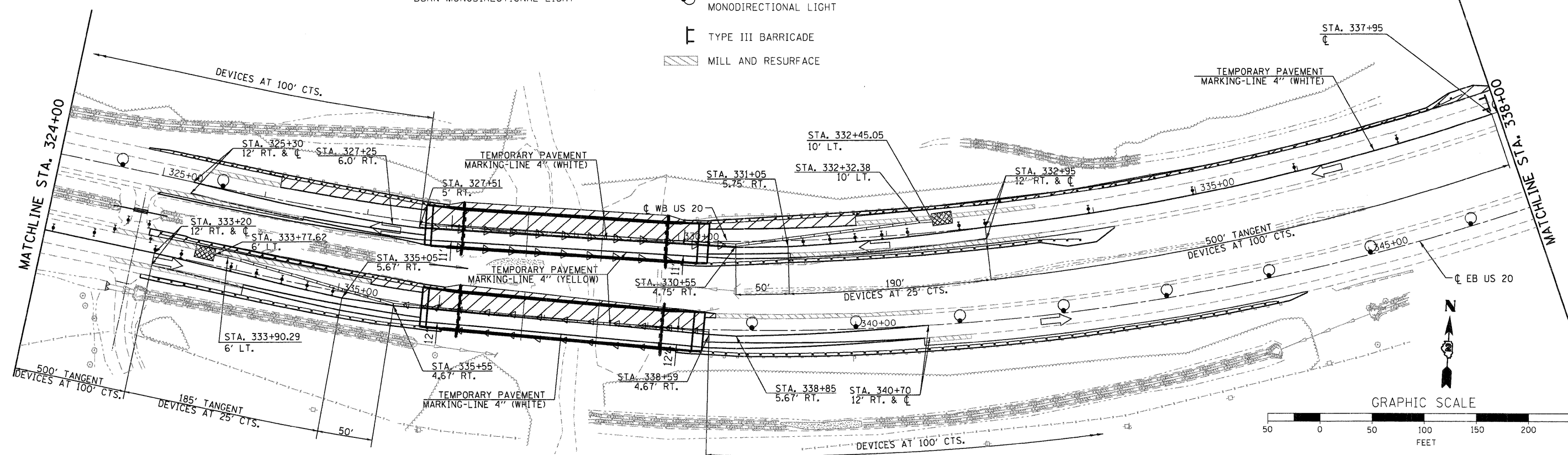
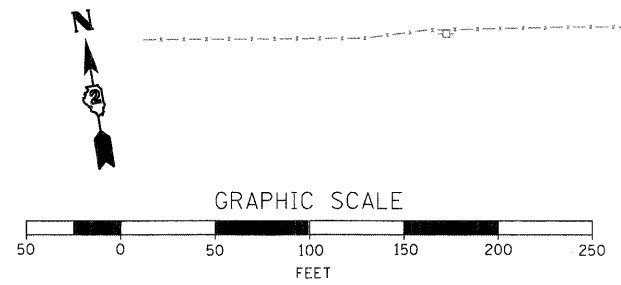

USER NAME = gjameson	DESIGNED -	REVISED -	 1701 ROUTE 35 NORTH EAST DUBUQUE, IL 61025 (815) 747-8833 DESIGN FIRM #184001036	STATE OF ILLINOIS DEPARTMENT OF TRANSPORTATION	US 20 TRAFFIC CONTROL PLANS (STAGE 2) SN 043-0004 & SN 043-0005			F.A.P. RTE.	SECTION	COUNTY	TOTAL SHEETS	SHEET NO.
FILE NAME = Z03207-shr-staging-64504005.dgn	DRAWN -	REVISED -			301	(43B,44B,44HB,45B)	JO DAVIESS	309	66			
PLOT DATE = 12/6/2011	CHECKED -	REVISED -			CONTRACT NO. 64C94			ILLINOIS FED. AID PROJECT				
PLOT TIME = 10:18:47 AM					SCALE: 1"=50'			SHEET NO. 1 OF 2 SHEETS		STA. 310+00 TO STA. 338+00		