

- ↑ ARROW BOARD
- ▨ WORK AREA
- ⊥ SIGN
- ⬆ DIRECTION INDICATOR BARRICADE WITH STEADY BURN MONODIRECTIONAL LIGHT
- ⬇ TYPE II BARRICADE, DRUM, OR VERTICAL BARRICADE WITH STEADY BURN MONODIRECTIONAL LIGHT
- ▨ MILL AND RESURFACE

LEGEND

- ▬ TEMPORARY CONCRETE BARRIER
- ◁ MONODIRECTIONAL BARRIER WALL/GUARDRAIL MARKER
- ▨ IMPACT ATTENUATOR
- ← DIRECTION OF TRAFFIC
- ▨ TEMPORARY PAVEMENT
- ⊙ DRUMS WITH STEADY BURNING MONODIRECTIONAL LIGHT
- ⊥ TYPE III BARRICADE

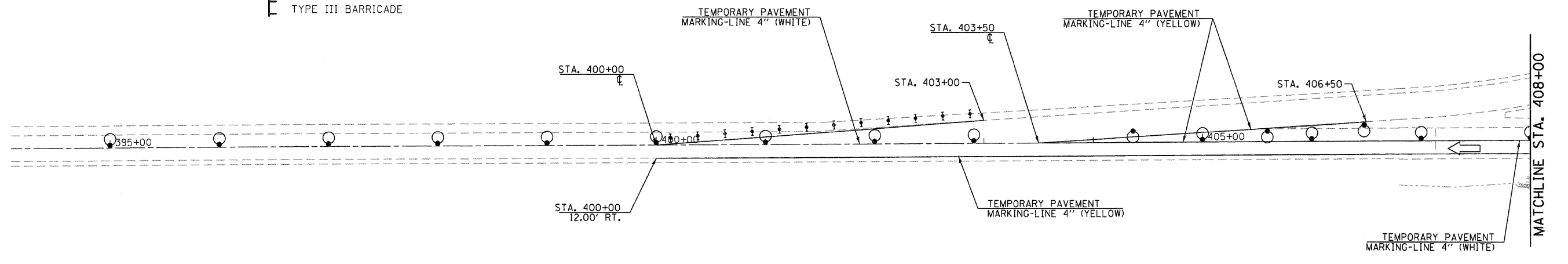
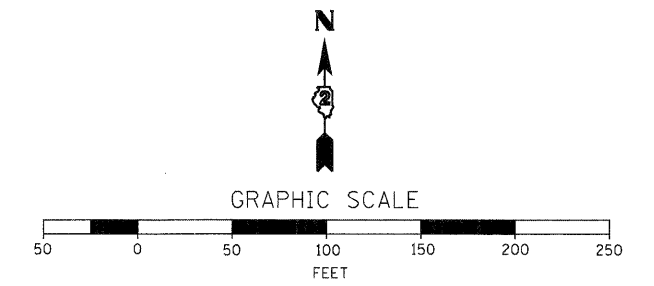

- NOTES:
- TEMPORARY CONCRETE BARRIER OFFSETS ARE MEASURED TO THE TRAFFIC SIDE OF THE WALL.

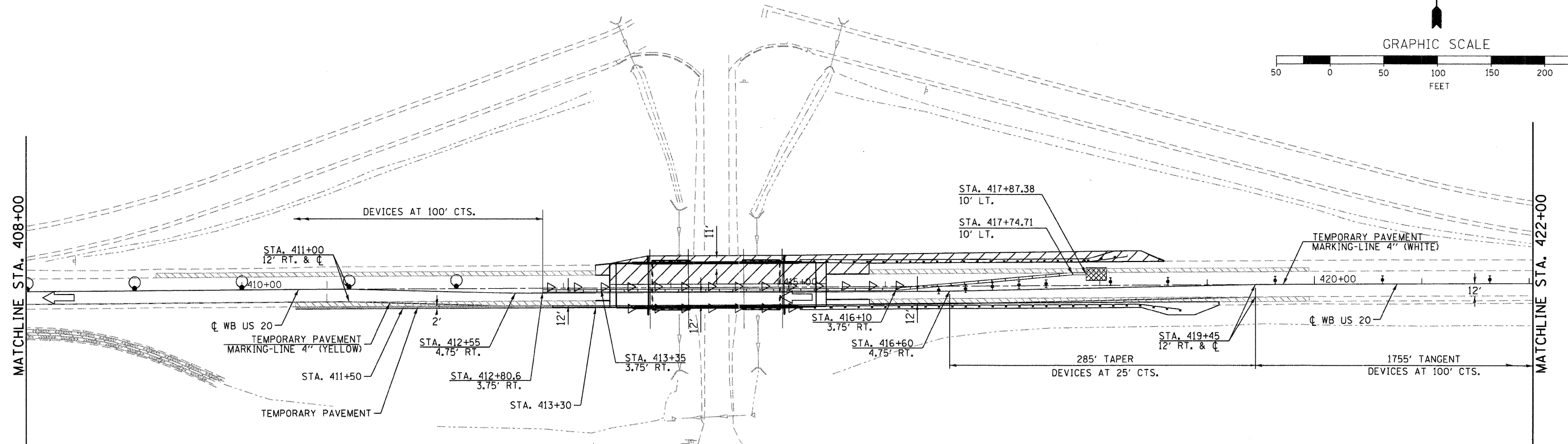
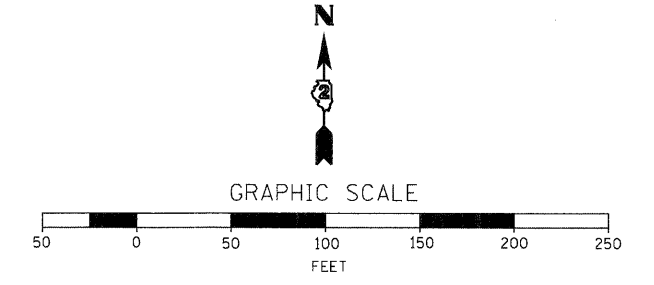

USER NAME = gjameson	DESIGNED -	REVISED -		1701 ROUTE 35 NORTH EAST DUBUQUE, IL 61025 (815) 747-8833 DESIGN FIRM #184001036	STATE OF ILLINOIS DEPARTMENT OF TRANSPORTATION	US 20 TRAFFIC CONTROL PLANS (STAGE 2) SN 043-0006 (WB)	F.A.P. RTE.	SECTION	COUNTY	TOTAL SHEETS	SHEET NO.
FILE NAME = 283207-shr-staging	SMBOGON	REVISED -					301	(43B,44B,44HB,45B)D	JO DAVIESS	309	71
PLOT DATE = 12/6/2011	DRAWN -	REVISED -					CONTRACT NO. 64C94				
PLOT TIME = 10:19:01 AM	CHECKED -	REVISED -					ILLINOIS FED. AID PROJECT				
SCALE: 1" = 50'						SHEET NO. 1 OF 2 SHEETS		STA. 395+00 TO STA. 422+00			