

STATE OF ILLINOIS
DEPARTMENT OF TRANSPORTATION
DIVISION OF HIGHWAYS
PROPOSED
HIGHWAY PLANS

F.A.S. RTE.	SECTION	COUNTY	TOTAL SHEETS	SHEET NO.
317	37 RS-3	IROQUOIS	9	1
ILLINOIS			CONTRACT NO. 66644	

INDEX OF SHEETS

1	COVER SHEET
2	GENERAL NOTES
3	SUMMARY OF QUANTITIES
4	TYPICAL SECTIONS
5-6	SCHEDULES
7	TIE POINTS
8	PROJECT LAYOUT
9	DETAILS

LIST OF ILLINOIS DOT HIGHWAY STANDARDS

000001-06	STANDARD SYMBOLS, ABBREVIATIONS AND PATTERNS
001006	DECIMAL OF AN INCH AND OF A FOOT
406201-01	MAILBOX TURNOUT
424001-06	PERPENDICULAR CURB RAMPS FOR SIDEWALKS
424006	DIAGONAL CURB RAMPS FOR SIDEWALKS
424011	CORNER PARALLEL CURB RAMPS FOR SIDEWALKS
424016	MID-BLOCK CURB RAMPS FOR SIDEWALKS
424021	DEPRESSED CORNER FOR SIDEWALKS
424026	ENTRANCE / ALLEY PEDESTRIAN CROSSINGS
606001-04	CONCRETE CURB TYPE B AND COMBINATION CONCRETE CURB AND GUTTER
667101-02	PERMANENT SURVEY MARKERS
701006-03	OFF-ROAD OPERATIONS 2L, 2W, 15' (4.5 m) TO 24" (600 mm) FROM PAVEMENT EDGE
701011-02	OFF-ROAD MOVING OPERATIONS 2L, 2W, DAY ONLY
701201-04	LANE CLOSURE, 2L, 2W, DAY ONLY, FOR SPEEDS ≥ 45 MPH
701301-04	LANE CLOSURE, 2L, 2W, SHORT TIME OPERATIONS
701306-03	LANE CLOSURE, 2L, 2W, SLOW MOVING OPERATIONS DAY ONLY, FOR SPEEDS ≥ 45 MPH
701311-03	LANE CLOSURE, 2L, 2W, MOVING OPERATIONS - DAY ONLY
701501-06	URBAN LANE CLOSURE, 2L, 2W, UNDIVIDED
701901-02	TRAFFIC CONTROL DEVICES
780001-03	TYPICAL PAVEMENT MARKINGS
781001-03	TYPICAL APPLICATIONS RAISED REFLECTIVE PAVEMENT MARKERS
701001-05	

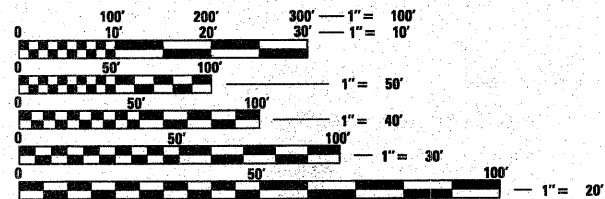

FULL SIZE PLANS HAVE BEEN PREPARED USING STANDARD ENGINEERING SCALES. REDUCED SIZED PLANS WILL NOT CONFORM TO STANDARD SCALES. IN MAKING MEASUREMENTS ON REDUCED PLANS, THE ABOVE SCALES MAY BE USED.

J.U.L.I.E.
 JOINT UTILITY LOCATION INFORMATION FOR EXCAVATION
 1-800-892-0123
 OR 811

PROJECT ENGINEER: JOE KANNEL, P.E.
UNIT CHIEF: MICHELE LINDEMANN, P.E./GREGG PRAIRIE

CONTRACT NO. 66644

FAS ROUTE 317 (US 45)
SECTION 37 RS-3
PROJECT: RS-0317(111)
3P RESURFACING
IROQUOIS COUNTY

C-93-052-06

**MILLING & RESURFACING FROM JUST SOUTH OF
 IL 116 TO NORTH STREET IN DANFORTH**

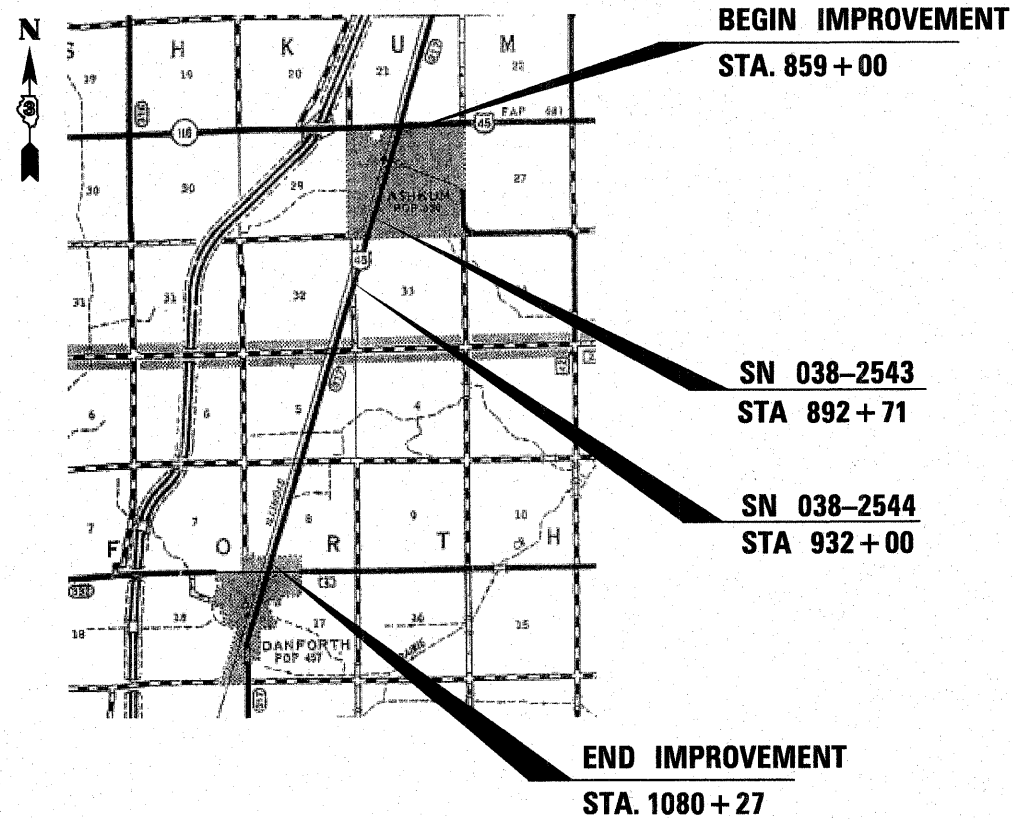

GROSS LENGTH = 22,127 FT. = 4.191 MILE
 NET LENGTH = 22,127 FT. = 4.191 MILE

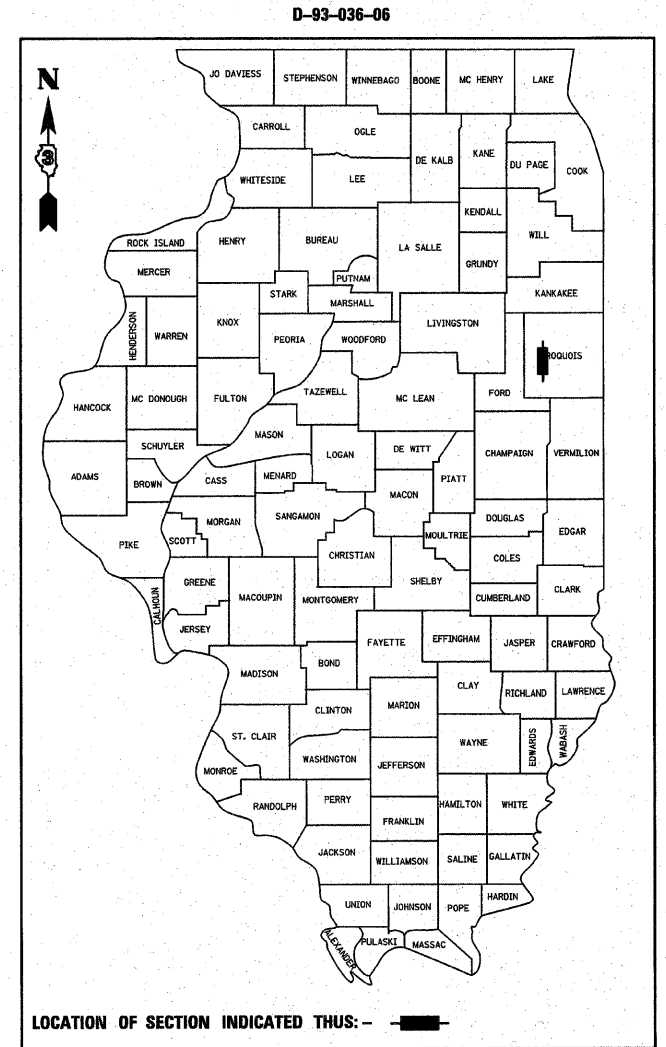

RURAL MAJOR COLLECTOR

ADT (2010) = 2200
 PC. = 89% S.U. = 7.0% M.U. = 4.0%

STATE OF ILLINOIS
 DEPARTMENT OF TRANSPORTATION
 DIVISION OF HIGHWAYS

SUBMITTED DECEMBER 16 20 11
Edna S. Thelander
 DEPUTY DIRECTOR OF HIGHWAYS, REGION ENGINEER

February 3 20 12
John D. Cavannoli, P.E.
 acting ENGINEER OF DESIGN AND ENVIRONMENT

February 3 20 12
William R. Fuchs
 acting DIRECTOR OF HIGHWAYS, CHIEF ENGINEER

**PRINTED BY THE AUTHORITY
 OF THE STATE OF ILLINOIS**

GENERAL NOTES

THE THICKNESS OF HMA SHOWN ON THE PLANS IS THE NOMINAL THICKNESS. DEVIATIONS FROM THE NOMINAL THICKNESS WILL BE PERMITTED WHEN SUCH DEVIATIONS OCCUR DUE TO IRREGULARITIES IN THE EXISTING SURFACE OR BASE ON WHICH THE HMA IS PLACED.

THE HMA SURFACE OF ALL MAILBOX TURNOUTS, PRIVATE ENTRANCES, COMMERCIAL ENTRANCES, AND SIDE ROADS SHALL BE MADE NEATLY, IN A WORKMANLIKE MANNER, AND SHALL ACCURATELY CONFORM TO THE SHAPES AND DIMENSIONS SHOWN ON THE PLAN DETAILS. IF REQUIRED BY THE ENGINEER, THE CONTRACTOR SHALL BE REQUIRED TO SAW CUT THE HMA SURFACE TO CONFORM TO THE SHAPES AND DIMENSIONS SHOWN ON THE PLAN DETAILS. THIS WORK SHALL BE INCLUDED IN THE COST OF THE INCIDENTAL HMA SURFACE.

THE ENGINEER WILL BE THE SOLE JUDGE CONCERNING CURING TIME FOR THE VARIOUS HMA LIFTS.

ALL DISTURBED AREAS WITHIN THE CONSTRUCTION LIMITS SHALL BE FERTILIZED AND SEEDED. SEEDING SHALL NOT BE PERMITTED AT ANY TIME WHEN THE GROUND IS FROZEN, WET, OR IN AN UNTILLABLE CONDITION. LOCATIONS TO BE SEEDED WILL BE DETERMINED BY THE ENGINEER.

THE FINISHED EARTHWORK SHALL HAVE A VEGETATION SUSTAINING SOIL COVERING THE TOP FOUR INCHES IN AREAS TO BE SEEDED OR SODDED. THE VEGETATION SUSTAINING SOIL REQUIRED WILL NOT BE PAID FOR SEPARATELY BUT SHALL BE INCLUDED IN THE COST OF FURNISHED EXCAVATION.

EXCELSIOR BLANKET SHALL BE USED AT ALL FURNISHED EXCAVATION LOCATIONS

ANY REFERENCE TO A STANDARD IN THESE PLANS SHALL BE INTERPRETED TO MEAN THE EDITION AS INDICATED BY THE SUBNUMBER SHOWN IN THE LIST OF STANDARDS OR THE COPY INCLUDED IN THESE PLANS.

THE FOLLOWING RATES OF APPLICATION HAVE BEEN USED IN CALCULATING PLAN QUANTITIES:

GRANULAR MATERIALS	2.05	TONS / CU YD
AGGREGATE (PRIME COAT)	0.002	TONS / SQ YD
HMA RESURFACING	112	LBS / SQ YD / IN
SHORT TERM PAVEMENT MARKING	10	FT /100 FT OF APPLICATION
MIX FOR CRACKS, JTS & FLGWYS	0.0003	TONS / SQ YD
LEVEL BINDER (HAND METHOD)	0.0005	TONS / SQ YD
SUPPLEMENTAL WATERING	3	GAL / SQ YD / APPLICATION
CALCIUM CHLORIDE	2	LB / SQ YD / APPLICATION
AGGREGATE DITCH CHECKS	5	TONS AGGREGATE

BITUMINOUS MATERIALS (PRIME COAT) RATES		
SURFACE TYPE	ESTIMATED TRUCK APPLICATION RATE	RESIDUAL RATE
AGGREGATE BASES	0.375 GAL / SQ YD	N/A
MILLED HMA OR PCC PAVEMENT	0.08 GAL / SQ YD	0.04 GAL / SQ YD
EXISTING PAVEMENT	0.05 GAL / SQ YD	0.025 GAL / SQ YD
FOG COAT (BETWEEN ADDITIONAL HMA LIFTS)	0.05 GAL / SQ YD	0.025 GAL / SQ YD

ESTIMATED TRUCK APPLICATION RATE USED FOR CALCULATING PLAN QUANTITIES

THE CONTRACTOR SHALL CONTACT JULIE AT LEAST 48 HOURS PRIOR TO EXCAVATION TO DETERMINE WHICH UTILITIES ARE IN THE AREA.

STATE OF ILLINOIS
DEPARTMENT OF TRANSPORTATION
DISTRICT THREE

PREPARED BY: *Don Bennis*
DISTRICT STUDIES & PLANS ENGINEER

DATE: 12-16-2011

EXAMINED BY: *Herbert*
DISTRICT CONSTRUCTION ENGINEER

John J. Peltz
DISTRICT MATERIALS ENGINEER

Bruce A. Wuehler
DISTRICT OPERATIONS ENGINEER

FILE NAME =	USER NAME = carpernterdj	DESIGNED -	REVISED -	STATE OF ILLINOIS DEPARTMENT OF TRANSPORTATION	GENERAL NOTES	F.A.S. RTE.	SECTION	COUNTY	TOTAL SHEETS	SHEET NO.	
ct\pw_work\pwidot\carpernterdj\d0176480	366644-sht-cover.dgn	DRAWN -	REVISED -			317	37 RS-3	IROQUOIS	9	2	
	PLOT SCALE = 47.2222' / in.	CHECKED -	REVISED -			CONTRACT NO. 66644					
	PLOT DATE = 12/15/2011	DATE -	REVISED -			SCALE:	SHEET NO.	OF	SHEETS	STA.	TO STA.

SUMMARY OF QUANTITIES				80% FED. 20% STATE
CODE NO.	CONSTRUCTION CODE TYPE: ITEM	UNIT	0005	
			TOTAL QUANT	
20200100	EARTH EXCAVATION	CU YD	7.2	
20400800	FURNISHED EXCAVATION	CU YD	21	
• 25000400	NITROGEN FERTILIZER NUTRIENT	POUND	6	
• 25000500	PHOSPHORUS FERTILIZER NUTRIENT	POUND	6	
• 25000600	POTASSIUM FERTILIZER NUTRIENT	POUND	6	
• 25100630	EROSION CONTROL BLANKET	SQ YD	252	
• 25200110	SODDING, SALT TOLERANT	SQ YD	48	
40200800	AGGREGATE SURFACE COURSE, TYPE B	TON	16	
40600100	BITUMINOUS MATERIALS (PRIME COAT)	GALLON	8,013	
40600300	AGGREGATE (PRIME COAT)	TON	125	
40600400	MIXTURE FOR CRACKS, JOINTS, AND FLANGEWAYS	TON	18	
40600725	POLYMERIZED LEVELING BINDER (HAND METHOD), N50	TON	30	
40600827	POLYMERIZED LEVELING BINDER (MACHINE METHOD), IL 4.75, N50	TON	2,509	
40600895	CONSTRUCTING TEST STRIP	EACH	2	
40600990	TEMPORARY RAMP	SQ YD	422	
40603310	HOT-MIX ASPHALT SURFACE COURSE, MIX "C", N50	TON	5,124	
40800050	INCIDENTAL HOT-MIX ASPHALT SURFACING	TON	389	
42400100	PORTLAND CEMENT CONCRETE SIDEWALK 4 INCH	SQ FT	1,243	
42400800	DETECTABLE WARNINGS	SQ FT	112	
44000158	HOT-MIX ASPHALT SURFACE REMOVAL, 2 1/4"	SQ YD	62,825	

SUMMARY OF QUANTITIES				80% FED. 20% STATE
CODE NO.	CONSTRUCTION CODE TYPE: ITEM	UNIT	0005	
			TOTAL QUANT	
44000500	COMBINATION CURB AND GUTTER REMOVAL	FOOT	120	
44000600	SIDEWALK REMOVAL	SQ FT	1,076	
48101200	AGGREGATE SHOULDERS, TYPE B	TON	1,251	
60605000	COMBINATION CONCRETE CURB AND GUTTER, TYPE B-6.24	FOOT	120	
66700205	PERMANENT SURVEY MARKERS, TYPE 1	EACH	1	
67000400	ENGINEER'S FIELD OFFICE, TYPE A	CAL MO	2	
67100100	MOBILIZATION	L SUM	1	
70100450	TRAFFIC CONTROL AND PROTECTION, STANDARD 701201	L SUM	1	
70100460	TRAFFIC CONTROL AND PROTECTION, STANDARD 701306	L SUM	1	
70102620	TRAFFIC CONTROL AND PROTECTION, STANDARD 701501	L SUM	1	
70102640	TRAFFIC CONTROL AND PROTECTION, STANDARD 701801	L SUM	1	
70300100	SHORT-TERM PAVEMENT MARKING	FOOT	6,639	
70300220	TEMPORARY PAVEMENT MARKING - LINE 4"	FOOT	37,654	
70300240	TEMPORARY PAVEMENT MARKING - LINE 6"	FOOT	5,537	
70301000	WORK ZONE PAVEMENT MARKING REMOVAL	SQ FT	738	
• 78001110	PAINT PAVEMENT MARKING - LINE 4"	FOOT	75,308	
• 78001130	PAINT PAVEMENT MARKING - LINE 6"	FOOT	9,414	
• 78000400	THERMOPLASTIC PAVEMENT MARKING - LINE 6"	FOOT	1,314	
• 78000650	THERMOPLASTIC PAVEMENT MARKING - LINE 24"	FOOT	87	
• 78100100	RAISED REFLECTIVE PAVEMENT MARKER	EACH	276	
78300200	RAISED REFLECTIVE PAVEMENT MARKER REMOVAL	EACH	276	
Z0034105	MATERIAL TRANSFER DEVICE	TON	5,124	

• SPECIALTY ITEMS

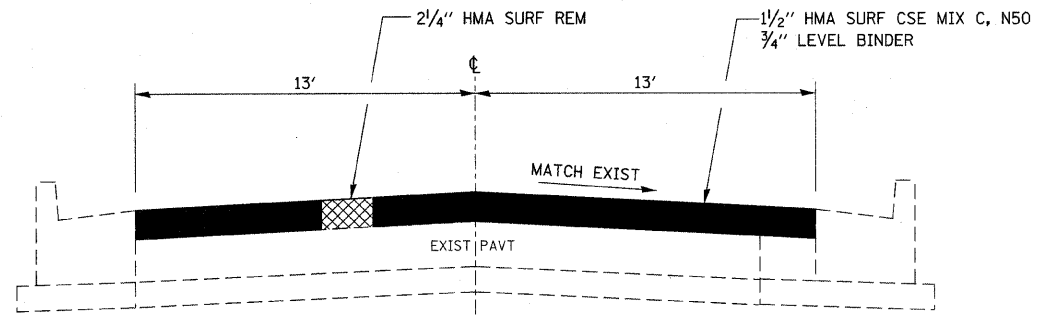

PROPOSED TYPICAL SECTION

STA. 859+00 TO STA. 892+00

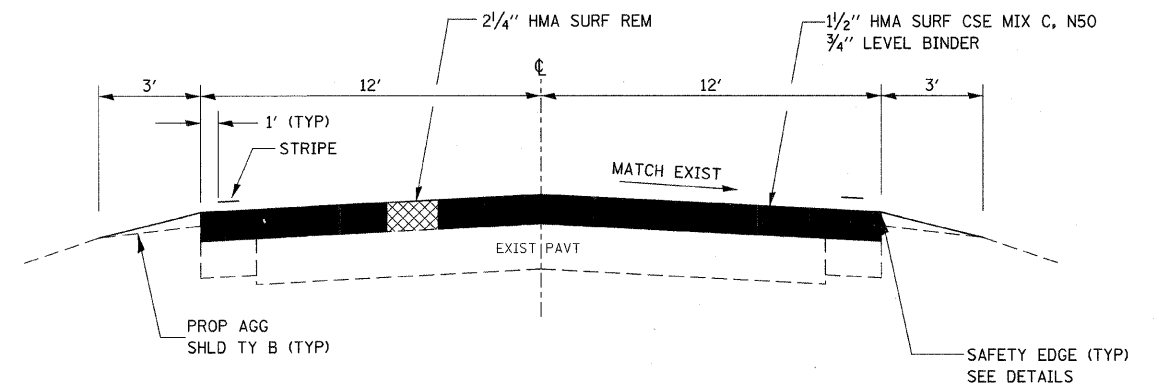

PROPOSED TYPICAL SECTION

STA. 892+00 TO STA. 1080+27

MIX DESIGN					
MIX	PG GRADE	DESIGN AIR VOIDS	MIX COMPOSITION	FRICITION AGG	DENSITY CONTROL
HMA SURFACE COURSE	PG 64-22	4.0% @N50	IL 9.5	MIXTURE C	OCP CORES
HMA LEVELING BINDER	SBS PG 70-22	4.0% @N50	IL 4.75		OCP CORES

MAINLINE SCHEDULE													
LOCATION	LENGTH	WIDTH	AREA	BIT MAT (PR CT)	AGG (PR CT)	MIX FOR CRACKS, JTS & FLGWYS	LEVEL BINDER (HM)	LEVEL BINDER (MM)	HMA SURF CSE	MATERIAL TRANSFER DEVICE	HMA SURF REM 2-1/4"	TEMP RAMP	AGG SHLD TYPE B
STA TO STA	FOOT	FOOT	SQ YD	GALLON	TON	TON	TON	TON	TON	TON	SQ YD	SQ YD	TON
1080+27 TO 892+00	18,827	24	50205	6527	100	15	25	2109	4323	4323	50205	20	1251
892+00 TO 859+00	3,300	26	9533	1239	19	3	5	400	801	801	9533	22	
TOTAL				7766	119	18	30	2509	5124	5124	59738	42	1251

SIDEROAD AND ENTRANCE SCHEDULE														
			LENGTH	WIDTH (EOP)	WIDTH (END)	WIDTH	AREA	INCIDENTAL HMA SURF	AGG SURF CSE TY B	HMA SURF REM 2-1/4"	TEMP RAMP	BIT MATLS (PR CT)	AGG (PR CT)	
			FOOT	FOOT	FOOT	FOOT	SQ YD	TON	TON	SQ YD	SQ YD	TON	GAL	
862+20	LT	SR	CHARLES ST	50	58	24	20	188.9	23.8	188.9	20	15.1	0.4	
866+20	LT	SR	FINE ST	45	57	23	20	166.7	21.0	166.7	19	13.3	0.3	
870+20	LT	SR	WASHINGTON ST	43	54	25	20	157.7	19.9	157.7	21	12.6	0.3	
874+20	RT	SR	MAIN ST	17	148	111	81	214.1	27.0	214.1	93	17.1	0.4	
874+20	LT	SR	MAIN ST	35	117	60	33	272.2	34.3	272.2	50	21.8	0.5	
878+40	LT	SR	LAKE ST	38	71	38	32	198.4	25.0	198.4	32	15.9	0.4	
880+40	LT	SR	HUBERT ST	47	65	33	30	222.8	28.1	222.8	28	17.8	0.4	
885+80	LT	SR	CLOKE ST	43	58	28	20	168.8	21.3	168.8	23	13.5	0.3	
905+20	LT	PE	HMA/AGG	10	130	85		119.4	15.0	119.4		9.6	0.2	
913+20	LT	SR	HMA/A3 (2500 N. RD.)	30	71	15		115.2	14.5	115.2	13	9.2	0.2	
914+40	LT	PE	HMA/AGG	10	37	13		27.8	3.5	27.8		2.2	0.1	
938+60	LT	PE	HMA/AGG	10	42	24.5		36.9	4.6	36.9		3.0	0.1	
940+60	LT	PE	HMA/AGG	16	46.5	31		65.65	8.3	65.7		5.3	0.1	
941+10	LT	SR	HMA/AGG (2450 N. RD.)	30	46.5	23		94.95	12.0	95.0		7.6	0.2	
969+00	RT	SR	HMA/A3 (2400 N. RD.)	30	110	34.5		229.7	28.9	229.7	29	18.4	0.5	
969+00	LT	SR	HMA/A3 (2400 N. RD.)	30	87	21		142.4	17.9	142.4	18	11.4	0.3	
984+80	LT	PE/MBT	HMA/AGG	10	36.5	17		64	8.1	64.0	1.0	5.1	0.1	
1024+00	LT	SR	HMA/A3 (2300 N. RD.)	30	83	19		146	18.4	146.0	16	11.7	0.3	
1024+00	RT	SR	HMA/A3 (2300 N. RD.)	30	95	22		195	24.6	195.0	18	15.6	0.4	
1073+80	LT	CE	HMA/AGG	14	54	45		77	9.7	77.0		6.2	0.2	
1074+80	LT	CE	HMA/AGG	18	52	36.5		88.5	11.2	88.5		7.1	0.2	
1076+00	LT	CE	HMA/AGG	14	45	30.5		58.7	7.4	58.7		4.7	0.1	
1079+80	LT	CE	HMA/AGG	14	30	16		35.8	4.5	35.8		2.9	0.1	
TOTALS								389	16	3,087	380	247	6	

PAVEMENT MARKING SCHEDULE												
LOCATION	LENGTH	PAINT PAVEMENT MARKING LINE		THERMO PAVEMENT MARKING LINE			TEMPORARY PAVEMENT MARKING LINE		SHORT-TERM PAVEMENT MARKING	WORK ZONE PAVEMENT MARKING REM	RAISED REFL PAVEMENT MARK REM	RAISED REFL PAVEMENT MARK
		4 INCH	6 INCH	6 INCH	6 INCH	24 INCH	4 INCH	6 INCH				
STA TO STA	FOOT	WHITE	YELLOW	WHITE	YELLOW	WHITE	WHITE	YELLOW	FOOT	SQ FT	EACH	EACH
859+00 TO 892+00	3300			60	830	12		830	990	110	41	41
CHARLES ST				52		12						
FINE ST				54		12						
WASHINGTON ST												
MAIN ST, RT				120		15						
LAKE ST				76		12						
HUBERT ST				66		12						
CLOKE ST				56		12						
892+00 TO 1080+27	18,827	75,308	9,414					37,654	4,707	5,649	628	235
TOTAL		75,308	9,414	484	830	87		37,654	5,537	6,639	738	276

NOTE: ADDITIONAL QUANTITY HAS BEEN INCLUDED TO ALLOW FOR TWO SEPARATE APPLICATIONS OF PAINT PAVEMENT MARKING LINE

FILE NAME =	USER NAME = carperterdj	DESIGNED -	REVISED -	STATE OF ILLINOIS DEPARTMENT OF TRANSPORTATION	SCHEDULES				F.A.S. RTE.	SECTION	COUNTY	TOTAL SHEETS	SHEET NO.
ca:\pr\work\pndot\carperterdj\d0176480\366644-shd-details.DGN	PLOT SCALE = 47.2222' / 1" =	DRAWN -	REVISED -		SCALE:	SHEET NO.	OF	SHEETS	STA.	TO STA.	IROQUOIS	9	5
	PLOT DATE = 12/15/2011	CHECKED -	REVISED -								ILLINOIS FED. AID PROJECT		
		DATE -	REVISED -										

Rev.

SEEDING SCHEDULE							
LOCATION		CLASS 2 SEEDING	NITROGEN FERTILIZER	PHOSPHORUS FERTILIZER	POTASSIUM FERTILIZER	EROSION CONTROL BLANKET	FURNISHED EXCAVATION
		ACRE	POUND	POUND	POUND	SQ YD	CU YD
2500 N. RD.	LT	0.01	0.9	0.9	0.9	42	3.5
2450 N. RD.	LT	0.01	0.9	0.9	0.9	42	3.5
2400 N. RD.	RT	0.01	0.9	0.9	0.9	42	3.5
2400 N. RD.	LT	0.01	0.9	0.9	0.9	42	3.5
2300 N. RD.	RT	0.01	0.9	0.9	0.9	42	3.5
2300 N. RD.	LT	0.01	0.9	0.9	0.9	42	3.5
TOTALS		0.06	5.4	5.4	5.4	252	21

SIDEWALK SCHEDULE FOR NEW RAMP INSTALLATION											
LOCATION	ADA RAMP STANDARD	PCC SIDEWALK 4"	DETECTABLE WARNINGS	CCC&G	SIDEWALK REMOVAL	CC&G REM	SOD SALT TOLERANT	NIT FERT NUT	PHOS FERT NUT	POT FERT NUT	EARTH EXC
		SQ FT	SQ FT	FT	SQ FT	FOOT	SQ YD	LB	LB	LB	CU YD
CHARLES ST:											
SE QUAD	424001	99.5	8	10	85.5	10	4	0.05	0.05	0.05	0.6
NE QUAD	424001	80.5	8	10	67	10	4	0.05	0.05	0.05	0.6
FINE ST:											
SE QUAD	424001	83.5	8	10	69.5	10	4	0.05	0.05	0.05	0.6
NE QUAD	424001	83.5	8	10	69.5	10	4	0.05	0.05	0.05	0.6
WASHINGTON ST:											
SE QUAD	424001	77.5	8	10	64.5	10	4	0.05	0.05	0.05	0.6
NE QUAD	424001	86.5	8	10	72	10	4	0.05	0.05	0.05	0.6
MAIN ST:											
SE QUAD	424006	113.1	8	0	113.9	0	0	0.00	0.00	0.00	0.0
NE QUAD	424006	95.9	8	0	95.9	0	0	0.00	0.00	0.00	0.0
LAKE ST:											
SE QUAD	424001	83.5	8	10	69.5	10	4	0.05	0.05	0.05	0.6
NE QUAD	424001	89.5	8	10	74.5	10	4	0.05	0.05	0.05	0.6
HUBERT ST:											
SE QUAD	424001	83.5	8	10	69.5	10	4	0.05	0.05	0.05	0.6
NE QUAD	424001	83.5	8	10	69.5	10	4	0.05	0.05	0.05	0.6
CLOKE ST:											
SE QUAD	424001	86.5	8	10	72	10	4	0.05	0.05	0.05	0.6
NE QUAD	424001	96.5	8	10	83	10	4	0.05	0.05	0.05	0.6
TOTAL		1243	112	120	1075.8	120	48	0.6	0.6	0.6	7.2

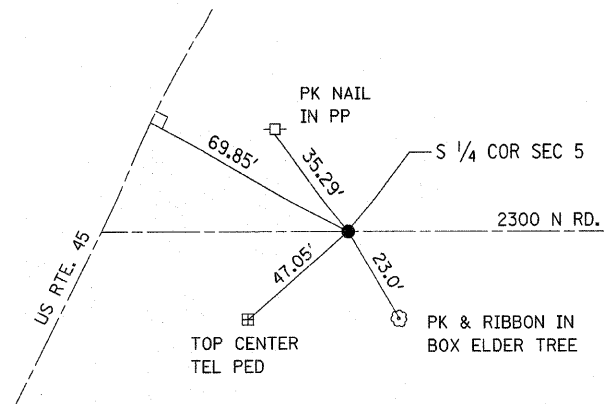

1-12-2010
 FOUND RAILROAD SPIKE
 C OF 2300 N RD.
 ±69.85' EAST OF C IL. RTE. 45
 RM, DB, WDM III

THE RESIDENT ENGINEER SHALL CONTACT
 BOB POUNDSTONE IN THE DISTRICT 3 BUREAU
 OF LAND ACQUISITION, AT 815-434-8424,
 TO OBTAIN TIE POINTS.

SEC. 5 S 1/4 COR. 27N. 14W
SECOND PM IROQUOIS CO.

US RTE 45 JUST SOUTH OF IL 116 IN ASHKUM TO NORTH ST. IN DANFORTH		IROQUOIS COUNTY			
STATION	DESCRIPTION	EXISTING MONUMENT TYPE	PROPOSED MONUMENT TYPE	MONUMENT RECORD TO BE RECORDED	RESPONSIBILITY
	S QTR CORNER SECTION 5-27-14W	BRASS DISK	TYPE 1	YES	2

NOTE: FOR ALL MONUMENT LOCATIONS SEE TIE SKETCHES

RESPONSIBILITY:
 1) RESIDENT TO RE-ESTABLISH MONUMENT
 2) RESIDENT TO RE-ESTABLISH MONUMENT AND FURNISH TIE SKETCHES TO D-3 PLATS AND PLANS (PAY ITEM REQUIRED. PERMANENT SURVEY MARKER, TYPE 1)
 3) PROFESSIONAL LAND SURVEYOR TO RE-ESTABLISH MONUMENT, RECORD NEW MONUMENT RECORD, AND PROVIDE COPY TO D-3 PLATS AND PLANS (PAY ITEM REQUIRED - LAND SECTION MARKERS)

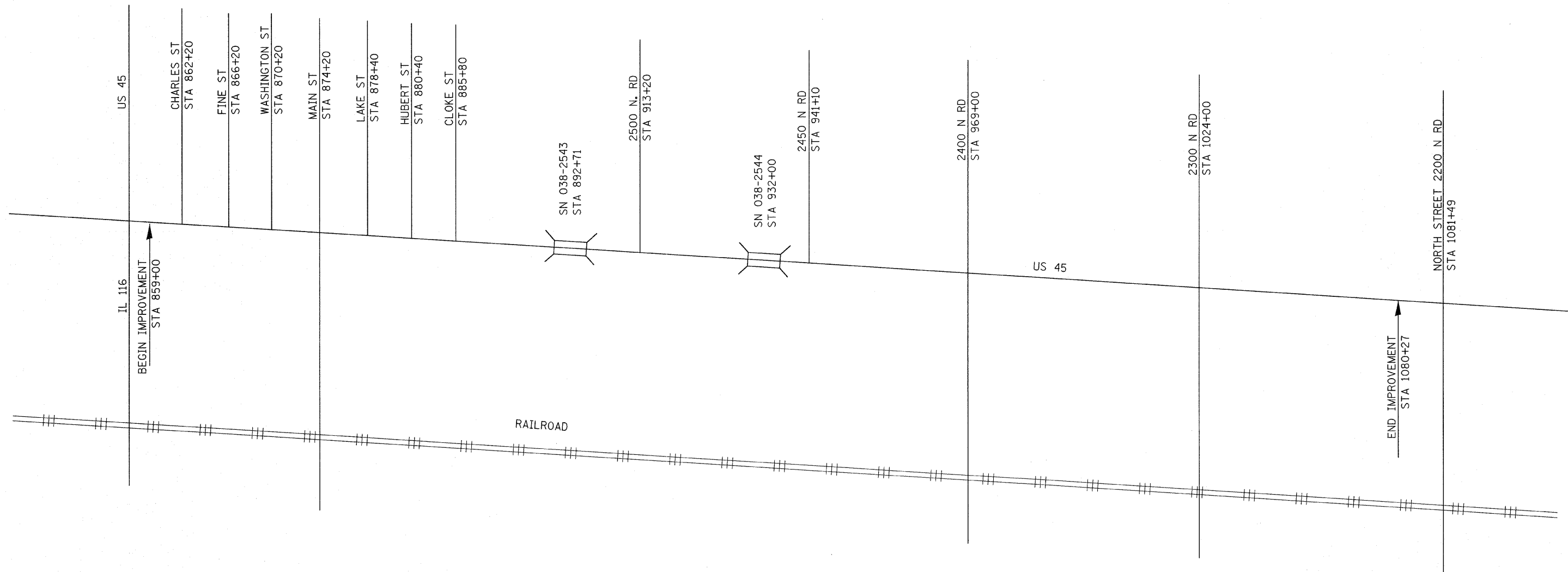
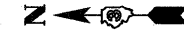

FILE NAME =	USER NAME = carpenterd_j	DESIGNED -	REVISED -
ci:\pw\work\pwidot\carpentard_j\d8176480\366644-aht-details.DGN		DRAWN -	REVISED -
	PLOT SCALE = 47.2222' / in.	CHECKED -	REVISED -
	PLOT DATE = 12/15/2011	DATE -	REVISED -

**STATE OF ILLINOIS
DEPARTMENT OF TRANSPORTATION**

LAYOUT MAP

SCALE: SHEET NO. OF SHEETS STA. TO STA.

F.A.S. RTE.	SECTION	COUNTY	TOTAL SHEETS	SHEET NO.
317	37 RS-3	IRROQUOIS	9	8
CONTRACT NO. 66644				
ILLINOIS FED. AID PROJECT				

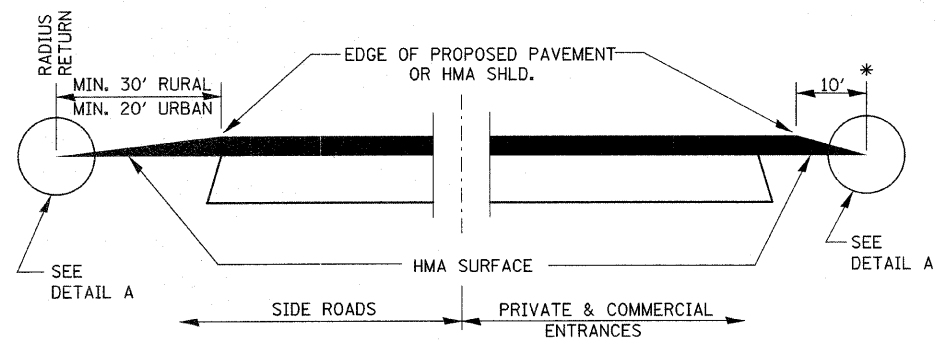

SECTION A-A
DETAILS AT ENTRANCES & SIDE ROADS

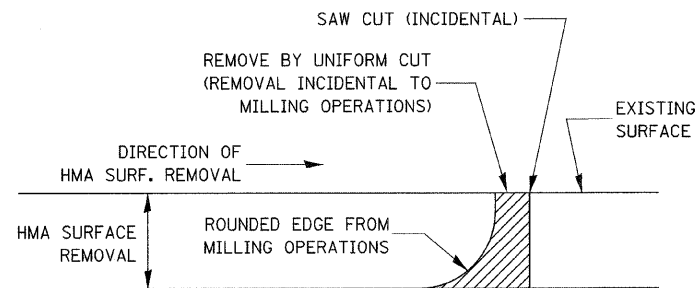

NOTE:
WHEN MILLING OPERATIONS PRODUCE A ROUNDED EDGE, THEN A SAW CUT SHALL BE USED TO MANUFACTURE A PERPENDICULAR EDGE AS SHOWN IN THE DETAIL. THE ENGINEER SHALL BE THE SOLE JUDGE CONCERNING THE USE OF THIS DETAIL

SAW CUT DETAIL AT HMA SURF. REM.

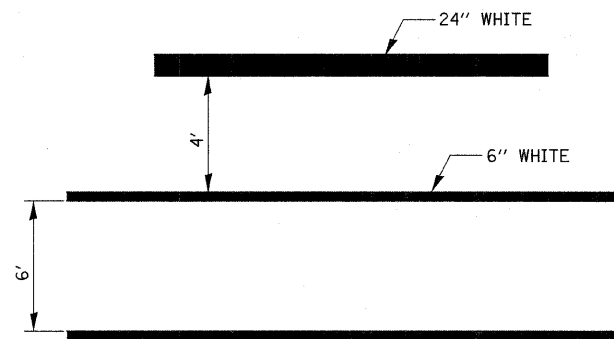

TYPICAL SPACING DETAIL FOR CROSSWALKS AND STOP BARS

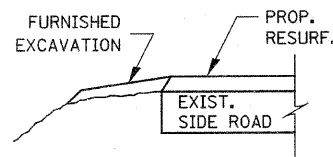

SECTION B-B

THE COST OF REMOVAL AT EXISTING HMA OR P.C.C. LOCATIONS SHALL BE PAID FOR PER SQ. YD. BY THE APPROPRIATE PAY ITEM. REMOVAL AT THE EXISTING AGG. LOCATIONS SHALL BE INCIDENTAL TO THE HMA. A-3 LOCATIONS SHALL BE FEATHER TAPERED.

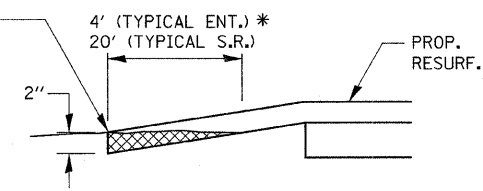

DETAIL A

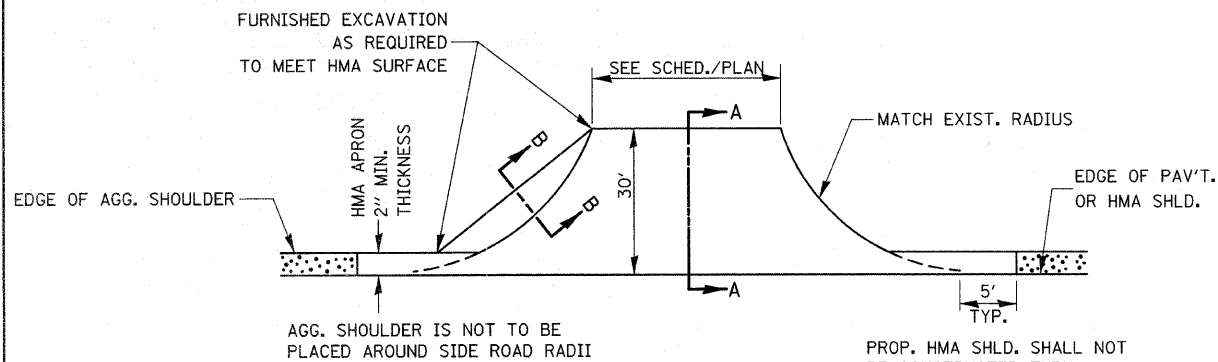

PLAN AT SIDE ROADS

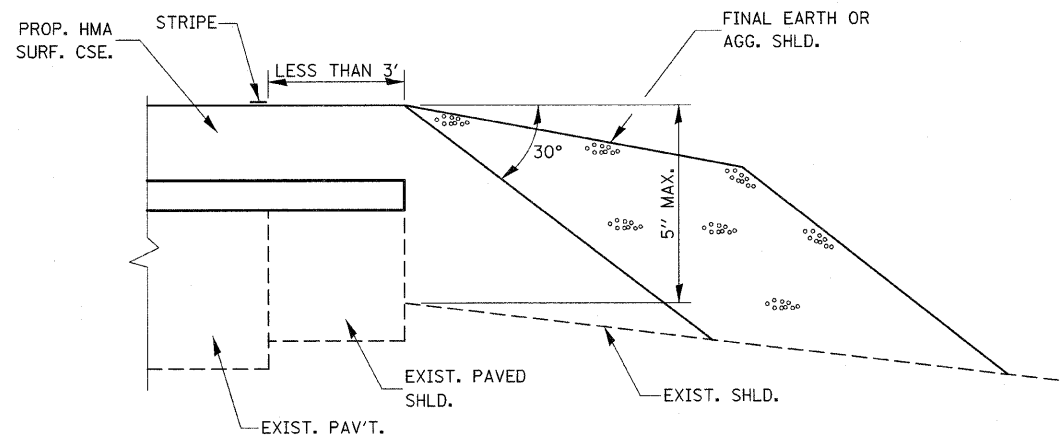

SAFETY EDGE

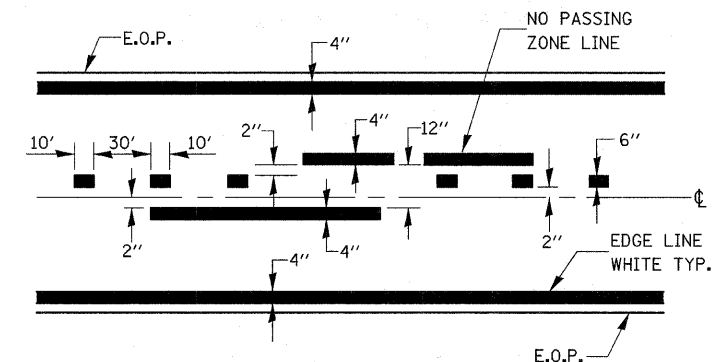

PAVEMENT MARKING

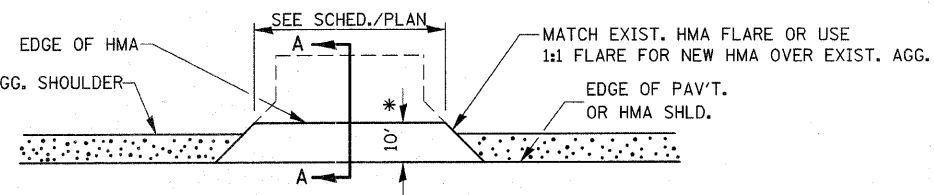

PLAN AT PRIVATE & COMMERCIAL ENTRANCES

(DO NOT RESURFACE FIELD ENTRANCES)

* PROPOSED HMA RESURFACING AT PUBLIC EDUCATIONAL FACILITY ENTRANCES SHALL BE EXTENDED TO THE RIGHT-OF-WAY LIMITS.

FILE NAME =	USER NAME = carpenterdj	DESIGNED -	REVISED -	STATE OF ILLINOIS DEPARTMENT OF TRANSPORTATION	DETAILS			F.A.S. RTE.	SECTION	COUNTY	TOTAL SHEETS	SHEET NO.
ca:\pw\work\pawdot\carpenterdj\d0176480\366644-sht-details.DGN	PLOT SCALE = 47.2222' / 1"	DRAWN -	REVISED -					317	37 RS-3	IROQUOIS	9	9
	PLOT DATE = 12/15/2011	CHECKED -	REVISED -		SCALE: SHEET NO. OF SHEETS STA. TO STA.			CONTRACT NO. 66644				
		DATE -	REVISED -		ILLINOIS FED. AID PROJECT							