

STATE OF ILLINOIS
DEPARTMENT OF TRANSPORTATION
DIVISION OF HIGHWAYS

PROPOSED
HIGHWAY PLANS

FAP 332 (IL 1)
SECTION (4,5,H,K,C-1)RS-4
PROJECT: ACNHF-0332(10B)
3P RESURFACING
KANKAKEE & IROQUOIS COUNTIES

C-93-056-09
MILLING & RESURFACING FROM
NCL OF ST ANNE TO JUST NORTH OF US 52

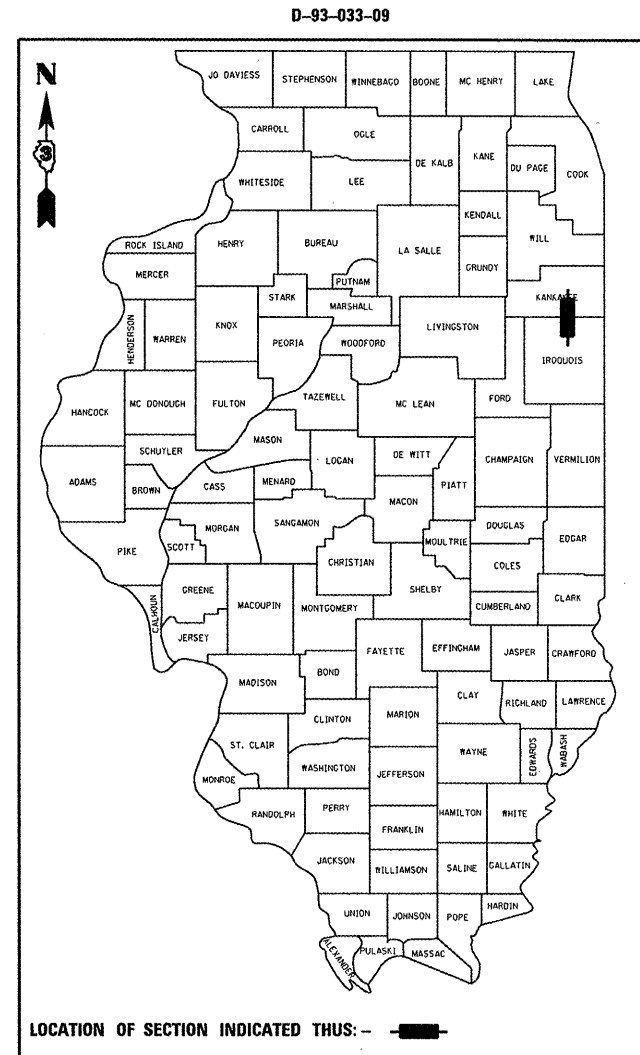

OTHER PRINCIPAL ARTERIAL
 2009 ADT = 3,000
 P.V. = 85%
 S.U. = 7%
 M.U. = 8%

STATE OF ILLINOIS
 DEPARTMENT OF TRANSPORTATION
 DIVISION OF HIGHWAYS

SUBMITTED 12-12 2011
Eric S. Therkelsen
 DEPUTY DIRECTOR OF HIGHWAYS, REGION ENGINEER

Feb 3 2012
John D. Baranzelli, P.E.
 acting ENGINEER OF DESIGN AND ENVIRONMENT

Feb 3 2012
William R. Fleury
 acting DIRECTOR OF HIGHWAYS, CHIEF ENGINEER

PRINTED BY THE AUTHORITY
OF THE STATE OF ILLINOIS

INDEX OF SHEETS

1	COVER SHEET
2	GENERAL NOTES
3-6	SUMMARY OF QUANTITIES
7	TYPICAL SECTIONS
8-11	SCHEDULES
12	TIE POINTS
13-14	PROJECT LAYOUT
15-18	PAVEMENT MARKING DETAILS
19-20	MISCELLANEOUS DETAILS

STANDARDS

000001-06	STANDARD SYMBOLS, ABBREVIATIONS AND PATTERNS
001006	DECIMAL OF AN INCH AND OF A FOOT
406201-01	MAILBOX TURNOUT
424001-06	PERPENDICULAR CURB RAMPS FOR SIDEWALKS
424006	DIAGONAL CURB RAMPS FOR SIDEWALKS
424011	CORNER PARALLEL CURB RAMPS FOR SIDEWALKS
424016	MID-BLOCK CURB RAMPS FOR SIDEWALKS
424021	DEPRESSED CORNER FOR SIDEWALKS
424026	ENTRANCE / ALLEY PEDESTRIAN CROSSINGS
442201-03	CLASS C AND D PATCHES
606001-04	CONCRETE CURB TYPE B AND COMBINATION CONCRETE CURB AND GUTTER
667101-01	PERMANENT SURVEY MARKERS
701001-02	OFF-ROAD OPERATIONS 2L, 2W, MORE THAN 15' (4.5 m) AWAY
701006-03	OFF-ROAD OPERATIONS 2L, 2W, 15' (4.5 m) TO 24" (600 mm) FROM PAVEMENT EDGE
701201-04	LANE CLOSURE, 2L, 2W, DAY ONLY, FOR SPEEDS ≥ 45 MPH
701301-04	LANE CLOSURE, 2L, 2W, SHORT TIME OPERATIONS
701306-03	LANE CLOSURE, 2L, 2W, SLOW MOVING OPERATIONS DAY ONLY, FOR SPEEDS ≥ 45 MPH
701311-03	LANE CLOSURE, 2L, 2W, MOVING OPERATIONS - DAY ONLY
701501-06	URBAN LANE CLOSURE, 2L, 2W, UNDIVIDED
701901-02	TRAFFIC CONTROL DEVICES
780001-03	TYPICAL PAVEMENT MARKINGS
781001-03	TYPICAL APPLICATIONS RAISED REFLECTIVE PAVEMENT MARKERS
782001	PRISMATIC CURB REFLECTORS

701801-05

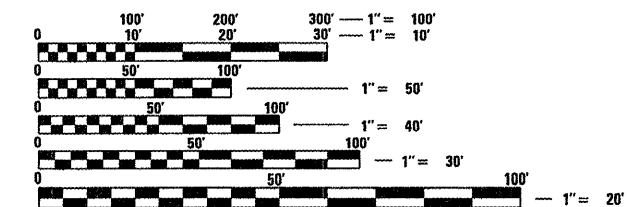

FULL SIZE PLANS HAVE BEEN PREPARED USING STANDARD ENGINEERING SCALES. REDUCED SIZED PLANS WILL NOT CONFORM TO STANDARD SCALES. IN MAKING MEASUREMENTS ON REDUCED PLANS, THE ABOVE SCALES MAY BE USED.

J.U.L.I.E.
 JOINT UTILITY LOCATION INFORMATION FOR EXCAVATION
 1-800-892-0123
 OR 811

DISTRICT 3 NO. (815) 434-6131

PROJECT ENGINEER: JOE KANNEL, P.E.
 UNIT CHIEF: GREGG PRAIRIE /MICHELE LINDEMANN, P.E.

CONTRACT NO. 66921

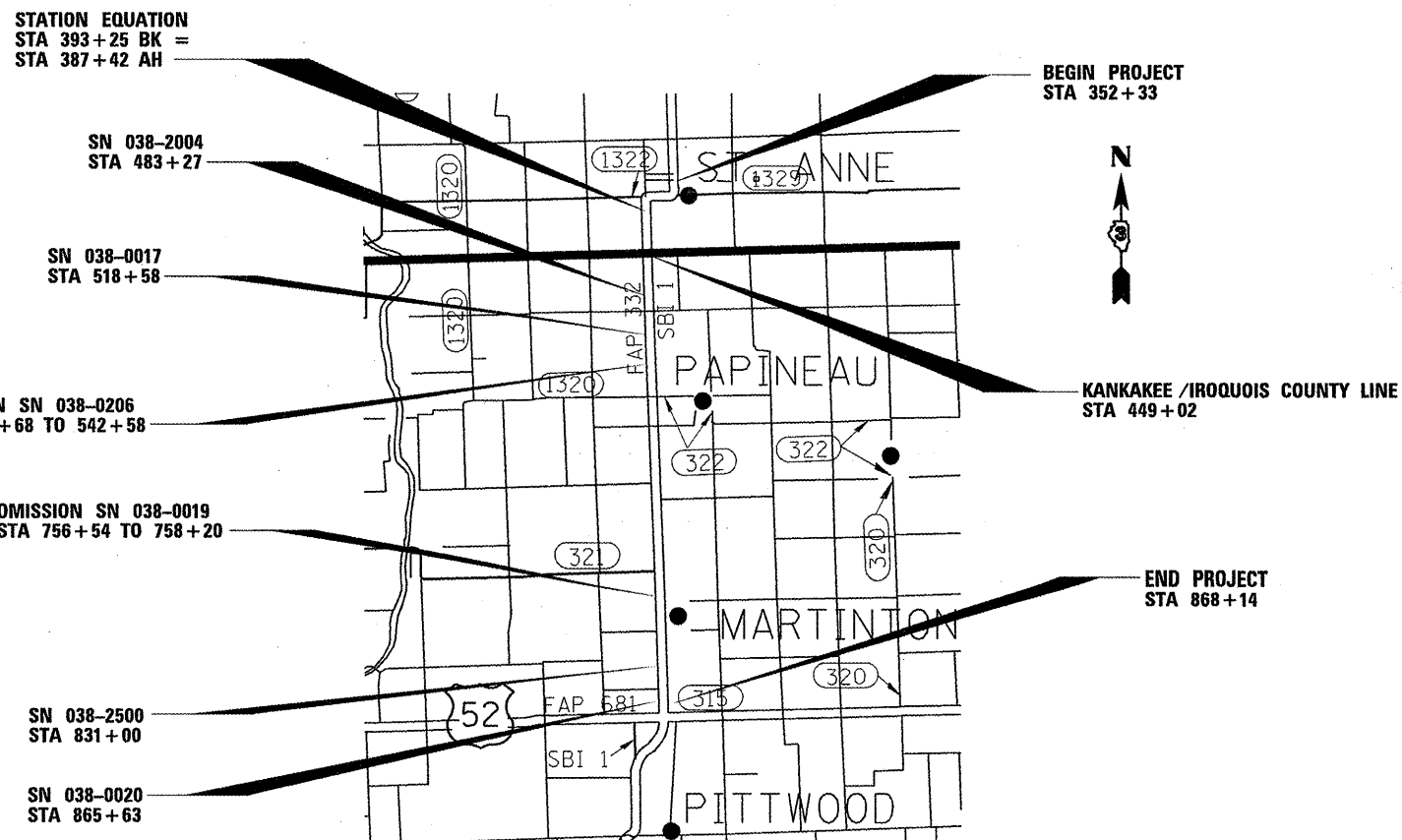

GROSS LENGTH = 52164 FT. = 9.880 MILE
 NET LENGTH = 51808 FT. = 9.812 MILE

GENERAL NOTES

THE THICKNESS OF HMA SHOWN ON THE PLANS IS THE NOMINAL THICKNESS. DEVIATIONS FROM THE NOMINAL THICKNESS WILL BE PERMITTED WHEN SUCH DEVIATIONS OCCUR DUE TO IRREGULARITIES IN THE EXISTING SURFACE OR BASE ON WHICH THE HMA IS PLACED.

THE HMA SURFACE OF ALL MAILBOX TURNOUTS, PRIVATE ENTRANCES, COMMERCIAL ENTRANCES, AND SIDE ROADS SHALL BE MADE NEATLY, IN A WORKMANLIKE MANNER, AND SHALL ACCURATELY CONFORM TO THE SHAPES AND DIMENSIONS SHOWN ON THE PLAN DETAILS. IF REQUIRED BY THE ENGINEER, THE CONTRACTOR SHALL BE REQUIRED TO SAW CUT THE HMA SURFACE TO CONFORM TO THE SHAPES AND DIMENSIONS SHOWN ON THE PLAN DETAILS. THIS WORK SHALL BE INCLUDED IN THE COST OF THE HMA SURFACE.

THE ENGINEER WILL BE THE SOLE JUDGE CONCERNING CURING TIME FOR THE VARIOUS HMA LIFTS.

SEEDING SHALL NOT BE PERMITTED AT ANY TIME WHEN THE GROUND IS FROZEN, WET, OR IN AN UNTILLABLE CONDITION. LOCATIONS TO BE SEEDED WILL BE DETERMINED BY THE ENGINEER.

THE FINISHED EARTHWORK SHALL HAVE A VEGETATION SUSTAINING SOIL COVERING THE TOP FOUR INCHES IN AREAS TO BE SEEDED OR SODDED. THE VEGETATION SUSTAINING SOIL REQUIRED WILL NOT BE PAID FOR SEPARATELY BUT SHALL BE INCLUDED IN THE COST OF FURNISHED EXCAVATION.

FOR NEW CONSTRUCTION, PLACE CURB RAMPS FOR SIDEWALKS AT ALL LOCATIONS WHERE PROPOSED SIDEWALK ABUTS CURB AT STREET ENTRANCES

ON EXISTING PAVEMENT WHICH MAY BE SUPERELEVATED, THE NEW HMA PAVEMENT SHALL BE BUILT WITH THE SAME SUPERELEVATION UNLESS NEW SUPERELEVATION RATES ARE GIVEN ON THE PLANS.

ANY REFERENCE TO A STANDARD IN THESE PLANS SHALL BE INTERPRETED TO MEAN THE EDITION AS INDICATED BY THE SUBNUMBER SHOWN IN THE LIST OF STANDARDS OR THE COPY INCLUDED IN THESE PLANS.

THE FOLLOWING RATES OF APPLICATION HAVE BEEN USED IN CALCULATING PLAN QUANTITIES:

GRANULAR MATERIALS	2.05	TONS / CU YD
BITUMINOUS MATERIALS (PRIME COAT)	0.08	GAL / SQ YD
FOR ADDITIONAL HMA LIFTS "FOG COAT"	0.05	GAL / SQ YD
AGGREGATE PRIME COAT	0.002	TONS / SQ YD
HMA RESURFACING	112	LBS / SQ YD / IN
SHORT TERM PAVEMENT MARKING	10	FT / 100 FT OF APPLICATION
MIX FOR CRACKS, JTS & FLGWYS	0.0003	TONS / SQ YD
LEVEL BINDER (HAND METHOD)	0.0005	TONS / SQ YD

THE CONTRACTOR SHALL CONTACT JULIE AT LEAST 48 HOURS PRIOR TO EXCAVATION TO DETERMINE WHICH UTILITIES ARE IN THE AREA.

STATE OF ILLINOIS
DEPARTMENT OF TRANSPORTATION
DISTRICT THREE

PREPARED BY: *Tom Benoit*
DISTRICT STUDIES & PLANS ENGINEER

DATE: 12-12-11

EXAMINED BY: *Wayne L. Phillips*
DISTRICT CONSTRUCTION ENGINEER

James A. Hucker
DISTRICT MATERIALS ENGINEER
James A. Hucker
DISTRICT OPERATIONS ENGINEER

FILE NAME *	USER NAME = lindemannms	DESIGNED -	REVISED -	STATE OF ILLINOIS DEPARTMENT OF TRANSPORTATION	GENERAL NOTES	F.A.P. RTE.	SECTION	COUNTY	TOTAL SHEETS	SHEET NO.
c:\pw_work\pwidat\lindemannms\d0135018\066921-sht-cover.dgn		DRAWN -	REVISED -			332	(4,5,H,K,C-1)RS-4	*	20	2
PLOT SCALE = 100.0000' / 1" =		CHECKED -	REVISED -			* KANKAKEE & IROQUOIS		CONTRACT NO. 66921		
PLOT DATE = 12/12/2011		DATE -	REVISED -			ILLINOIS FED. AID PROJECT				
					SCALE:	SHEET NO. OF SHEETS		STA. TO STA.		

80% FED.
20% STATE

CODE NO.	ITEM	UNIT	TOTAL QUANTITY	CONSTR. CODE	CONSTR. CODE
				KANKAKEE CO.	IROQUOIS CO.
				ROADWAY 0005 RURAL	ROADWAY 0005 RURAL
20400800	FURNISHED EXCAVATION	CU YD	25.7	4.4	21.3
25000200	SEEDING, CLASS 2	ACRE	0.17	0.02	0.15
25000400	NITROGEN FERTILIZER NUTRIENT	POUND	15.3	1.8	13.5
25000500	PHOSPHORUS FERTILIZER NUTRIENT	POUND	15.3	1.8	13.5
25000600	POTASSIUM FERTILIZER NUTRIENT	POUND	15.3	1.8	13.5
25100630	EROSION CONTROL BLANKET	SO YD	884	104	780
40200800	AGGREGATE SURFACE COURSE TYPE B	TON	120	9	111
40600100	BITUMINOUS MATERIALS (PRIME COAT)	GALLON	19767	4128	15639
40600300	AGGREGATE (PRIME COAT)	TON	305	63	242
40600400	MIXTURE FOR CRACKS, JOINTS, AND FLANGEWAYS	TON	44	9	35
40600525	LEVELING BINDER (HAND METHOD), N50	TON	74	15	59
40600625	LEVELING BINDER (MACHINE METHOD), N50	TON	5653	722	4931
40600895	CONSTRUCTING TEST STRIP	EACH	1	0.2	0.8
40600990	TEMPORARY RAMP	SO YD	387	158	229

• SPECIALTY ITEMS

FILE NAME =	USER NAME = carcoran\m	DESIGNED -	REVISED -
ct:\pw\work\p\widot\carcoran\m\0135018\066921-sht-S00.dgn		DRAWN -	REVISED -
	PLOT SCALE = 100.0000' / 1" =	CHECKED -	REVISED -
	PLOT DATE = 12/13/2011	DATE -	REVISED -

STATE OF ILLINOIS
DEPARTMENT OF TRANSPORTATION

SUMMARY OF QUANTITIES

SCALE: SHEET NO. OF SHEETS STA. TO STA.

F.A.P. RTE.	SECTION	COUNTY	TOTAL SHEETS	SHEET NO.
332	14,5,H,K,C-1RS-4		20	3
• KANKAKEE & IROQUOIS		CONTRACT NO. 66921		
ILLINOIS FED. AID PROJECT				

80% FED.
20% STATE

CODE NO.	ITEM	UNIT	TOTAL QUANTITY	CONSTR. CODE	
				KANKAKEE CO.	IROQUOIS CO.
				ROADWAY 0005 RURAL	ROADWAY 0005 RURAL
40603335	HOT-MIX ASPHALT SURFACE COURSE, MIX "D", N50	TON	12388	2527	9861
40800050	INCIDENTAL HOT-MIX ASPHALT SURFACING	TON	521	148	373
42400100	PORTLAND CEMENT CONCRETE SIDEWALK 4 INCH	SO FT	909	909	0
42400800	DETECTABLE WARNINGS	SO FT	120	120	0
44000155	HOT-MIX ASPHALT SURFACE REMOVAL, 1 1/2"	SO YD	152970	31823	121147
44000158	HOT-MIX ASPHALT SURFACE REMOVAL, 2 1/4"	SO YD	12975	12975	0
44000600	SIDEWALK REMOVAL	SO FT	855	855	0
44201803	CLASS D PATCHES, TYPE II, 13 INCH	SO YD	398	0	398
44201807	CLASS D PATCHES, TYPE III, 13 INCH	SO YD	20	0	20
44201809	CLASS D PATCHES, TYPE IV, 13 INCH	SO YD	27	0	27
48101200	AGGREGATE SHOULDER, TYPE B	TON	2457	349	2108
60255500	MANHOLES TO BE ADJUSTED	EACH	8	8	0
66700205	PERMANENT SURVEY MARKERS, TYPE 1	EACH	9	1	8
67000400	ENGINEER'S FIELD OFFICE, TYPE A	CAL MO	4	0.8	3.2

* SPECIALTY ITEMS

FILE NAME =	USER NAME = corcoranlm	DESIGNED -	REVISED -	STATE OF ILLINOIS DEPARTMENT OF TRANSPORTATION	SUMMARY OF QUANTITIES				F.A.P. RTE.	SECTION	COUNTY	TOTAL SHEETS	SHEET NO.		
c:\pwwork\pwwork\corcoranlm\d0135018\d0135018.dgn	66921-sht-S00.dgn	DRAWN -	REVISED -		SCALE:	SHEET NO.	OF	SHEETS	STA.	TO STA.	332	(4,5,H,K,C-1)RS-4	*	20	4
		CHECKED -	REVISED -						* KANKAKEE & IROQUOIS		CONTRACT NO. 66921				
		DATE -	REVISED -						ILLINOIS FED. AID PROJECT						

80% FED.
20% STATE

CODE NO.	ITEM	UNIT	TOTAL QUANTITY	CONSTR. CODE	
				KANKAKEE CO.	IROQUOIS CO.
				ROADWAY	ROADWAY
				0005	0005
				RURAL	RURAL
67100100	MOBILIZATION	L SUM	1	0.2	0.8
70100450	TRAFFIC CONTROL AND PROTECTION, STANDARD 701201	L SUM	1	0.2	0.8
70100460	TRAFFIC CONTROL AND PROTECTION, STANDARD 701306	L SUM	1	0.2	0.8
70102620	TRAFFIC CONTROL AND PROTECTION, STANDARD 701501	L SUM	1	0.2	0.8
70102620	TRAFFIC CONTROL AND PROTECTION,	L SUM	1	0.2	0.8
70300100	SHORT-TERM PAVEMENT MARKING <i>STANDARD 701801</i>	FOOT	18672	6099	12573
70300210	TEMPORARY PAVEMENT MARKING - LETTERS AND SYMBOLS	SO FT	156	156	0
70300220	TEMPORARY PAVEMENT MARKING - LINE 4"	FOOT	99808	15254	84554
70300240	TEMPORARY PAVEMENT MARKING - LINE 6"	FOOT	12997	2518	10479
70300250	TEMPORARY PAVEMENT MARKING - LINE 8"	FOOT	524	524	0
70300260	TEMPORARY PAVEMENT MARKING - LINE 12"	FOOT	180	180	0
70300280	TEMPORARY PAVEMENT MARKING - LINE 24"	FOOT	89	89	0
70301000	WORK ZONE PAVEMENT MARKING REMOVAL	SO FT	2074	677	1397
78000100	THERMOPLASTIC PAVEMENT MARKING - LETTERS AND SYMBOLS	SO FT	156	156	0
78000200	THERMOPLASTIC PAVEMENT MARKING - LINE 4"	FOOT	2934	2934	0

• SPECIALTY ITEMS

CODE NO.	ITEM	UNIT	TOTAL QUANTITY	CONSTR. CODE	CONSTR. CODE
				KANKAKEE CO.	IROQUOIS CO.
				ROADWAY 0005 RURAL	ROADWAY 0005 RURAL
78000400	THERMOPLASTIC PAVEMENT MARKING - LINE 6"	FOOT	978	978	0
78000500	THERMOPLASTIC PAVEMENT MARKING - LINE 8"	FOOT	524	524	0
78000600	THERMOPLASTIC PAVEMENT MARKING - LINE 12"	FOOT	180	180	0
78001110	PAINT PAVEMENT MARKING - LINE 4"	FOOT	96874	12320	84554
78001130	PAINT PAVEMENT MARKING - LINE 6"	FOOT	12019	1540	10479
78003180	PREFORMED PLASTIC PAVEMENT MARKING, TYPE B - LINE 24"	FOOT	89	89	0
78100100	RAISED REFLECTIVE PAVEMENT MARKER	EACH	694	172	522
78200300	PRISMATIC CURB REFLECTOR	EACH	15	15	0
78300200	RAISED REFLECTIVE PAVEMENT MARKER REMOVAL	EACH	550	157	393
X4400500	COMBINATION CURB AND GUTTER REMOVAL (SPECIAL)	FOOT	116	116	0
X6061700	COMBINATION CONCRETE CURB AND GUTTER, TYPE B (SPECIAL)	FOOT	118	118	0
Z0021700	EXPANSION JOINT REHABILITATION	FOOT	230	0	230
Z0034105	MATERIAL TRANSFER DEVICE	TON	12388	2527	9861
Z0055300	RUMBLE STRIP	EACH	1	0	1
② Z0076600	TRAINEES	HOUR	1000	1000	

② 0042
 * SPECIALTY ITEMS

FILE NAME =	USER NAME = corcoran	DESIGNED -	REVISED -	STATE OF ILLINOIS DEPARTMENT OF TRANSPORTATION	SUMMARY OF QUANTITIES				F.A.P. RTE.	SECTION	COUNTY	TOTAL SHEETS	SHEET NO.
c:\pwwork\pwwork\corcoran\08135018\066921-sht-500.dgn		DRAWN -	REVISED -						332	(4,5,H,K,C-1)RS-4	*	20	6
PLOT SCALE = 100.0000' / in.		CHECKED -	REVISED -		* KANKAKEE & IROQUOIS				CONTRACT NO. 66921				
PLOT DATE = 12/13/2011		DATE -	REVISED -		ILLINOIS FED. AID PROJECT								

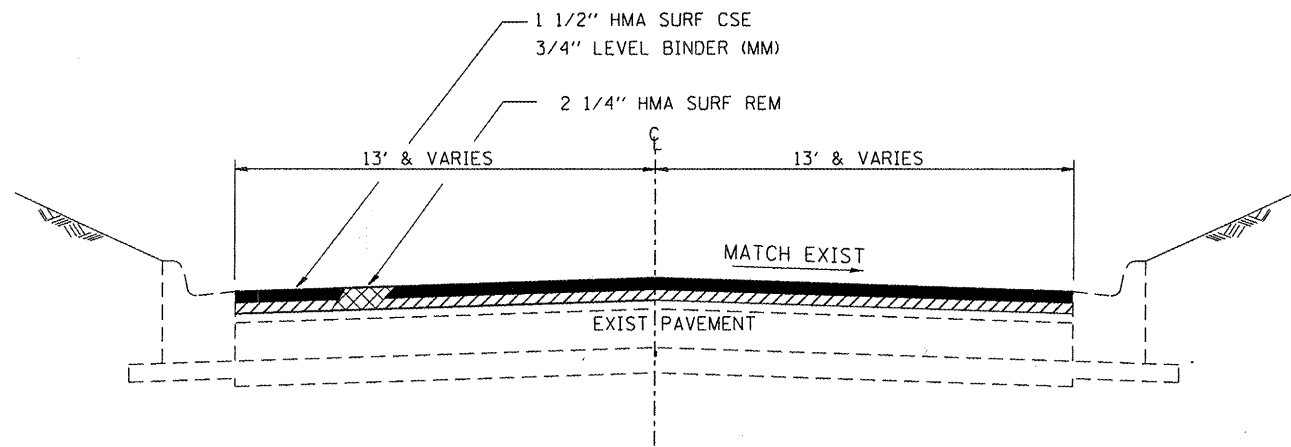

PROPOSED TYPICAL SECTION

352+33 TO 393+25 BK

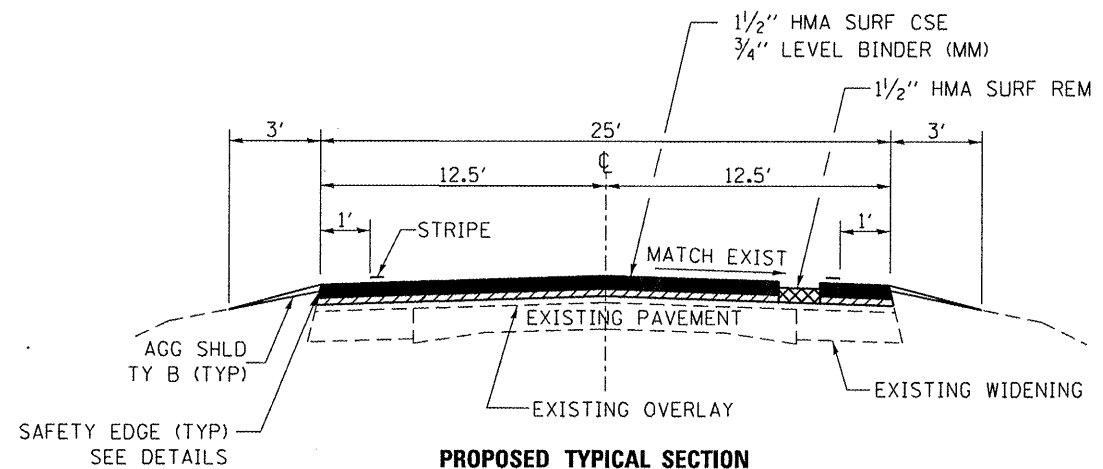

PROPOSED TYPICAL SECTION

387+42 AH TO 535+40
 546+88 TO 754+39
 760+63 TO 827+26
 834+77 TO 865+22

STATION EQUATION:
 393+25 BK = 387+42 AH

OMISSIONS
 STA 540+68 TO 542+58
 STA 756+54 TO 758+20

MIX DESIGN					
MIX	PG GRADE	DESIGN AIR VOIDS	MIX COMPOSITION	FRICTION AGG	DENSITY TEST METHOD
HOT-MIX ASPHALT SURFACE COURSE	PG64-22	4.0% @ N50	IL 9.5	MIX C	CORRELATION
LEVELING BINDER (MM)	PG64-22	4.0% @ N50	IL 9.5		SATISFACTION OF ENGINEER

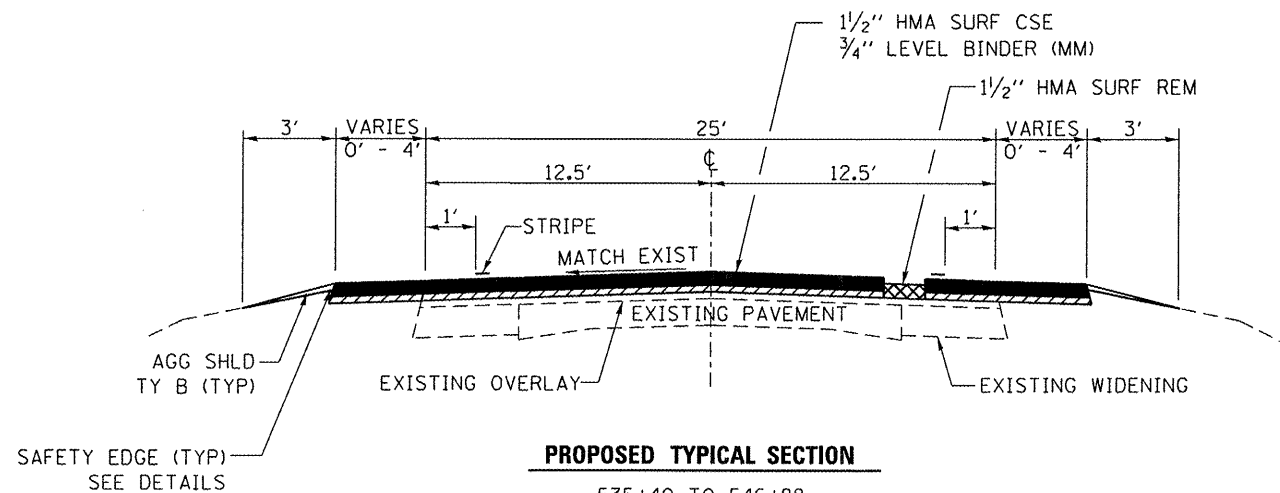

PROPOSED TYPICAL SECTION

535+40 TO 546+88
 754+39 TO 760+63
 827+26 TO 834+77
 865+22 TO 868+14

FILE NAME =	USER NAME = corcoranm	DESIGNED -	REVISED -
c:\pwwork\pwwork\corcoranm\d0135018\066921-sht-typical.dgn		DRAWN -	REVISED -
PLOT SCALE = 100.0000 1/1 in.		CHECKED -	REVISED -
PLOT DATE = 12/13/2011		DATE -	REVISED -

**STATE OF ILLINOIS
 DEPARTMENT OF TRANSPORTATION**

TYPICAL SECTIONS			
SCALE:	SHEET	OF SHEETS	STA. TO STA.

F.A.P. RTE.	SECTION	COUNTY	TOTAL SHEETS	SHEET NO.
332	(4,5,H,K,C)-IRS-4	*	20	7
KANKAKEE & IROQUOIS			CONTRACT NO. 66921	
ILLINOIS FED. AID PROJECT				

MAINLINE SCHEDULE															
LOCATION	DESCRIPTION	LENGTH	AREA	HMA SURF REM 1 1/2"	HMA SURF REM 2 1/4"	HMA SURF CSE	LEVEL BINDER (MM)	BIT MATL (PR CT)	AGG (PR CT)	MIX FOR CRACKS, JTS & FLGWYS	LEVEL BINDER (HM)	TEMP RAMP	RUMBLE STRIP EACH	AGG SHLD TY B TON	
STA.		FOOT	SQ YD	SQ YD	SQ YD	TON	TON	GALLON	TON	TON	TON	SQ YD		TON	
KANKAKEE COUNTY															
352+33 TO 376+07.5		2374.5	6859.7		6859.7	576.2	288.1	891.8	13.7	2.1	3.4	21.7			
376+07.5 TO 377+97.5		190	665		665.0	55.9	27.9	86.5	1.3	0.2	0.3				
377+97.5 TO 379+23		125.5	571		571.0	48.0	24.0	74.2	1.1	0.2	0.3				
379+23 TO 381+59		236	1248.9		1248.9	104.9	52.5	162.4	2.5	0.4	0.6				
381+59 TO 382+91		132	560.3		560.3	47.1	23.5	72.8	1.1	0.2	0.3				
382+91 TO 384+41		150	516.7		516.7	43.4	21.7	67.2	1.0	0.2	0.3				
384+41 TO 393+25 BK		884	2553.8		2553.8	214.5	107.3	332.0	5.1	0.8	1.3				
387+42 AH TO 449+02		6160	17111.1		17111.1	1471.9	718.7	2224.4	34.2	5.1	8.6			350.8	
KANKAKEE COUNTY SUBTOTALS					17111.1	12975.4	2561.9	1263.7	3911.3	60.0	9.2	15.1	21.7	0	350.8
IROQUOIS COUNTY															
449+02 TO 535+40		8638	23994.4		23994.4	2064.0	1007.8	3119.3	48.0	7.2	12.0			491.9	
535+40 TO 540+38		498	1826		1826.0	156.2	76.7	237.4	3.7	0.5	0.9				
540+38 TO 540+68	BUTT JOINT	30	110		110.0	9.4	4.6	14.3	0.2	0.0	0.1	14.4			
540+68 TO 542+58	S.N. 038-0206 OMISSION	190													
542+58 TO 542+88	BUTT JOINT	30	110		110.0	9.4	4.6	14.3	0.2	0.0	0.1	14.4			
542+88 TO 546+88		400	1466.7		1466.7	125.4	61.6	190.7	2.9	0.4	0.7				
546+88 TO 754+39		20751	57641.7		57641.7	4958.2	2421.0	7493.4	115.3	17.3	28.8			1181.7	
754+39 TO 756+24		185	678.3		678.3	58.0	28.5	88.2	1.4	0.2	0.3				
756+24 TO 756+54	BUTT JOINT	30	110		110.0	9.4	4.6	14.3	0.2	0.0	0.1	14.4			
756+54 TO 758+20	S.N. 038-0019 OMISSION	166													
758+20 TO 758+50	BUTT JOINT	30	110		110.0	9.4	4.6	14.3	0.2	0.0	0.1	14.4			
758+50 TO 760+63		213	781		781.0	66.8	32.8	101.5	1.6	0.2	0.4				
760+63 TO 827+26		6663	18508.3		18508.3	1592.1	777.3	2406.1	37.0	5.6	9.3			379.4	
827+26 TO 834+77	S.N. 038-2500	751	2523.1		2523.1	216.2	106.0	328.0	5.0	0.8	1.3			42.8	
834+77 TO 865+22		3045	8569.4		8569.4	736.9	359.9	1114.0	17.1	2.6	4.3		1		
865+22 TO 866+04	S.N. 038-0020	82	255.1		255.1	21.9	10.7	33.2	0.5	0.1	0.1				
866+04 TO 867+84		180	611.1		611.1	52.3	25.7	79.4	1.2	0.2	0.3			10.3	
867+84 TO 868+14	BUTT JOINT	30	96.7		96.7	8.3	4.1	12.6	0.2	0.0	0.0	16.1		1.7	
IROQUOIS COUNTY SUBTOTALS					117391.8	0.0	10093.9	4930.5	15261.0	234.7	35.1	58.8	73.7	1	2107.8
TOTALS					134502.9	12975.4	12655.8	6194.2	19172.3	294.7	44.3	73.9	95.4	1	2458.6

EXPANSION JOINTS	
LOCATION	EXPANSION JOINT REHAB
STRUCTURE	FOOT
IROQUOIS COUNTY	
SN 038-0017	50
SN 038-0206	50
SN 038-0019	51
SN 038-2500	25
SN 038-0020	54
TOTAL	230

MANHOLE SCHEDULE		
LOCATION	OFFSET	MANHOLE TO BE ADJUSTED
STA	LT/RT	EACH
KANKAKEE COUNTY		
STATION STREET	LT	1
CHAPEL STREET	LT	1
377+97	RT	1
379+25	RT	1
380+15	LT	1
SCHOOL RD	LT	3
TOTAL		8

FILE NAME =	USER NAME = corcoranlm	DESIGNED -	REVISED -	STATE OF ILLINOIS DEPARTMENT OF TRANSPORTATION	SCHEDULES OF QUANTITIES				F.A.P. RTE.	SECTION	COUNTY	TOTAL SHEETS	SHEET NO.	
c:\pwwork\pwwork\corcoranlm\0135018\066921-sht-schedule.dgn	DRAWN -	REVISED -	SCALE:		SHEET NO.	OF	SHEETS	STA.	TO STA.	332	(4,5,H,K,C)-IRS-4	*	20	8
PLOT SCALE = 100.0000 ' / in.	CHECKED -	REVISED -								*	KANKAKEE & IROQUOIS	CONTRACT NO. 66921		
PLOT DATE = 12/13/2011	DATE -	REVISED -									ILLINOIS FED. AID PROJECT			

ENTRANCE SCHEDULE									
LOCATION	DESC	MAT	WIDTH	AREA	HMA SURF REM 1-1/2"	BIT MATL PR CT	AGG PRIME COAT	HMA INC SURF	AGG SURF CSE
STA			FOOT	SQ YD	SQ YD	GAL	TON	TON	TON
KANKAKEE COUNTY									
402+62 LT	FE	AGG	10	22.2					0.9
418+22 RT	PE/MB	HMA/AGG	20	33.3	36.1	2.7	0.10	3.5	0.2
422+62 RT	FE	HMA/AGG	20	33.3	29.4				2.8
437+82 RT	FE	HMA/AGG	27	41.1	24.1				3.5
448+92 RT	FE	AGG	15	27.8					1.2
KANKAKEE COUNTY SUBTOTALS					89.6	2.7	0.10	3.5	8.6
IROUOIS COUNTY									
452+65 LT	FE	AGG	20	33.3					1.4
465+98 RT	FE	AGG	9	21.1					0.9
467+48 RT	PE/MB	HMA/AGG	50	66.7	40	5.3	0.10	7.1	0.2
471+48 LT	FE	AGG	8	20					0.9
477+88 RT	FE	HMA/AGG	30	44.4	21.3				3.8
484+68 RT	FE	HMA/AGG	20	33.3	30				2.8
485+48 LT	FE	AGG	15	27.8					1.2
491+08 RT	FE	HMA/AGG	20	33.3	22.7				2.8
493+88 LT	PE	HMA/AGG	20	33.3	16.7	2.7	0.10	3.5	0.7
493+88 RT	MB	HMA	31	45.6	27.3	3.6	0.10	4.9	
524+68 RT	FE	HMA/AGG	23	36.7	27.1				3.1
535+48 LT	FE	HMA/AGG	20	33.3	24.9				2.8
539+48 RT	FE	HMA/AGG	20	33.3	23.6				2.8
540+67 LT	PE	HMA/AGG	15	27.8	13.9	2.2	0.10	3.0	0.6
542+59 LT	PE	HMA/AGG	15	27.8	13.9	2.2	0.10	3.0	0.6
549+48 LT	PE	AGG	23	36.7					1.6
552+68 RT	CE/MB	AGG	20	33.3		2.7	0.10	3.5	0.2
554+68 RT	CE	HMA/EARTH	90	111.1	60	8.9	0.20	11.8	2.4
557+08 LT	FE	HMA/AGG	22	35.6	18				3.0
557+08 RT	FE	HMA/DIRT	20	33.3	30				2.8
569+08 RT	FE	HMA/AGG	45	61.1	51.1				5.2
569+88 LT	FE	HMA/AGG	24	37.8	19.3				3.2
581+08 RT	PE/MB	HMA/AGG	72	91.1	35.3	7.3	0.20	9.7	0.2
582+89 LT	FE	AGG	8	20					0.9

ENTRANCE SCHEDULE (CONTINUED)									
LOCATION	DESC	MAT	WIDTH	AREA	HMA SURF REM 1-1/2"	BIT MATL PR CT	AGG PRIME COAT	HMA INC SURF	AGG SURF CSE
STA			FOOT	SQ YD	SQ YD	GAL	TON	TON	TON
IROUOIS COUNTY									
636+68 RT	FE	EARTH	8	20					
642+88 RT	FE	EARTH	8	20					
645+28 LT	PE/MB	HMA/AGG	36	51.1	58.9	4.1	0.10	5.4	0.2
646+68 LT	MB	HMA	54	24	24	1.9	0.05	2.6	
646+68 RT	PE	AGG	16	28.9					1.2
647+48 RT	FE	AGG	8	20					0.9
655+68 LT	PE	HMA/AGG	20	33.3	31.1	2.7	0.10	3.5	0.7
668+28 RT	PE	HMA/CONC	19	32.2	27.2	2.6	0.10	3.4	
668+28 LT	MB	HMA	66	44	44	3.5	0.10	4.7	
671+31 RT	FE	EARTH	8	20					
671+31 LT	FE	EARTH	8	20					
678+88 RT	FE	HMA/AGG	24	37.8	31.6				3.2
678+88 LT	NO MB	HMA	68	45.3	45.3				3.9
688+28 LT	PE/MB	HMA	20	33.3	33.3	2.7	0.10	3.5	0.2
701+08 LT	FE	HMA/EARTH	20	33.3	15				2.8
701+08 RT	FE	HMA/AGG	25	38.9	20				3.3
714+48 RT	FE	HMA/EARTH	48	64.4	35.3				5.5
717+28 LT	PE/MB	HMA/AGG	30	44.4	40.6	3.6	0.10	4.7	0.2
727+48 RT	PE	HMA/AGG	16	28.9	17.5	2.3	0.10	3.1	0.6
727+48 LT	MB	HMA/AGG	35	15.6	15.6	1.2	0.03	1.7	
742+28 RT	FE	HMA	24	37.8	23.6				3.2
747+08 LT	PE/MB	HMA/AGG	15	27.8	30.6	2.2	0.10	3.0	0.2
749+48 LT	FE	HMA/AGG	20	33.3	28.9				2.8
753+28 RT	FE	HMA	20	33.3	16.7				2.8
753+88 RT	FE	HMA	29	43.3	22				3.7
760+28 LT	PE	HMA/AGG	12	24.4	23.3	2.0	0.05	2.6	1.0
761+08 LT	MB	HMA	65	57.8	57.8	4.6	0.10	6.1	
763+28 RT	CE	HMA/AGG	30	44.4	47.2	3.6	0.10	4.7	0.9
764+68 RT	PE	HMA/AGG	25	38.9	38.3	3.1	0.10	4.1	0.8
766+28 LT	PE/CE/MB	HMA/AGG	100	111.1	111.1	8.9	0.20	11.8	0.2
766+68 RT	PE	AGG	32	46.7					2.0
767+48 LT	TAPER	HMA	70	31.1	31.1	2.5	0.10	3.3	
769+08 RT	PE	HMA/AGG	13	25.6	13.2	2.0	0.10	2.7	0.5
770+28 RT	PE	HMA/AGG	18	31.1	24	2.5	0.10	3.3	0.7
770+28 LT	MB	HMA/AGG	62	27.6	27.6	2.2	0.10	2.9	
777+88 LT	CE/MB	AGG	150	83.3					0.2
778+28 LT	CE	HMA	175	194.4	194.4	15.6	0.40	20.7	4.1
784+28 LT	PE/MB	HMA	15	27.8	25	2.2	0.10	3.0	0.2
787+68 RT	FE	GRASS	16	28.9					
787+68 LT	PE	AGG	20	33.3					1.4
788+08 LT	PE	AGG	20	8.9					0.4
804+48 RT	PE	HMA/AGG	42	57.8	31.3	4.6	0.10	6.1	1.2
804+48 LT	MB	HMA	60	40	40	3.2	0.10	4.3	
809+28 LT	FE	HMA	20	8.9	8.9				0.8
821+48 LT	PE/MB	AGG	15	27.8					0.2
823+48 RT	FE	HMA/AGG	10	22.2	11.1				1.9
829+00 RT	FE	HMA/EARTH	10	22.2	11.1				1.9
842+28 RT	FE	EARTH	15	27.8					
842+28 LT	PE/MB	HMA/AGG	25	38.9	33.3	3.1	0.10	4.1	0.2
863+48 RT	FE	HMA	25	16.7	16.7				1.4
863+48 LT	FE	HMA	25	16.7	16.7				1.4
IROUOIS COUNTY SUBTOTALS					1798.4	124.0	3.7	164.8	100.9
TOTALS					1888	127	4	168	110

NOTE: HMA APRONS SHALL NOT BE REPLACED AT FIELD ENTRANCES.

FILE NAME =	USER NAME = corcoranm	DESIGNED -	REVISED -	STATE OF ILLINOIS DEPARTMENT OF TRANSPORTATION	SCHEDULES OF QUANTITIES			F.A.P. RTE.	SECTION	COUNTY	TOTAL SHEETS	SHEET NO.
c:\pwork\pwork\corcoranm\0135018\0135018-1\0135018-1-sht-schedule.dgn		DRAWN -	REVISED -		332	(4,5,H,K,C-1)RS-4		20	9			
PLOT SCALE = 100.0000' / in.		CHECKED -	REVISED -		KANKAKEE & IROUOIS			CONTRACT NO.				
PLOT DATE = 12/13/2011		DATE -	REVISED -		ILLINOIS FED. AID PROJECT							
				SCALE:	SHEET NO.	OF	SHEETS	STA.	TO STA.			

PAVEMENT MARKING													
LOCATION	DESCRIPTION	LENGTH	PAINT PAVEMENT MARKING LINE			PREFORMED PLASTIC PVMT MARK, TY B	THERMOPLASTIC PAVEMENT MARKING LINE						
			4 INCH		6 INCH	24 INCH	4 INCH	6 INCH		8 INCH	12 INCH		LETTERS & SYMBOLS
			YELLOW	WHITE	YELLOW	WHITE	YELLOW	WHITE	YELLOW	WHITE	WHITE	YELLOW	& SYMBOLS
STA		FOOT	FOOT	FOOT	FOOT	FOOT	FOOT	FOOT	FOOT	FOOT	FOOT	FOOT	SO FT
KANKAKEE COUNTY													
352+33 TO 376+00	MAINLINE	2367						592					
376+00 TO 384+71	TURN LANE/MEDIAN	871				89	2454	172		524	32.2	147.7	156
384+71 TO 393+25 BK	MAINLINE/NPZ EB	854					480			214			
387+42 AH TO 449+02	MAINLINE	6160		24640	3080								
KANKAKEE COUNTY SUBTOTALS			0	24640	3080	89	2934	172	806	524	32.2	147.7	156
KANKAKEE COUNTY SUBTOTALS				24640	3080	89	2934	978	806	524	179.9	147.7	156
IROQUOIS COUNTY													
449+02 TO 860+84	MAINLINE	41182		164728	20591								
860+84 TO 868+14	NO PASS ZONE SB	730	1460	2920	365								
STOP BARS AT US 52						160							
IROQUOIS COUNTY SUBTOTALS			1460	167648	20956	160	0	0	0	0	0	0	0
IROQUOIS COUNTY SUBTOTALS				169108	20956	160	0	0	0	0	0	0	0
TOTALS			193748	24036		249	2934	978	524	179.9		156	

NOTE: ADDITIONAL QUANTITY HAS BEEN INCLUDED TO ALLOW FOR TWO SEPARATE APPLICATIONS OF PAINT PAVEMENT MARKING LINE

TEMPORARY PAVEMENT MARKING													
LOCATION	DESCRIPTION	LENGTH	SHORT TERM PAVEMENT MARKING	WORK ZONE PVMT MARK REMOVAL	TEMPORARY PAVEMENT MARKING LINE								
					4 INCH		6 INCH		8 INCH	12 INCH		24 INCH	LETTERS & SYMBOLS
					YELLOW	WHITE	YELLOW	WHITE	WHITE	WHITE	YELLOW	WHITE	SO FT
STA		FOOT	FOOT	SQ FT	FOOT	FOOT	FOOT	FOOT	FOOT	FOOT	FOOT	FOOT	SO FT
KANKAKEE COUNTY													
352+33 TO 376+00	MAINLINE	2367	711	79			592						
376+00 TO 384+71	TURN LANE/MEDIAN	871	3285	365	2454		172	524	32.2	147.7	89		156
384+71 TO 393+25 BK	MAINLINE	854	255	28	480			214					
387+42 AH TO 449+02	MAINLINE	6160	1848	205		12320		1540					
KANKAKEE COUNTY SUBTOTALS			6099	677	2934	12320	2346	172	524	32.2	147.7	89	156
KANKAKEE COUNTY SUBTOTALS			6099	677		15254	2518	524	179.9		89		156
IROQUOIS COUNTY													
449+02 TO 860+84	MAINLINE	41182	12354	1373		82364	10296						
860+84 TO 868+14	NO PASS ZONE SB	730	219	24	730	1460	183						
STOP BARS AT US 52												160	
IROQUOIS COUNTY SUBTOTALS			12573	1397	730	83824	10479	0	0	0	0	160	0
IROQUOIS COUNTY SUBTOTALS			12573	1397		84554	10479	0	0	0	160	0	0
TOTALS			18672	2074		99808	12997	524	179.9		249		156

RAISED REFLECTIVE PAVEMENT MARKER				
LOCATION	RAISED REFLECTIVE PAVEMENT MARKER		RAISED REFL PVMT MARKER REMOVAL	PRISMATIC CURB REFLECTORS
	TWO-WAY AMBER	ONE-WAY CRYSTAL		
STA	EACH	EACH	EACH	EACH
KANKAKEE COUNTY				
352+33 TO 376+00	30		30	
376+00 TO 384+71	46	8	54	
380+40				15
384+71 TO 393+25 BK	11		11	
387+42 AH TO 449+02	77		62	
	164	8	157	15
KANKAKEE COUNTY SUBTOTALS			172	157
IROQUOIS COUNTY				
449+02 TO 868+14	522		393	
	522	0	393	0
IROQUOIS COUNTY SUBTOTALS			522	393
TOTALS			694	550

FILE NAME =	USER NAME = corcoranlm	DESIGNED -	REVISED -	STATE OF ILLINOIS DEPARTMENT OF TRANSPORTATION	SCHEDULES OF QUANTITIES	F.A.P. RTE.	SECTION	COUNTY	TOTAL SHEETS	SHEET NO.	
c:\pwork\pwork\pwork\corcoranlm\0135018\0	66921-shr-schedule.dgn	DRAWN -	REVISED -			332	(4,5,H,K,C)-1RS-4	*	20	11	
	PLOT SCALE = 100.0000' / 1"	CHECKED -	REVISED -			* KANKAKEE & IROQUOIS		CONTRACT NO.			
	PLOT DATE = 12/13/2011	DATE -	REVISED -			SCALE:	SHEET OF SHEETS	STA.	TO STA.	ILLINOIS FED. AID PROJECT	

THE RESIDENT ENGINEER SHALL CONTACT BOB POUNDSTONE IN THE DISTRICT 3 BUREAU OF LAND ACQUISITION, AT 815-434-8424, TO OBTAIN TIE POINTS

STATION (REFERENCE NUMBER)	DESCRIPTION	EXISTING MONUMENT TYPE	PROPOSED MONUMENT TYPE	MONUMENT RECORD TO BE RECORDED	RESPONSIBILITY
1	S OTR CORNER SECTION 4-29N-12W 2ND PM KANKAKEE COUNTY		TYPE 1	YES	2
3	NW CORNER SECTION 16-29N-12W 2ND PM IROQUOIS COUNTY	PK	PK	NO	2
4	NE CORNER SECTION 20-29N-R12W 2ND PM IROQUOIS COUNTY	NAIL	TYPE 1	YES	2
7B	E OTR CORNER SECTION 4-28N-R12W 2ND PM IROQUOIS COUNTY		TYPE 1	YES	2
7	SW CORNER SECTION 4-28N-R12W 2ND PM IROQUOIS COUNTY		TYPE 1	YES	2
8	NW CORNER SECTION 16-28N-R12W 2ND PM IROQUOIS COUNTY	PK	TYPE 1	YES	2
9	E OTR CORNER SECTION 17-28N-R12W 2ND PM IROQUOIS COUNTY	PK	TYPE 1	YES	2
10	SE CORNER SECTION 17-28N-R12W 2ND PM IROQUOIS COUNTY	PK	TYPE 1	YES	2
11	E OTR CORNER SECTION 20-28N-R12W 2ND PM IROQUOIS COUNTY	SURVEY NAIL	TYPE 1	YES	2

NOTE: MONUMENT LOCATION TIES WILL BE AVAILABLE FROM THE DISTRICT 3 BUREAU OF LAND ACQUISITION AFTER WINTER INSPECTION

RESPONSIBILITY:
1) RESIDENT TO RE-ESTABLISH MONUMENT
2) RESIDENT TO RE-ESTABLISH MONUMENT AND FURNISH TIE SKETCHES TO D-3 PLATS AND PLANS (PAY ITEM REQUIRED. PERMANENT SURVEY MARKER, TYPE 1)
3) PROFESSIONAL LAND SURVEYOR TO RE-ESTABLISH MONUMENT, RECORD NEW MONUMENT RECORD, AND PROVIDE COPY TO D-3 PLATS AND PLANS (PAY ITEM REQUIRED - LAND SECTION MARKERS)

FILE NAME =	USER NAME = corcoran1m	DESIGNED -	REVISED -	STATE OF ILLINOIS DEPARTMENT OF TRANSPORTATION	TIE POINTS	F.A.P. RTE. =	SECTION	COUNTY	TOTAL SHEETS	SHEET NO.
ct:\pwwork\pudot\corcoran1m\0135018\066921-sh1-RTB.dgn	66921-sh1-RTB.dgn	DRAWN -	REVISED -			332	4,5,H,K,C-1RS-4	*	20	12
PLOT SCALE = 100.0000 ' / 1" =	CHECKED -	REVISED -				* KANKAKEE & IROQUOIS		CONTRACT NO. 66921		
PLOT DATE = 12/13/2011	DATE -	REVISED -				[ILLINOIS] FED. AID PROJECT				

NOT TO SCALE

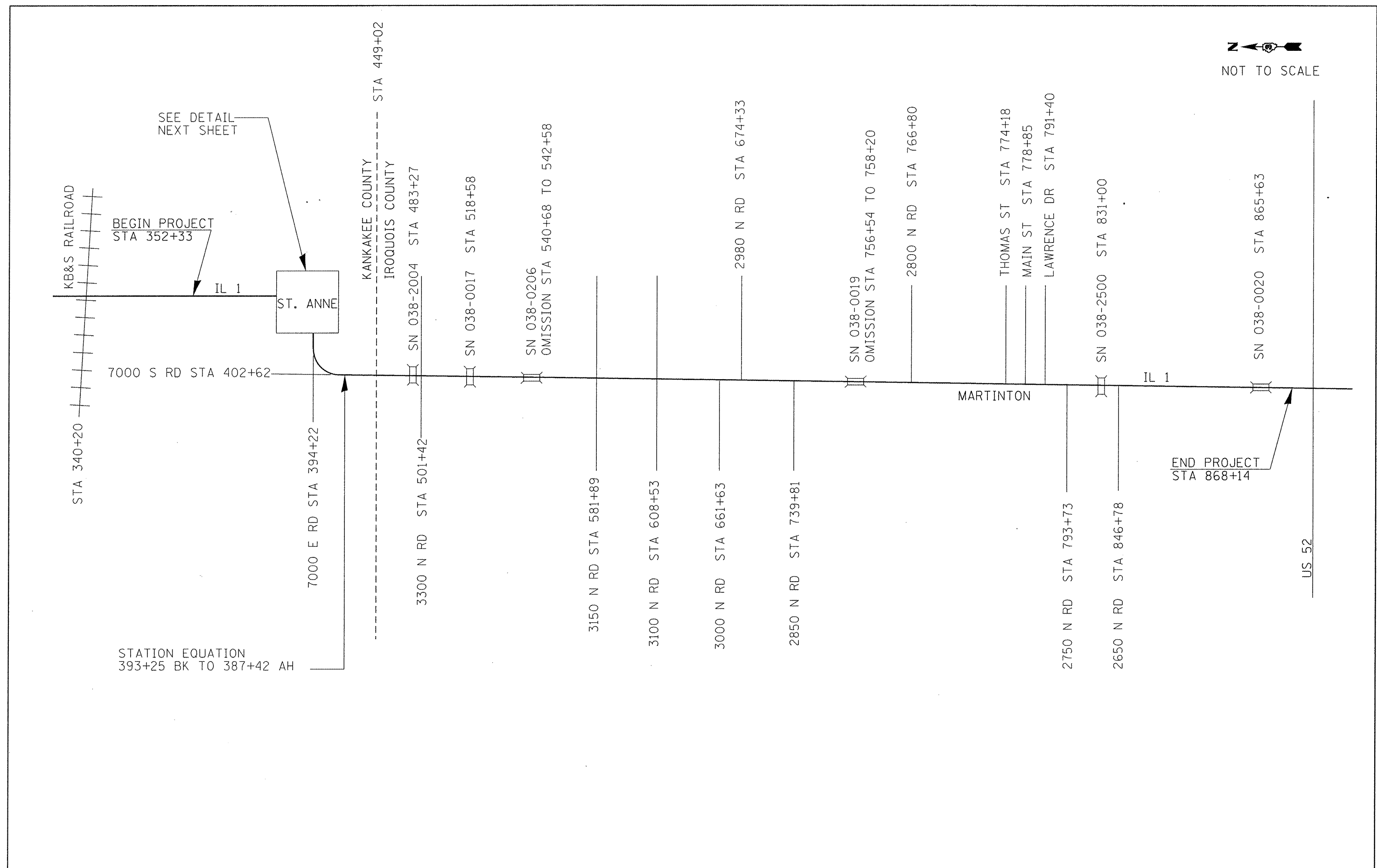

FILE NAME =	USER NAME = corcoranlm	DESIGNED -	REVISED -	STATE OF ILLINOIS DEPARTMENT OF TRANSPORTATION	PROJECT LAYOUT			F.A.P. RTE.	SECTION	COUNTY	TOTAL SHEETS	SHEET NO.		
c:\pwwork\pwwork\corcoranlm\d0135018\66921-sht-plan.dgn		DRAWN -	REVISED -		SCALE:	SHEET NO.	OF	SHEETS	STA.	TO STA.	332	(4,5,H,K,C-1)RS-4	20	13
	PLOT SCALE = 100.0000' / 1"	CHECKED -	REVISED -									* KANKAKEE & IROQUOIS		
	PLOT DATE = 12/13/2011	DATE -	REVISED -									CONTRACT NO. 66921		
											ILLINOIS FED. AID PROJECT			

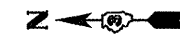

NOT TO SCALE

ST. ANNE DETAIL

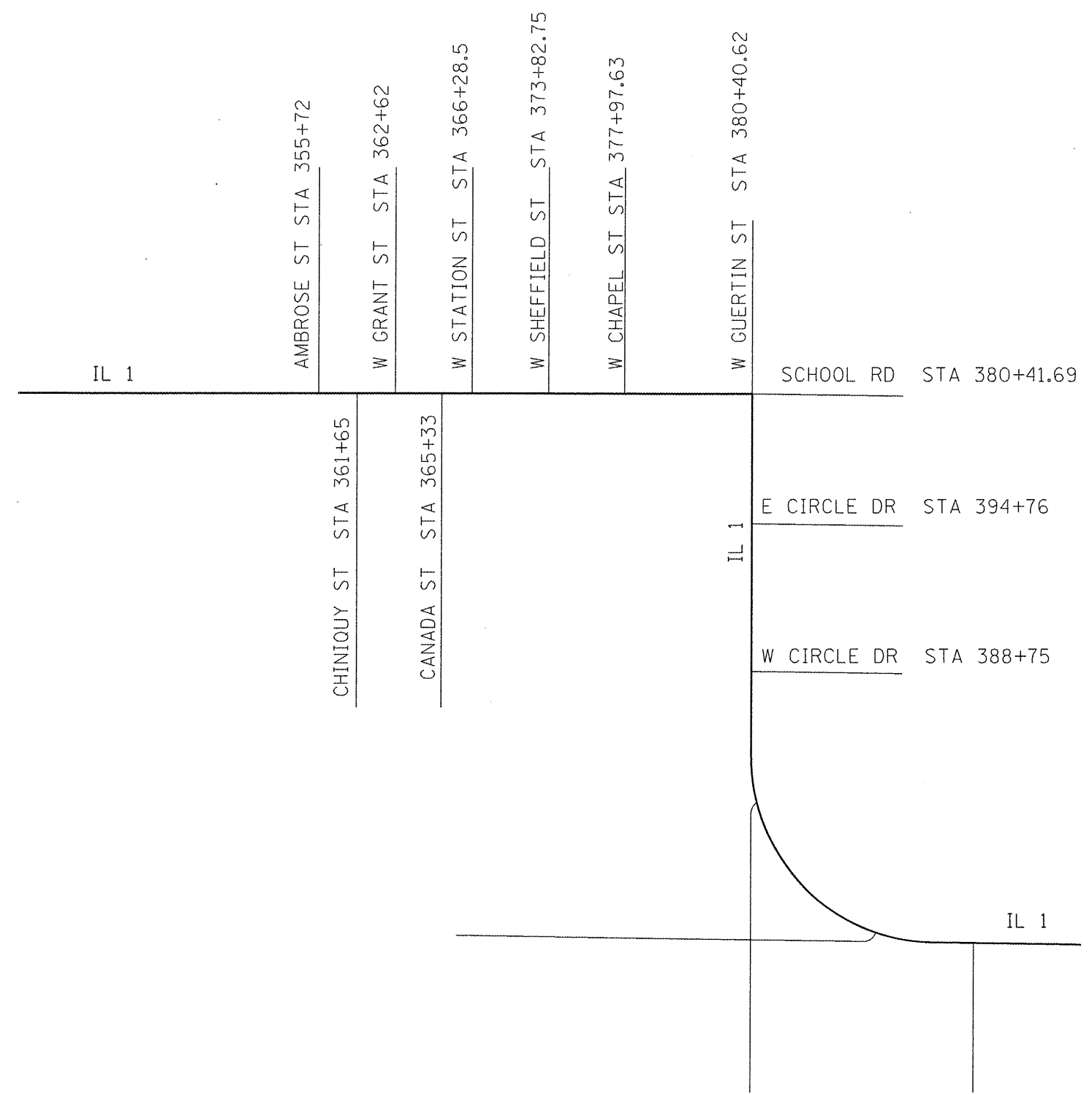

FILE NAME =	USER NAME = corcoranlm	DESIGNED -	REVISED -
cr:\pwork\pwork\corcoranlm\0135018\66921-sht-plen.dgn		DRAWN -	REVISED -
	PLOT SCALE = 100.0000' / in.	CHECKED -	REVISED -
	PLOT DATE = 12/13/2011	DATE -	REVISED -

**STATE OF ILLINOIS
DEPARTMENT OF TRANSPORTATION**

PROJECT LAYOUT			
SCALE:	SHEET NO.	OF SHEETS	STA. TO STA.

F.A.P. RTE.	SECTION	COUNTY	TOTAL SHEETS	SHEET NO.
332	(4,5,H,K,C-1)RS-4	*	20	14
* KANKAKEE & IROQUOIS			CONTRACT NO. 66921	
ILLINOIS FED. AID PROJECT				

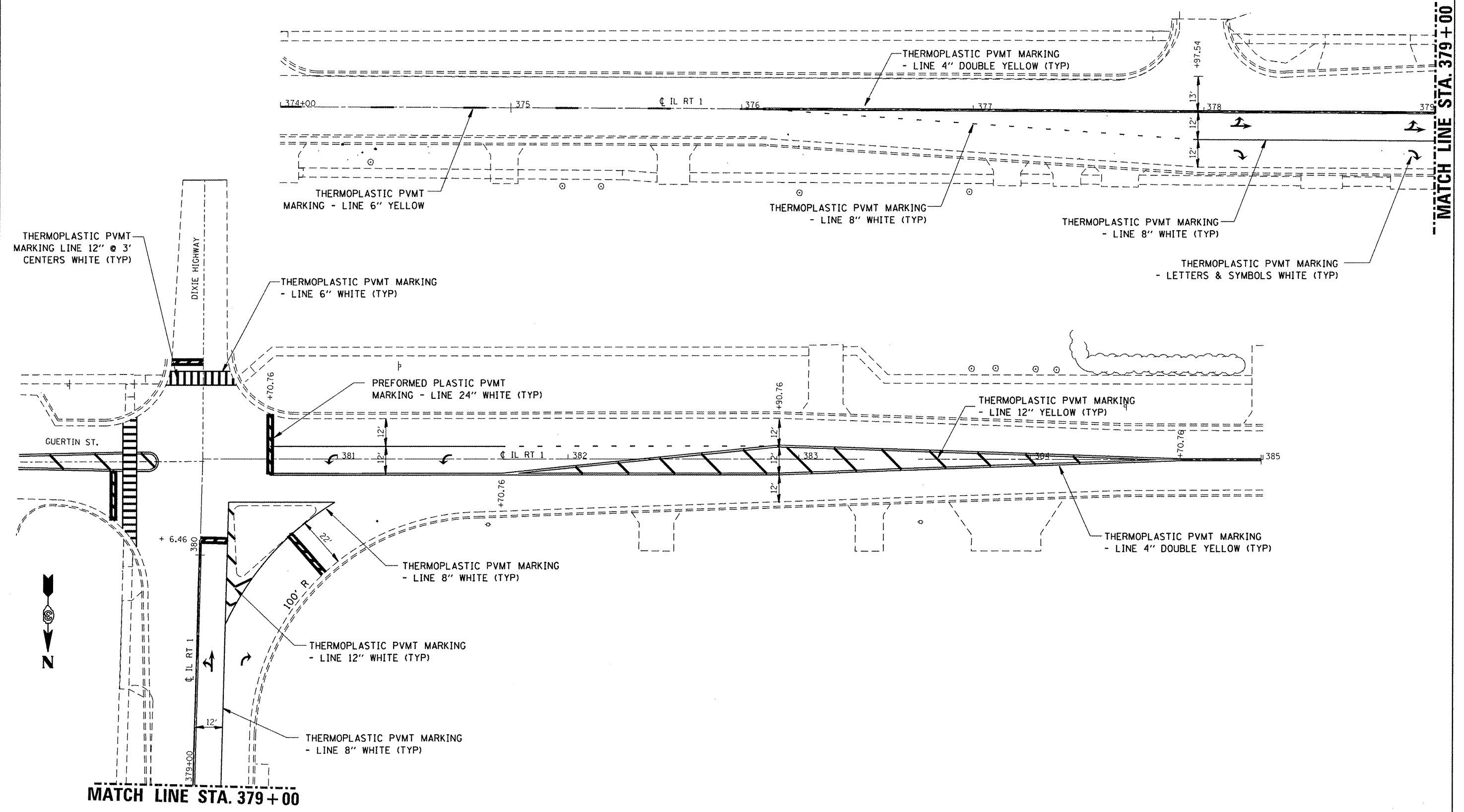

MATCH LINE STA. 379 + 00

MATCH LINE STA. 379 + 00

FILE NAME =	USER NAME = corcoranlm	DESIGNED -	REVISED -
c:\pwork\pvidot\corcoranlm\0135018\066921-sht-details.dgn		DRAWN -	REVISED -
		CHECKED -	REVISED -
		DATE -	REVISED -

**STATE OF ILLINOIS
DEPARTMENT OF TRANSPORTATION**

**PAVEMENT MARKING DETAIL
AT INTERSECTION OF IL 1 AND GUERTIN ST**

F.A.P. RTE. =	SECTION	COUNTY	TOTAL SHEETS	SHEET NO.
332	(4,5,H,K,C-1)RS-4	*	20	15
* KANKAKEE & IROUOIS			CONTRACT NO. 66921	
ILLINOIS FED. AID PROJECT				

SCALE: SHEET OF SHEETS STA. TO STA.

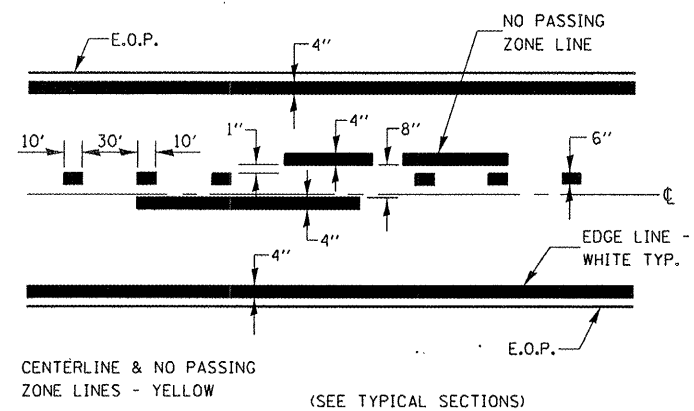

PAVEMENT MARKING

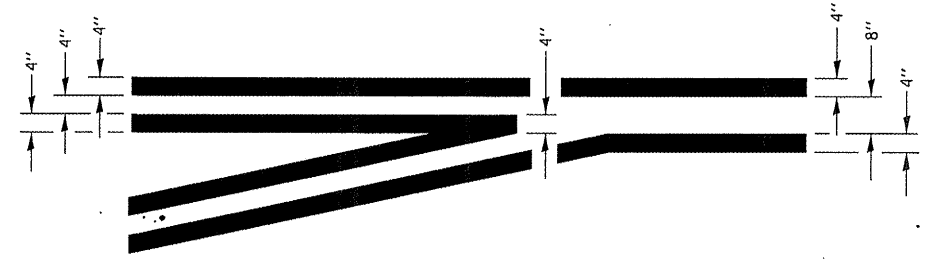

TYPICAL APPLICATION LEFT TURN LANES

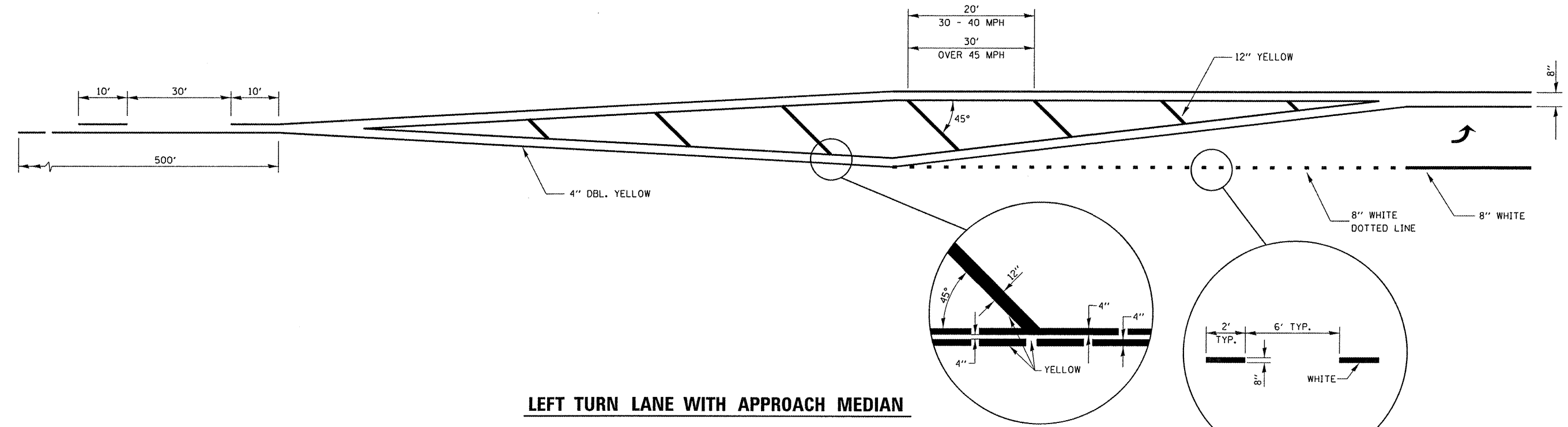

LEFT TURN LANE WITH APPROACH MEDIAN

FILE NAME =	USER NAME = corcoranm	DESIGNED -	REVISED -
c:\pwork\pwork\corcoranm\0135018\066921-shr-detail.dgn		DRAWN -	REVISED -
	PLOT SCALE = 100.0000" / in.	CHECKED -	REVISED -
	PLOT DATE = 12/13/2011	DATE -	REVISED -

**STATE OF ILLINOIS
DEPARTMENT OF TRANSPORTATION**

DETAILS			
SCALE:	SHEET NO.	OF SHEETS	STA. TO STA.

F.A.P. RTE.	SECTION	COUNTY	TOTAL SHEETS	SHEET NO.
332	(4,5,H,K,C-1)RS-4		20	16
KANKAKEE & IROQUOIS			CONTRACT NO. 66921	
ILLINOIS FED. AID PROJECT				

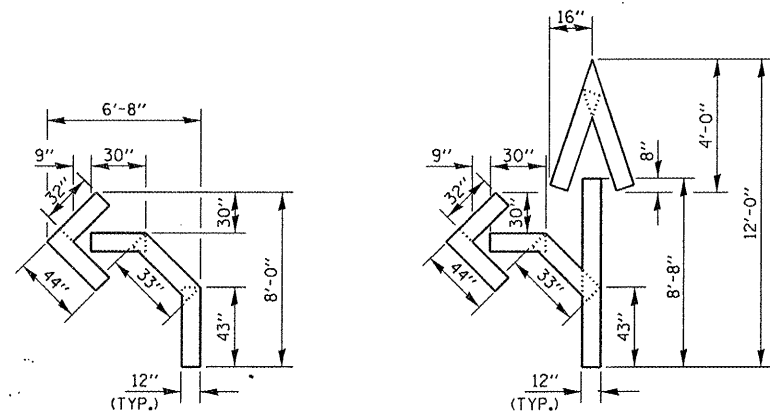

QUANTITY
12" LINE = 16 LIN. FT.
OR 4" LINE = 48 LIN. FT.

QUANTITY
12" LINE = 29 LIN. FT.
OR 4" LINE = 87 LIN. FT.

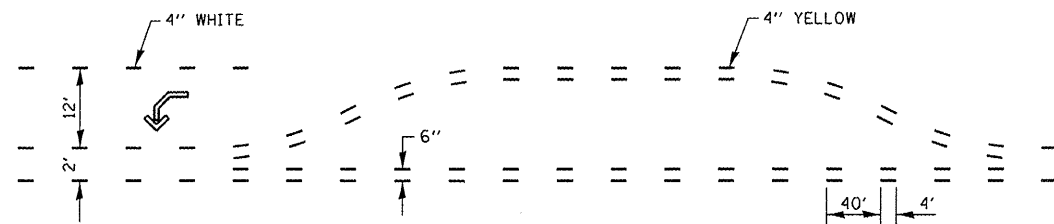

**SHORT-TERM PAVEMENT MARKING
FOR MEDIANS AND ARROWS**

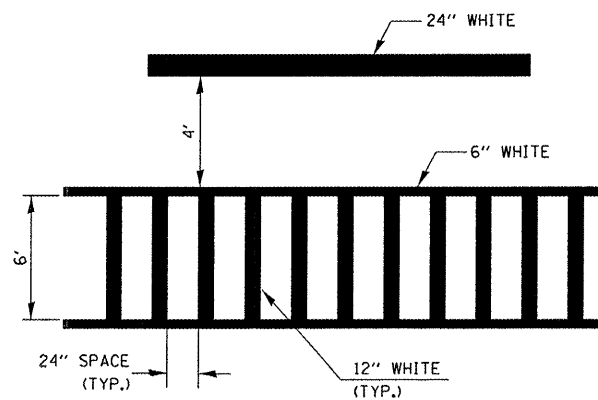

**TYPICAL SPACING DETAIL FOR
CROSSWALKS AND STOP BARS**

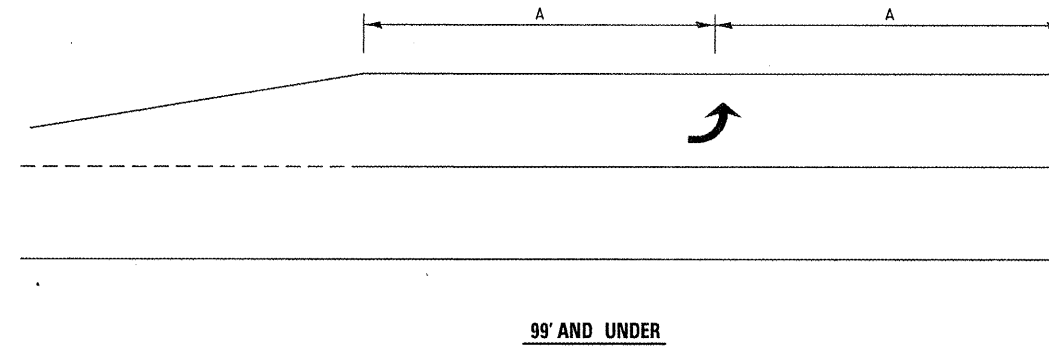

99' AND UNDER

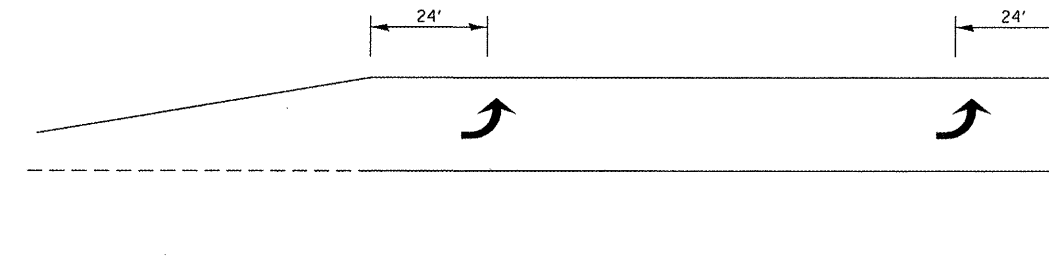

100' TO 149'

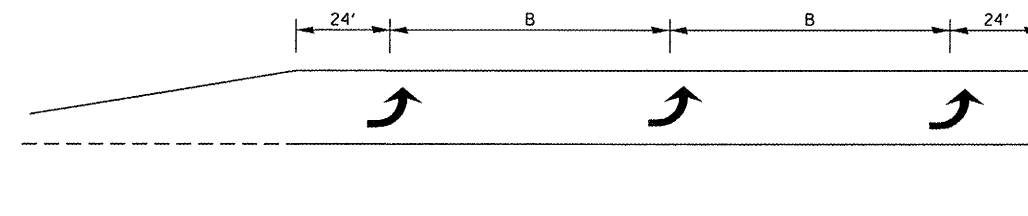

150' AND LONGER

**TYPICAL PLACEMENT OF ARROWS
IN TURN LANES**

FILE NAME =	USER NAME = corcoranlm	DESIGNED -	REVISED -
ca:\pwork\pwsdot\corcoranlm\d0135018\066921-sht-details.dgn		DRAWN -	REVISED -
PLOT SCALE = 100.0000' / 1"		CHECKED -	REVISED -
PLOT DATE = 12/13/2011		DATE -	REVISED -

STATE OF ILLINOIS
DEPARTMENT OF TRANSPORTATION

DETAILS				
SCALE:	SHEET NO.	OF SHEETS	STA.	TO STA.

F.A.P. RTE.	SECTION	COUNTY	TOTAL SHEETS	SHEET NO.
332	(4,5,H,K,C-1)RS-4	*	20	17
* KANKAKEE & IROQUOIS			CONTRACT NO. 66921	
ILLINOIS FED. AID PROJECT				

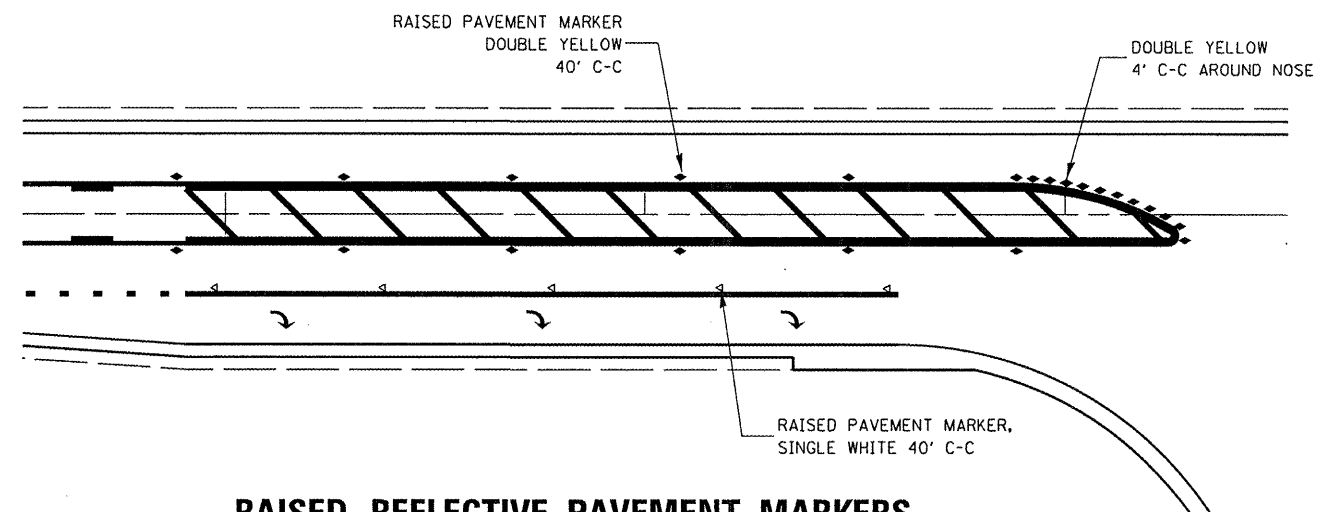

**RAISED REFLECTIVE PAVEMENT MARKERS
RIGHT TURN LANE**

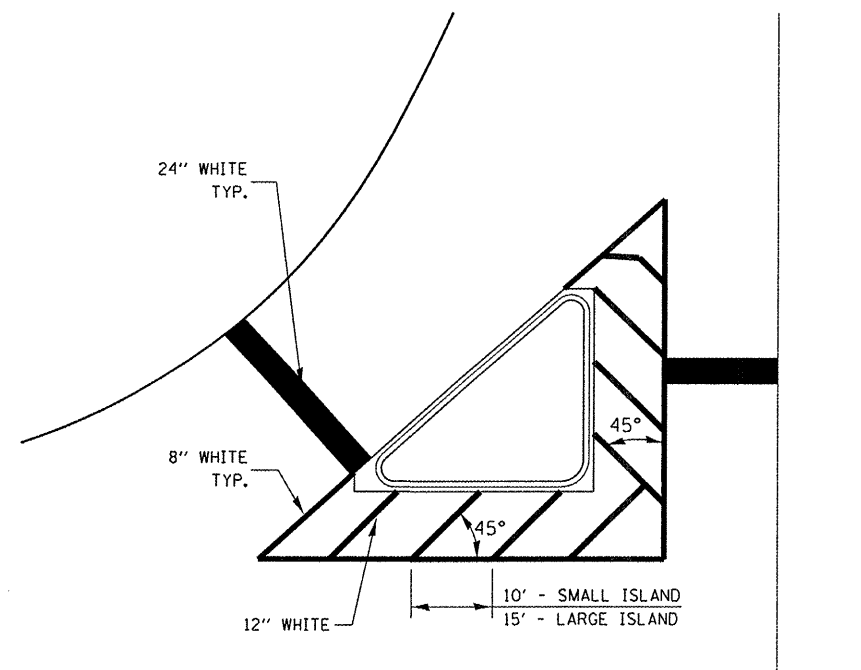

TYPICAL ISLAND

FILE NAME =	USER NAME = corcoranlm	DESIGNED -	REVISED -
c:\pwork\pwork\corcoranlm\30135018\066921-sht-details.dgn		DRAWN -	REVISED -
PLOT SCALE = 100.0000' / 1in.		CHECKED -	REVISED -
PLOT DATE = 12/13/2011		DATE -	REVISED -

**STATE OF ILLINOIS
DEPARTMENT OF TRANSPORTATION**

DETAILS			
SCALE:	SHEET	OF	SHEETS
			STA.
			TO STA.

F.A.P. RTE.	SECTION	COUNTY	TOTAL SHEETS	SHEET NO.
332	(4,5,H,K,C-1)RS-4	*	20	18
* KANKAKEE & IROUOIS			CONTRACT NO. 66921	
ILLINOIS FED. AID PROJECT				

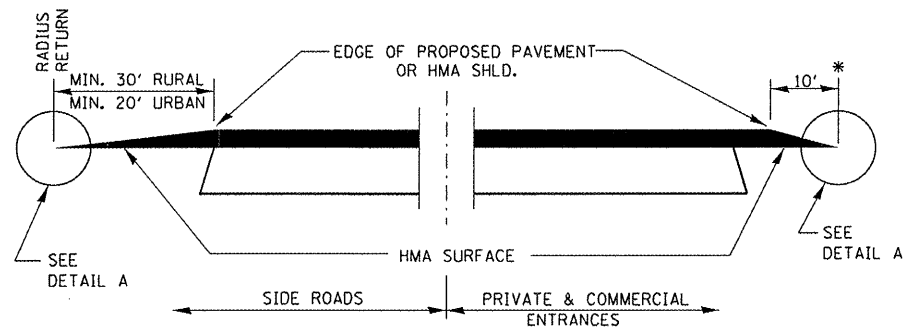

SECTION A-A
DETAILS AT ENTRANCES & SIDE ROADS

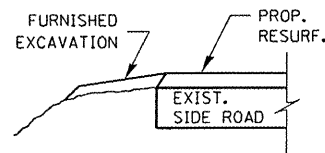

SECTION B-B

THE COST OF REMOVAL AT EXISTING HMA OR P.C.C. LOCATIONS SHALL BE PAID FOR PER SQ. YD. BY THE APPROPRIATE PAY ITEM. REMOVAL AT THE EXISTING AGG. LOCATIONS SHALL BE INCIDENTAL TO THE HMA. A-3 LOCATIONS SHALL BE FEATHER TAPERED.

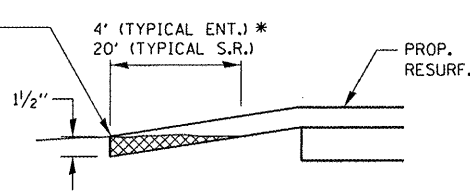

DETAIL A

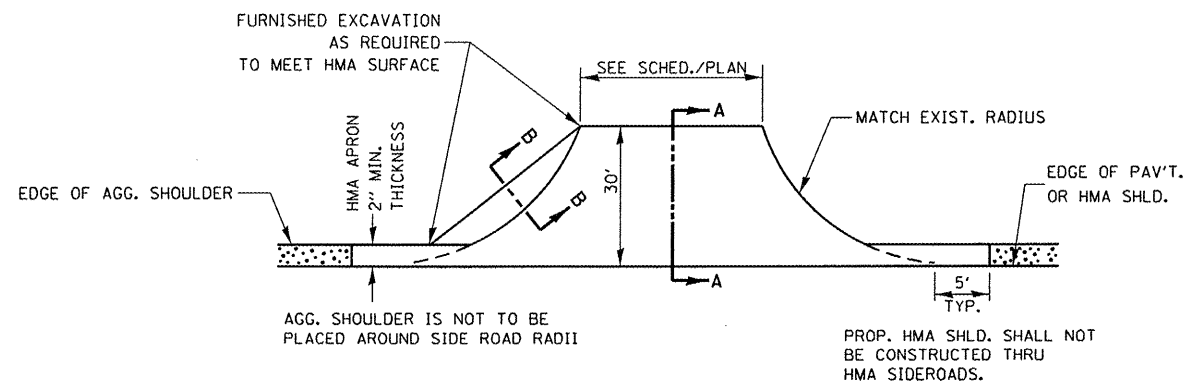

PLAN AT SIDE ROADS

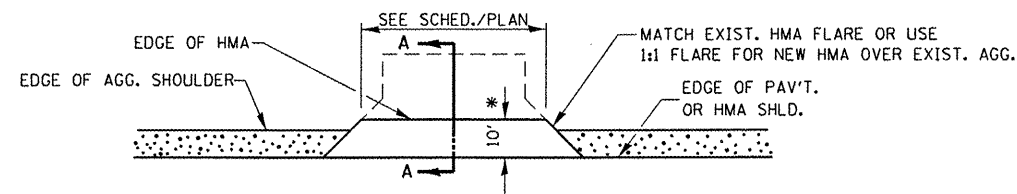

PLAN AT PRIVATE & COMMERCIAL ENTRANCES

(DO NOT RESURFACE FIELD ENTRANCES)

* PROPOSED HMA RESURFACING AT PUBLIC EDUCATIONAL FACILITY ENTRANCES SHALL BE EXTENDED TO THE RIGHT-OF-WAY LIMITS.

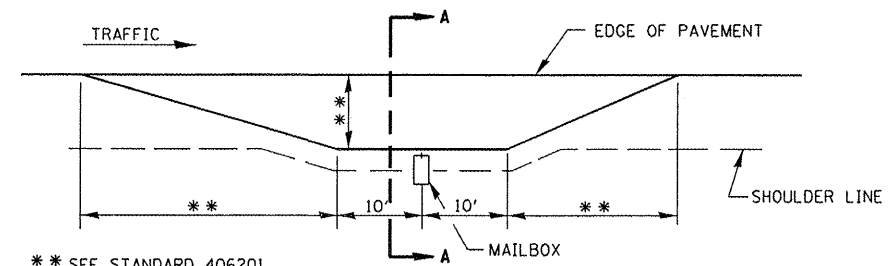

SECTION A-A
RURAL MAILBOX TURNOUT DETAILS

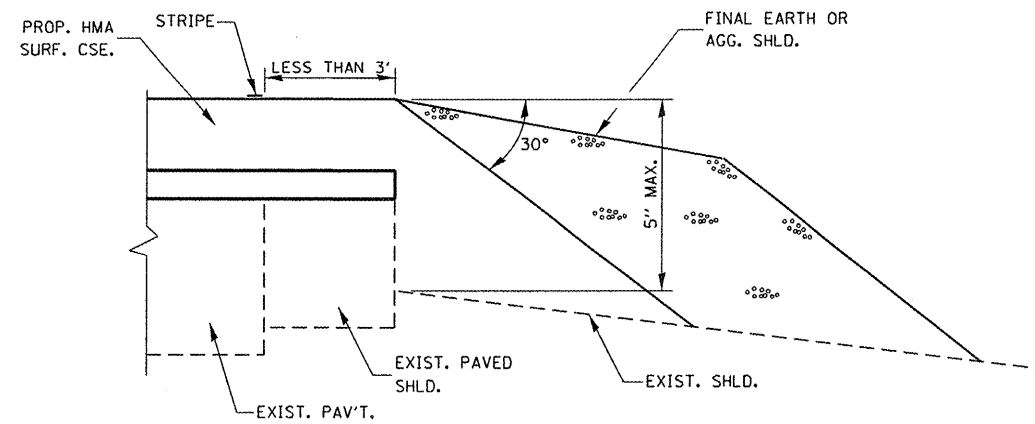
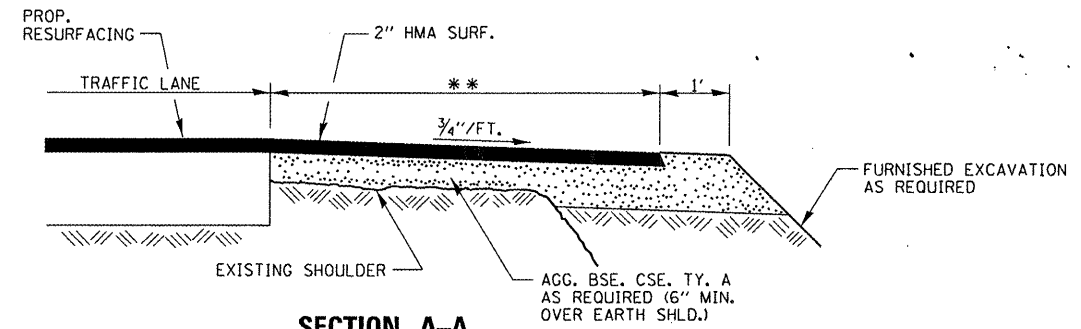

SAFETY EDGE

FILE NAME =	USER NAME = eorcoran	DESIGNED -	REVISED -
66921-sht-details.dgn		DRAWN -	REVISED -
PLOT SCALE = 100.0000' / 1in.		CHECKED -	REVISED -
PLOT DATE = 12/13/2011		DATE -	REVISED -

STATE OF ILLINOIS
DEPARTMENT OF TRANSPORTATION

DETAILS

SCALE: SHEET NO. OF SHEETS STA. TO STA.

F.A.P. RTE.	SECTION	COUNTY	TOTAL SHEETS	SHEET NO.
332	14.5.H.K.C-1RS-4	*	20	19
* KANKAKEE & IROQUOIS			CONTRACT NO. 66921	
[ILLINOIS] FED. AID PROJECT				

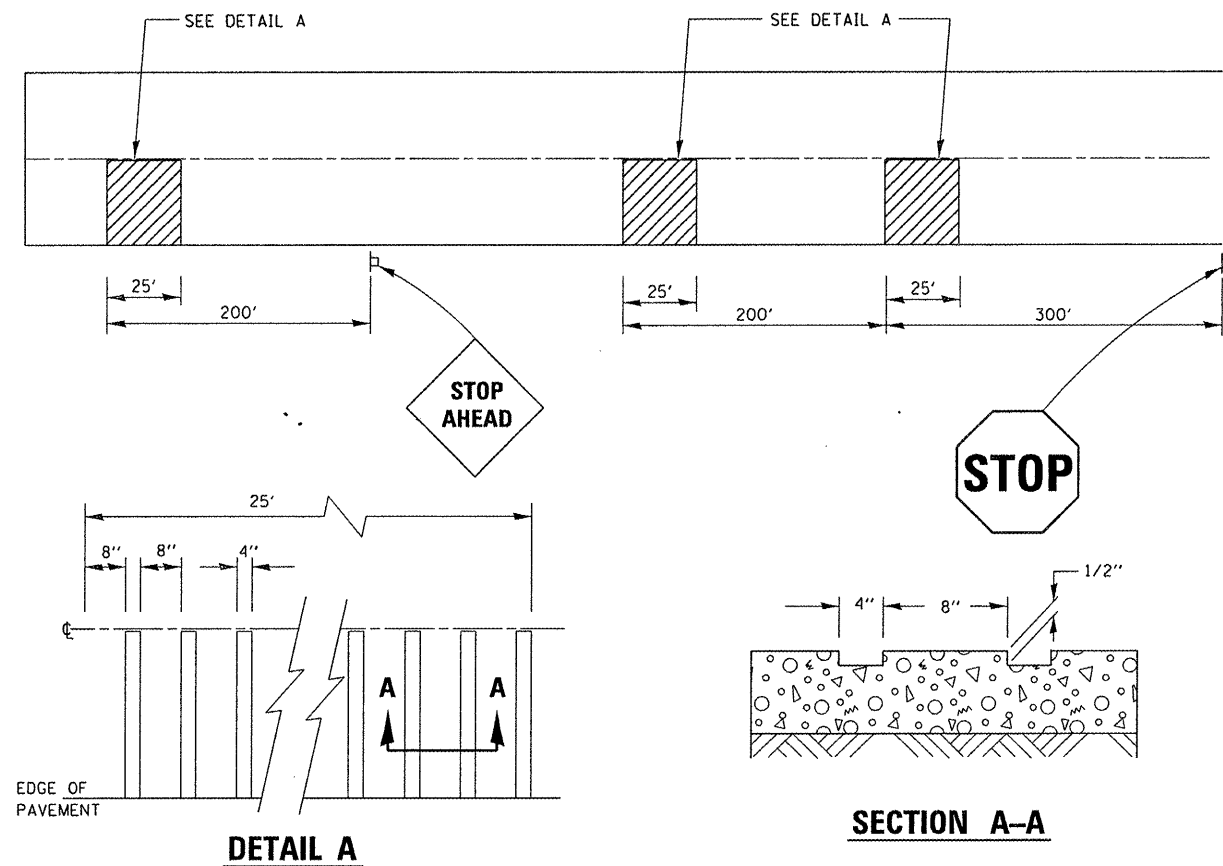

DETAIL A

SECTION A-A

**TYPICAL GROOVED RUMBLE STRIP
APPLICATION IN ADVANCE OF AN INTERSECTION**

NOTE: PUT BACK AT EXISTING LOCATION

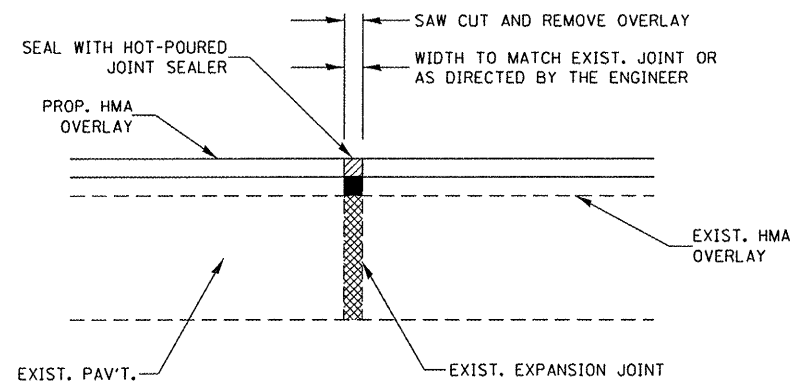

EXPANSION JOINT REHABILITATION DETAIL

GENERAL NOTES:

1. THE NEW HMA OVERLAY SHALL BE SAWED, REMOVED AND THE JOINT AREA CLEANED. PRIOR TO PLACING THE HOT-POURED JOINT SEALER, THE JOINT SHALL BE BLOWN OUT WITH COMPRESSED AIR.
2. THIS WORK WILL BE PAID FOR AT THE CONTRACT UNIT PRICE PER FOOT FOR EXPANSION JOINT REHABILITATION.

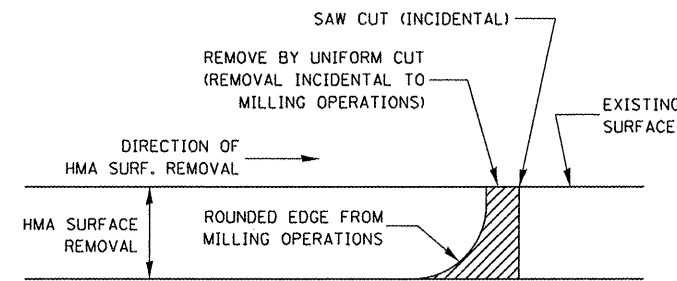

NOTE:
WHEN MILLING OPERATIONS PRODUCE A ROUNDED EDGE, THEN A SAW CUT SHALL BE USED TO MANUFACTURE A PERPENDICULAR EDGE AS SHOWN IN THE DETAIL. THE ENGINEER SHALL BE THE SOLE JUDGE CONCERNING THE USE OF THIS DETAIL

HMA DETAIL AT BUTT JOINTS

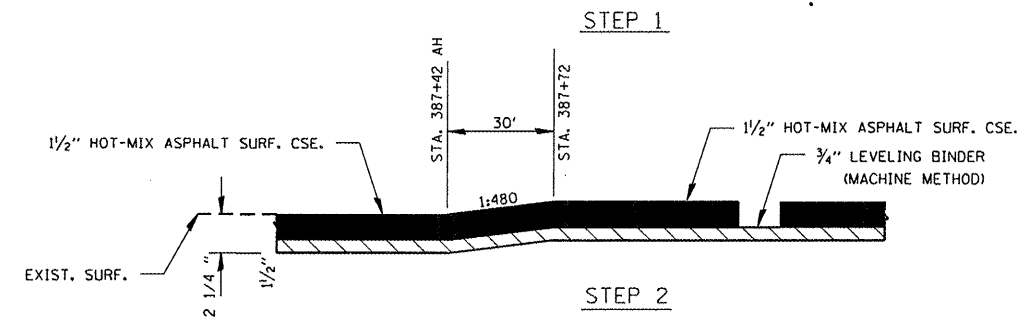
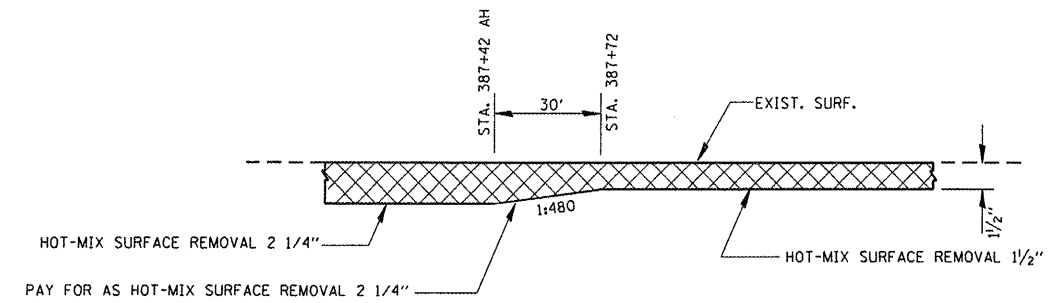

HMA TAPER DETAIL

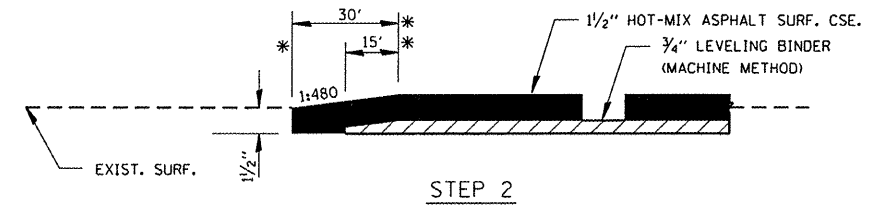
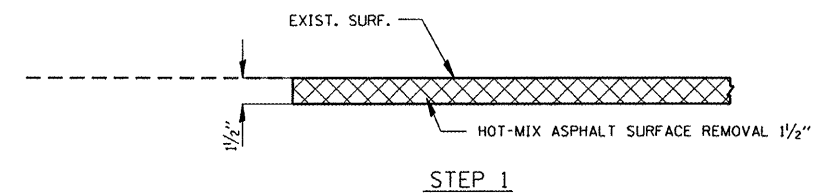

BUTT JOINT DETAIL

- STA. 540+68 TO **STA. 540+38
- STA. 542+58 TO **STA. 542+88
- STA. 756+54 TO **STA. 756+24
- STA. 758+20 TO **STA. 758+50
- STA. 868+14 TO **STA. 867+84

SN 038-0206 OMISSION
SN 038-0019 OMISSION

FILE NAME =	USER NAME = corcoranlm	DESIGNED -	REVISED -
ci:\pwwork\pwwork\corcoranlm\d0135018\066921-sht-details.dgn	66921-sht-details.dgn	DRAWN -	REVISED -
PLOT SCALE = 100,0000 / 1 in.		CHECKED -	REVISED -
PLOT DATE = 12/13/2011		DATE -	REVISED -

**STATE OF ILLINOIS
DEPARTMENT OF TRANSPORTATION**

DETAILS

SCALE: SHEET NO. OF SHEETS STA. TO STA.

F.A.P. RTE.	SECTION	COUNTY	TOTAL SHEETS	SHEET NO.
332	(4,5,H,K,C-1)RS-4		20	20
KANKAKEE & IROUOUISS		CONTRACT NO. 66921		
ILLINOIS FED. AID PROJECT				