

**STATE OF ILLINOIS**  
**DEPARTMENT OF TRANSPORTATION**  
**DIVISION OF HIGHWAYS**  
**PROPOSED**  
**HIGHWAY PLANS**

**FAP ROUTE 587 (US 34)**  
**SECTION (20X) RS-2**  
**PROJECT: ACF-0587 (026)**  
**3P MILLING AND RESURFACING**  
**LaSALLE COUNTY**

C-93-080-11

F.A.P. RTE.	SECTION	COUNTY	TOTAL SHEETS	SHEET NO.
587	(20X) RS-2	LaSALLE	22	1
		ILLINOIS	CONTRACT NO. 66B16	

**INDEX OF SHEETS**

1	COVER SHEET
2	GENERAL NOTES
3-4	SUMMARY OF QUANTITIES
5-6	TYPICAL SECTIONS
7-9	SCHEDULE OF QUANTITIES
10	TIE POINTS
11-19	PLAN VIEW
20 - 22	DETAILS

**STANDARDS**

000001-06	STANDARD SYMBOLS, ABBREVIATIONS AND PATTERNS
001006	DECIMAL OF AN INCH AND OF A FOOT
424001-06	PERPENDICULAR CURB RAMPS FOR SIDEWALKS
424006	DIAGONAL CURB RAMPS FOR SIDEWALKS
424011	CORNER PARALLEL CURB RAMPS FOR SIDEWALKS
424016	MID-BLOCK CURB RAMPS FOR SIDEWALKS
424021	DEPRESSED CORNER FOR SIDEWALKS
424026	ENTRANCE / ALLEY PEDESTRIAN CROSSINGS
606001-04	CONCRETE CURB TYPE B AND COMBINATION CONCRETE CURB AND GUTTER
667101-02	PERMANENT SURVEY MARKERS
701501-06	URBAN LANE CLOSURE, 2L, 2W, UNDIVIDED
701801-05	LANE CLOSURE, MULTILANE 1W OR 2W CROSSWALK OR SIDEWALK CLOSURE
701901-02	TRAFFIC CONTROL DEVICES
780001-03	TYPICAL PAVEMENT MARKINGS
781001-03	TYPICAL APPLICATIONS RAISED REFLECTIVE PAVEMENT MARKERS



**OTHER PRINCIPAL ARTERIAL**  
**ADT 2009 = 5038**  
**PV = 88.1% ,SU = 8.3%, MU = 3.6%**

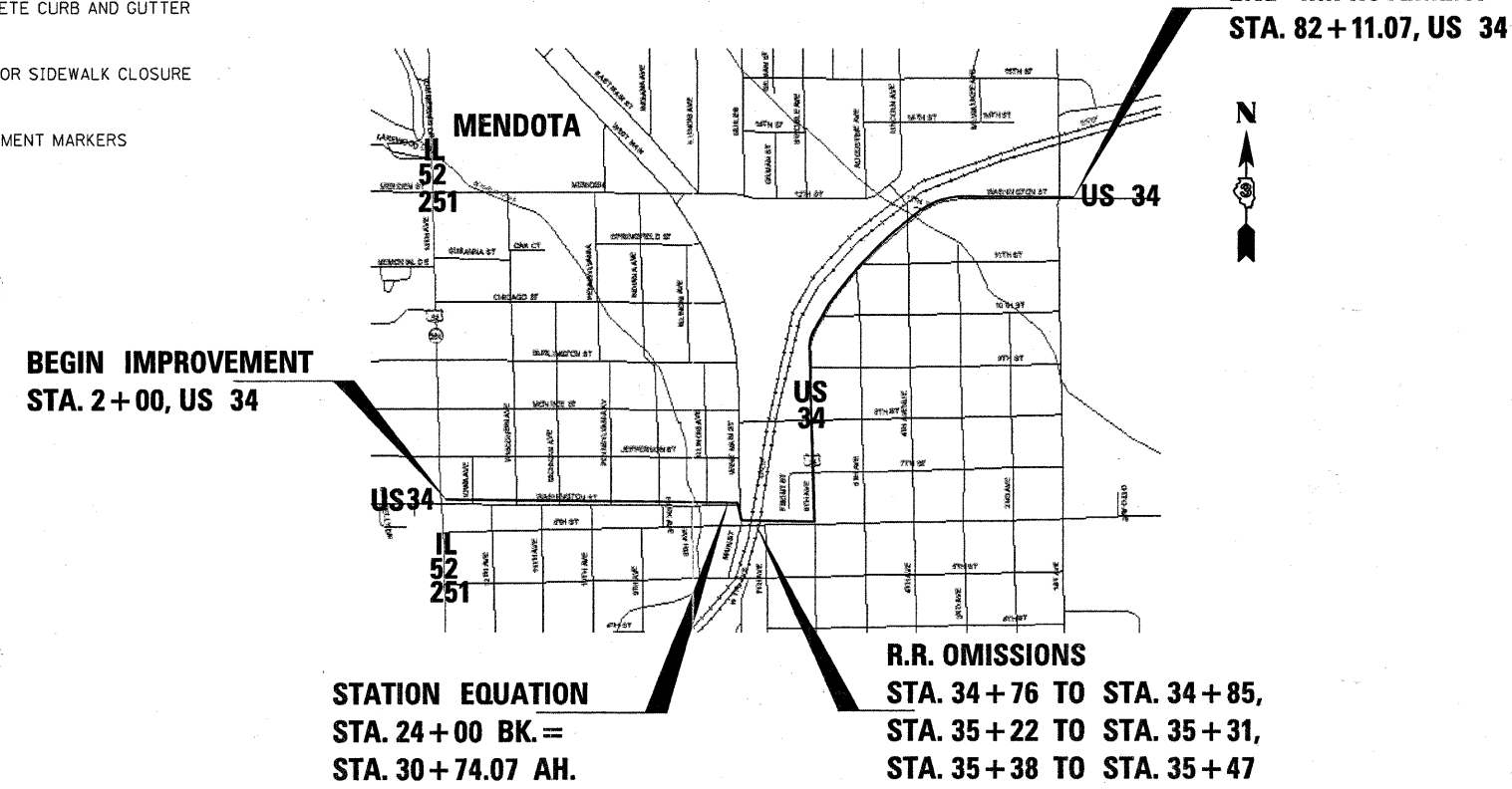

**J.U.L.I.E.**  
**JOINT UTILITY LOCATION INFORMATION FOR EXCAVATION**  
**1-800-892-0123**  
**OR 811**

**PROJECT ENGINEER: CRAIG REED, P.E.**  
**PROJECT MANAGER: MARK JONES, P.E.**

**CONTRACT NO. 66B16**

**GROSS LENGTH = 7337 FT. = 1.390 MILE**  
**NET LENGTH = 7230 FT. = 1.370 MILE**

**STATE OF ILLINOIS**  
**DEPARTMENT OF TRANSPORTATION**  
**DIVISION OF HIGHWAYS**

SUBMITTED December 7, 2011  
Eric S. Thealderson  
 DEPUTY DIRECTOR OF HIGHWAYS, REGION ENGINEER

February 3, 2012  
John D. Baranzelli, P.E.  
 acting ENGINEER OF DESIGN AND ENVIRONMENT

February 3, 2012  
William R. Frenkel  
 acting DIRECTOR OF HIGHWAYS, CHIEF ENGINEER

**PRINTED BY THE AUTHORITY**  
**OF THE STATE OF ILLINOIS**

GENERAL NOTES

THE THICKNESS OF HMA SHOWN ON THE PLANS IS THE NOMINAL THICKNESS. DEVIATIONS FROM THE NOMINAL THICKNESS WILL BE PERMITTED WHEN SUCH DEVIATIONS OCCUR DUE TO IRREGULARITIES IN THE EXISTING SURFACE OR BASE ON WHICH THE HMA IS PLACED.

THE ENGINEER WILL BE THE SOLE JUDGE CONCERNING CURING TIME FOR THE VARIOUS HMA LIFTS.

FOR STABILIZATION, ALL TYPE III BARRICADES SHALL REQUIRE A MINIMUM OF FOUR SAND BAGS PER BARRICADE.

THE FINISHED EARTHWORK SHALL HAVE A VEGETATION SUSTAINING SOIL COVERING THE TOP FOUR INCHES ( 100 MILLIMETERS) IN AREAS TO BE SEEDED OR SODDED. THE VEGETATION SUSTAINING SOIL REQUIRED WILL NOT BE PAID FOR SEPARATELY BUT SHALL BE INCLUDED IN THE COST OF FURNISHED EXCAVATION.

ABANDONED UNDERGROUND UTILITIES THAT CONFLICT WITH CONSTRUCTION SHALL BE DISPOSED OF OUTSIDE THE LIMITS OF THE RIGHT OF WAY ACCORDING TO ARTICLE 202.03 OF THE STANDARD SPECIFICATIONS AND AS DIRECTED BY THE ENGINEER. THIS WORK WILL NOT BE PAID FOR SEPARATELY, BUT SHALL BE INCLUDED IN THE COST OF EARTH EXCAVATION.

ANY REFERENCE TO A STANDARD IN THESE PLANS SHALL BE INTERPRETED TO MEAN THE EDITION AS INDICATED BY THE SUBNUMBER SHOWN IN THE LIST OF STANDARDS OR THE COPY INCLUDED IN THESE PLANS.

THE FOLLOWING RATES OF APPLICATION HAVE BEEN USED IN CALCULATING PLAN QUANTITIES:

GRANULAR MATERIALS	2.05
AGGREGATE (PRIME COAT)	0.002
HMA RESURFACING	112
SHORT TERM PAVEMENT MARKING	10
MIX FOR CRACKS, JTS & FLGWYS	0.0003
LEVEL BINDER (HAND METHOD)	0.0005
SUPPLEMENTAL WATERING	3
CALCIUM CHLORIDE	2
AGGREGATE DITCH CHECKS	5

BITUMINOUS MATERIALS (PRIME COAT) RATES	
SURFACE TYPE	ESTIMATED TRUCK APPLICATION RATE
AGGREGATE BASES	0.375 GAL / SQ YD
MILLED HMA OR PCC PAVEMENT	0.08 GAL / SQ YD
EXISTING PAVEMENT FOG COAT	0.05 GAL / SQ YD
(BETWEEN ADDITIONAL HMA LIFTS)	0.05 GAL / SQ YD

ESTIMATED TRUCK APPLICATION RATE USED FOR CALCULATING PLAN QUANTITIES

THE CONTRACTOR'S ATTENTION IS DIRECTED TO THE PRESENCE OF DEPARTMENT-OWNED UNDERGROUND ELECTRICAL CABLE WITHIN THE LIMITS OF THE PROPOSED IMPROVEMENT. THE CONTRACTOR SHALL REQUEST THE ILLINOIS DEPARTMENT OF TRANSPORTATION IN OTTAWA (815-434-8417) TO LOCATE THE UNDERGROUND FACILITIES, PROVIDING A MINIMUM OF 72 HOURS NOTICE. THE DEPARTMENT IS NOT A MEMBER OF THE JOINT UTILITY LOCATING INFORMATION FOR EXCAVATORS (JULIE) SYSTEM.

ALL DAMAGE TO DEPARTMENT OWNED UNDERGROUND FACILITIES, CAUSED BY THE CONTRACTOR SHALL BE REPAIRED TO THE SATISFACTION OF THE DEPARTMENT AT THE CONTRACTOR'S EXPENSE. THIS SHALL INCLUDE ALL TEMPORARY REPAIRS REQUIRED TO KEEP THE FACILITY OPERATIONAL WHILE MATERIAL IS BEING OBTAINED TO MAKE PERMANENT REPAIRS. SPlicing OF ELECTRIC CABLE SHALL NOT BE ALLOWED. ELECTRIC CABLE SHALL BE REPLACED FROM POLE TO POLE OR CONTROLLER.

THE CONTRACTOR SHALL CONTACT JULIE AT LEAST 48 HOURS PRIOR TO EXCAVATION TO DETERMINE WHICH UTILITIES ARE IN THE AREA.

STATE OF ILLINOIS  
DEPARTMENT OF TRANSPORTATION  
DISTRICT THREE

PREPARED BY: *Don Bannit*  
DISTRICT STUDIES & PLANS ENGINEER

DATE: 12-1-11

EXAMINED BY: *Harold B. Long Jr.*  
DISTRICT CONSTRUCTION ENGINEER

*Steve J. Palko*  
DISTRICT MATERIALS ENGINEER

*Bruce A. Chubb*  
DISTRICT OPERATIONS ENGINEER

FILE NAME =	USER NAME = quigley1	DESIGNED -	REVISED -
o:\p\work\p\dot\quigley1\6253613\036816-sh1-cover.dgn		DRAWN -	REVISED -
PLOT SCALE = 50.0000' / in.		CHECKED -	REVISED -
PLOT DATE = 11/30/2011		DATE -	REVISED -

STATE OF ILLINOIS  
DEPARTMENT OF TRANSPORTATION

GENERAL NOTES

SCALE: SHEET NO. OF SHEETS STA. TO STA.

F.A. RTE.	SECTION	COUNTY	TOTAL SHEETS	SHEET NO.
587	(20X) RS-2	LaSALLE	2	2
CONTRACT NO. 66B16				
ILLINOIS FED. AID PROJECT				

CODE NO.	ITEM	UNIT	URBAN TOTAL QUANTITY	80% FED. / 20% STATE CONSTR. CODE
				0005 ROADWAY
20400800	FURNISHED EXCAVATION	CU YD	38	38
25000400	NITROGEN FERTILIZER NUTRIENT	POUND	3	3
25000500	PHOSPHORUS FERTILIZER NUTRIENT	POUND	3	3
25000600	POTASSIUM FERTILIZER NUTRIENT	POUND	3	3
25200110	SODDING, SALT TOLERANT	SQ YD	232	232
25200200	SUPPLEMENTAL WATERING	UNIT	4	4
40600100	BITUMINOUS MATERIALS (PRIME COAT)	GALLON	3794	3794
40600300	AGGREGATE (PRIME COAT)	TON	67	67
40600400	MIXTURE FOR CRACKS, JOINTS, AND FLANGEWAYS	TON	13	13
40600525	LEVELING BINDER (HAND METHOD), N50	TON	16	16
40600627	LEVELING BINDER (MACHINE METHOD), IL-9.5FG, N50	TON	1215	1215
40600895	CONSTRUCTING TEST STRIP	EACH	1	1
40600990	TEMPORARY RAMP	SQ YD	879	879
40603535	POLYMERIZED HOT-MIX ASPHALT SURFACE COURSE, MIX "D", N50	TON	2557	2557
40800050	INCIDENTAL HOT-MIX ASPHALT SURFACING	TON	375	375
42400100	PORTLAND CEMENT CONCRETE SIDEWALK 4 INCH	SQ FT	5854	5854
42400800	DETECTABLE WARNINGS	SQ FT	805	805
44000155	HOT-MIX ASPHALT SURFACE REMOVAL, 1 1/2"	SQ YD	4247	4247
44000158	HOT-MIX ASPHALT SURFACE REMOVAL, 2 1/4"	SQ YD	28801	28801
44000300	CURB REMOVAL	FOOT	478	478
44000600	SIDEWALK REMOVAL	SQ FT	5854	5854
56109210	WATER VALVES TO BE ADJUSTED	EACH	1	1
60255500	MANHOLES TO BE ADJUSTED	EACH	37	37
60255800	MANHOLES TO BE ADJUSTED WITH NEW TYPE 1 FRAME, CLOSED LID	EACH	15	15
60260100	INLETS TO BE ADJUSTED	EACH	25	25
60266600	VALVE BOXES TO BE ADJUSTED	EACH	9	9

FILE NAME =	USER NAME = quigleyml	DESIGNED -	REVISED -	<b>STATE OF ILLINOIS DEPARTMENT OF TRANSPORTATION</b>	<b>SUMMARY OF QUANTITIES</b>				F.A.P. RTE.	SECTION	COUNTY	TOTAL SHEETS	SHEET NO.
ct:\pw\work\p\idot\quigleyml\d8253613\0365816-sht-details.DGN	PLOT SCALE = 50.0000' / 1" =	DRAWN -	REVISED -						587	(20X) RS-2	LA SALLE	3	3
	PLOT DATE = 12/2/2011	CHECKED -	REVISED -		SCALE:	SHEET NO.	OF SHEETS	STA.	TO STA.	CONTRACT NO. 66B16			
		DATE	REVISED -		ILLINOIS FED. AID PROJECT								

CODE NO.	ITEM	UNIT	URBAN TOTAL QUANTITY	801.FED./201.STATE CONSTR. CODE
				0005 ROADWAY
60600605	CONCRETE CURB, TYPE B	FOOT	478	478
66700205	PERMANENT SURVEY MARKERS, TYPE I	EACH	2	2
67000400	ENGINEER'S FIELD OFFICE, TYPE A	CAL MO	4	4
67100100	MOBILIZATION	L SUM	1	1
70102620	TRAFFIC CONTROL AND PROTECTION, STANDARD 701501	L SUM	1	1
70102640	TRAFFIC CONTROL AND PROTECTION, STANDARD 701801	L SUM	1	1
70103815	TRAFFIC CONTROL SURVEILLANCE	CAL DA	15	15
70300100	SHORT-TERM PAVEMENT MARKING	FOOT	4572	4572
70300210	TEMPORARY PAVEMENT MARKING- LETTERS AND SYMBOLS	SQ FT	446	446
70300220	TEMPORARY PAVEMENT MARKING- LINE 4"	FOOT	9289	9289
70300240	TEMPORARY PAVEMENT MARKING- LINE 6"	FOOT	4075	4075
70300250	TEMPORARY PAVEMENT MARKING- LINE 8"	FOOT	479	479
70300260	TEMPORARY PAVEMENT MARKING- LINE 12"	FOOT	1936	1936
70300280	TEMPORARY PAVEMENT MARKING- LINE 24"	FOOT	612	612
70301000	WORK ZONE PAVEMENT MARKING REMOVAL	SQ FT	1508	1508
* 78000100	THERMOPLASTIC PAVEMENT MARKING - LETTERS AND SYMBOLS	SQ FT	446	446
* 78000200	THERMOPLASTIC PAVEMENT MARKING - LINE 4"	FOOT	9289	9289
* 78000400	THERMOPLASTIC PAVEMENT MARKING - LINE 6"	FOOT	4075	4075
* 78000500	THERMOPLASTIC PAVEMENT MARKING - LINE 8"	FOOT	479	479
* 78000600	THERMOPLASTIC PAVEMENT MARKING - LINE 12"	FOOT	1936	1936
* 78004280	PREFORMED PLASTIC PAVEMENT MARKING, TYPE B - INLAID - LINE 24"	FOOT	612	612
* 78100100	RAISED REFLECTIVE PAVEMENT MARKER	EACH	110	110
78300200	RAISED REFLECTIVE PAVEMENT MARKER REMOVAL	EACH	118	118
Z0048665	RAILROAD PROTECTIVE LIABILITY INSURANCE	L SUM	1	1
X2010400	STUMP REMOVAL ONLY	UNIT	2.5	2.5
* X8140115	HANDHOLE TO BE ADJUSTED	EACH	2	2
Z0034105	MATERIAL TRANSFER DEVICE	TON	3772	3772

\*SPECIALTY ITEMS

FILE NAME =	USER NAME = quigleyml	DESIGNED -	REVISED -	<b>STATE OF ILLINOIS DEPARTMENT OF TRANSPORTATION</b>	<b>SUMMARY OF QUANTITIES</b>				F.A.P. RTE.	SECTION	COUNTY	TOTAL SHEETS	SHEET NO.
c:\pwork\pwork\quigleyml\0253613\036	66B16-sht-details.DGN	DRAWN -	REVISED -						587	(20X) RS-2	LA SALLE	4	4
	PLOT SCALE = 50.0000' / in.	CHECKED -	REVISED -		SCALE: SHEET NO. OF SHEETS STA. TO STA.				CONTRACT NO. 66B16				
	PLOT DATE = 12/2/2011	DATE -	REVISED -						ILLINOIS FED. AID PROJECT				

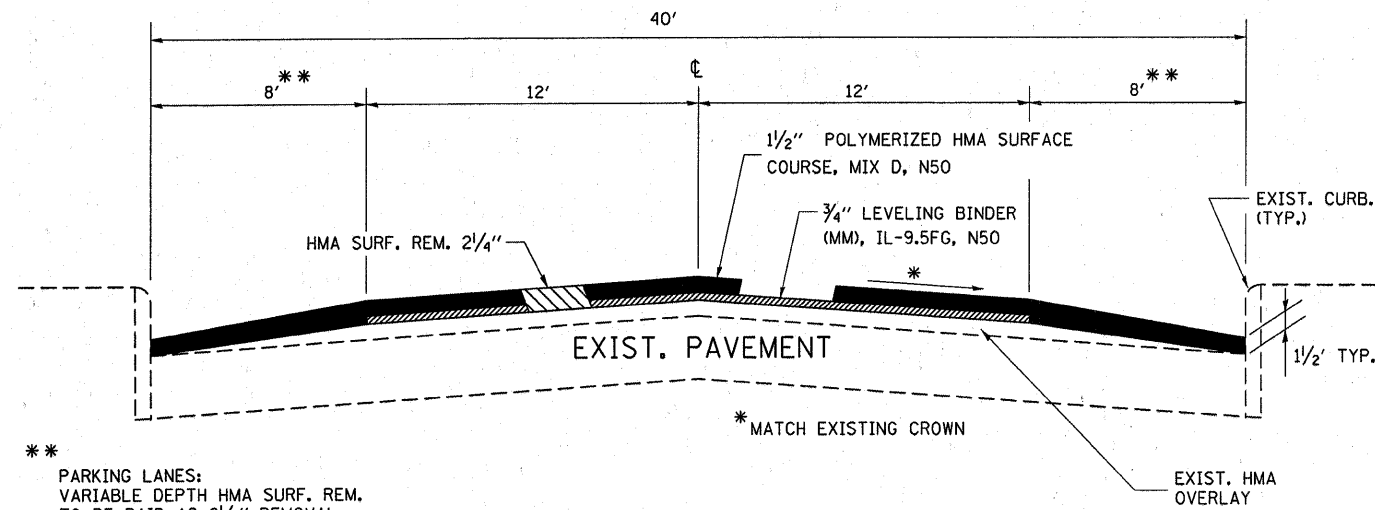

**TYPICAL SECTION 1**

STA. 2+00.00 TO STA. 18+67.88 (INDIANA AVE.)

\*\* PARKING LANES:  
VARIABLE DEPTH HMA SURF. REM.  
TO BE PAID AS 2 1/4" REMOVAL

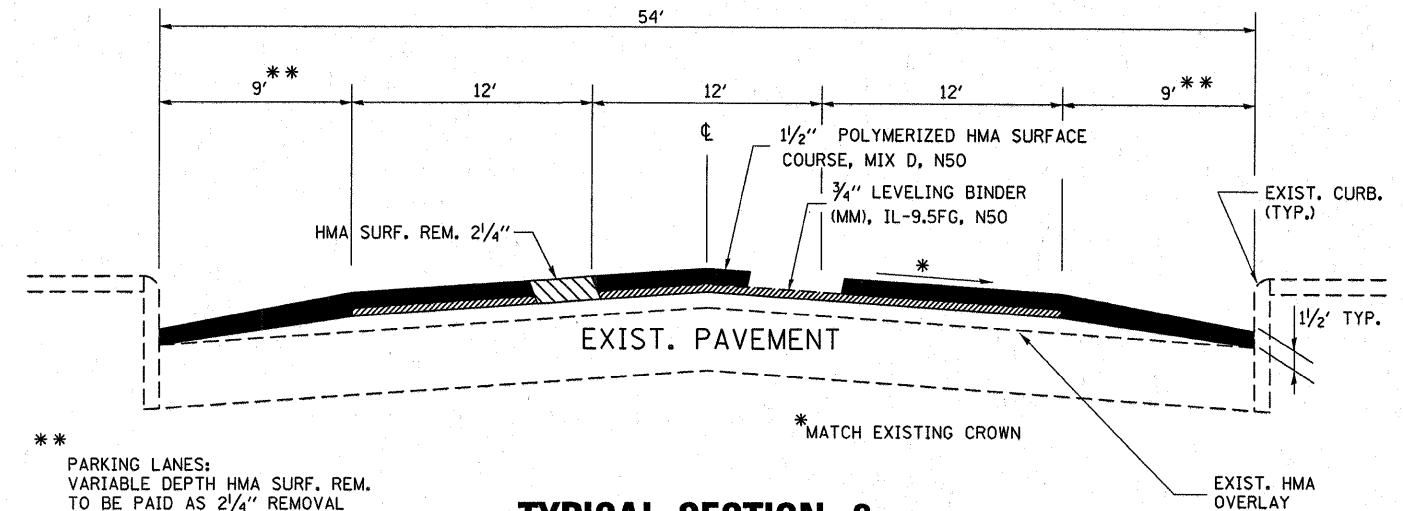

**TYPICAL SECTION 2**

STA. 18+67.88 (INDIANA AVE.) TO STA. 24+00.00 BK.  
STA. 30+74.10 AHD. TO STA. 32+08.67

\*\* PARKING LANES:  
VARIABLE DEPTH HMA SURF. REM.  
TO BE PAID AS 2 1/4" REMOVAL

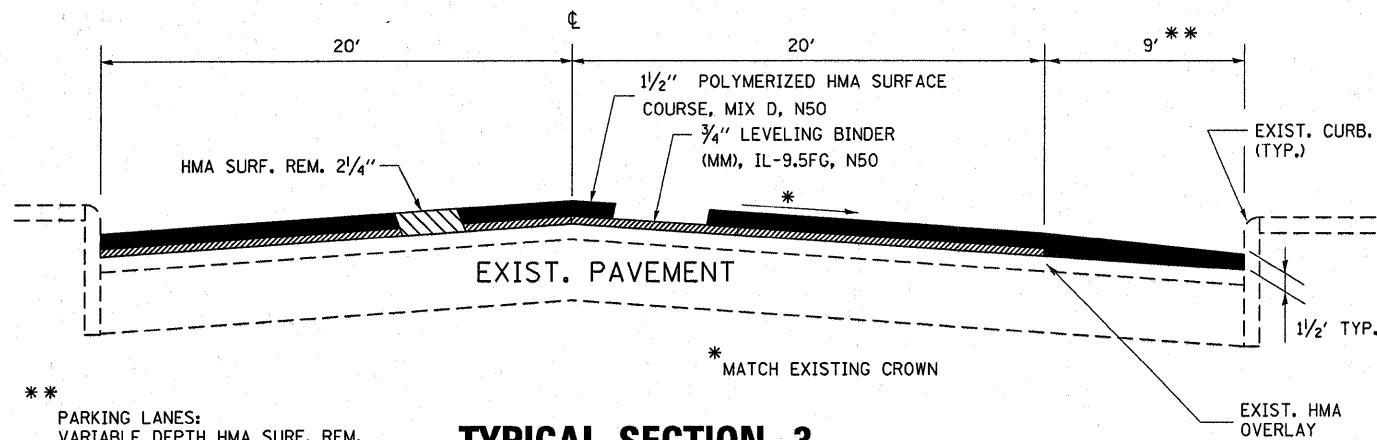

**TYPICAL SECTION 3**

STA. 32+08.67 TO STA. 33+05.00

\*\* PARKING LANES:  
VARIABLE DEPTH HMA SURF. REM.  
TO BE PAID AS 2 1/4" REMOVAL

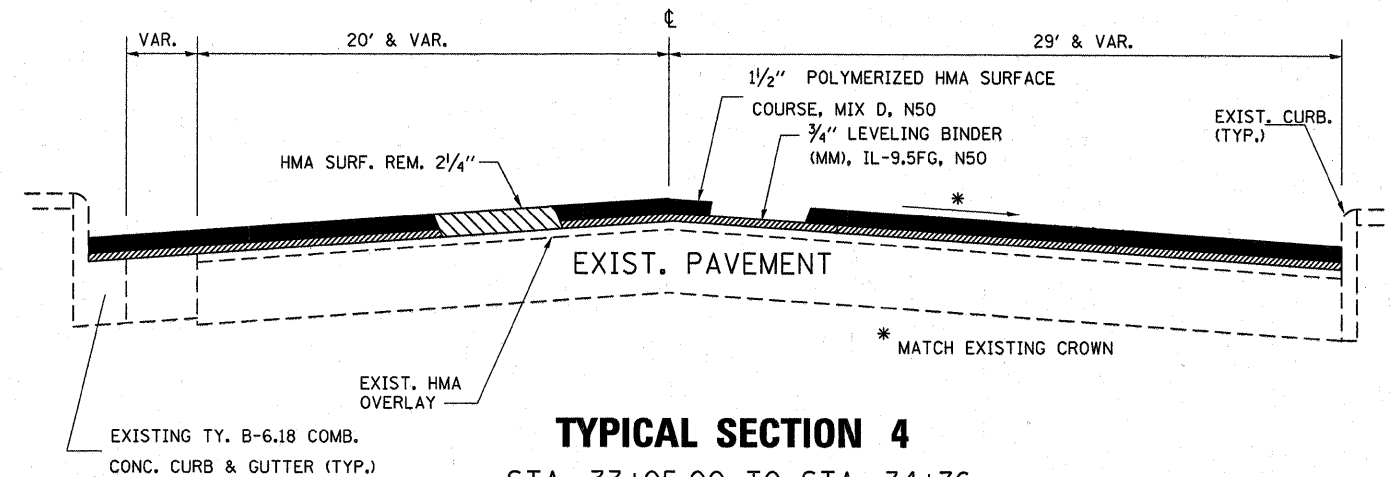

**TYPICAL SECTION 4**

STA. 33+05.00 TO STA. 34+76

EXISTING TY. B-6.18 COMB.  
CONC. CURB & GUTTER (TYP.)

FILE NAME =	USER NAME = quigleyml	DESIGNED -	REVISED -	<b>STATE OF ILLINOIS DEPARTMENT OF TRANSPORTATION</b>	<b>TYPICAL SECTIONS</b>				F.A.P. RTE.	SECTION	COUNTY	TOTAL SHEETS	SHEET NO.
c:\pwork\pwork\quigleyml\0253613\036816-aht-details.DGN		DRAWN -	REVISED -		587	(20X) RS-2	LA SALLE	5					
PLOT SCALE = 50,0000' / in.		CHECKED -	REVISED -		CONTRACT NO. 66B16								
PLOT DATE = 11/30/2011		DATE -	REVISED -		ILLINOIS FED. AID PROJECT								
				SCALE:	SHEET NO.	OF	SHEETS	STA.	TO STA.				

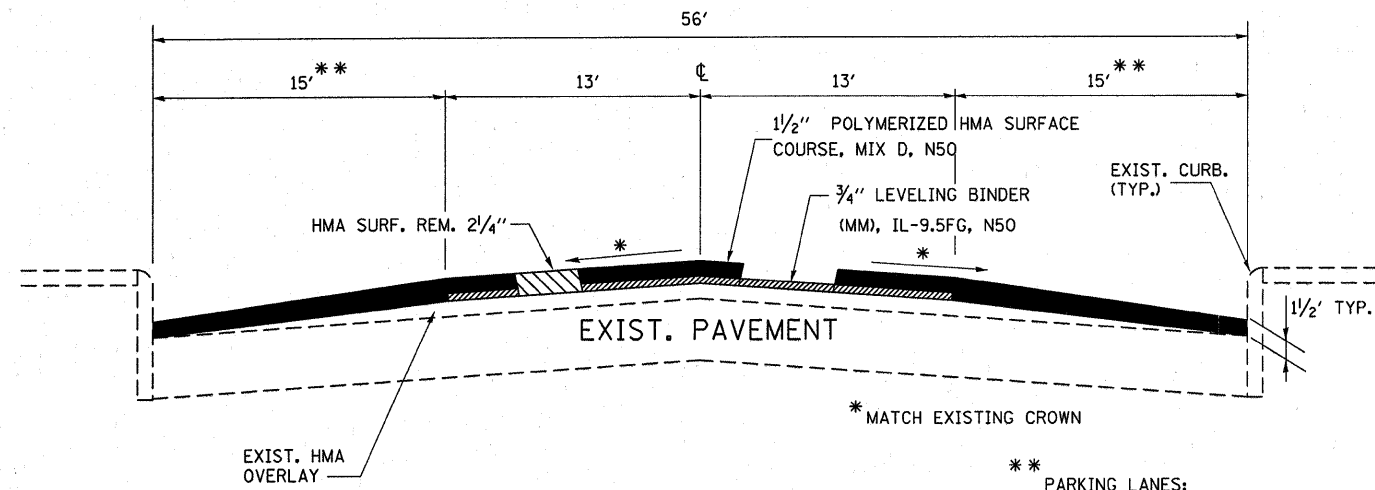

**TYPICAL SECTION 5**

STA. 35+47.00 TO STA. 40+00.27

\*\* PARKING LANES:  
VARIABLE DEPTH HMA SURF. REM.  
TO BE PAID AS 2 1/4" REMOVAL

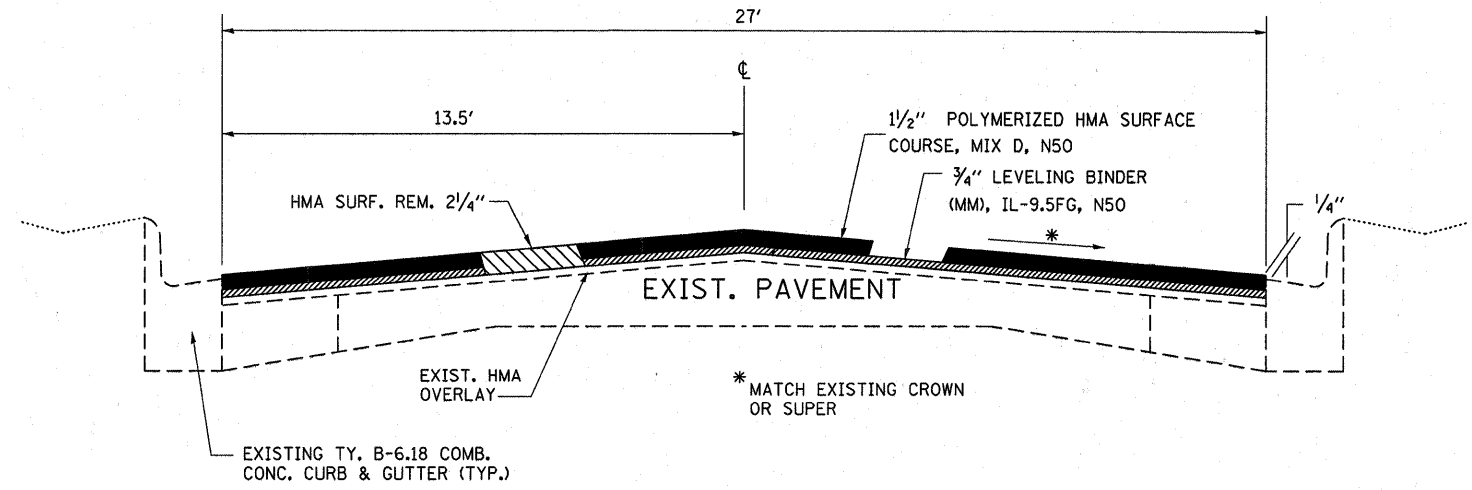

**TYPICAL SECTION 6**

STA. 40+00.27 TO STA. 82+11.07

MIXTURE TABLE					
MIX	PG GRADE	DESIGN AIR VOIDS	FRICTION AGGREGATE	MIXTURE COMPOSITION	DESITY TEST
HMA LEVELING BINDER	PG64-22	4% @ N50		IL-9.5FG	CORES OR CORRELATION
HMA SURFACE COURSE	SBS PG70-22	4% @ N50	MIXTURE D	IL-9.5	CORES OR CORRELATION

\*IF RAP OPTION IS SELECTED, THE ASPHALT CEMENT GRADE MAY NEED TO BE ADJUSTED. THIS WILL BE DETERMINED BY THE ENGINEER.

FILE NAME =	USER NAME = quigleyml	DESIGNED -	REVISED -	<b>STATE OF ILLINOIS DEPARTMENT OF TRANSPORTATION</b>	<b>TYPICAL SECTIONS</b>			F.A.P. RTE.	SECTION	COUNTY	TOTAL SHEETS	SHEET NO.
c:\pwork\pwidot\quigleyml\d0253613\0366816-sht-details.DGN	PLOT SCALE = 50.0000' / in.	DRAWN -	REVISED -					587	(20X) RS-2	LA SALLE	6	6
	PLOT DATE = 11/30/2011	CHECKED -	REVISED -		SCALE:	SHEET NO. OF SHEETS	STA. TO STA.	CONTRACT NO. 66B16				
		DATE -	REVISED -		ILLINOIS FED. AID PROJECT							

MAINLINE HMA SCHEDULE										
STA TO STA	DRIVE LANE/ PARK LANE	AREA SQ YD	LEVEL BINDER (M.M.), N50 TON	POLY HMA SURF. CSE. MIX D, N50 TON	AGG. (PRIME COAT) TON	BIT. MAT'LS. (PRIME COAT) GALLON	MIX CRACKS JOINTS & FLWY TON	LEVEL BINDER (H.M.), N50 TON	HMA SURF. REM 2 1/4" SQ YD	TEMP RAMP SQ YD
2+00 TO 18+67.88	DRIVE LANE	4448	312	374	8.9	579	1.4	2.3	4448	20
	PARK LANE	2966		312	6.0	238	0.9	1.5	2966	
18+67.88 TO 32+08.94	DRIVE LANE	2668	170	225	5.4	347	0.9	1.4	2668	
	PARK LANE	1334		141	2.7	107	0.5	0.7	1334	
32+08.94 TO 33+71.34	DRIVE LANE	722	38	61	1.5	94	0.3	0.4	722	
	PARK LANE	163		18	0.4	14	0.1	0.1	163	
33+71.34 TO 34+76	DRIVE LANE	233	20	20	0.5	31	0.1	0.2	233	
	PARK LANE	233		25	0.5	19	0.1	0.2	233	
34+76 TO 35+47	DRIVE LANE	442	19	38	0.9	58	0.2	0.3	442	
	PARK LANE	0		0	0.0	0	0.0	0.0	0	
RR OMISSION 34+76-34+85										72
RR OMISSION 35+22-35+31										73
RR OMISSION 35+38-35+47										73
35+47 TO 40+00	DRIVE LANE	1309	119	110	2.7	171	0.4	0.7	1309	
	PARK LANE	1510		159	3.1	121	0.5	0.8	1510	
40+00.27 TO 82+11.07	DRIVE LANE	12633	531	1062	25.3	1643	3.8	6.4	12633	23
MAIN ST. RADIUS	DRIVE LANE	140	6	12	0.3	19	0.1	0.1	140	
<b>TOTALS</b>		<b>28,801</b>	<b>1,215</b>	<b>2,557</b>	<b>58</b>	<b>3,441</b>	<b>10</b>	<b>16</b>	<b>28,801</b>	<b>261</b>

SIDEROAD SCHEDULE									
SIDEROAD	LT/RT	STATION	AREA	INCID.	BIT	AGG	TEMP	MIX CRACKS	HMA
			TOTAL SQ YD	HMA SURF. TON	MATL (PRIME COAT) GALLON	(PRIME COAT) TON	RAMP SQ YD	JOINTS & FLWY TON	SURF REM 1 1/2IN SQ YD
IOWA	LT	3+09.50	122	11.0	10.0	0.2	16	0.1	122
12TH AVE	RT	4+61.40	122	11.0	10.0	0.2	16	0.1	122
WISCONSIN AVE	LT	6+70.72	122	11.0	10.0	0.2	16	0.1	122
11TH AVE	RT	8+78.72	122	11.0	10.0	0.2	16	0.1	122
MICHIGAN AVE	LT	10+32.59	122	11.0	10.0	0.2	16	0.1	122
10TH AVE	RT	12+97.02	148	13.0	12.0	0.3	20	0.1	148
PENNSYLVANIA AVE	LT	14+65.00	122	11.0	10.0	0.2	16	0.1	122
INDIANA AVE	LT	18+67.88	117	10.0	10.0	0.2	23	0.1	117
VETERANS WAY	RT	19+06.27	156	14.0	13.0	0.3	26	0.1	156
8TH AVE	RT	21+36.58	78	7.0	7.0	0.2	28	0.1	78
ILLINOIS AVE	LT	22+65.84	90	8.0	8.0	0.2	30	0.1	90
MAIN ST. (NORTH END)	LT	32+08.94	347	30.0	28.0	0.7	30	0.2	347
MAIN ST. (SOUTH END)	RT	33+71.34	64	6.0	6.0	0.1	18	0.1	64
6TH ST.	RT	33+71.34	112	10.0	9.0	0.2	32	0.1	112
7TH AVE	RT	35+54.40	64	6.0	6.0	0.1	15	0.1	64
6TH AVE	RT	39+97.64	120	11.0	10.0	0.2	45	0.1	120
6TH ST.	RT	40+00.27	146	13.0	12.0	0.3	34	0.1	146
7TH ST.	RT	44+34.97	118	10.0	10.0	0.2	15	0.1	118
7TH ST.	LT	44+34.97	115	10.0	10.0	0.2	15	0.1	115
8TH ST.	RT	48+66.40	149	13.0	12.0	0.3	15	0.1	149
8TH ST.	LT	48+66.40	196	17.0	16.0	0.4	24	0.1	196
9TH ST.	RT	52+96.51	130	11.0	11.0	0.3	15	0.1	130
10TH ST.	RT	57+49.92	175	15.0	14.0	0.4	15	0.1	175
5TH AVE	RT	62+56.47	205	18.0	17.0	0.4	14	0.1	205
11TH ST.	RT	63+02.40	239	21.0	20.0	0.5	14	0.1	239
4TH AVE	RT	68+14.86	251	22.0	21.0	0.5	16	0.1	251
4TH AVE	LT	68+14.86	251	22.0	21.0	0.5	16	0.1	251
1ST AVE	RT	81+25.07	122	11.0	10.0	0.2	16	0.1	122
1ST AVE	LT	81+50.48	122	11.0	10.0	0.2	16	0.1	122
ALLEY 1	RT	15+05	0	0.0	0.0	0.1	6	0.0	0
ALLEY 2	LT	20+65.84	0	0.0	0.0	0.1	6	0.0	0
ALLEY 3	LT	30+88	0	0.0	0.0	0.1	6	0.0	0
ALLEY 4	LT	37+87.64	0	0.0	0.0	0.1	6	0.0	0
ALLEY 4	RT	37+87.64	0	0.0	0.0	0.1	6	0.0	0
<b>TOTALS</b>			<b>4,247</b>	<b>375</b>	<b>353</b>	<b>9</b>	<b>618</b>	<b>3</b>	<b>4247</b>

**CONCRETE SCHEDULE**

LOCATION	QUADRANT	SUGGESTED METHOD	CURB REM	CONCRETE CURB	LENGTH	WIDTH	SIDEWALK REM	PCC SIDEWALK 4IN.	DETECT WARN	SODDING SALT TOLERANT	NITROGEN	PHOSPHORUS	POTASSIUM
			44000300	60600105			44000600	42400100	42400800	25200110	25000400	25000500	25000600
			FT	FT			SQ FT	SQ FT	SQ FT	SQ YD	POUND	POUND	POUND
IOWA AVE. & US 34	NW	424001			11.0	7.0	77.0	77.0	14.0	3.0	0.04	0.04	0.04
	NE	424001			11.0	7.0	77.0	77.0	14.0	3.0	0.04	0.04	0.04
12TH AVE & US 34	SW	424001	17.0	17.0	20.0	5.0	100.0	100.0	10.0	9.0	0.11	0.11	0.11
	SE	424001	13.0	13.0	13.0	6.0	78.0	78.0	12.0	6.0	0.07	0.07	0.07
STA. 5+00	N SIDE	424016			12.0	5.0	60.0	60.0	10.0	3.0	0.04	0.04	0.04
	S SIDE	424001			12.0	5.0	60.0	60.0	10.0	3.0	0.04	0.04	0.04
WISCONSIN & US 34	NW	424001			9.0	7.0	63.0	63.0	14.0	2.0	0.02	0.02	0.02
	NE	424001			13.0	7.0	91.0	91.0	14.0	3.0	0.04	0.04	0.04
11TH AVE & US 34	SW	424001			13.0	7.0	91.0	91.0	14.0	3.0	0.04	0.04	0.04
	SE	424001			13.0	7.0	91.0	91.0	14.0	3.0	0.04	0.04	0.04
9+15	N SIDE	424016			11.0	5.0	55.0	55.0	10.0	3.0	0.04	0.04	0.04
	S SIDE	424001			7.0	4.0	28.0	28.0	8.0	2.0	0.02	0.02	0.02
MICHIGAN & US 34	NW	424001			13.0	7.0	91.0	91.0	14.0	3.0	0.04	0.04	0.04
	NE	424001			12.0	7.0	84.0	84.0	14.0	3.0	0.04	0.04	0.04
					17.0	8.5	144.5	144.5	17.0	4.0	0.05	0.05	0.05
10+85	S SIDE	424016			9.0	6.0	54.0	54.0	12.0	2.0	0.02	0.02	0.02
10TH AVE & US 34	SW	424001			26.0	6.0	156.0	156.0	12.0	6.0	0.07	0.07	0.07
	SE	424001			16.0	6.0	96.0	96.0	12.0	4.0	0.05	0.05	0.05
PENNSYLVANIA & US 34	NW	424001	22.0	22.0	10.0	6.0	60.0	60.0	12.0	8.0	0.10	0.10	0.10
	NE	424001	20.0	20.0	15.0	6.0	90.0	90.0	12.0	8.0	0.10	0.10	0.10
INDIANA & US 34	NW	424001	18.0	18.0	15.0	7.0	105.0	105.0	14.0				
	NE	424021	33.0	33.0	15.0	14.0	210.0	210.0	28.0				
VETERANS & US 34	SW	424001	17.0	17.0	17.0	6.0	102.0	102.0	12.0	8.0	0.10	0.10	0.10
	SE	424006			9.9	11.2	110.9	110.9	22.4				
8TH AVE & US 34	SW	424001	26.0	26.0	13.0	13.0	169.0	169.0	26.0				
	SE	424001			12.0	6.0	72.0	72.0	12.0				
					6.0	6.0	36.0	36.0	12.0				
ILLINOIS & US 34	NW	424021			13.4	12.4	166.2	166.2	24.8				
	NE	424021	21.0	21.0	12.3	12.3	151.3	151.3	24.6				
					12.3	5.7	70.1	70.1	11.4				
					12.3	7.0	86.1	86.1	14.0				
STA. 22+25	S. SIDE	424016			17.0	6.0	102.0	102.0	12.0				
STA. 22+80	S. SIDE	424016			17.0	6.0	102.0	102.0	12.0				
(N) MAIN ST. & US 34	NW	424001	34.0	34.0	7.5	9.8	73.5	73.5	10.0				
					7.7	19.0	146.3	146.3					
	SW	424001			13.0	10.5	136.5	136.5	10.0				
					11.9	7.2	85.3	85.3					
					10.7	10.3	55.1	55.1					
(S) MAIN ST.& 6TH ST (US 34).	NW	424011			12.6	12.2	153.7	153.7	24.4				
	NE	424001			10.0	5.0	50.0	50.0	10.0				
	SW	424021			15.0	6.0	90.0	90.0	12.0				
	SE	424001			17.0	5.0	85.0	85.0	10.0	4.0	0.05	0.05	0.05
(US 34) 6TH ST. & 7TH AVE	SE	424001			12.0	10.0	120.0	120.0	20.0				
(US 34) 6TH AVE & 6TH ST. (US 34)	NW	424-17	17.0	17.0	18.0	6.0	108.0	108.0	12.0	8.0	0.10	0.10	0.10
	NE	424011			23.0	4.0	92.0	92.0	8.0	6.0	0.07	0.07	0.07
	SW	424001			12.0	10.0	120.0	120.0	20.0				
	SE	424001	32.0	32.0	14.0	6.0	84.0	84.0	12.0	11.0	0.14	0.14	0.14
					13.0	6.0	78.0	78.0	12.0				
(US 34) 6TH AVE. & 7TH ST.	NW	424001	12.0	12.0	10.0	4.0	40.0	40.0	8.0	5.0	0.06	0.06	0.06
	NE	424001	10.0	10.0	14.0	4.0	56.0	56.0	8.0	6.0	0.07	0.07	0.07
	SW	424001	12.0	12.0	12.0	4.0	48.0	48.0	8.0	6.0	0.07	0.07	0.07
	SE	424001	10.0	10.0	11.0	4.0	44.0	44.0	8.0	5.0	0.06	0.06	0.06
(US 34) 6TH AVE & 8TH ST.	NW	424006	14.0	14.0	25.0	4.0	100.0	100.0	8.0	9.0	0.11	0.11	0.11
	NE	424001	10.0	10.0	14.0	4.0	56.0	56.0	8.0	6.0	0.07	0.07	0.07
	SW	424001	30.0	30.0	24.0	5.0	120.0	120.0	10.0	12.0	0.15	0.15	0.15
	SE	424001	10.0	10.0	10.0	4.0	40.0	40.0	8.0	5.0	0.06	0.06	0.06
(US 34) 6TH AVE & 9TH ST.	NE	424001	10.0	10.0	16.0	4.0	64.0	64.0	8.0	6.0	0.07	0.07	0.07
	SE	424001	10.0	10.0	16.0	4.0	64.0	64.0	8.0	6.0	0.07	0.07	0.07
(US 34) 6TH AVE & 10TH ST.	NE	424001	10.0	10.0	15.0	4.0	60.0	60.0	8.0	6.0	0.07	0.07	0.07
	SE	424001	10.0	10.0	15.0	4.0	60.0	60.0	8.0	6.0	0.07	0.07	0.07
(US 34) 6TH AVE & 5TH AVE	NE	424001	10.0	10.0	15.0	4.0	60.0	60.0	8.0	6.0	0.07	0.07	0.07
	SE	424001	10.0	10.0	15.0	4.0	60.0	60.0	8.0	6.0	0.07	0.07	0.07
(US 34) 6TH AVE & 11TH ST.	NE	424001	10.0	10.0	15.0	4.0	60.0	60.0	8.0	6.0	0.07	0.07	0.07
	SE	424001	10.0	10.0	15.0	4.0	60.0	60.0	8.0	6.0	0.07	0.07	0.07
(US 34) 12TH ST. & 4TH AVE	NE	424001	10.0	10.0	15.0	4.0	60.0	60.0	8.0	6.0	0.07	0.07	0.07
	SE	424001	10.0	10.0	15.0	4.0	60.0	60.0	8.0	6.0	0.07	0.07	0.07
	NW	424001			10.0	4.0	40.0	40.0	8.0				
ALLEY/STA 37+87.64	SW	424026			12.0	8.0	96.0	96.0	16.0				
<b>TOTALS</b>			<b>478</b>	<b>478</b>	<b>927</b>	<b>449</b>	<b>5854</b>	<b>5854</b>	<b>805</b>	<b>232</b>	<b>3</b>	<b>3</b>	<b>3</b>



ADJUSTMENT SCHEDULE						
LOCATION	MANHOLES TO BE ADJ	MANHOLES TO BE ADJ W/ NEW TY1 FRAME & LID	HANDHOLE TO BE ADJ	WATER VALVES TO BE ADJ	VALVE BOXES TO BE ADJ	INLET TO BE ADJ
	60255500	60255800	81400115	56109210	60266600	60260100
	EACH	EACH	EACH	EACH	EACH	EACH
BEGIN - IOWA AVE.	1				1	2
IOWA AVE - 12th AVE	2					
12th AVE. - WISCONSIN AVE.	1					3
WISCONSIN AVE. - 11th AVE.						
11th AVE. - MICHIGAN AVE.		1			1	3
MICHIGAN AVE. - 10th AVE.	1	1*				
10th AVE. - PENNSYLVANIA AVE.	4					2
PENNSYLVANIA AVE. - INDIANA AVE.	6	3*, 2			1	
INDIANA AVE. - 8th AVE.	2	1*			2	2
8th AVE. - ILLINOIS AVE.						2
ILLINOIS AVE. - MAIN ST.	3				2	6
WASHINGTON AVE. - 6th ST.			1		1	1
MAIN ST. - 7th AVE.	3	1*	1			
7th AVE. - 6th AVE.	7	3				4
6th ST - 7th ST	1	1			1	
7th ST - 8th ST	1					
8th ST - 9th ST		1				
9th ST - 10th ST		1				
10th ST - 5th AVE.						
5th AVE. - 11th ST	1					
11th ST - 12th ST	1					
12th ST - 1st AVE.	3			1		
<b>TOTALS</b>	<b>37</b>	<b>15</b>	<b>2</b>	<b>1</b>	<b>9</b>	<b>25</b>

\*REPLACE NEW LIDS WITH MATCHING LETTERING "SANITARY"

PAVEMENT MARKING															
STATION	SHORT TERM PAVT MARK 4 IN	TEMP PAVT MARK L&S	TEMP PAVT MARK 4 IN	TEMP PAVT MARK 6 IN	TEMP PAVT MARK 8 IN	TEMP PAVT MARK 12 IN	TEMP PAVT MARK 24 IN	THERMO PLASTIC L&S	THERMO PLASTIC 4 IN	THERMO PLASTIC 6 IN	THERMO PLASTIC 8 IN	THERMO PLASTIC 12 IN	PREFORM PLASTIC TY B INLAID 24 IN	RAISED REFLECT MARK	RAISED REFLECT MARK REM
	FOOT	SQ FT	FOOT	FOOT	FOOT	FOOT	FOOT	SQ FT	FOOT	FOOT	FOOT	FOOT	FOOT	EACH	EACH
1+00 - 5+79	678	15.6	1584	192	194	120	28	15.6	1584	192	194	120	28	20	
5+79 - 20+00	426	117.4	0	1166	0	432	99	117.4	0	1166	0	432	99	16	
20+01 - 22+92.5	372	15.6	440	426	80	426	23	15.6	440	426	80	426	23		
22+92.5 - 31+70	756	62.4	376	112	138	112	0	62.4	376	112	138	112	0		
31+70 - 34+55	348	61.2	316	358	67	358	115	61.2	316	358	67	358	115		
34+55 - 40+00	165	61.2	966	432	0	326	182	61.2	966	432	0	326	182		
40+00 - 82+11	1827	112.8	5607.0	1389.0	0.0	162.0	165.0	112.8	5607	1389	0	162	165	74	
TEMP PAINT PVT MARK QUANTITIES FOR 1 APPLICATION (LEVEL BINDER, AND AN ABBREVIATED APPLICATION FOR MILLING)															
SHORT TERM PAVT MARK QUANTITIES FOR 3 APPLICATION (MILLING, LEVEL BINDER, AND SURFACE)															
<b>TOTALS</b>	<b>4572</b>	<b>446</b>	<b>9289</b>	<b>4075</b>	<b>479</b>	<b>1936</b>	<b>612</b>	<b>446</b>	<b>9289</b>	<b>4075</b>	<b>479</b>	<b>1936</b>	<b>612</b>	<b>110</b>	<b>118</b>

TIE POINTS					
US RTE. 34	FROM ILL 251 TO FIRST AVE IN MENDOTA			LASALLE COUNTY	
STATION	DESCRIPTION	EXISTING MONUMENT TYPE	PROPOSED MONUMENT TYPE	MONUMENT RECORD TO BE RECORDED	RESPONSIBILITY
	W QTR COR SEC 33-36-1E	BRASS PLUG	TYPE 1	YES	2
14+39.20	NW COR SEC 34-36-1E	BRASS PLUG	TYPE 1	NO	2

NOTE: FOR ALL MONUMENT LOCATIONS SEE TIE SKETCHES

RESPONSIBILITY:  
 1) RESIDENT TO RE-ESTABLISH MONUMENT  
 2) RESIDENT TO RE-ESTABLISH MONUMENT AND FURNISH TIE SKETCHES TO D-3 PLATS AND PLANS (PAY ITEM REQUIRED, PERMANENT SURVEY MARKER, TYPE 1)

**14 + 39.20 NW COR SEC 34-36-1E**

**W COR SEC 33-36-1E**

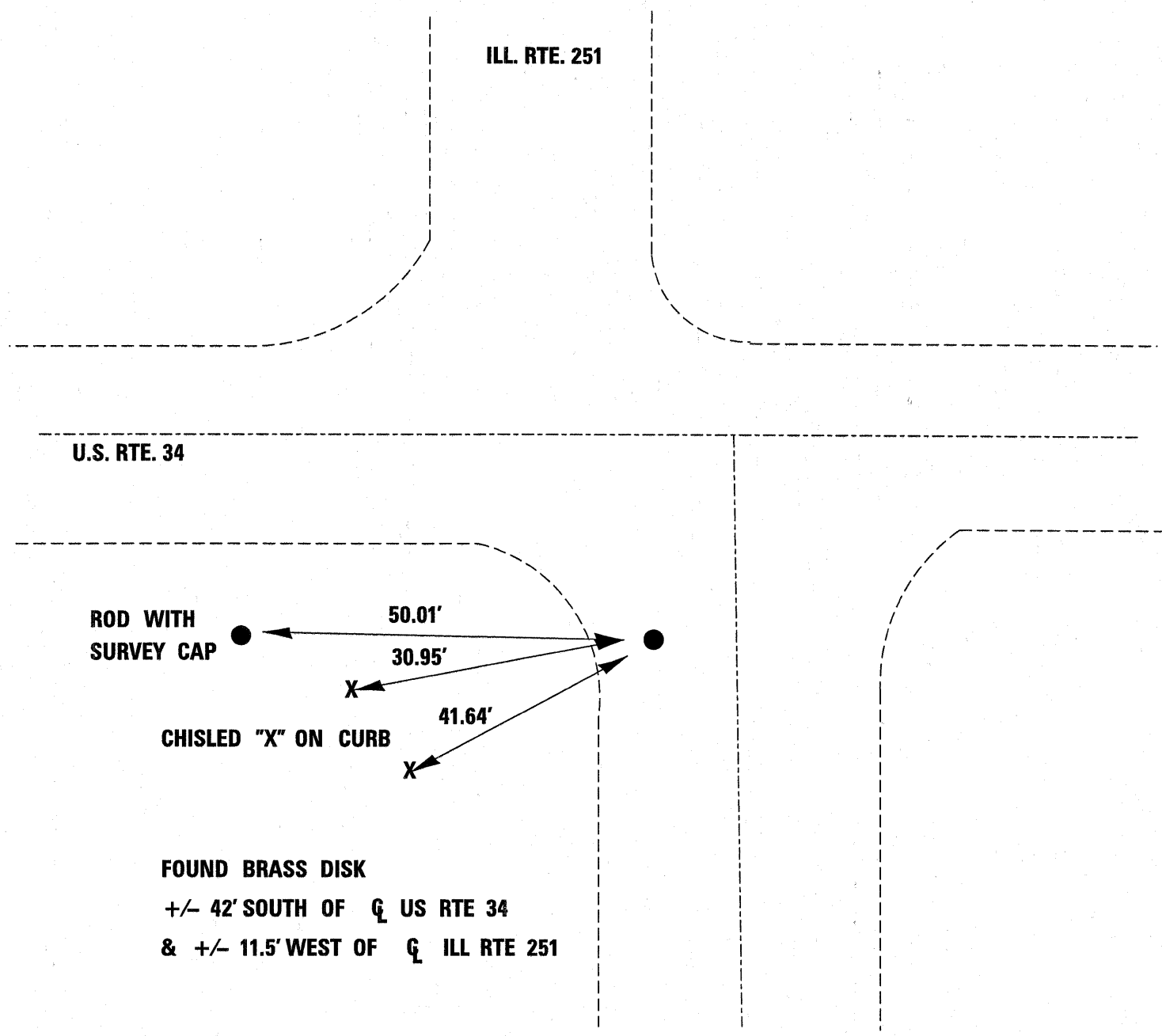
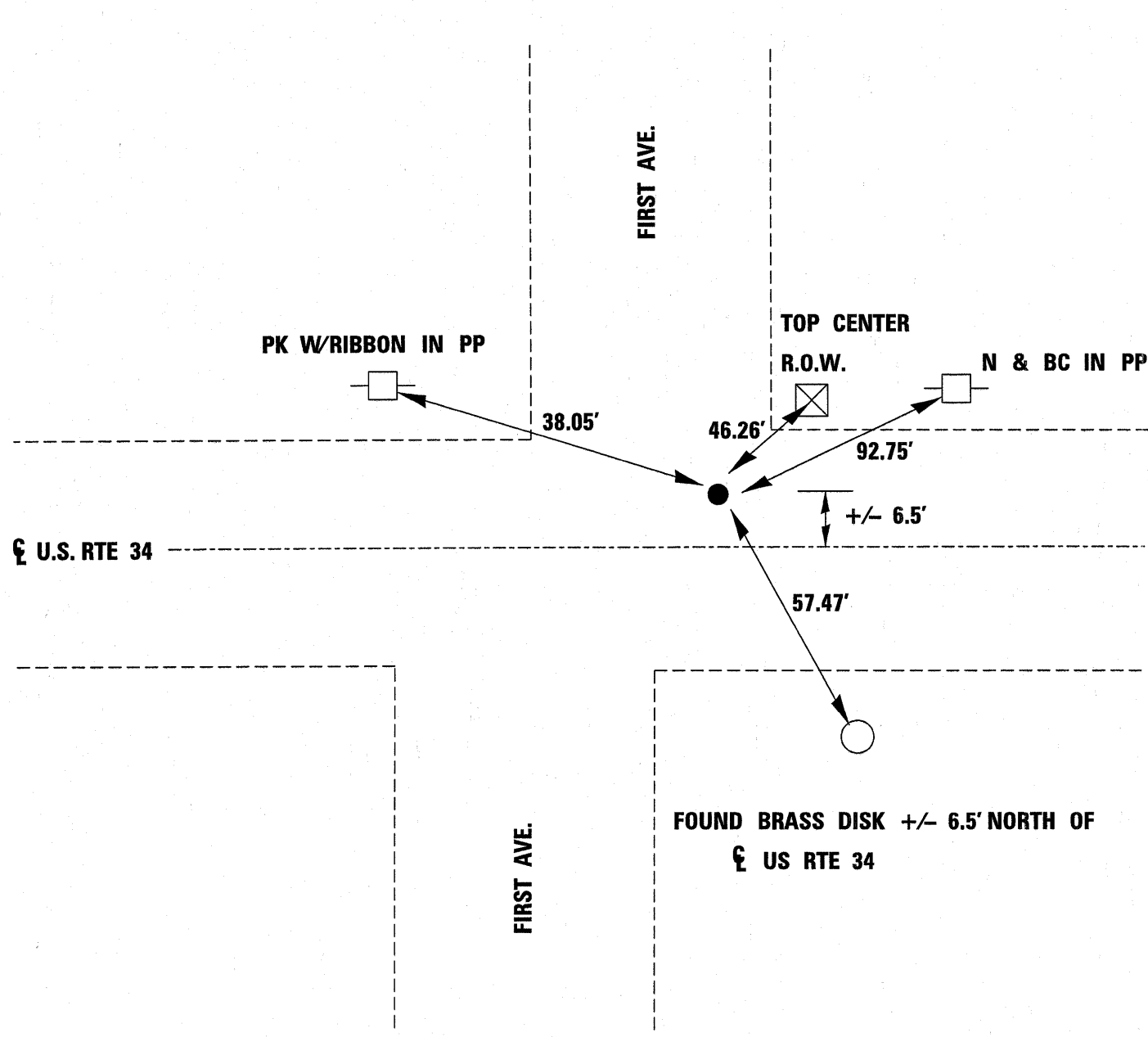

FILE NAME =	USER NAME = quigley.m	DESIGNED -	REVISED -
c:\pw_work\pwsdot\quigley.m\d0253613\0366616-sht-cover.dgn		DRAWN -	REVISED -
		CHECKED -	REVISED -
		DATE -	REVISED -

**STATE OF ILLINOIS  
DEPARTMENT OF TRANSPORTATION**

TIE POINTS			
SCALE:	SHEET NO.	OF SHEETS	STA. TO STA.

F.A. RTE.	SECTION	COUNTY	TOTAL SHEETS	SHEET NO.
587	(20X) RS-2	LaSALLE		10
CONTRACT NO. 66B16				
ILLINOIS FED. AID PROJECT				

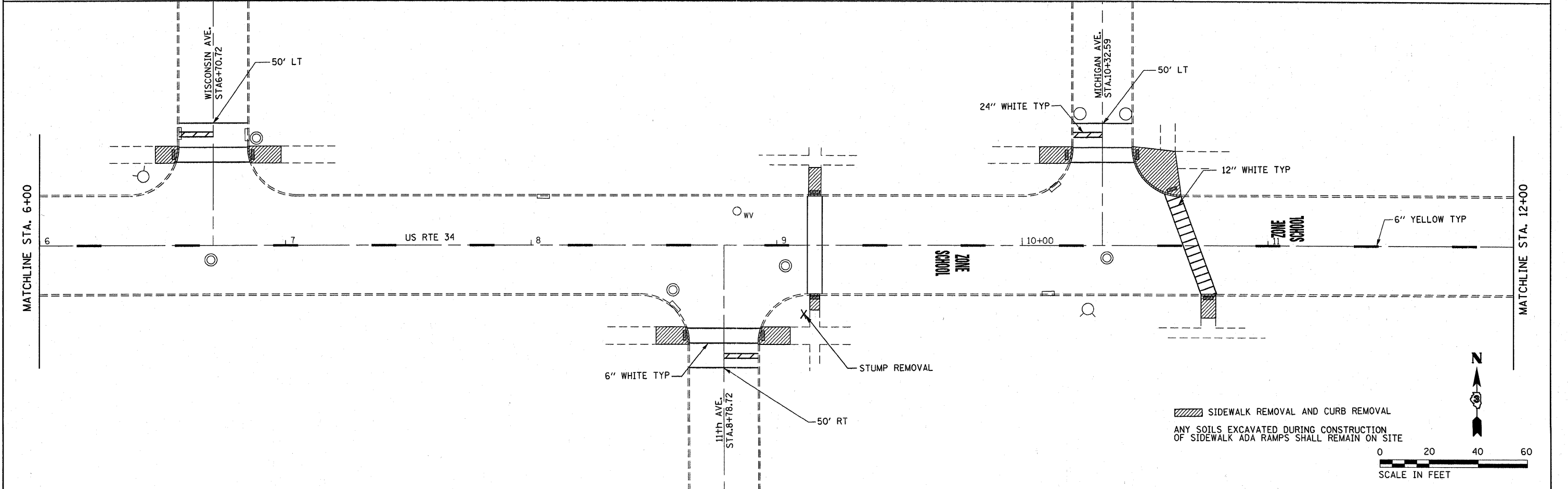
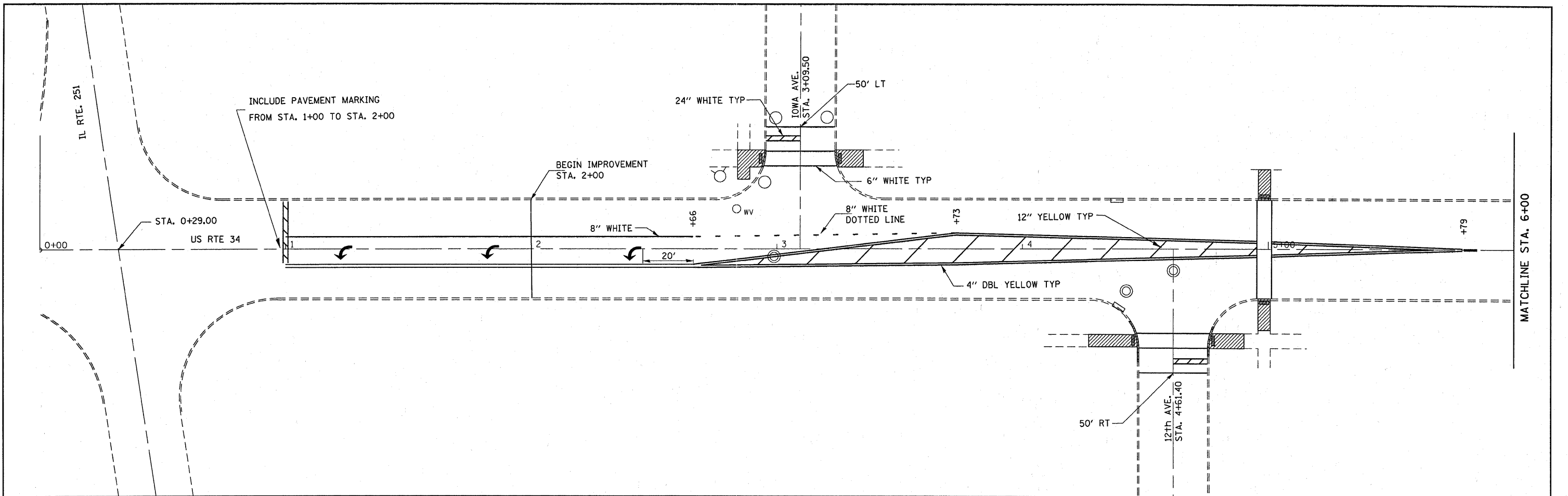

SIDEWALK REMOVAL AND CURB REMOVAL  
 ANY SOILS EXCAVATED DURING CONSTRUCTION OF SIDEWALK ADA RAMPS SHALL REMAIN ON SITE



FILE NAME =	USER NAME = quigleyml	DESIGNED -	REVISED -	<b>STATE OF ILLINOIS DEPARTMENT OF TRANSPORTATION</b>	<b>PLAN VIEW US 34 IN MENDOTA</b>	F.A.P. RTE.	SECTION	COUNTY	TOTAL SHEETS	SHEET NO.
o:\p\work\pwidot\quigleyml\d0253613\036816-plan1.dgn	DRAWN -	REVISED -	587			(20)RS-2	LASALLE	11		
PLOT SCALE = 20.0000' / 1" /	CHECKED -	REVISED -	CONTRACT NO. 66816							
PLOT DATE = 11/30/2011	DATE -	REVISED -	ILLINOIS FED. AID PROJECT							

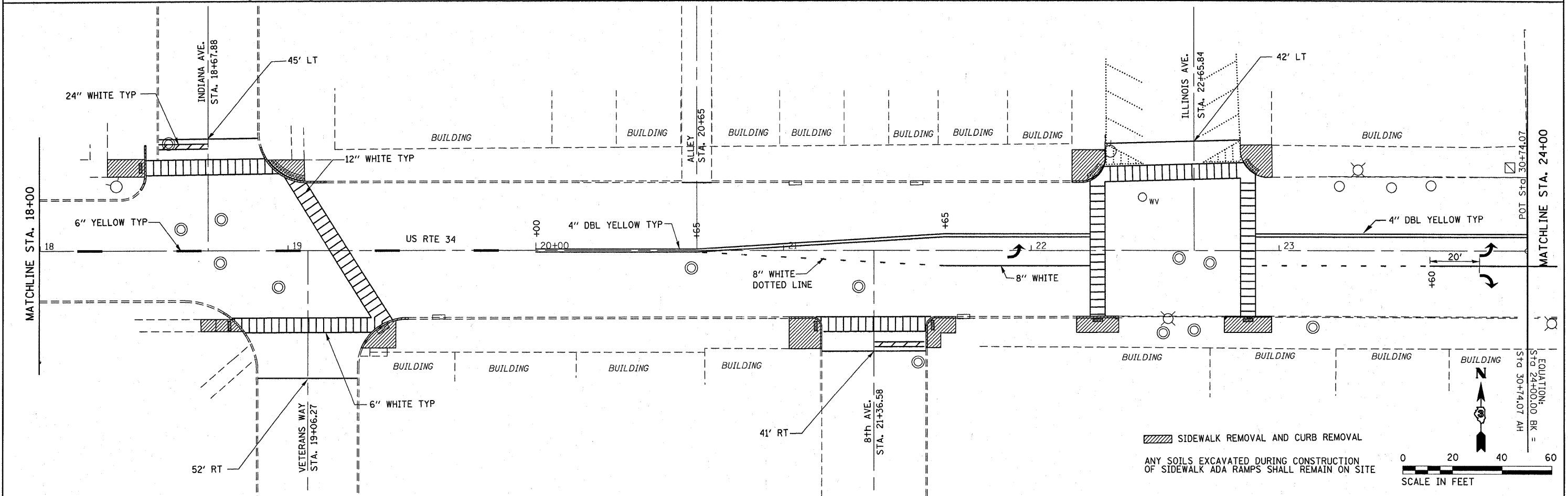
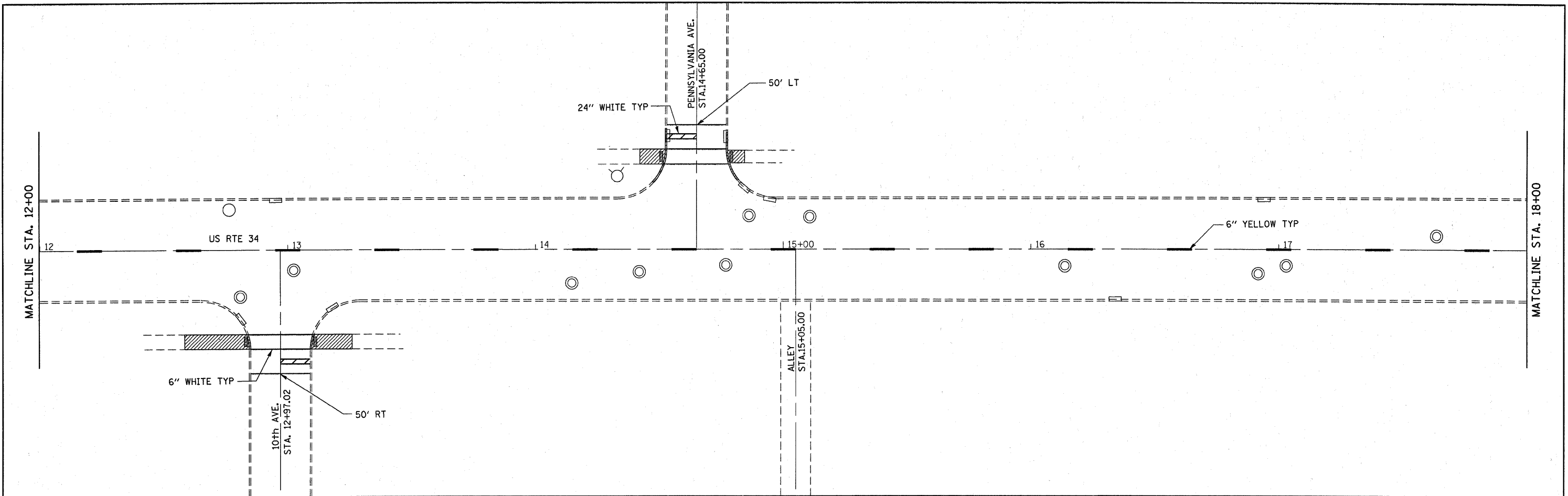

▨ SIDEWALK REMOVAL AND CURB REMOVAL

ANY SOILS EXCAVATED DURING CONSTRUCTION OF SIDEWALK ADA RAMPS SHALL REMAIN ON SITE

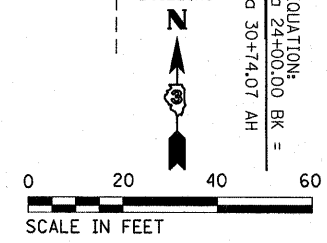

FILE NAME =	USER NAME = quigley.m	DESIGNED -	REVISED -
c:\pwwork\pwwork\quigley.m\d0253613\036816-plan1.dgn		DRAWN -	REVISED -
PLOT SCALE = 20.0000' / 1"		CHECKED -	REVISED -
PLOT DATE = 11/30/2011		DATE -	REVISED -

**STATE OF ILLINOIS  
DEPARTMENT OF TRANSPORTATION**

**PLAN VIEW  
US 34 IN MENDOTA**

SCALE: SHEET NO. OF SHEETS STA. 12+00 TO STA. 24+00

F.A.P. RTE.	SECTION	COUNTY	TOTAL SHEETS	SHEET NO.
587	(20)RS-2	LASALLE	12	12
				CONTRACT NO. 66B16
ILLINOIS FED. AID PROJECT				

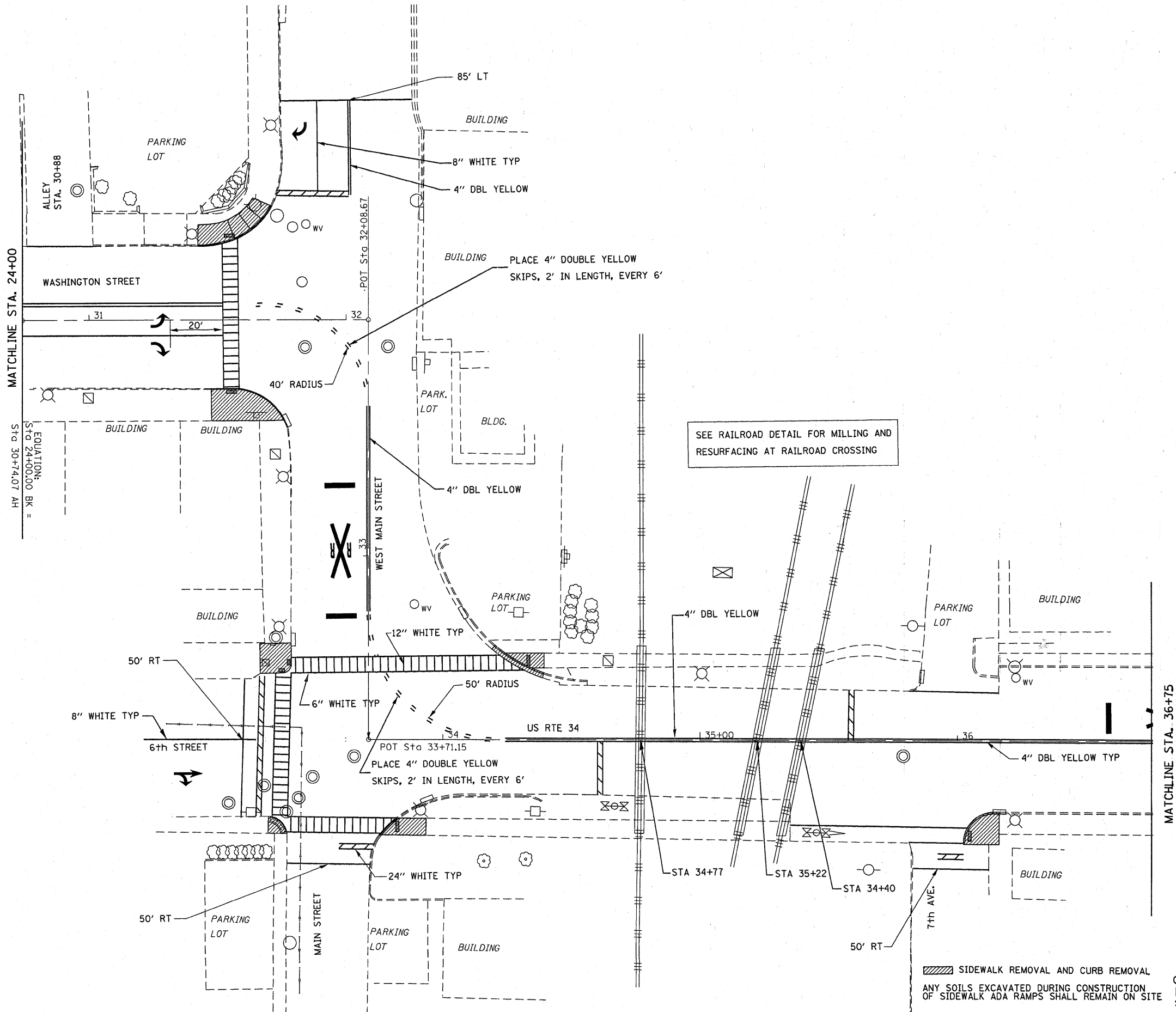

SEE RAILROAD DETAIL FOR MILLING AND RESURFACING AT RAILROAD CROSSING

 SIDEWALK REMOVAL AND CURB REMOVAL  
 ANY SOILS EXCAVATED DURING CONSTRUCTION OF SIDEWALK ADA RAMPS SHALL REMAIN ON SITE

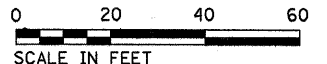

FILE NAME =	USER NAME = quigleyml	DESIGNED -	REVISED -
c:\pwork\pwsdot\quigleyml\0253613\036816-plan1.dgn		DRAWN -	REVISED -
PLOT SCALE = 20.0000' / in.		CHECKED -	REVISED -
PLOT DATE = 11/30/2011		DATE -	REVISED -

**STATE OF ILLINOIS  
DEPARTMENT OF TRANSPORTATION**

**PLAN VIEW  
US 34 IN MENDOTA**

SCALE: SHEET NO. OF SHEETS STA. 24+00 TO STA. 36+75

F.A.P. RTE.	SECTION	COUNTY	TOTAL SHEETS	SHEET NO.
587	(20)RS-2	LASALLE	13	
CONTRACT NO. 66816			ILLINOIS FED. AID PROJECT	

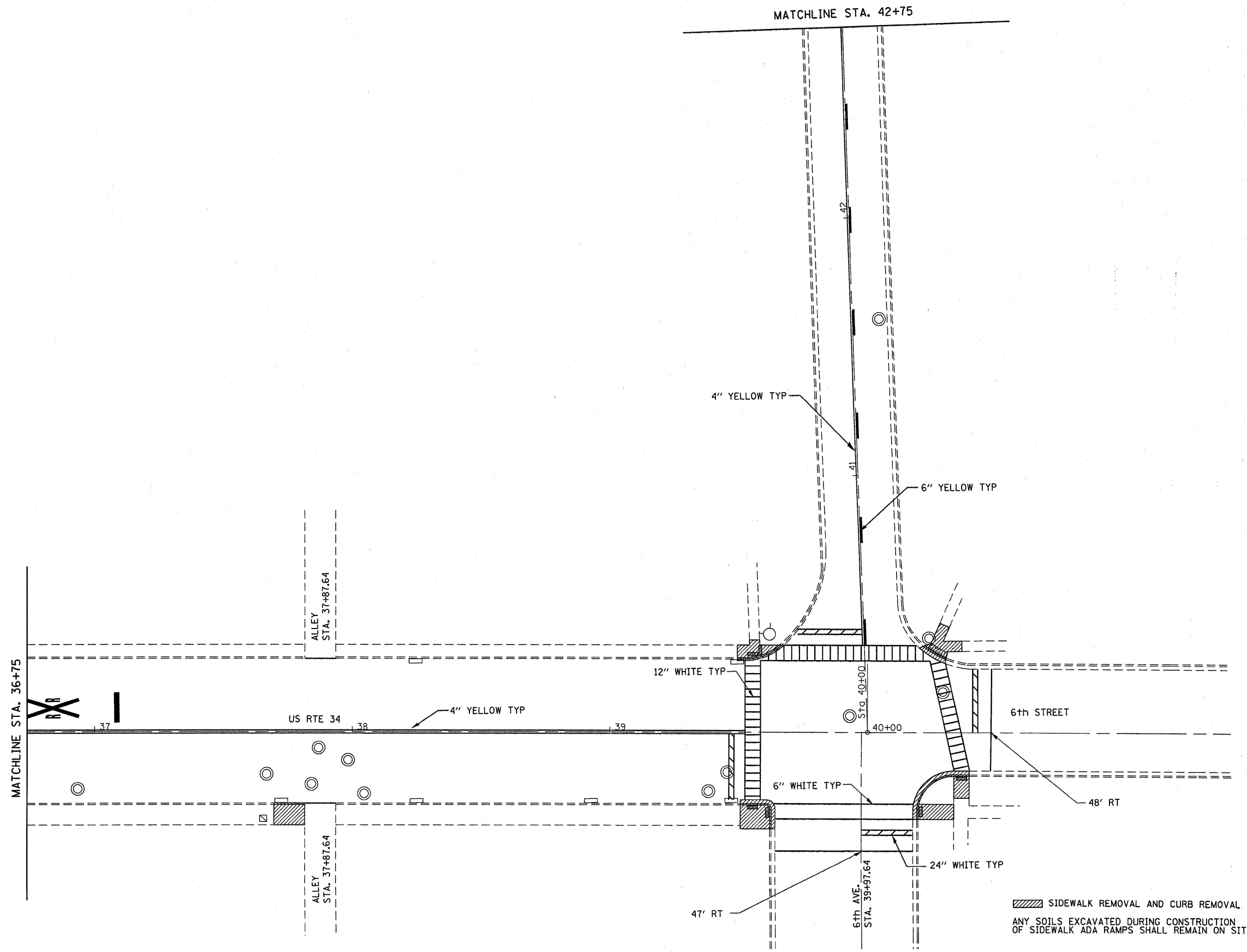

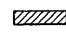
 SIDEWALK REMOVAL AND CURB REMOVAL  
 ANY SOILS EXCAVATED DURING CONSTRUCTION OF SIDEWALK ADA RAMPS SHALL REMAIN ON SITE

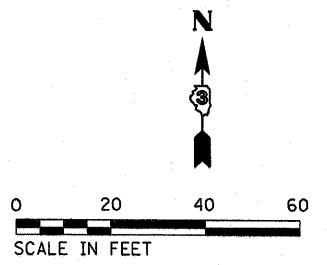

FILE NAME =	USER NAME = quigleyml	DESIGNED -	REVISED -
c:\pwwork\pwwork\quigleyml\d0253613\0366816-pln1.dgn		DRAWN -	REVISED -
PLOT SCALE = 20.0000' / in.		CHECKED -	REVISED -
PLOT DATE = 11/30/2011		DATE -	REVISED -

**STATE OF ILLINOIS**  
**DEPARTMENT OF TRANSPORTATION**

<b>PLAN VIEW</b>			
<b>US 34 IN MENDOTA</b>			
SCALE:	SHEET NO.	OF SHEETS	STA. 36+75 TO STA. 42+75

F.A.P. RTE.	SECTION	COUNTY	TOTAL SHEETS	SHEET NO.
587	(20X)RS-2	LASALLE	14	14
CONTRACT NO. 66B16				
ILLINOIS FED. AID PROJECT				

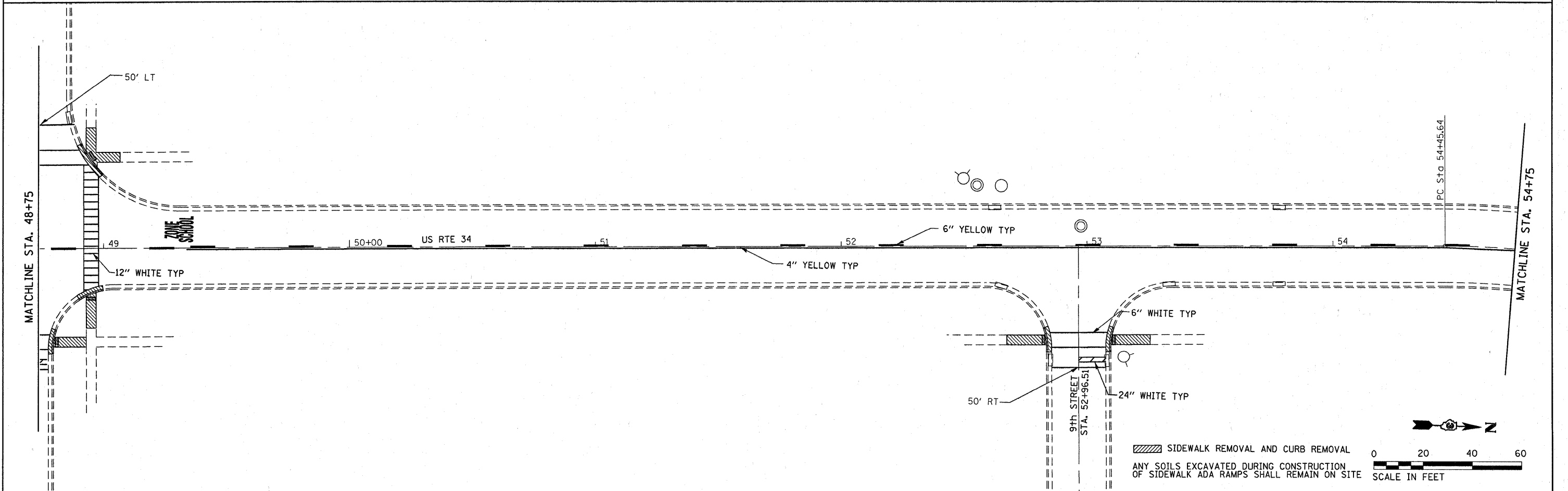
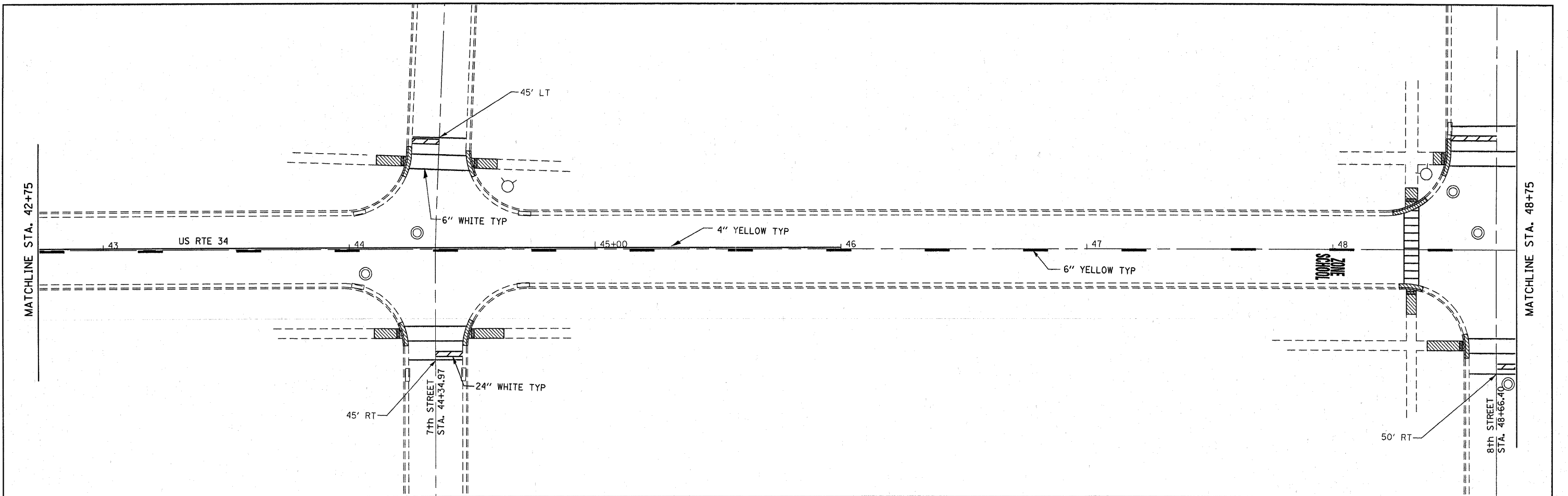

SIDEWALK REMOVAL AND CURB REMOVAL  
 ANY SOILS EXCAVATED DURING CONSTRUCTION OF SIDEWALK ADA RAMPS SHALL REMAIN ON SITE

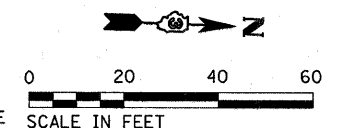

FILE NAME =	USER NAME = quigleyml	DESIGNED -	REVISED -
c:\pwwork\pwwork\quigleyml\d0253613\036816-pln1.dgn		DRAWN -	REVISED -
PLOT SCALE = 20.0000' / 1" =		CHECKED -	REVISED -
PLOT DATE = 11/30/2011		DATE -	REVISED -

**STATE OF ILLINOIS**  
**DEPARTMENT OF TRANSPORTATION**

<b>PLAN VIEW</b>				
<b>US 34 IN MENDOTA</b>				
SCALE:	SHEET NO.	OF	SHEETS	STA. 42+75 TO STA. 54+75

F.A.P. RTE.	SECTION	COUNTY	TOTAL SHEETS	SHEET NO.
587	(20X)RS-2	LASALLE	15	15
CONTRACT NO. 66B16			ILLINOIS FED. AID PROJECT	

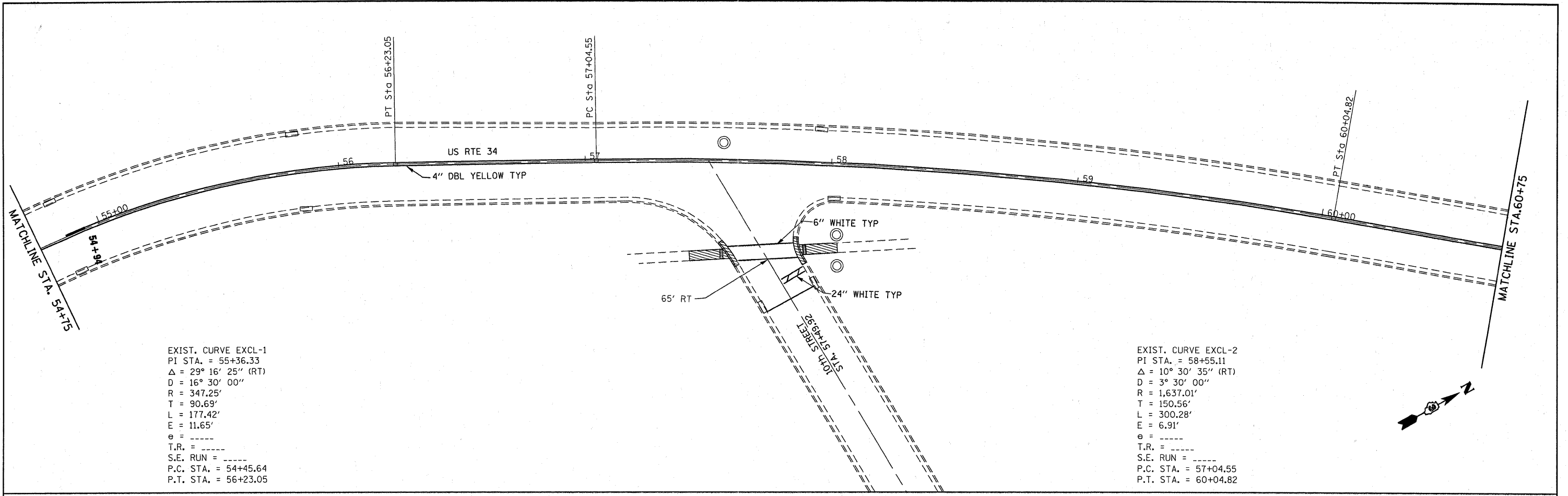

EXIST. CURVE EXCL-1  
 PI STA. = 55+36.33  
 $\Delta$  = 29° 16' 25" (RT)  
 D = 16° 30' 00"  
 R = 347.25'  
 T = 90.69'  
 L = 177.42'  
 E = 11.65'  
 e = -----  
 T.R. = -----  
 S.E. RUN = -----  
 P.C. STA. = 54+45.64  
 P.T. STA. = 56+23.05

EXIST. CURVE EXCL-2  
 PI STA. = 58+55.11  
 $\Delta$  = 10° 30' 35" (RT)  
 D = 3° 30' 00"  
 R = 1,637.01'  
 T = 150.56'  
 L = 300.28'  
 E = 6.91'  
 e = -----  
 T.R. = -----  
 S.E. RUN = -----  
 P.C. STA. = 57+04.55  
 P.T. STA. = 60+04.82

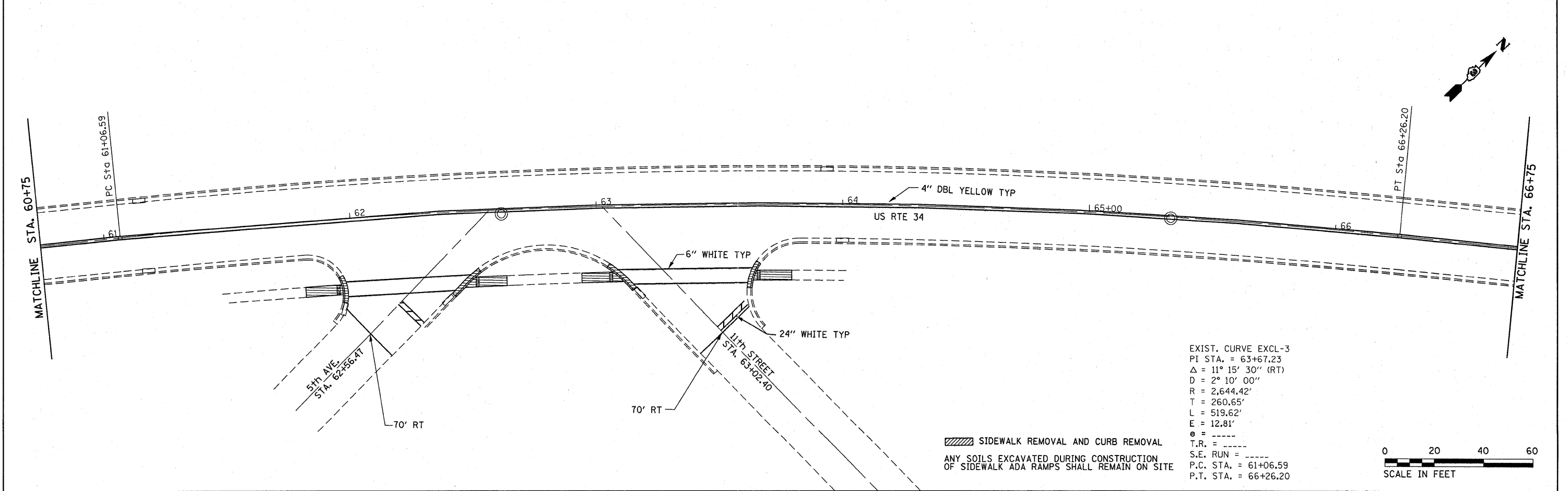

EXIST. CURVE EXCL-3  
 PI STA. = 63+67.23  
 $\Delta$  = 11° 15' 30" (RT)  
 D = 2° 10' 00"  
 R = 2,644.42'  
 T = 260.65'  
 L = 519.62'  
 E = 12.81'  
 e = -----  
 T.R. = -----  
 S.E. RUN = -----  
 P.C. STA. = 61+06.59  
 P.T. STA. = 66+26.20

▨ SIDEWALK REMOVAL AND CURB REMOVAL  
 ANY SOILS EXCAVATED DURING CONSTRUCTION  
 OF SIDEWALK ADA RAMPS SHALL REMAIN ON SITE

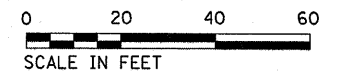

FILE NAME =  
 c:\pwork\pwork\quigley\1\0253613\036816-plen1.dgn

USER NAME = quigleyml  
 PLOT SCALE = 20,0000' / in.  
 PLOT DATE = 11/30/2011

DESIGNED -  
 DRAWN -  
 CHECKED -  
 DATE -

REVISED -  
 REVISED -  
 REVISED -  
 REVISED -

STATE OF ILLINOIS  
 DEPARTMENT OF TRANSPORTATION

PLAN VIEW  
 US 34 IN MENDOTA

SCALE: SHEET NO. OF SHEETS STA. 54+75 TO STA. 66+75

F.A.P. RTE. 587	SECTION (20)XRS-2	COUNTY LASALLE	TOTAL SHEETS 16	SHEET NO. 16
CONTRACT NO. 66B16				
ILLINOIS FED. AID PROJECT				



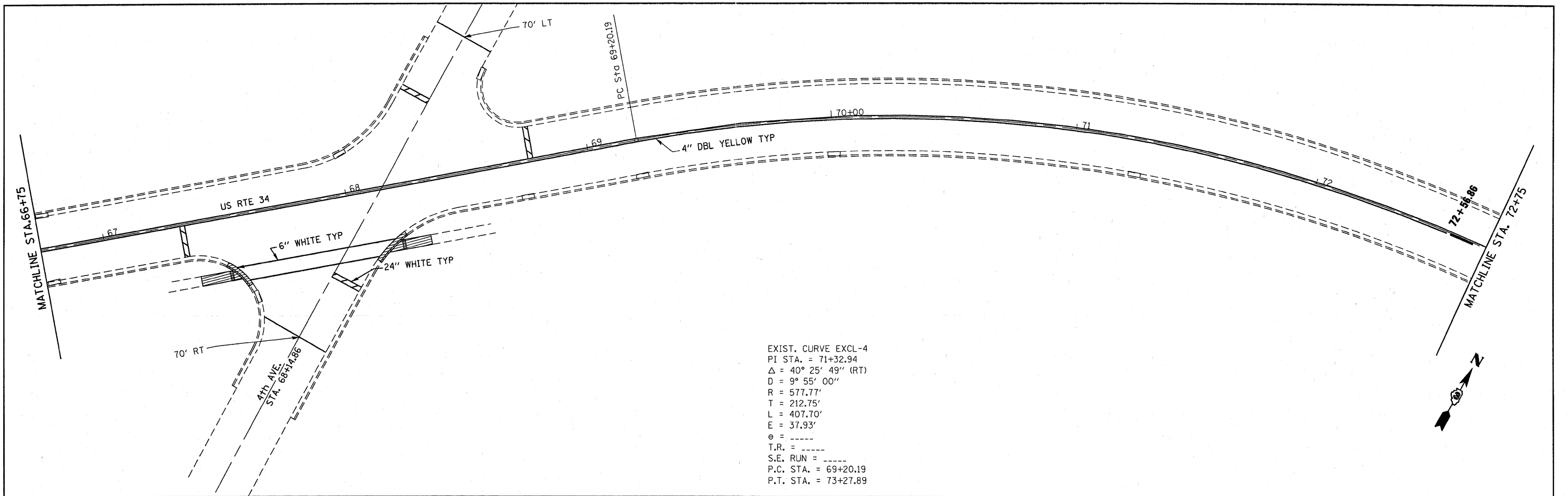

EXIST. CURVE EXCL-4  
 PI STA. = 71+32.94  
 $\Delta = 40^\circ 25' 49''$  (RT)  
 $D = 9^\circ 55' 00''$   
 $R = 577.77'$   
 $T = 212.75'$   
 $L = 407.70'$   
 $E = 37.93'$   
 $e = \text{-----}$   
 $T.R. = \text{-----}$   
 $S.E. \text{ RUN} = \text{-----}$   
 $P.C. \text{ STA.} = 69+20.19$   
 $P.T. \text{ STA.} = 73+27.89$

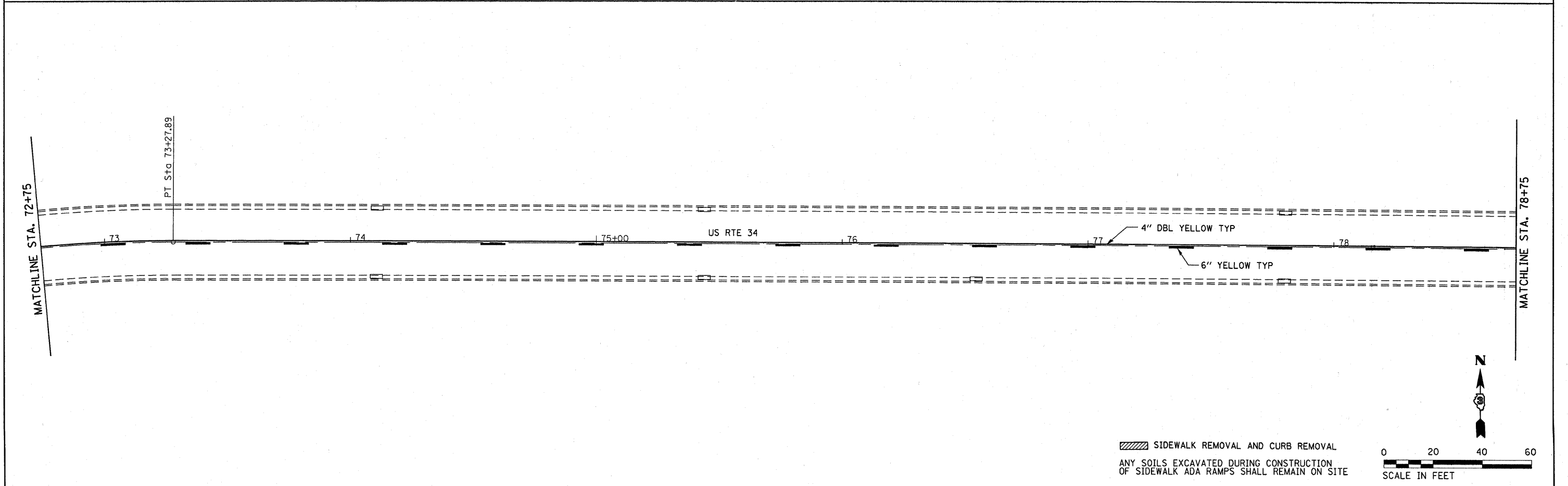
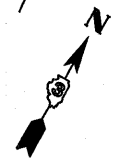

SIDEWALK REMOVAL AND CURB REMOVAL  
 ANY SOILS EXCAVATED DURING CONSTRUCTION  
 OF SIDEWALK ADA RAMPS SHALL REMAIN ON SITE

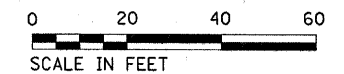

FILE NAME =	USER NAME = quigleyml	DESIGNED -	REVISED -	<b>STATE OF ILLINOIS DEPARTMENT OF TRANSPORTATION</b>	<b>PLAN VIEW US 34 IN MENDOTA</b>	F.A.P. RTE.	SECTION	COUNTY	TOTAL SHEETS	SHEET NO.	
cr:\pvt\work\pvt\dot\quigleyml\d0253613\036816-plan1.dgn		DRAWN -	REVISED -			587	(20)IRS-2	LASALLE	17		
PLOT SCALE = 20.0000' / 1"		CHECKED -	REVISED -			SCALE: SHEET NO. OF SHEETS STA. 66+75 TO STA. 78+75		CONTRACT NO. 66B16			
PLOT DATE = 11/30/2011		DATE -	REVISED -			ILLINOIS FED. AID PROJECT					

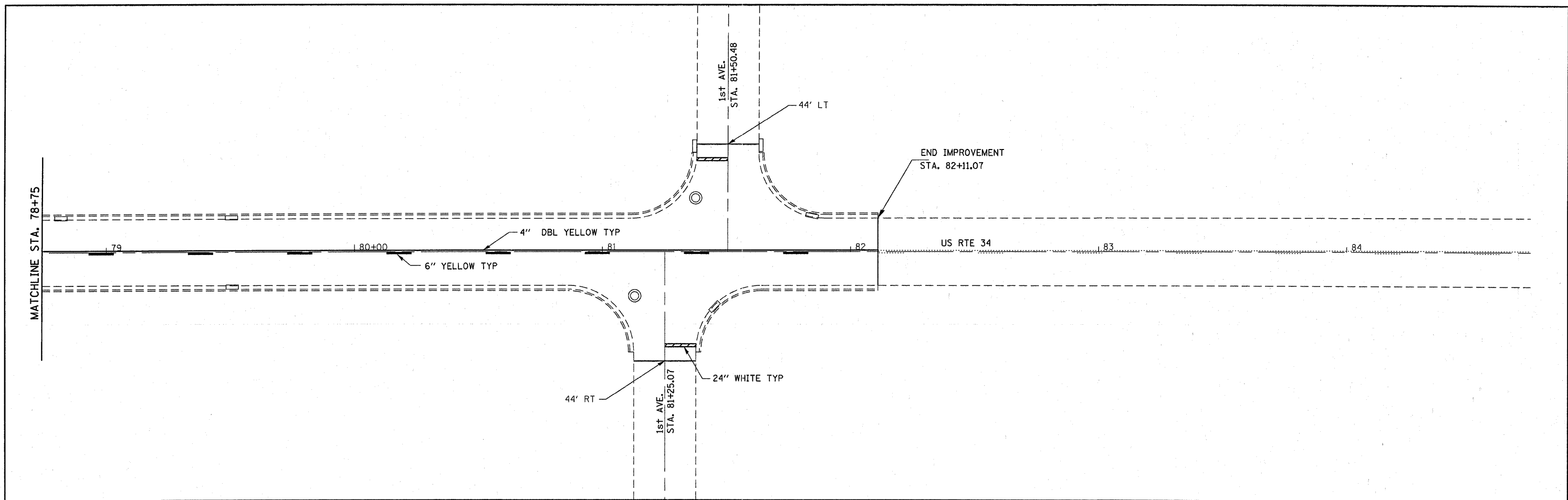

 SIDEWALK REMOVAL AND CURB REMOVAL  
 ANY SOILS EXCAVATED DURING CONSTRUCTION OF SIDEWALK ADA RAMP SHALL REMAIN ON SITE

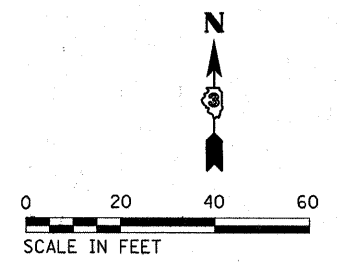

FILE NAME =	USER NAME = quigley.m	DESIGNED -	REVISED -
ct:\pw_work\p\dot\quigley.m\0253613\0366816-plan1.dgn		DRAWN -	REVISED -
PLOT SCALE = 20.0000' / 1"		CHECKED -	REVISED -
PLOT DATE = 11/30/2011		DATE -	REVISED -

**STATE OF ILLINOIS**  
**DEPARTMENT OF TRANSPORTATION**

<b>PLAN VIEW</b>			
<b>US 34 IN MENDOTA</b>			
SCALE:	SHEET NO.	OF SHEETS	STA. 78+75 TO STA. 85+00

F.A.P. RTE. 587	SECTION (20XRS-2)	COUNTY LASALLE	TOTAL SHEETS 18	SHEET NO. 18
CONTRACT NO. 66B16				ILLINOIS FED. AID PROJECT

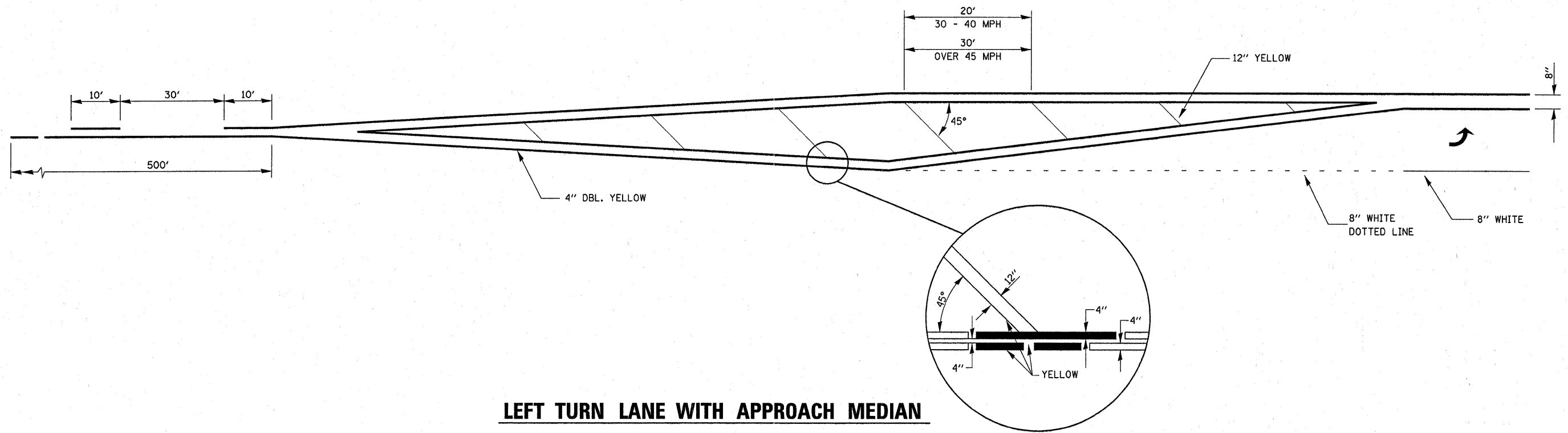

**LEFT TURN LANE WITH APPROACH MEDIAN**

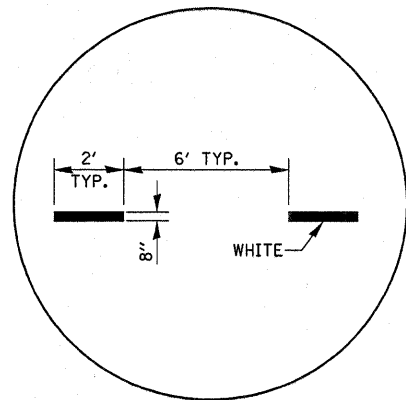

**ADVANCE AND INTERSECTION LANE DIVIDER LINES**

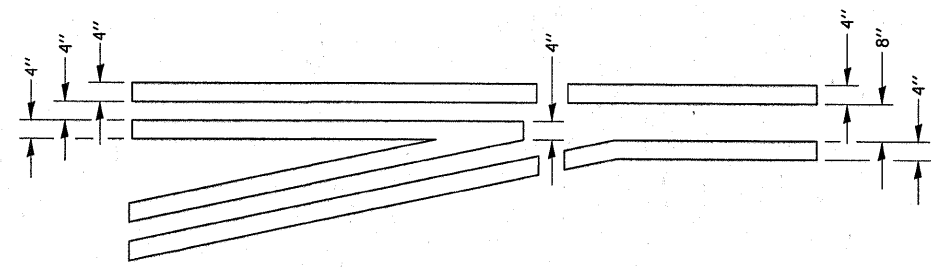

**TYPICAL APPLICATION LEFT TURN LANES**

FILE NAME =	USER NAME = quigleyml	DESIGNED -	REVISED -	<b>STATE OF ILLINOIS DEPARTMENT OF TRANSPORTATION</b>	<b>PAVEMENT MARKING DETAILS</b>				F.A.P. RTE.	SECTION	COUNTY	TOTAL SHEETS	SHEET NO.	
c:\pwork\pwidot\quigleyml\d8253613\0368816-shi-details.DGN		DRAWN -	REVISED -		SCALE:	SHEET NO.	OF	SHEETS	STA.	TO STA.	587	(20X) RS-2	LA SALLE	19
		PLOT SCALE = 50.0000' / in.	CHECKED -		REVISED -								CONTRACT NO. 66B16	
		PLOT DATE = 11/30/2011	DATE -		REVISED -								ILLINOIS FED. AID PROJECT	

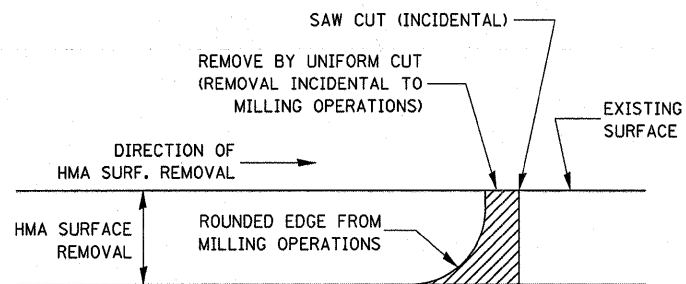

NOTE:  
 WHEN MILLING OPERATIONS PRODUCE A ROUNDED EDGE,  
 THEN A SAW CUT SHALL BE USED TO MANUFACTURE  
 A PERPENDICULAR EDGE AS SHOWN IN THE DETAIL.  
 THE ENGINEER SHALL BE THE SOLE JUDGE  
 CONCERNING THE USE OF THIS DETAIL

**HMA DETAIL AT BUTT JOINTS**

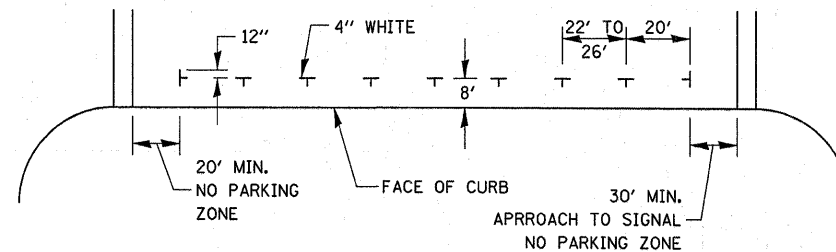

**PREFERRED METHOD**

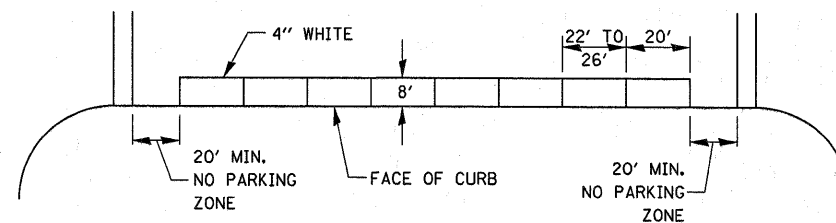

**OPTION 2**

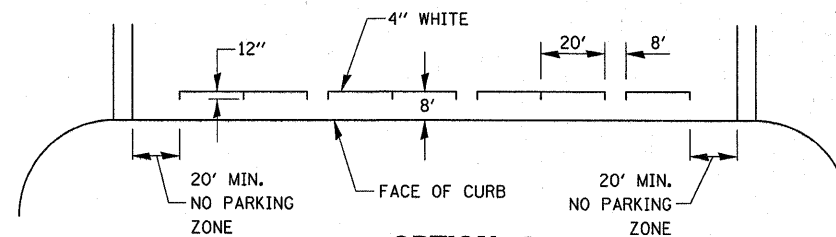

**OPTION 3**

**TYPICAL PARKING SPACING**

FILE NAME =	USER NAME = quigleyml	DESIGNED -	REVISED -	<b>STATE OF ILLINOIS DEPARTMENT OF TRANSPORTATION</b>	<b>PAVEMENT MARKING DETAILS</b>				F.A.P. RTE.	SECTION	COUNTY	TOTAL SHEETS	SHEET NO.
c:\pwork\pwidot\quigleyml\d0253613\036816-sht-details.DGN		DRAWN -	REVISED -		587	(20X) RS-2	LA SALLE	20	20				
PLOT SCALE = 50.0000' / in.		CHECKED -	REVISED -		CONTRACT NO. 66B16								
PLOT DATE = 11/30/2011		DATE -	REVISED -		ILLINOIS FED. AID PROJECT								
				SCALE:	SHEET NO.	OF	SHEETS	STA.	TO STA.				

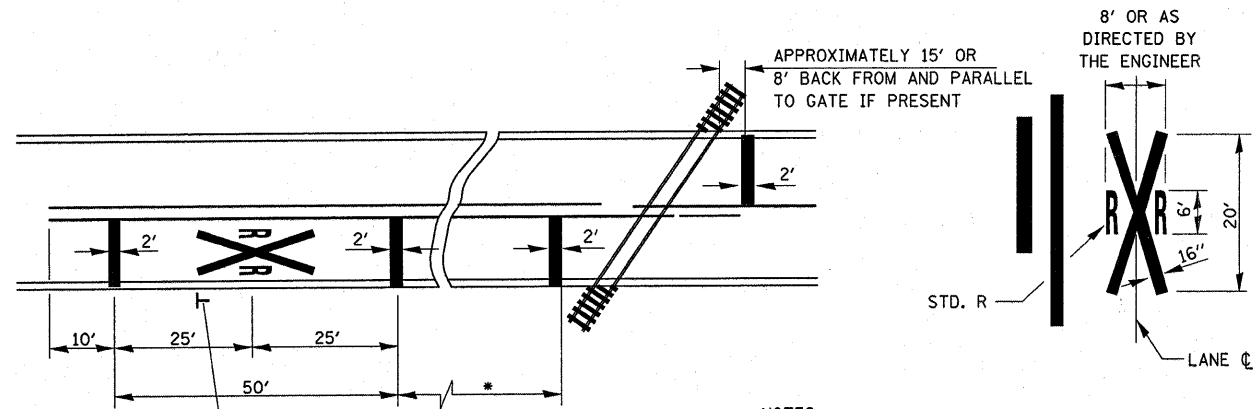

\* MINIMUM DISTANCE  
 400' FOR 55 MPH  
 250' FOR 45 MPH  
 100' FOR 35 MPH OR LESS

**PAVEMENT MARKINGS AT  
 RAILROAD-HIGHWAY GRADE CROSSING**

NOTES:  
 THE TRANSVERSE SPREAD OF THE "X"  
 MAY VARY ACCORDING TO LANE WIDTH.

ON MULTI-LANE ROADS, THE STOP LINES  
 SHALL EXTEND ACROSS ALL APPROACH  
 LANES AND SEPARATE RXR SYMBOLS SHALL  
 BE PLACED ADJACENT TO EACH OTHER  
 IN EACH LANE.

WHEN THE PAVEMENT MARKING SYMBOL  
 IS USED, A PORTION OF THE SYMBOL  
 SHOULD BE LOCATED DIRECTLY ADJACENT  
 TO THE ADVANCE WARNING SIGN (W10-1).

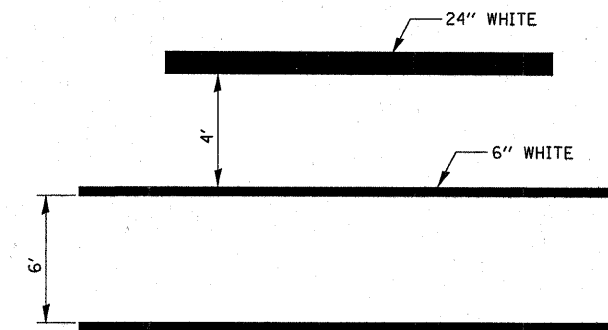

**TYPICAL SPACING DETAIL FOR  
 CROSSWALKS AND STOP BARS**

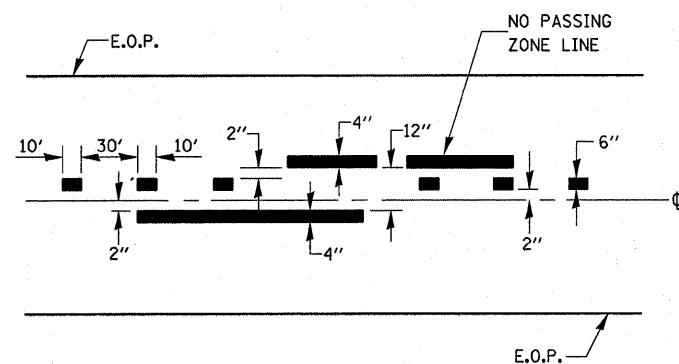

CENTERLINE & NO PASSING  
 ZONE LINES - YELLOW  
 (SEE TYPICAL SECTIONS)

**PAVEMENT MARKING**

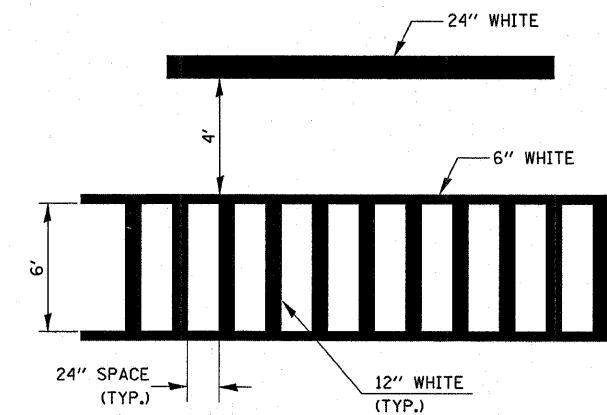

**TYPICAL SPACING DETAIL FOR  
 CROSSWALKS AND STOP BARS**

FILE NAME =	USER NAME = qugleym	DESIGNED -	REVISED -	<b>STATE OF ILLINOIS DEPARTMENT OF TRANSPORTATION</b>	<b>PAVEMENT MARKING DETAILS</b>				F.A.P. RTE.	SECTION	COUNTY	TOTAL SHEETS	SHEET NO.
o:\pwork\pwork\qugleym\0253613\036816-ehd-details.DGN	PLOT SCALE = 50.0000' / in.	DRAWN -	REVISED -		587	(20X) RS-2	LA SALLE	21					
	PLOT DATE = 11/30/2011	CHECKED -	REVISED -		SCALE:	SHEET NO.	OF	SHEETS	STA.	TO STA.	CONTRACT NO. 66B16		
		DATE -	REVISED -								ILLINOIS FED. AID PROJECT		

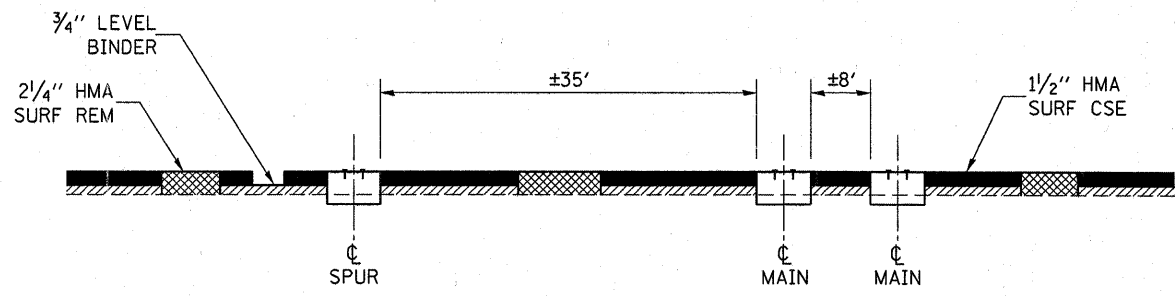
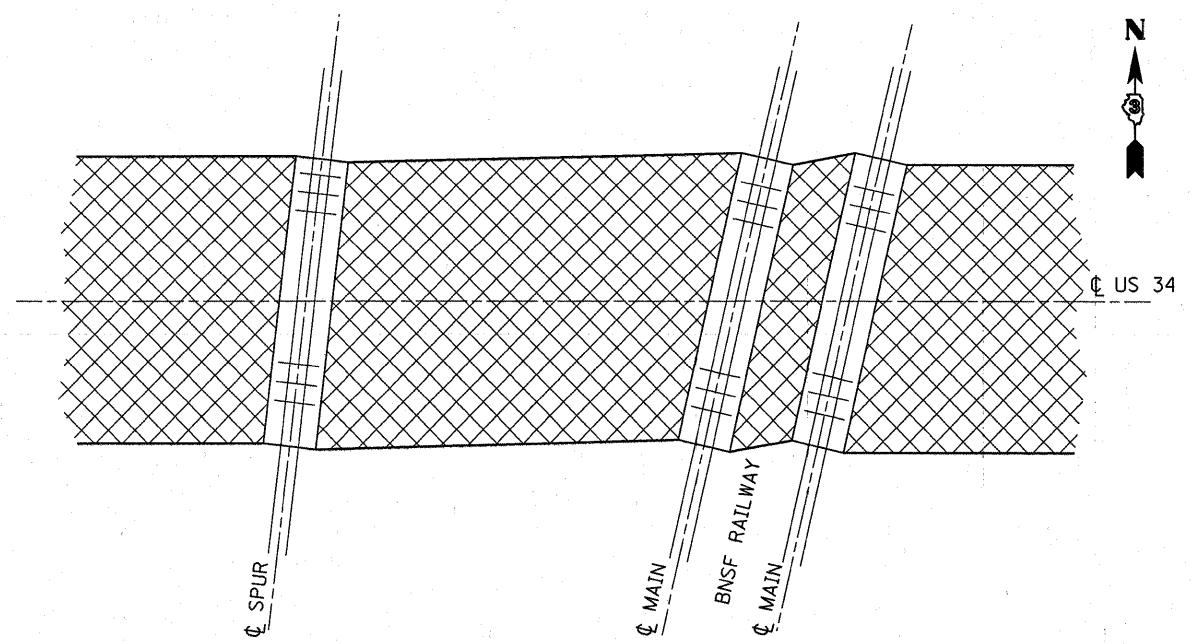

**PROPOSED MILLING & RESURFACING DETAIL  
AT THE BNSF RAILWAY GRADE CROSSING**

(DOT/AAR NO. 079 643 S)

FILE NAME = c:\pw_work\pwidot\quigley\1\0253613\036816-sht-details.DGN	USER NAME = quigleyml	DESIGNED -	REVISED -	<b>STATE OF ILLINOIS DEPARTMENT OF TRANSPORTATION</b>	<b>RAILROAD DETAIL</b>				F.A.P. RTE.	SECTION	COUNTY	TOTAL SHEETS	SHEET NO.	
	PLOT SCALE = 50.0000' / in.	DRAWN -	REVISED -		SCALE:	SHEET NO.	OF	SHEETS	STA.	TO STA.	587	(20X) RS-2	LA SALLE	22
	PLOT DATE = 11/30/2011	CHECKED -	REVISED -											
		DATE -	REVISED -											
												ILLINOIS FED. AID PROJECT		