

**ELEVATION**

**GENERAL NOTES**

REINFORCEMENT BARS DESIGNATED (E) SHALL BE EPOXY COATED.  
 WATERPROOFING MEMBRANE SHALL BE APPLIED TO THE DESIGNATED AREAS ON THE BACKSIDE OF THE WINGWALL AS DETAILED.

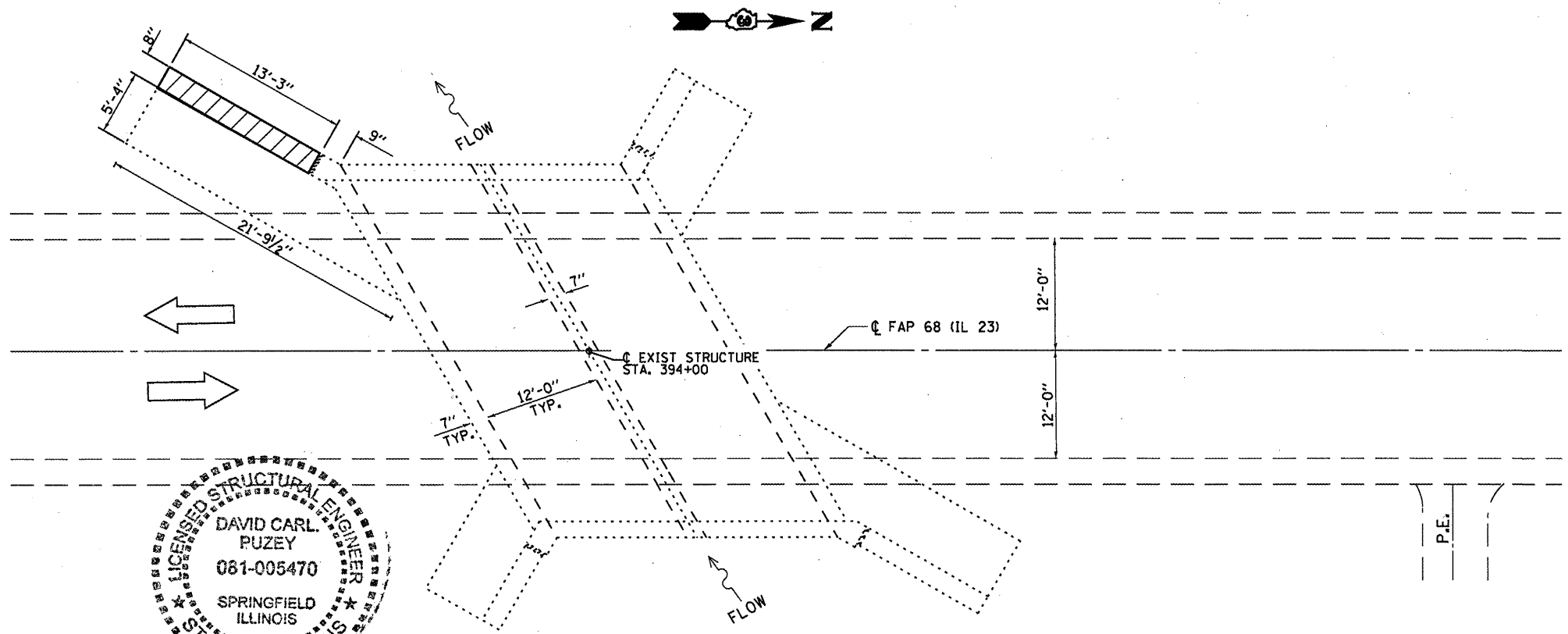

**PLAN**

**DAMAGED WING WALL TO BE REPLACED**

**TOTAL BILL OF MATERIAL**

ITEM	UNIT	TOTAL
STRUCTURE EXCAVATION	CU YD	18
EARTH EXCAVATION	CU YD	30
FURNISHED EXCAVATION	CU YD	48
CONCRETE REMOVAL	CU YD	2.1
CONCRETE BOX CULVERTS	CU YD	2.1
REINFORCEMENT BARS (EPOXY COATED)	POUND	274
SHEET WATERPROOFING MEMBRANE SYSTEM	SQ YD	5.0
RELOCATE TEMPORARY CONCRETE BARRIER	FOOT	100
RELOCATE IMP ATTN TEMP SUN TL3	EACH	2

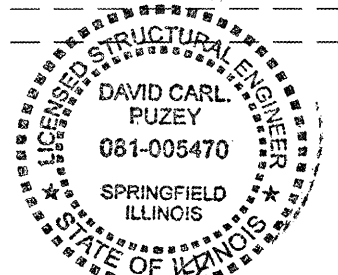

*David Carl Puzey* 1/31/12  
 Expires 11/30/12

FILE NAME =	USER NAME = petelyj	DESIGNED - YOGESH PATEL	REVISED -
ct:\pwork\pwidot\petelyj\08266589\036642-sheets.dgn		DRAWN - YOGESH PATEL	REVISED -
	PLOT SCALE = 1/8" = 1'-0"	CHECKED - RON WOODSHANK	REVISED -
	PLOT DATE = 12/27/2011	DATE -	REVISED -

STATE OF ILLINOIS  
 DEPARTMENT OF TRANSPORTATION

**GENERAL PLAN AND ELEVATION  
 FOR LOCATION 2: SN 053-2013**

F.A.P. RTE. VAR.	SECTION VARIOUS	COUNTY VARIOUS	TOTAL SHEETS 40	SHEET NO. 13
			CONTRACT NO. 66B42	
ILLINOIS FED. AID PROJECT				