

WING ELEVATION

*ORDER v₁(E) BARS IN FULL LENGTH AND CUT IN FIELD TO FIT.

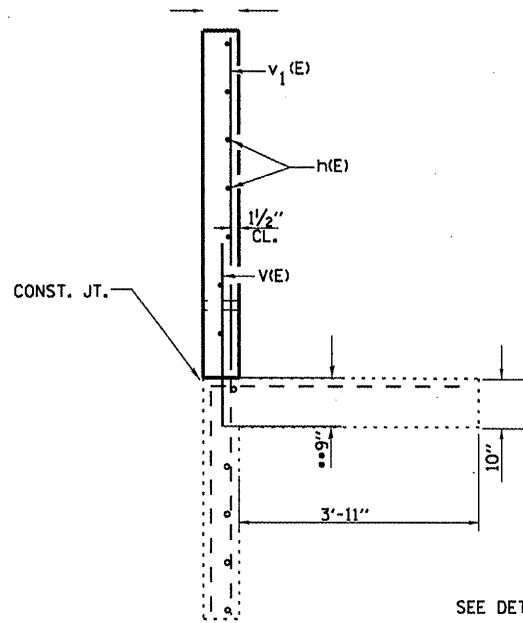

SECTION A-A

** DRILL & GROUT v₁(E) BARS INTO EXISTING CONCRETE FOOTING, ACCORDING TO SECTION 584 OF THE STANDARD SPEC.

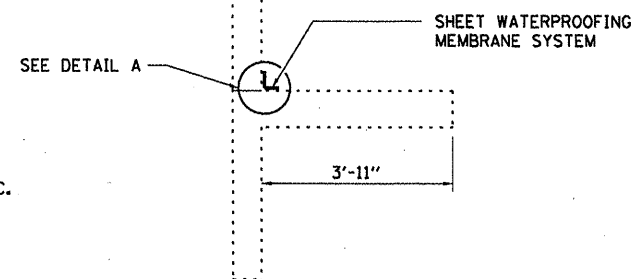

SECTION A-A

SHEET WATERPROOFING MEMBRANE SYSTEM

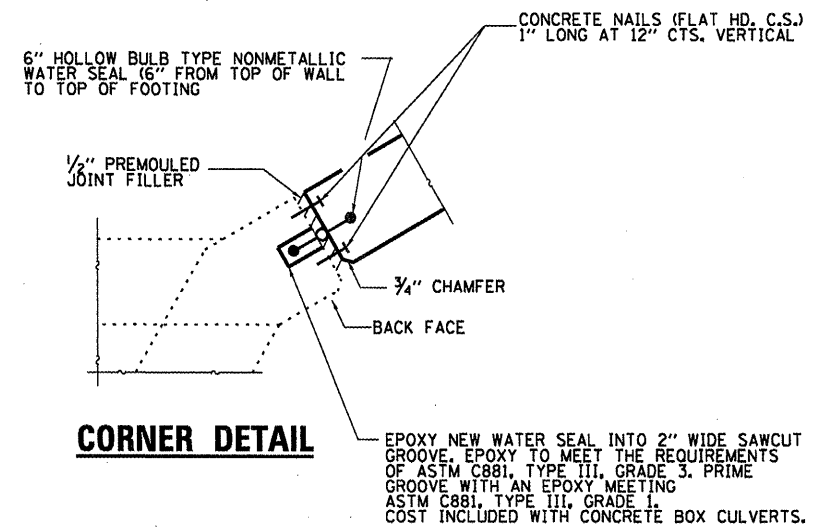

CORNER DETAIL

EPOXY NEW WATER SEAL INTO 2" WIDE SAWCUT GROOVE. EPOXY TO MEET THE REQUIREMENTS OF ASTM C881, TYPE III, GRADE 3. PRIME GROOVE WITH AN EPOXY MEETING ASTM C881, TYPE III, GRADE 1. COST INCLUDED WITH CONCRETE BOX CULVERTS.

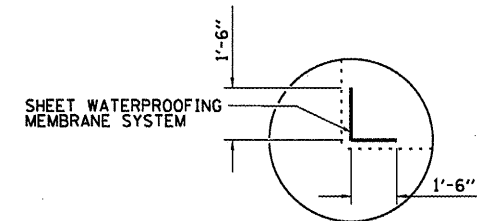

DETAIL A

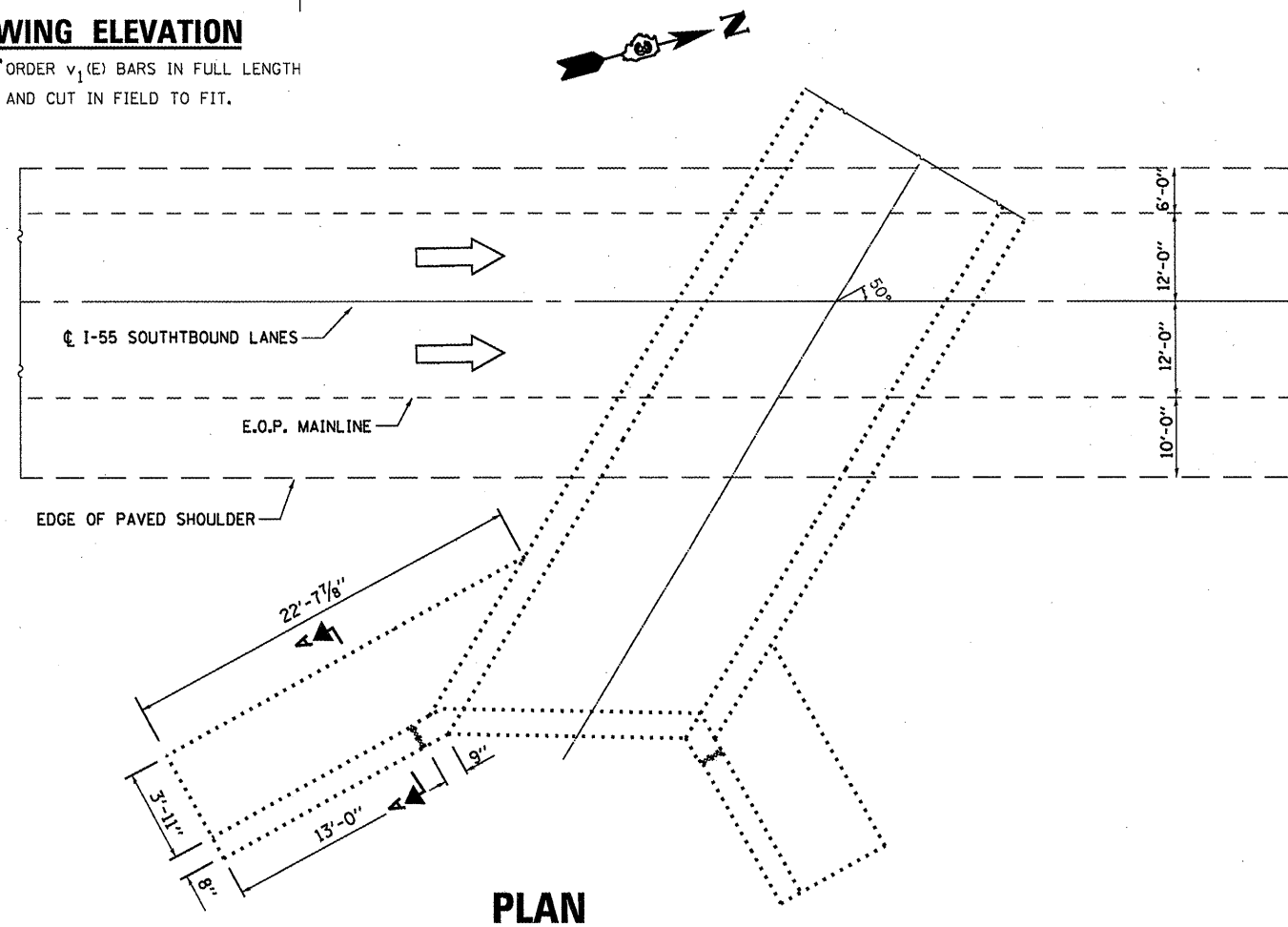

PLAN

BILL OF MATERIAL

Bar	No.	Size	Length	Shape
h(E)	4	#5	12'-9"	—
v(E)	13	#6	3'-0"	—
v ₁ (E)	13	#4	5'-0"	—
Concrete Box Culverts			Cu. Yd.	1.6
Reinforcement Bars			Pound	155.0
Sheet Waterproofing Membrane System			Sq. Yd.	5.0

FILE NAME =	USER NAME = petaluj	DESIGNED - YOGESH PATEL	REVISED -
c:\pw_work\pido\petaluj\d0266589\036842-sheets.dgn		DRAWN - YOGESH PATEL	REVISED -
PLOT SCALE = 100.0000 / in.		CHECKED - RON WOODSHANK	REVISED -
PLOT DATE = 12/27/2011		DATE -	REVISED -

STATE OF ILLINOIS
DEPARTMENT OF TRANSPORTATION

RECONSTRUCTION DETAILS
FOR LOCATION 6: SN 032-2519

F.A.P. RTE. VAR.	SECTION VARIOUS	COUNTY VARIOUS	TOTAL SHEETS 40	SHEET NO. 37
			CONTRACT NO. 66842	
ILLINOIS FED. AID PROJECT				