

F.A.P. RTE.	SECTION	COUNTY	TOTAL SHEETS	SHEET NO.
698	(6 & 50)8N,RS-1	BUREAU	6	1
		ILLINOIS	CONTRACT NO. 66B68	

STATE OF ILLINOIS
DEPARTMENT OF TRANSPORTATION
DIVISION OF HIGHWAYS
**PROPOSED
HIGHWAY PLANS**

**FAP ROUTE 698 (IL 89)(US6)
SECTION (6 & 50)8N,RS-1**

**SPOT MILLING AND RESURFACING
BUREAU COUNTY**

C-93-017-12

INDEX OF SHEETS

1. COVER SHEET
2. GENERAL NOTES, TYPICALS & SIGNATURE SHEET
3. SUMMARY OF QUANTITIES & SCHEDULES
4. MILLING & RESURFACING PLAN
5. PAVEMENT MARKING PLAN
6. CADD DETAILS

LIST OF STANDARDS

- | | |
|-----------|--|
| 000001-06 | STANDARD SYMBOLS, ABBREVIATIONS AND PATTERNS |
| 482011-03 | HMA SHOULDER STRIPS/SHOULDERS WITH RS OR WIDENING & RS PROJECTS |
| 701427 | LANE CLOSURE, MULTILANE INTERMITTENT OR MOVING OPERATION, FOR SPEEDS **d" 40 MPH |
| 701601-07 | URBAN LANE CLOSURE, MULTILANE, 1W OR 2W WITH NONTRAVERSABLE MEDIAN |
| 701701-08 | URBAN LANE CLOSURE, MULTILANE INTERSECTION |
| 701901-02 | TRAFFIC CONTROL DEVICES |
| 780001-03 | TYPICAL PAVEMENT MARKINGS |
| 781001-03 | TYPICAL APPLICATIONS RAISED REFLECTIVE PAVEMENT MARKERS |

**PROJECT LOCATION
STA. 223+50 TO STA.232+85
INTERSECTION US 6 7 IL 89**

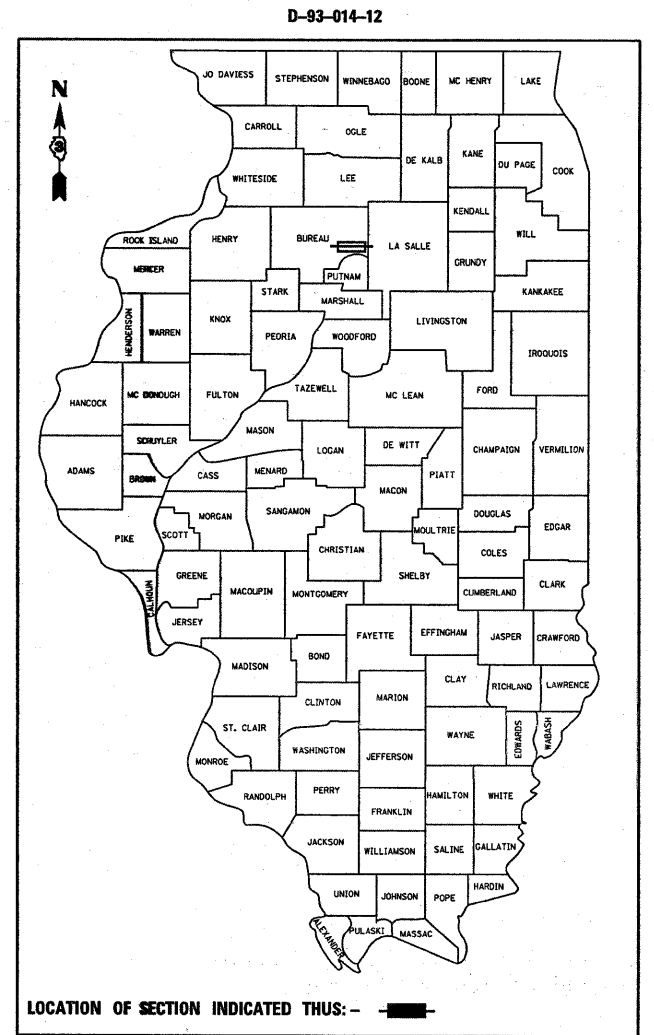

**US 6 EAST - MINOR URBAN ARTERIAL
ADT 2600 SU 50 MU 40 PV 2510**

**IL 89 NORTH - MINOR NON-URBAN ARTERIAL
ADT 6900 SU 425 MU 800 PV 5675**

**US 6/IL 89 SOUTH - OTHER PRINCIPAL ARTERIAL
ADT 6800 SU 425 MU 800 PV 5575**

STATE OF ILLINOIS
DEPARTMENT OF TRANSPORTATION
DIVISION OF HIGHWAYS

SUBMITTED December 9 20 11

E. S. Thibodeau
DEPUTY DIRECTOR OF HIGHWAYS, REGION ENGINEER

February 3 20 12
John D. Baramelli P.E.
ENGINEER OF DESIGN AND ENVIRONMENT

February 3 20 12
William R. Frey Jr.
DIRECTOR OF HIGHWAYS, CHIEF ENGINEER

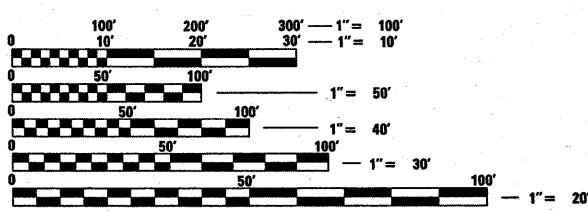

FULL SIZE PLANS HAVE BEEN PREPARED USING STANDARD ENGINEERING SCALES. REDUCED SIZED PLANS WILL NOT CONFORM TO STANDARD SCALES. IN MAKING MEASUREMENTS ON REDUCED PLANS, THE ABOVE SCALES MAY BE USED.

J.U.L.I.E.
JOINT UTILITY LOCATION INFORMATION FOR EXCAVATION
1-800-892-0123
OR 811

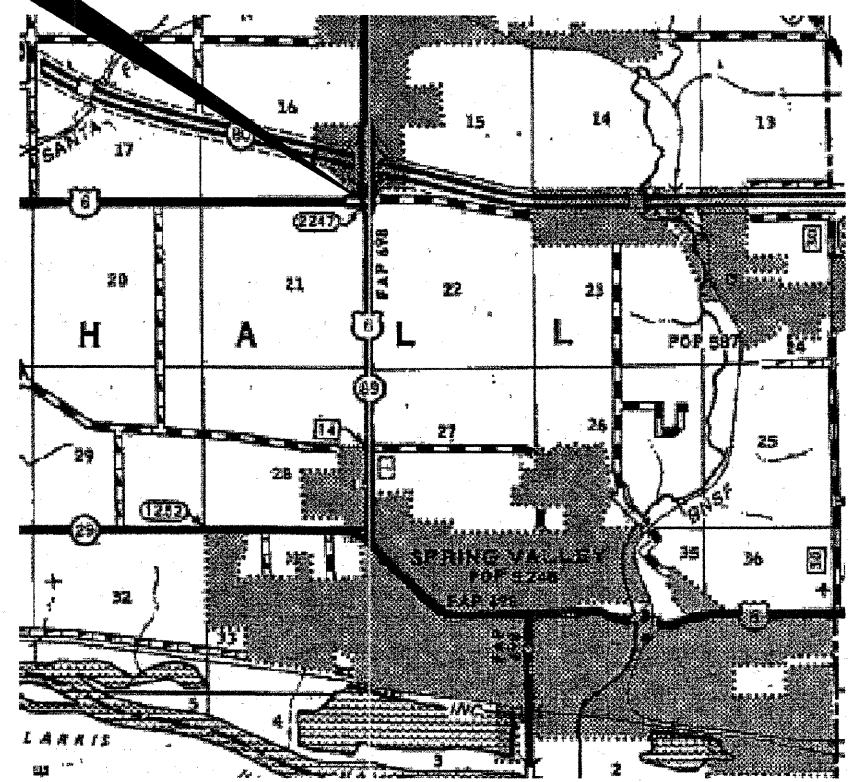

GROSS AND NET LENGTH = 935 FT. = 0.18 MILE

**PROJECT ENGINEER: JOE KANNEL
UNIT CHIEF: SCOTT A. FERGUSON**

CONTRACT NO. 66B68

**PRINTED BY THE AUTHORITY
OF THE STATE OF ILLINOIS**