

03-09-12 LETTING ITEM 035

INDEX OF SHEETS

1. COVER SHEET
2. GENERAL NOTES, TYPICALS & SIGNATURE SHEET
3. SUMMARY OF QUANTITIES & SCHEDULES
4. MILLING & RESURFACING PLAN
5. PAVEMENT MARKING PLAN
6. CADD DETAILS

LIST OF STANDARDS

- | | |
|-----------|---|
| 000001-06 | STANDARD SYMBOLS, ABBREVIATIONS AND PATTERNS |
| 482011-03 | HMA SHOULDER STRIPS/SHOULDERS WITH RS OR WIDENING & RS PROJECTS |
| 701427 | LANE CLOSURE, MULTILANE INTERMITTENT OR MOVING OPERATION, FOR SPEEDS **d** 40 MPH |
| 701601-07 | URBAN LANE CLOSURE, MULTILANE, 1W OR 2W WITH NONTRAVERSABLE MEDIAN |
| 701701-08 | URBAN LANE CLOSURE, MULTILANE INTERSECTION |
| 701901-02 | TRAFFIC CONTROL DEVICES |
| 780001-03 | TYPICAL PAVEMENT MARKINGS |
| 781001-03 | TYPICAL APPLICATIONS RAISED REFLECTIVE PAVEMENT MARKERS |

STATE OF ILLINOIS

DEPARTMENT OF TRANSPORTATION

DIVISION OF HIGHWAYS

PROPOSED
HIGHWAY PLANS

FAP ROUTE 698 (IL 89)(US6)
SECTION (6 & 50)8N,RS-1

SPOT MILLING AND RESURFACING
BUREAU COUNTY

C-93-017-12

PROJECT LOCATION
STA. 223+50 TO STA.232+85
INTERSECTION US 6 7 IL 89

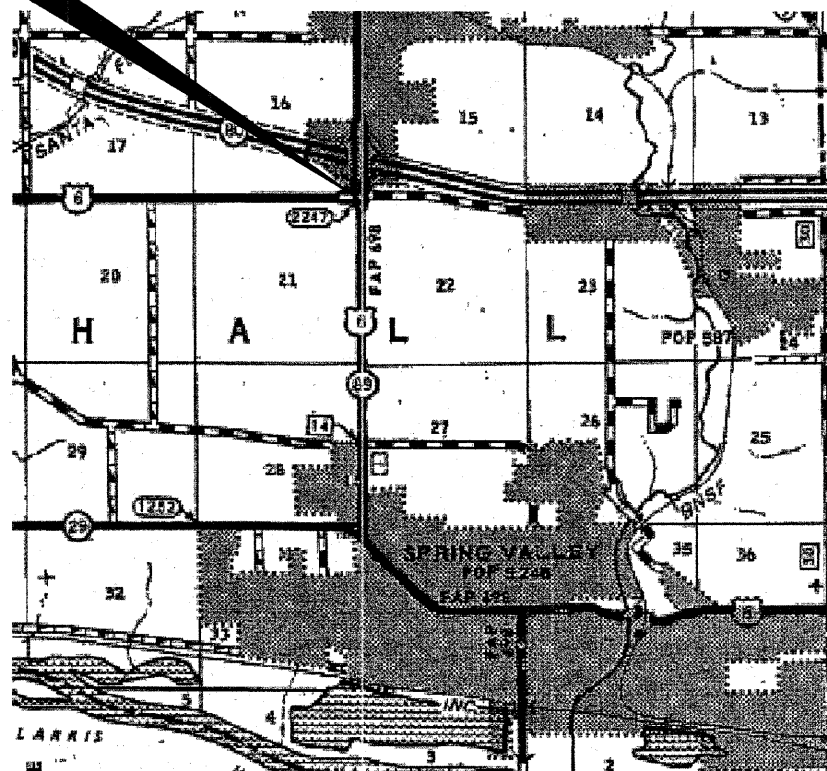

GROSS AND NET LENGTH = 935 FT. = 0.18 MILE

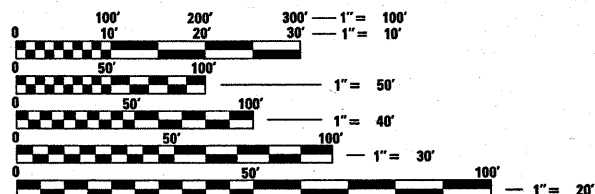

FULL SIZE PLANS HAVE BEEN PREPARED USING STANDARD ENGINEERING SCALES. REDUCED SIZED PLANS WILL NOT CONFORM TO STANDARD SCALES. IN MAKING MEASUREMENTS ON REDUCED PLANS, THE ABOVE SCALES MAY BE USED.

J.U.L.I.E.
JOINT UTILITY LOCATION INFORMATION FOR EXCAVATION
1-800-892-0123
OR 811

PROJECT ENGINEER: JOE KANNEL
UNIT CHIEF: SCOTT A. FERGUSON

CONTRACT NO. 66B68

F.A.P. RTE.	SECTION	COUNTY	TOTAL SHEETS	SHEET NO.
698	(6 & 50)8N,RS-1	BUREAU	6	1
		ILLINOIS	CONTRACT NO. 66B68	

D-93-014-12

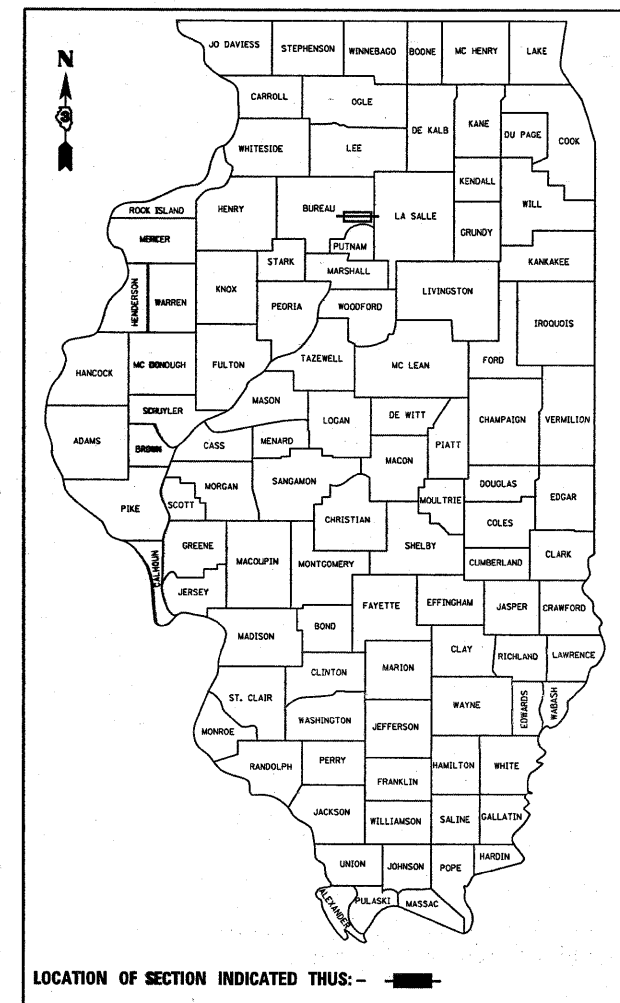

US 6 EAST - MINOR URBAN ARTERIAL
ADT 2600 SU 50 MU 40 PV 2510

IL 89 NORTH - MINOR NON-URBAN ARTERIAL
ADT 6900 SU 425 MU 800 PV 5675

US 6/IL 89 SOUTH - OTHER PRINCIPAL ARTERIAL
ADT 6800 SU 425 MU 800 PV 5575

STATE OF ILLINOIS
DEPARTMENT OF TRANSPORTATION
DIVISION OF HIGHWAYS

SUBMITTED December 9 20 11
E. S. Thibodeau
DEPUTY DIRECTOR OF HIGHWAYS, REGION ENGINEER

February 3 20 12
John D. Baramelli P.E.
ENGINEER OF DESIGN AND ENVIRONMENT

February 3 20 12
William R. Frey Jr.
DIRECTOR OF HIGHWAYS, CHIEF ENGINEER

PRINTED BY THE AUTHORITY
OF THE STATE OF ILLINOIS

GENERAL NOTES

THE THICKNESS OF HMA SHOWN ON THE PLANS IS THE NOMINAL THICKNESS. DEVIATIONS FROM THE NOMINAL THICKNESS WILL BE PERMITTED WHEN SUCH DEVIATIONS OCCUR DUE TO IRREGULARITIES IN THE EXISTING SURFACE OR BASE ON WHICH THE HMA IS PLACED.

EXCEPT AS NOTED ON THE PLANS, PAVEMENT GRADES SHOWN ARE AT THE TOP OF PAVEMENT SURFACES.

THE ENGINEER WILL BE THE SOLE JUDGE CONCERNING CURING TIME FOR THE VARIOUS HMA LIFTS.

ON EXISTING PAVEMENT WHICH MAY BE SUPERELEVATED, THE NEW HMA PAVEMENT SHALL BE BUILT WITH THE SAME SUPERELEVATION UNLESS NEW SUPERELEVATION RATES ARE GIVEN ON THE PLANS.

ALL ELEVATIONS REFERRING TO U.S.G.S. MEAN SEA LEVEL DATUM.

ANY REFERENCE TO A STANDARD IN THESE PLANS SHALL BE INTERPRETED TO MEAN THE EDITION AS INDICATED BY THE SUBNUMBER SHOWN IN THE LIST OF STANDARDS OR THE COPY INCLUDED IN THESE PLANS.

THE FOLLOWING RATES OF APPLICATION HAVE BEEN USED IN CALCULATING PLAN QUANTITIES:

GRANULAR MATERIALS	2.05	TONS / CU YD
AGGREGATE (PRIME COAT)	0.002	TONS / SQ YD
HMA RESURFACING	112	LBS / SQ YD / IN
SHORT TERM PAVEMENT MARKING	10	FT / 100 FT OF APPLICATION
MIX FOR CRACKS, JTS & FLGWYS	0.0003	TONS / SQ YD
LEVEL BINDER (HAND METHOD)	0.0005	TONS / SQ YD

BITUMINOUS MATERIALS (PRIME COAT) RATES		
SURFACE TYPE	ESTIMATED TRUCK APPLICATION RATE	RESIDUAL RATE
AGGREGATE BASES	0.375 GAL / SQ YD	N/A
MILLED HMA OR PCC PAVEMENT	0.08 GAL / SQ YD	0.04 GAL / SQ YD
EXISTING PAVEMENT	0.05 GAL / SQ YD	0.025 GAL / SQ YD
FOG COAT (BETWEEN ADDITIONAL HMA LIFTS)	0.05 GAL / SQ YD	0.025 GAL / SQ YD

THE CONTRACTOR SHALL CONTACT JULIE AT LEAST 48 HOURS PRIOR TO EXCAVATION TO DETERMINE WHICH UTILITIES ARE IN THE AREA.

HOT-MIX ASPHALT SURF. REMOVAL - 3 3/4"
 POLYMERIZED HMA BINDER IL.19.0 N90 - 2"
 POLYMERIZED HMA SURF. CSE. MIX "D", N90 - 1 3/4"

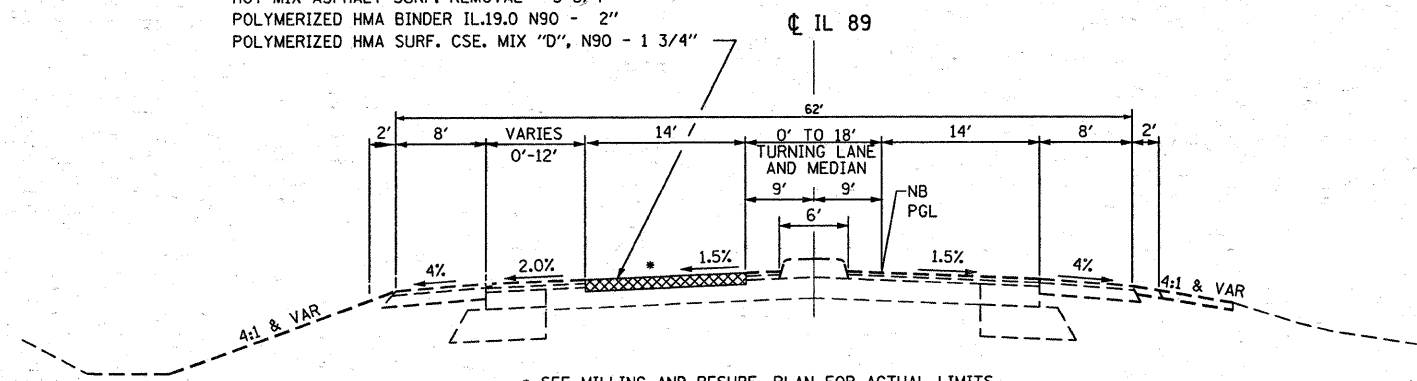

• SEE MILLING AND RESURF. PLAN FOR ACTUAL LIMITS

PROPOSED TYPICAL SECTION
 STA 228+59.0 TO STA 238+39.5

	HMA SURFACE	HMA LEVELING BINDER
PG GRADE	SBS PG 70-22	SBS PG 70-22
DESIGN AIR VOIDS	4% @ N90	4% @ N90
MIXTURE COMPOSITION	IL 9.5	IL 19.0
FRICTION AGGREGATE	MIXTURE D	-
DENSITY TEST METHOD	CORES	CORES

STATE OF ILLINOIS
 DEPARTMENT OF TRANSPORTATION
 DISTRICT THREE

PREPARED BY: Don Beaulieu
 DISTRICT STUDIES & PLANS ENGINEER

DATE: 12-16-11

EXAMINED BY: [Signature]
 DISTRICT CONSTRUCTION ENGINEER

[Signature]
 DISTRICT MATERIALS ENGINEER

[Signature]
 DISTRICT OPERATIONS ENGINEER

FILE NAME =	USER NAME = fergusonsa	DESIGNED -	REVISED -	STATE OF ILLINOIS DEPARTMENT OF TRANSPORTATION	GENERAL NOTES, TYPICALS AND SIGNATURE BLOCK	F.A. RTE.	SECTION	COUNTY	TOTAL SHEETS	SHEET NO.	
ca:\pwork\pwork\pwork\ferguson\02276870\066868-shr-cover.dgn		DRAWN -	REVISED -			698	(6 & 50)8N,RS-1	BUREAU	6	2	
PLOT SCALE = 50.0000' / in.		CHECKED -	REVISED -			CONTRACT NO. 66B68					
PLOT DATE = 12/15/2011		DATE -	REVISED -			ILLINOIS FED. AID PROJECT					
					SCALE:	SHEET NO.	OF	SHEETS	STA.	TO STA.	

SUMMARY OF QUANTITIES			
CONSTRUCTION CODE		100% STATE 0005	
CODE NO.	ITEM	UNIT	TOTAL QUANTITY
40300100	BITUMINOUS MATERIALS (PRIME COAT)	GALLON	339.4
40600300	AGGREGATE (PRIME COAT)	TON	5.2
40600400	MIXTURE FOR CRACKS, JOINTS, AND FLANGEWAYS	TON	0.8
40600990	TEMPORARY RAMP	SQ YD	52
40603545	POLYMERIZED HOT-MIX ASPHALT SURFACE COURSE, MIX "D", N90	TON	219.2
40603240	POLYMERIZED HOT-MIX ASPHALT BINDER COURSE, IL 19.0 N90	TON	328.9
44000164	HOT-MIX ASPHALT SURFACE REMOVAL, 3 3/4"	SQ YD	2610.5
67100100	MOBILIZATION	LSUM	1
70102630	TRAFFIC CONTROL AND PROTECTION, STANDARD 701601	L SUM	1
70102635	TRAFFIC CONTROL AND PROTECTION, STANDARD 701701	L SUM	1
70300100	SHORT-TERM PAVEMENT MARKING	FOOT	2256
78000100	THERMOPLASTIC PAVEMENT MARKING - LETTERS AND SYMBOLS	SQ FT	140
78000200	THERMOPLASTIC PAVEMENT MARKING - LINE 4"	FOOT	3221
78000500	THERMOPLASTIC PAVEMENT MARKING - LINE 8"	FOOT	692
78000600	THERMOPLASTIC PAVEMENT MARKING - LINE 12"	FOOT	391
78000650	THERMOPLASTIC PAVEMENT MARKING - LINE 24"	FOOT	106
78100100	RAISED REFLECTIVE PAVEMENT MARKER	EACH	15
78300200	RAISED REFLECTIVE PAVEMENT MARKER REMOVAL	EACH	15

• SPECIALITY ITEMS

MAINLINE SCHEDULE										
LOCATION	DESCRIPTION	LENGTH	AREA	HMA SURF REM 3 3/4"	TEMP RAMP	BIT MATL (PR CT)	AGG (PR CT)	MIXTURES FOR CRACKS JOINTS AND FLANGEWAYS	POLY. LEVEL BINDER 2 1/4" (MM) N90	POLY. HMA SURF 1 1/2" CSE N90
STA.		FOOT	SQ YD	SQ YD	SQ YD	GALLON	TON	TON	TON	TON
BUREAU COUNTY- URBAN IL 89										
STA. 223+50 - STA. 230+87	LT START PROJECT	737	1187.4	1187.4	8.3	154.4	2.4	0.4	149.6	99.7
STA. 230+87 - STA. 232+85	LT	198	312	312.0	14.4	40.6	0.6	0.1	39.3	26.2
BUREAU COUNTY - URBAN US 6										
STA. 1806+35 - STA. 1807+63.8	LT END PROJECT	125	1111.1	1111.1	28.9	144.4	2.2	0.3	140.0	93.3
STA. 1807+63.8 - STA. 1810+21		261								
BUREAU COUNTY SUBTOTALS				2610.5	52.0	339.4	5.2	0.8	328.9	219.2
TOTALS				2610.5	52.0	339.4	5.2	0.8	328.9	219.2

PAVEMENT MARKING SCHEDULE										
LOCATION	SHORT-TERM PAVEMENT MARKING	THERMOPLASTIC PAVEMENT MARKING LETTERS & SYMBOLS	THERMOPLASTIC PAVEMENT MARKING LINE 4"	THERMOPLASTIC PAVEMENT MARKING LINE 8"	THERMOPLASTIC PAVEMENT MARKING LINE 12"	THERMOPLASTIC PAVEMENT MARKING LINE 24"	RAISED REFLECTIVE PAVEMENT MARKER	RAISED REFLECTIVE PAVEMENT MARKER REMOVAL		
STA. TO STA.	FOOT WHITE	SQ FT WHITE	FOOT YELLOW	FOOT WHITE	FOOT WHITE	FOOT WHITE	EACH CRYSTAL	EACH		
BUREAU COUNTY- IL 89										
STA. 223+50 TO STA. 230+87	1383	78	1267	650.98	396.3		11	11		
STA. 230+87 TO STA. 232+85	698.7	46.8	351	392.4	295.3		4	4		
BUREAU COUNTY- US 6										
STA. 1806+35 TO STA. 1807+63.8	174.33	15.6	203.7	355.6	391		56.1			
STA. 1807+63.8 TO STA. 1810+21	83.85		318	369.6	195		52.7			
TOTAL	2256	140	1822	1399	692	391	106	15		

FILE NAME =	USER NAME = Ferguson	DESIGNED -	REVISED -	STATE OF ILLINOIS DEPARTMENT OF TRANSPORTATION	SUMMARY OF QUANTITIES				F.A. RTE.	SECTION	COUNTY	TOTAL SHEETS	SHEET NO.
ci:\pwork\pwork\ferguson\02276878\066668-sht-cover.dgn		DRAWN -	REVISED -		SCALE:	SHEET	OF	SHEETS	STA.	TO STA.	BUREAU	6	3
		CHECKED -	REVISED -								CONTRACT NO. 66B68		
		DATE -	REVISED -								ILLINOIS FED. AID PROJECT		

MATCH LINE 228+25

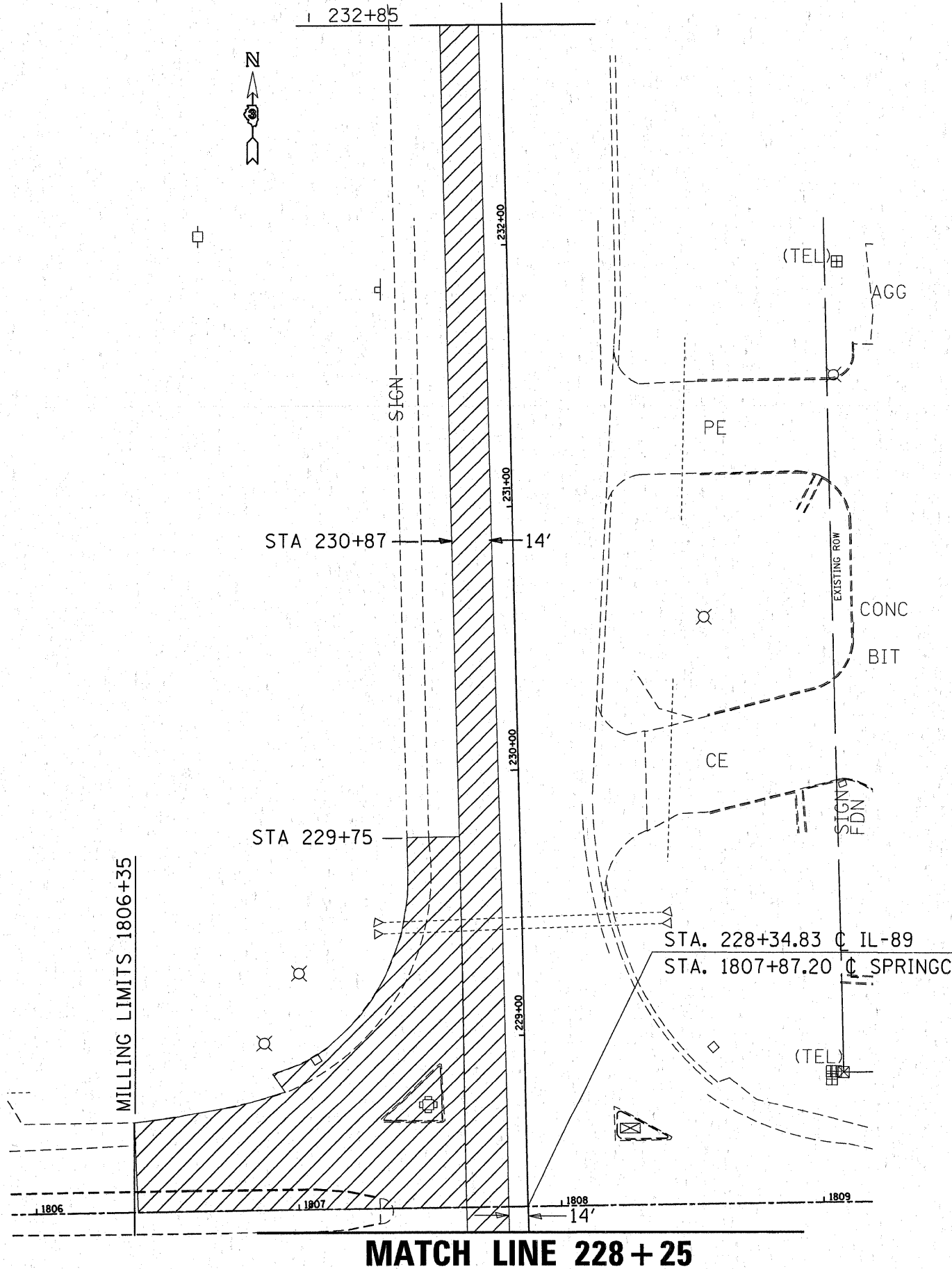

 **MILLING AND RESURFACING LIMITS**

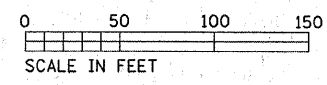

BEGIN PROJECT 223+50

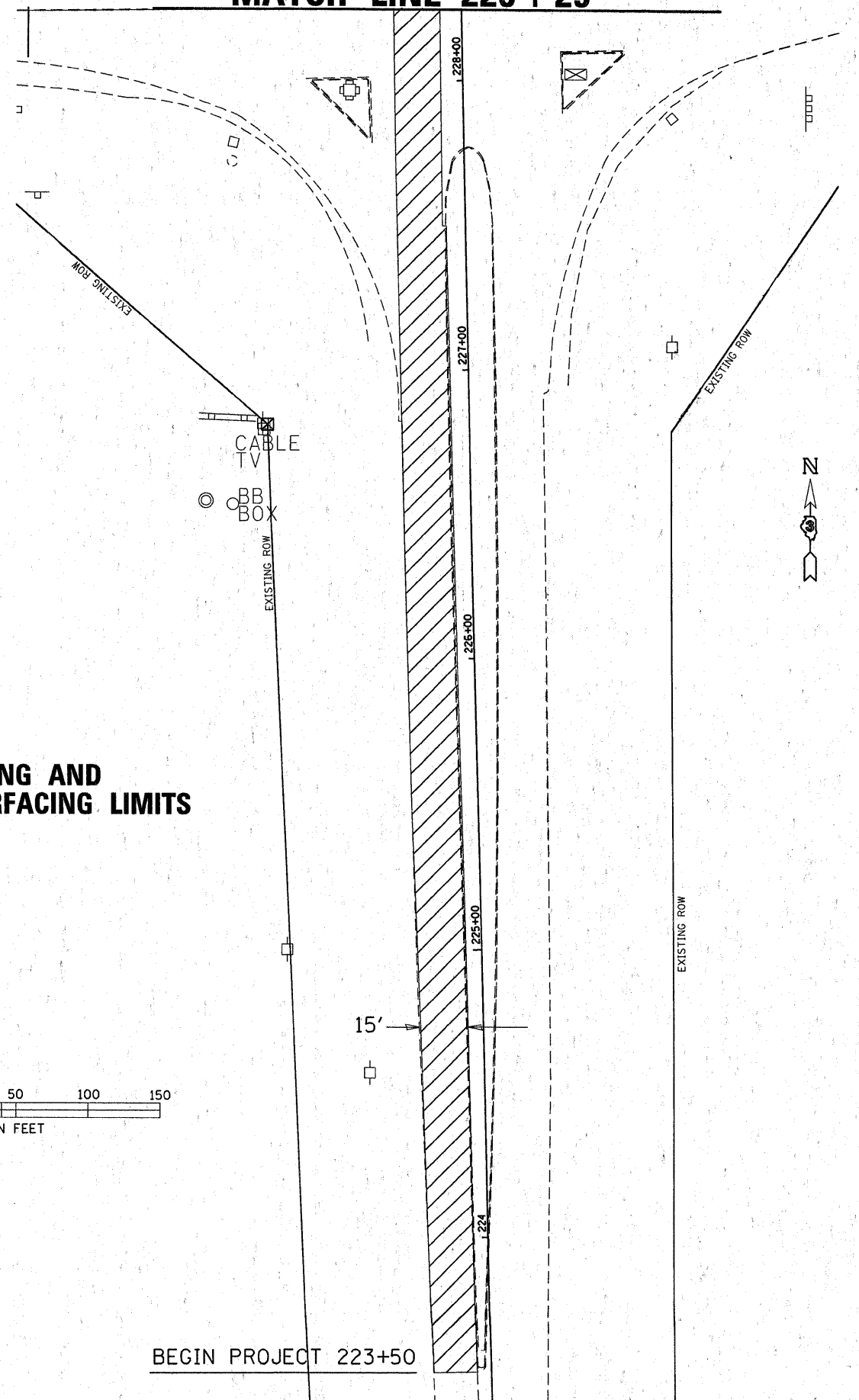

MATCH LINE 228+25

FILE NAME = c:\pwork\pwork\ferguson\827687\666868-ah-00ver.dgn	USER NAME = ferguson	DESIGNED -	REVISED -	STATE OF ILLINOIS DEPARTMENT OF TRANSPORTATION	MILLING AND RESURFACING PLAN			F.A. RTE. 698	SECTION (6 & 5018N,RS-1)	COUNTY BUREAU	TOTAL SHEETS 6	SHEET NO. 4	
	PLOT SCALE = 50.0000' / 1"	CHECKED -	REVISED -		SCALE: SHEET OF SHEETS STA. TO STA.			CONTRACT NO. 66688					
	PLOT DATE = 12/15/2011	DATE -	REVISED -										
	ILLINOIS FED. AID PROJECT												

END PROJECT 232+85
PAVEMENT MARKING LIMITS

4" PVMT MK. - YELLOW

8" PVMT MK.
DOTTED WHITE

4" PVMT MK. - WHITE

8" PVMT MK. - WHITE

MILLING LIMITS 1806+35
PAVEMENT MARKING LIMITS

4" PVMT MK.
YELLOW

PAVEMENT MARKING LIMITS

STA. 228+34.83 C IL-89
STA. 1807+87.20 C SPRINGCREEK DR.

4" PVMT MK. - YELLOW

BEGIN PROJECT 223+50
PAVEMENT MARKING LIMITS

24" STOP BAR - WHITE (TYP.)

8" PVMT MK. - WHITE (TYP.)

12" PVMT MK. - WHITE (TYP.)

4" PVMT MK. - YELLOW

4" PVMT MK. - WHITE

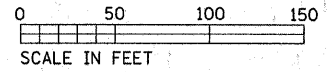

FILE NAME =	USER NAME = Fergusonsa	DESIGNED -	REVISED -	STATE OF ILLINOIS DEPARTMENT OF TRANSPORTATION	PAVEMENT MARKING DETAIL			F.A. RTE.	SECTION	COUNTY	TOTAL SHEETS	SHEET NO.
ca\pwork\pwork\ Fergusonsa\227687\066668-shr-cover.dgn	PLOT SCALE = 50.0000' / 1"	DRAWN -	REVISED -					698	(6 & 50)8N,RS-1	BUREAU	6	5
	PLOT DATE = 12/15/2011	CHECKED -	REVISED -		CONTRACT NO. 66B68			[ILLINOIS] FED. AID PROJECT				
		DATE -	REVISED -		SCALE:	SHEET	OF	SHEETS	STA.	TO	STA.	

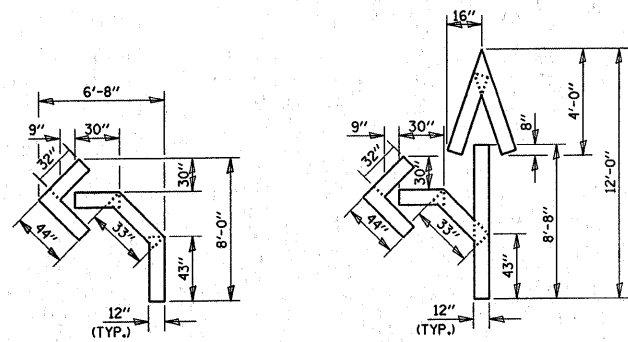

QUANTITY
12" LINE = 16 LIN. FT.
OR 4" LINE = 48 LIN. FT.

QUANTITY
12" LINE = 29 LIN. FT.
OR 4" LINE = 87 LIN. FT.

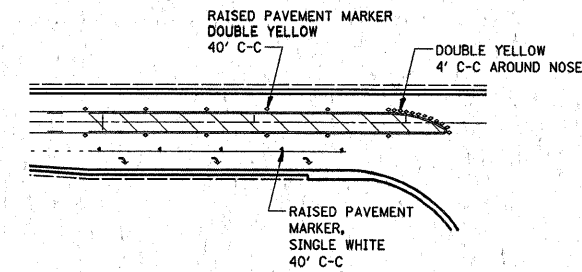
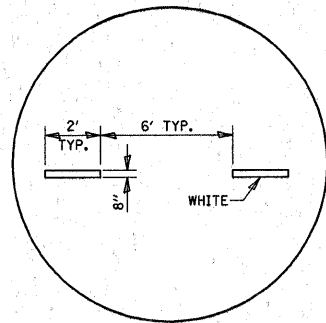
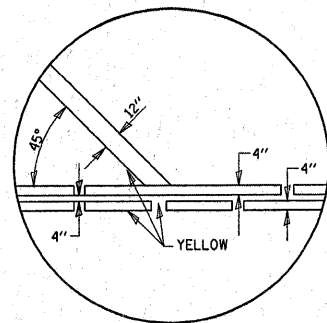

**RAISED REFLECTIVE PAVEMENT MARKERS
RIGHT TURN LANE**

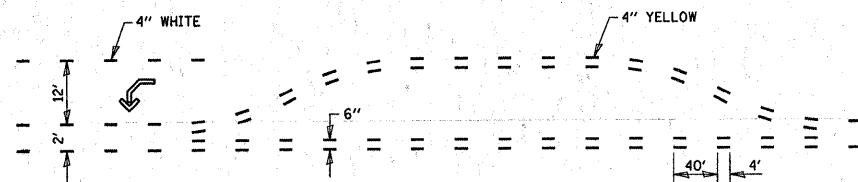

**SHORT-TERM PAVEMENT MARKING
FOR MEDIANS AND ARROWS**

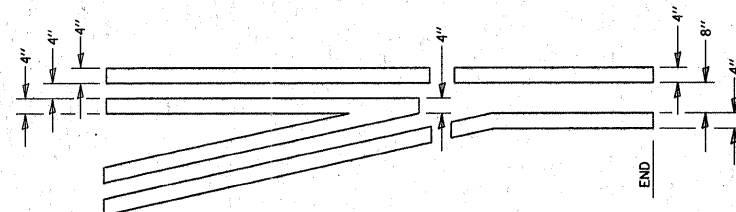

**TYPICAL APPLICATION
LEFT TURN LANES**

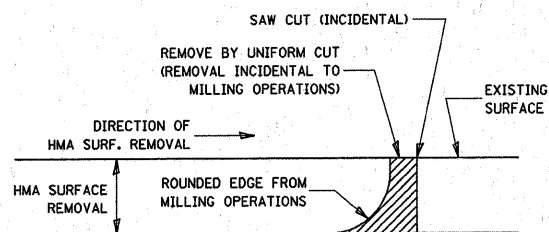

NOTE:
WHEN MILLING OPERATIONS PRODUCE A ROUNDED EDGE,
THEN A SAW CUT SHALL BE USED TO MANUFACTURE
A PERPENDICULAR EDGE AS SHOWN IN THE DETAIL.
THE ENGINEER SHALL BE THE SOLE JUDGE
CONCERNING THE USE OF THIS DETAIL

HMA DETAIL AT BUTT JOINTS

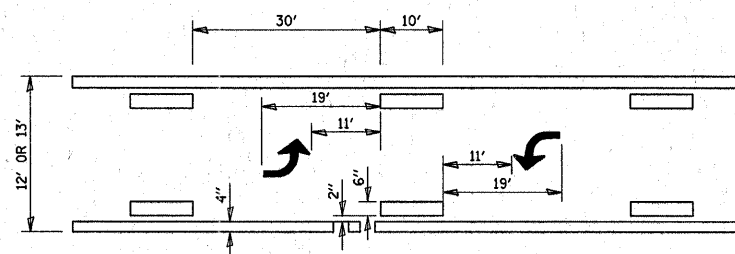

**TYPICAL APPLICATION
BI-DIRECTIONAL TURN LANE**

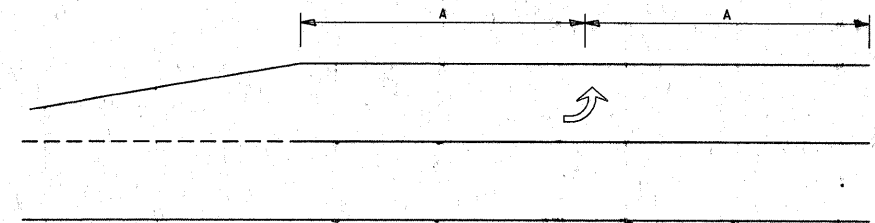

9' AND UNDER

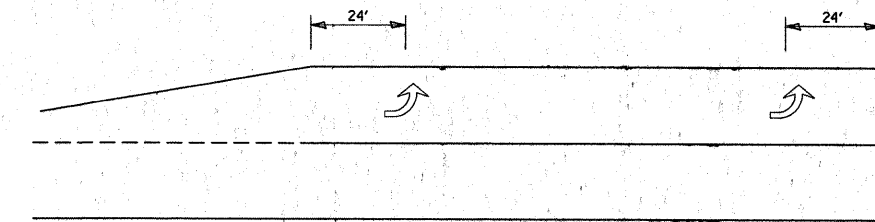

100' TO 149'

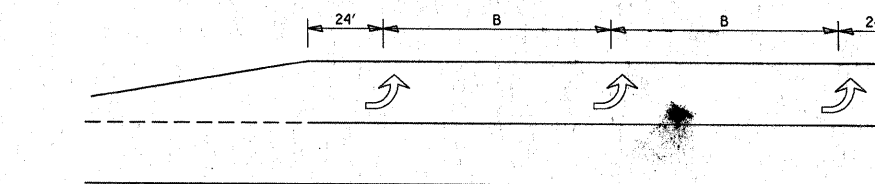

150' AND LONGER

**TYPICAL PLACEMENT OF ARROWS
IN TURN LANES**

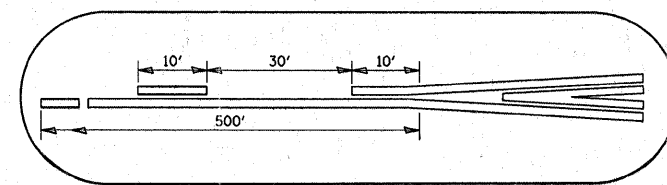

FILE NAME =	USER NAME = ferguson	DESIGNED -	REVISED -	STATE OF ILLINOIS DEPARTMENT OF TRANSPORTATION	CADD DETAILS	F.A. RTE.	SECTION	COUNTY	TOTAL SHEETS	SHEET NO.
ct:\pw_wark\p\ridot\ferguson\d0276870\066868-shr-cover.dgn	PLOT SCALE = 50.0000' / in.	DRAWN -	REVISED -			698	(6 & 50)BN_RS-1	BUREAU	6	6
PLOT DATE = 12/15/2011	DATE -	CHECKED -	REVISED -			CONTRACT NO. 66B68				
SCALE: SHEET OF SHEETS STA. TO STA.						ILLINOIS FED. AID PROJECT				