

PI STA. = 228+40.88	EXIST. CURVE IL8EXCL4
Δ = 15° 18' 11" (LT)	PI STA. = 228+28.90
D = 1° 09' 51"	Δ = 13° 52' 36" (LT)
R = 4,921.25'	D = 1° 31' 31"
T = 661.14'	R = 3,756.69'
L = 1,314.41'	T = 457.16'
E = 44.21'	L = 909.85'
P.C. STA = 221+79.74	E = 27.71'
P.T. STA = 234+94.15	P.C. STA. = 223+71.74
	P.T. STA. = 232+81.59

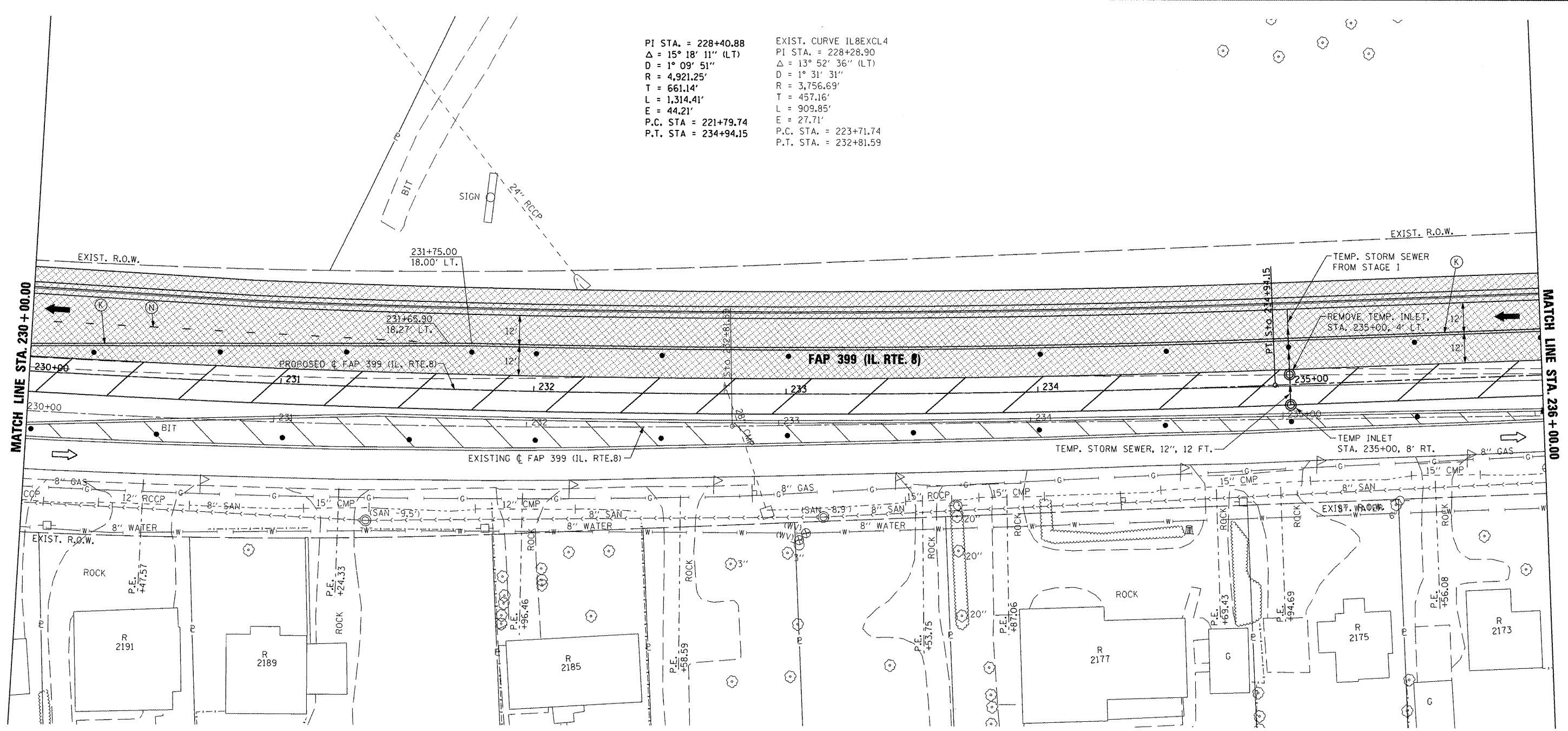

NOTE: TEMPORARY CONCRETE BARRIER LOCATIONS ARE SHOWN AT C OF WALL.

TEMPORARY PAVEMENT MARKING LEGEND

(A) TEMP. PAVE. MARK. - 4" WHITE SOLID	(I) PAVE. MARK. TAPE - 4" WHITE SOLID		CONSTRUCTION THIS STAGE
(B) TEMP. PAVE. MARK. - 4" YELLOW SOLID	(J) PAVE. MARK. TAPE - 4" YELLOW SOLID		PREVIOUSLY CONSTRUCTED
(C) TEMP. PAVE. MARK. - DOUBLE 4" YELLOW SOLID	(K) PAVE. MARK. TAPE - DOUBLE 4" YELLOW SOLID		TEMPORARY PAVEMENT
(D) TEMP. PAVE. MARK. - 4" YELLOW SKIP DASH	(L) PAVE. MARK. TAPE - 4" YELLOW SKIP DASH		EXISTING TRAFFIC LANE
(E) TEMP. PAVE. MARK. - 8" WHITE SOLID	(M) PAVE. MARK. TAPE - 8" WHITE SOLID		TRAFFIC LANE
(F) TEMP. PAVE. MARK. - 8" WHITE SKIP DASH	(N) PAVE. MARK. TAPE - 8" WHITE SKIP DASH		TYPE II BARRICADES OR DRUMS @ 50' CTRS. UNLESS OTHERWISE NOTED
(G) TEMP. PAVE. MARK. - 24" WHITE SOLID (STOP BAR)	(O) PAVE. MARK. TAPE - 12" YELLOW SOLID (DIAGONAL)		TYPE III BARRICADE WITH R 11-2 SIGN
(H) TEMP. PAVE. MARK. - LETTERS AND SYMBOLS	(P) PAVE. MARK. TAPE - 12" WHITE SOLID (DIAGONAL)		TEMPORARY CONCRETE BARRIER
TEMP. PAVE. MARK. = PAINT	(Q) PAVE. MARK. TAPE - 24" WHITE SOLID (STOP BAR)		TEMPORARY IMPACT ATTENUATOR
	(R) PAVE. MARK. TAPE - LETTERS AND SYMBOLS		

PAVE. MARK. TAPE = PAVEMENT MARKING TAPE, TYPE III

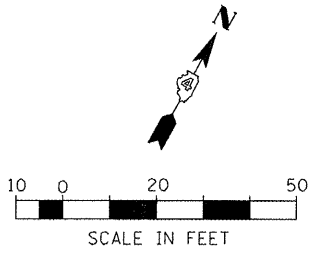

FILE NAME = x:\projects\20080356\idgn\04-Rte8-sht-5	USER NAME = 1007 aging-2-G.dgn	DESIGNED -	REVISED -
PLOT SCALE = 41.249 FT / IN.	CHECKED -	DATE - 10-21-11	REVISED -
PLOT DATE = 10/21/2011	DATE - 10-21-11		

STATE OF ILLINOIS		FAP 399 (IL RTE. 8)		SECTION		COUNTY		TOTAL SHEETS		SHEET NO.	
DEPARTMENT OF TRANSPORTATION		MAINTENANCE OF TRAFFIC - STAGE II		399		36 R-7		TAZEWELL		390 129	
SCALE: AS SHOWN	SHEET NO.	OF	SHEETS	STA. 230+00.00	TO	STA. 236+00.00	CONTRACT NO. 68370		ILLINOIS FED. AID PROJECT		