

|  |  |  |
|--|--|--|
| <b>STRUCTURE #133</b><br>STA. 266+10.00, 30.0' LT<br>INLET, TYPE G-1<br>RIM ELEV. = 801.99<br>INV ELEV. = 798.20 (12" W)<br>INV ELEV. = 798.00 (12" E) | <b>STRUCTURE #134</b><br>STA. 267+20.00, 30.8' LT<br>INLET, TYPE G-1<br>RIM ELEV. = 801.73<br>INV ELEV. = 797.45 (12" W)<br>INV ELEV. = 797.25 (15" E) | <b>STRUCTURE #135</b><br>STA. 268+30.00, 32.2' LT<br>INLET, TYPE G-1<br>RIM ELEV. = 801.47<br>INV ELEV. = 796.70 (15" W)<br>INV ELEV. = 796.50 (15" E) |
|--|--|--|

|   |
|---|
| <b>STRUCTURE #136</b><br>STA. 269+27.00, 33.4' LT<br>INLET-MANHOLE, TYPE G-1, 5' DIA.<br>RIM ELEV. = 801.19<br>INV ELEV. = 797.08 (12" E)<br>INV ELEV. = 796.01 (15" W)<br>INV ELEV. = 792.71 (EXIST 24" S)<br>INV ELEV. = 792.71 (30" N) |
|---|

|   |
|---|
| <b>STRUCTURE #137</b><br>STA. 270+10.00, 34.4 LT<br>INLET, TYPE G-1<br>RIM ELEV. = 800.99<br>INV ELEV. = 797.49 (12" W) |
|---|

|  |
|--|
| <b>STRUCTURE #148</b><br>STA. 269+27.00, 80.0 LT<br>PRECAST REINFORCED<br>CONCRETE END SECTION 30"<br>INV ELEV. = 791.45 (30" S) |
|--|

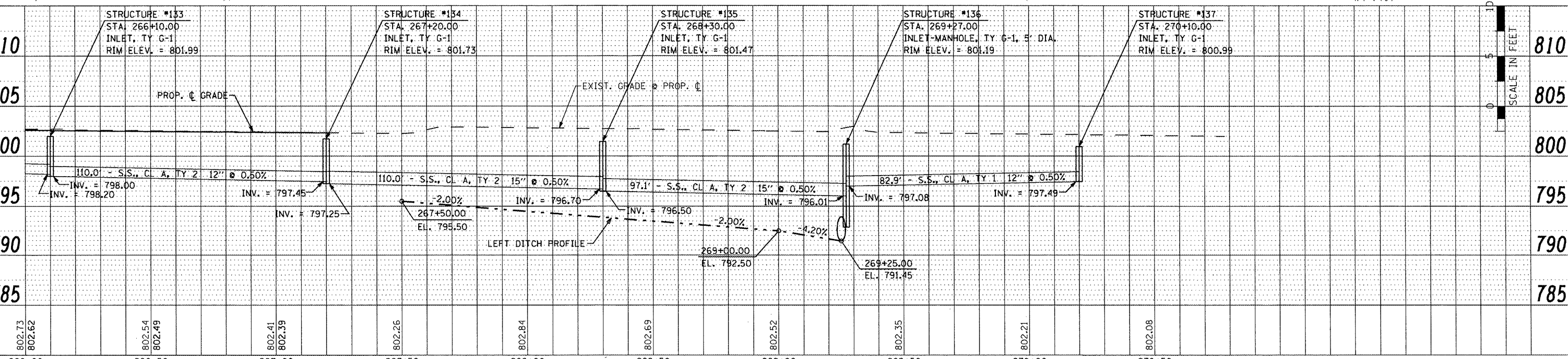
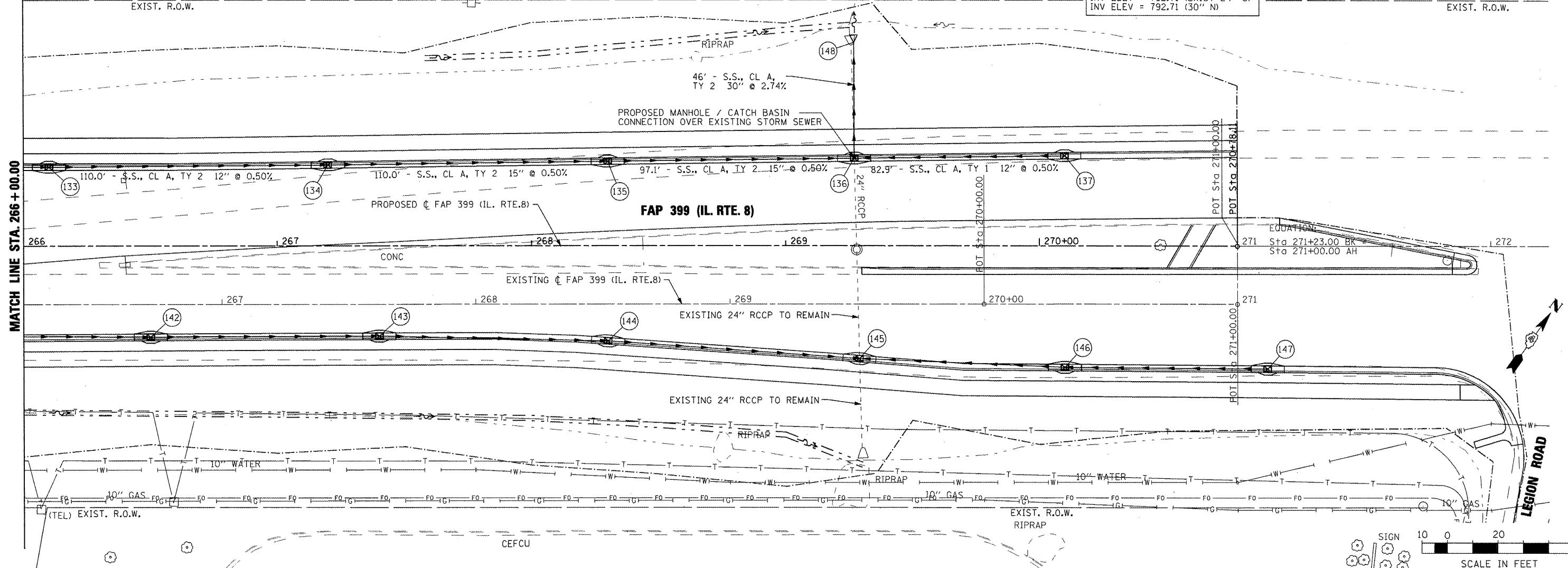

|                    |      |
|--------------------|------|
| PLAN               | DATE |
| SURVEYED           | BY   |
| PLOTTED            | BY   |
| CHECKED            | BY   |
| RT. OF WAY CHECKED | BY   |
| CADD FILE NAME     |      |
| NO.                |      |

|                             |      |
|-----------------------------|------|
| PROFILE                     | DATE |
| SURVEYED                    | BY   |
| GRADES CHECKED              | BY   |
| STRUCTURE NOTATIONS CHECKED | BY   |
| NO.                         |      |

**STATE OF ILLINOIS  
DEPARTMENT OF TRANSPORTATION**

**FAP 399 (IL. RTE. 8)  
DRAINAGE PLAN AND PROFILE - NORTH**

|                             |                  |            |           |                 |                     |                                  |               |                    |                 |                           |               |
|-----------------------------|------------------|------------|-----------|-----------------|---------------------|----------------------------------|---------------|--------------------|-----------------|---------------------------|---------------|
| FILE NAME =                 | USER NAME = IDDT | DESIGNED - | REVISED - | SCALE: AS SHOWN | SHEET NO. OF SHEETS | STA. 266+00.00 TO STA. 270+78.11 | F.A. RTE. 399 | SECTION 36 R-7     | COUNTY TAZEWELL | TOTAL SHEETS 390          | SHEET NO. 188 |
| PLOT SCALE = 40.0000' / IN. |                  |            |           | SCALE: AS SHOWN |                     |                                  |               | CONTRACT NO. 68370 |                 | ILLINOIS FED. AID PROJECT |               |
| PLOT DATE = 10/21/2011      |                  |            |           |                 |                     |                                  |               |                    |                 |                           |               |