

| | |
|----------|--|
| DATE | |
| BY | |
| SURVEYED | |
| TEMPLATE | |
| AREAS | |
| CHECKED | |
| NO. | |

| | |
|----------|--|
| DATE | |
| BY | |
| SURVEYED | |
| TEMPLATE | |
| AREAS | |
| CHECKED | |
| NO. | |

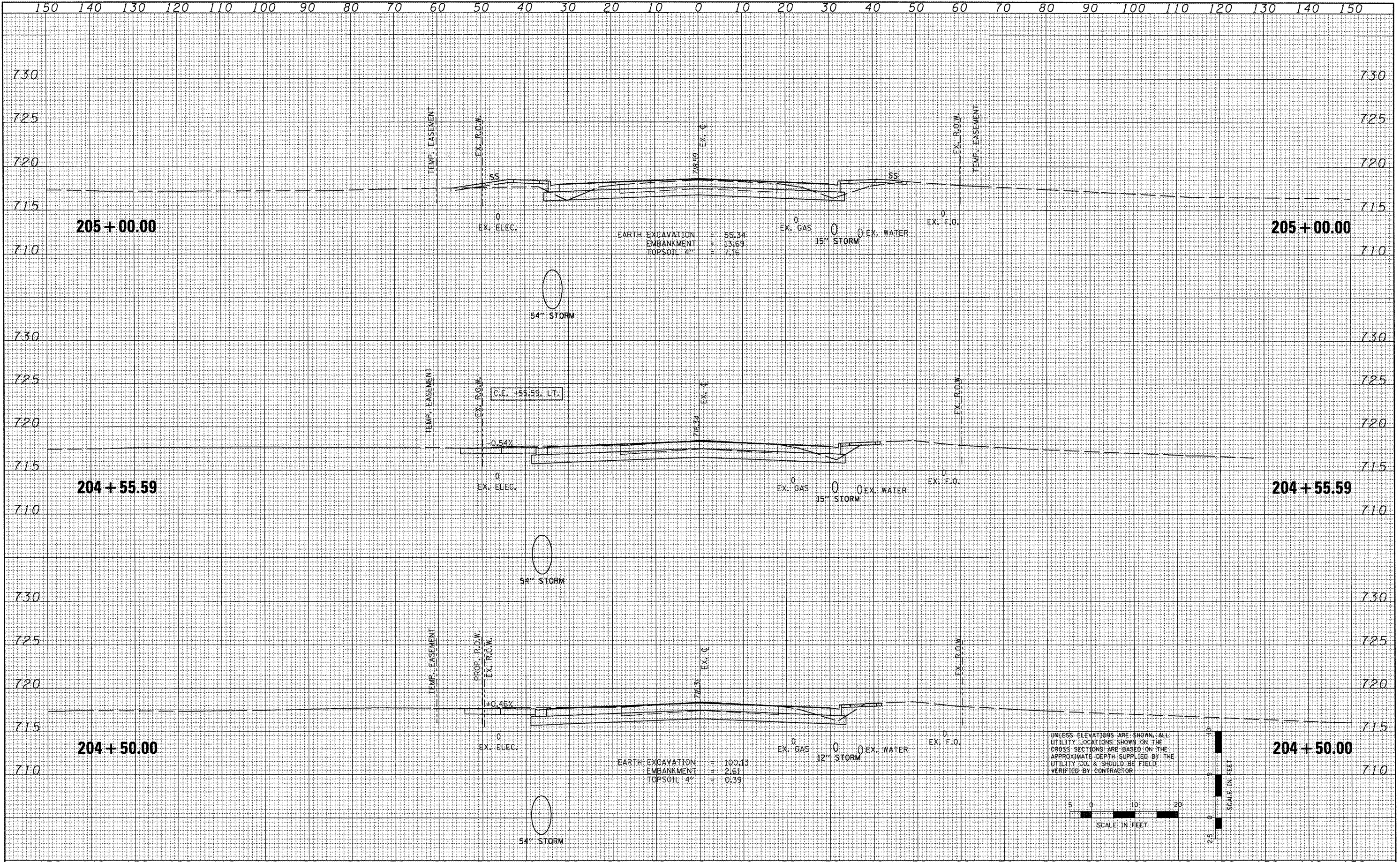

UNLESS ELEVATIONS ARE SHOWN, ALL UTILITY LOCATIONS SHOWN ON THE CROSS SECTIONS ARE BASED ON THE APPROXIMATE DEPTH SUPPLIED BY THE UTILITY CO. & SHOULD BE FIELD VERIFIED BY CONTRACTOR.



| | | | | | | | | | | |
|--|------------------|-----------------|-----------|---|---|--------------------|---------------------|----------------------------------|--------------|-----------|
| FILE NAME = | USER NAME = IDOT | DESIGNED - | REVISED - | STATE OF ILLINOIS DEPARTMENT OF TRANSPORTATION | FAP 399 (IL RTE. 8) CROSS SECTIONS | F.A.P. R.T.L. | SECTION | COUNTY | TOTAL SHEETS | SHEET NO. |
| xs\projects\200803566\dgn\gpk\XS-IL-RT8-sheets.dgn | | DRAWN - | REVISED - | | | 399 | 36 R-7 | TAZEWELL | 390 | 308 |
| PLOT SCALE = 20.7428' / IN. | | CHECKED - | REVISED - | | | CONTRACT NO. 68370 | | ILLINOIS FED. AID PROJECT | | |
| PLOT DATE = 10/21/2011 | | DATE = 10-21-11 | REVISED - | | | SCALE: | SHEET NO. OF SHEETS | STA. 204+50.00 TO STA. 205+00.00 | | |