

DATE	
BY	
FINAL SURVEY	SURVEYED
NOTE BOOK	PLOTTED
NO.	TEMPLATE
	AREAS CHECKED

DATE	
BY	
ORIGINAL SURVEY	SURVEYED
NOTE BOOK	PLOTTED
NO.	TEMPLATE
	AREAS CHECKED

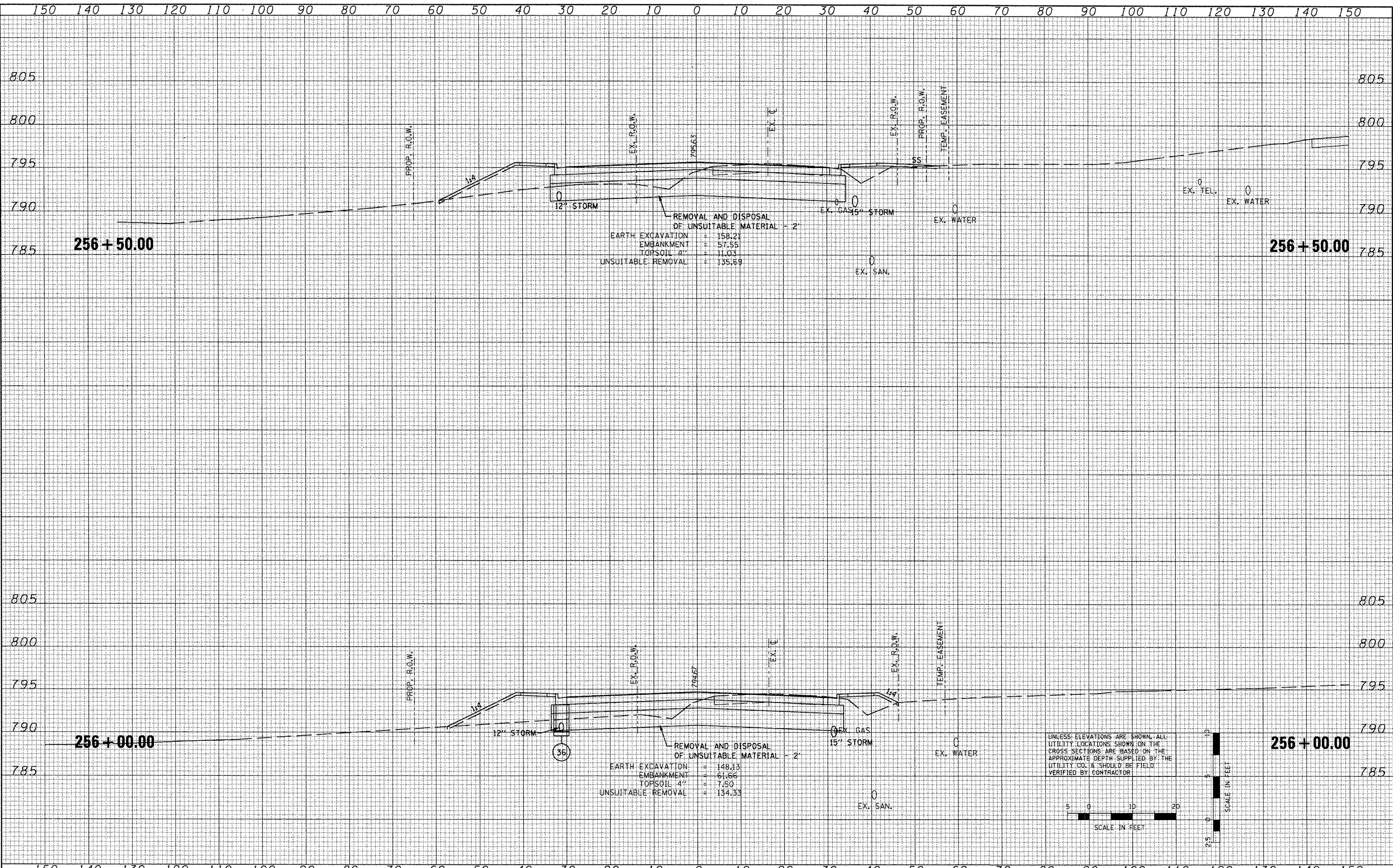

REMOVAL AND DISPOSAL OF UNSUITABLE MATERIAL - 2'

EARTH EXCAVATION	=	158.21
EMBANKMENT	=	57.55
TOPSOIL 4"	=	11.03
UNSUITABLE REMOVAL	=	135.69

REMOVAL AND DISPOSAL OF UNSUITABLE MATERIAL - 2'

EARTH EXCAVATION	=	148.13
EMBANKMENT	=	61.66
TOPSOIL 4"	=	7.80
UNSUITABLE REMOVAL	=	134.33

UNLESS ELEVATIONS ARE SHOWN, ALL UTILITY LOCATIONS SHOWN ON THE CROSS SECTIONS ARE BASED ON THE APPROXIMATE DEPTH SUPPLIED BY THE UTILITY CO. & SHOULD BE FIELD VERIFIED BY CONTRACTOR

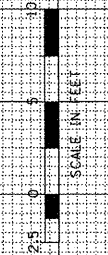

FILE NAME = x:\projects\200803566\dgn\gpk\XS-IL-RT8-sheets.dgn
 USER NAME = IDOT
 PLOT SCALE = 20.7420' / IN.
 PLOT DATE = 10/21/2011

DESIGNED -	REVISD -
DRAWN -	REVISD -
CHECKED -	REVISD -
DATE - 10-21-11	REVISD -

**STATE OF ILLINOIS
DEPARTMENT OF TRANSPORTATION**

**FAP 399 (IL RTE. 8)
CROSS SECTIONS**

SCALE: SHEET NO. OF SHEETS STA. 256+00.00 TO STA. 256+50.00

F.A.P. RTE. 399	SECTION 36 R-7	COUNTY TAZEWELL	TOTAL SHEETS 390	SHEET NO. 365
			CONTRACT NO. 68370	
ILLINOIS FED. AID PROJECT				