

DATE	
BY	
FINAL SURVEY	SURVEYED
NOTE BOOK	PLOTTED
NO.	TEMP. EASEMENT
	EX. R.O.W.
	PROP. R.O.W.
	EX. R.O.W.
	PROP. R.O.W.

DATE	
BY	
ORIGINAL SURVEY	SURVEYED
NOTE BOOK	PLOTTED
NO.	TEMP. EASEMENT
	EX. R.O.W.
	PROP. R.O.W.
	EX. R.O.W.
	PROP. R.O.W.

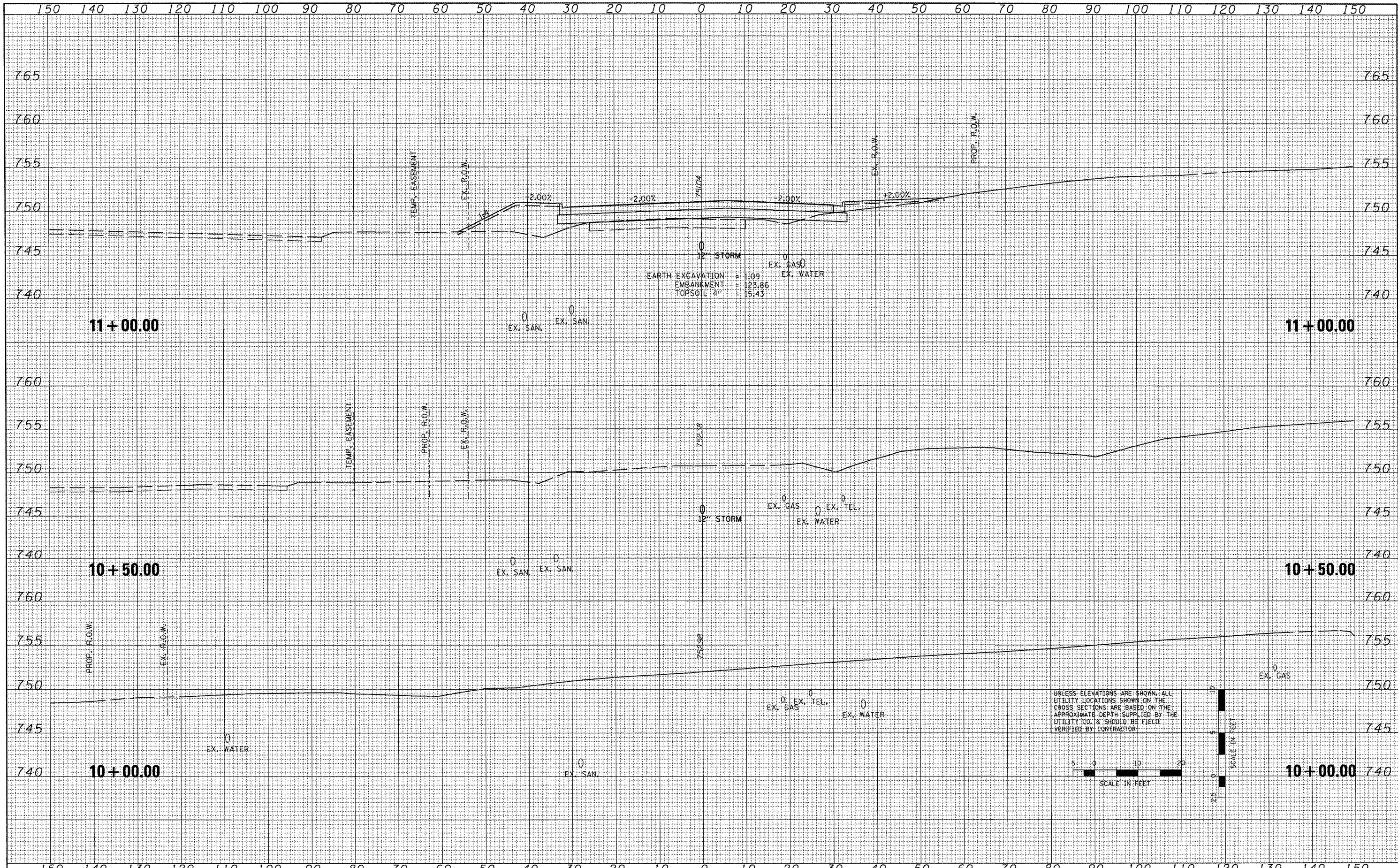

UNLESS ELEVATIONS ARE SHOWN, ALL UTILITY LOCATIONS SHOWN ON THE CROSS SECTIONS ARE BASED ON THE APPROXIMATE DEPTH SUPPLIED BY THE UTILITY CO. & SHOULD BE FIELD VERIFIED BY CONTRACTOR

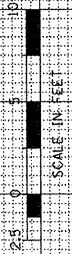
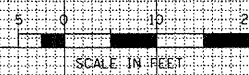

FILE NAME = s:\projects\200803566\dgn\gpk\XS-School2-SHEE
5.dgn

USER NAME = 1001
DESIGNED -
DRAWN -
CHECKED -
DATE -
PLOT SCALE = 20.7420 / IN.
PLOT DATE = 10/21/2011

DESIGNED -
DRAWN -
CHECKED -
DATE -
REVISED -
REVISED -
REVISED -
REVISED -

STATE OF ILLINOIS
DEPARTMENT OF TRANSPORTATION

SCHOOL STREET
CROSS SECTIONS

SCALE: SHEET NO. OF SHEETS STA. 10+00.00 TO STA. 11+00.00

F.A.P. RTE. 399	SECTION 36 R-7	COUNTY TAZEWELL	TOTAL SHEETS 390	SHEET NO. 384
ILLINOIS FED. AID PROJECT			CONTRACT NO. 68370	