

• WIDTH RESTRICTION 10'-6"

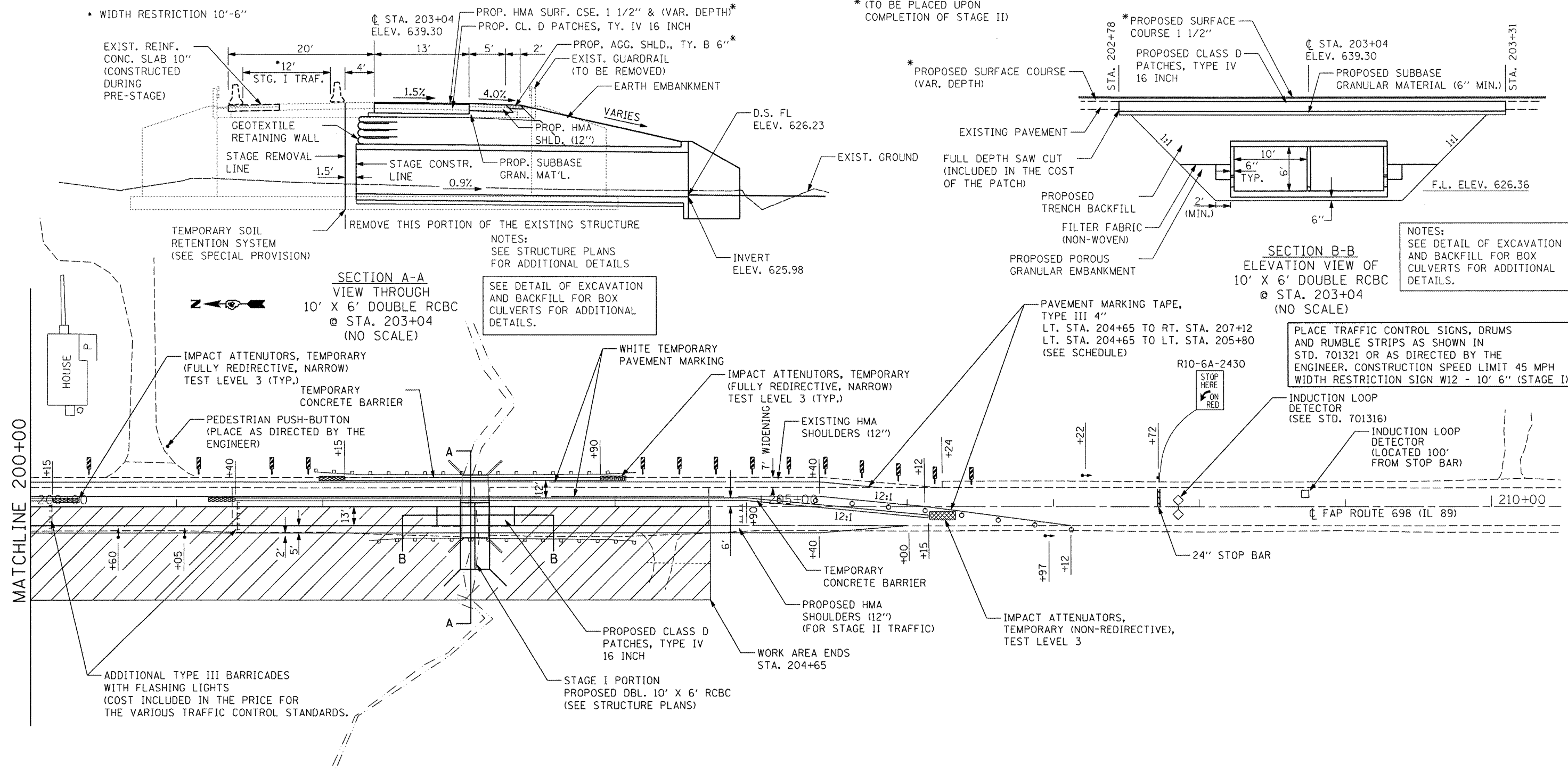

TEMPORARY SOIL RETENTION SYSTEM (SEE SPECIAL PROVISION)

**SECTION A-A**  
VIEW THROUGH  
10' X 6' DOUBLE RCBC  
@ STA. 203+04  
(NO SCALE)

NOTES:  
SEE STRUCTURE PLANS  
FOR ADDITIONAL DETAILS

SEE DETAIL OF EXCAVATION  
AND BACKFILL FOR BOX  
CULVERTS FOR ADDITIONAL  
DETAILS.

**SECTION B-B**  
ELEVATION VIEW OF  
10' X 6' DOUBLE RCBC  
@ STA. 203+04  
(NO SCALE)

NOTES:  
SEE DETAIL OF EXCAVATION  
AND BACKFILL FOR BOX  
CULVERTS FOR ADDITIONAL  
DETAILS.

PLACE TRAFFIC CONTROL SIGNS, DRUMS  
AND RUMBLE STRIPS AS SHOWN IN  
STD. 701321 OR AS DIRECTED BY THE  
ENGINEER. CONSTRUCTION SPEED LIMIT 45 MPH  
WIDTH RESTRICTION SIGN W12 - 10' 6" (STAGE I)

MATCHLINE 200+00

- ▬ TYPE III BARRICADE WITH FLASHING LIGHTS
- ▬ SIGN
- DRUM WITH STEADY BURNING LIGHTS
- ◀ TRAFFIC SIGNAL
- ▬ DOUBLE VERTICAL PANEL

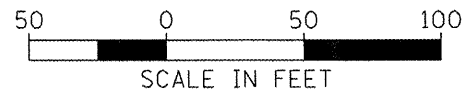

FILE NAME = ...plans\0468751-sht-staging1.dgn  
**Johnson, Depp & Ouisenberry**  
 CONSULTING ENGINEERS  
 Springfield, Illinois

USER NAME = #USER	DESIGNED -	REVISED -
PLOT SCALE = 70,0000 "/>		

CHECKED -	REVISED -
DATE -	REVISED -

**STATE OF ILLINOIS**  
**DEPARTMENT OF TRANSPORTATION**

<b>STAGE I CONSTRUCTION AND TRAFFIC CONTROL</b>			
SCALE:	SHEET NO.	OF SHEETS	STA. TO STA.

F.A.P. RTE. 698	SECTION (2) BR-1 & BR-2	COUNTY PUTNAM	TOTAL SHEETS 71	SHEET NO. 26
CONTRACT NO. 68571				
ILLINOIS FED. AID PROJECT				