

Notes:  
See sheet 8 of 15 for Sections C-C, D-D & E-E and View B-B and F-F.  
a<sub>6</sub>(E) thru a<sub>9</sub>(E) bar spacings measured along  $\varnothing$  Rdwy.

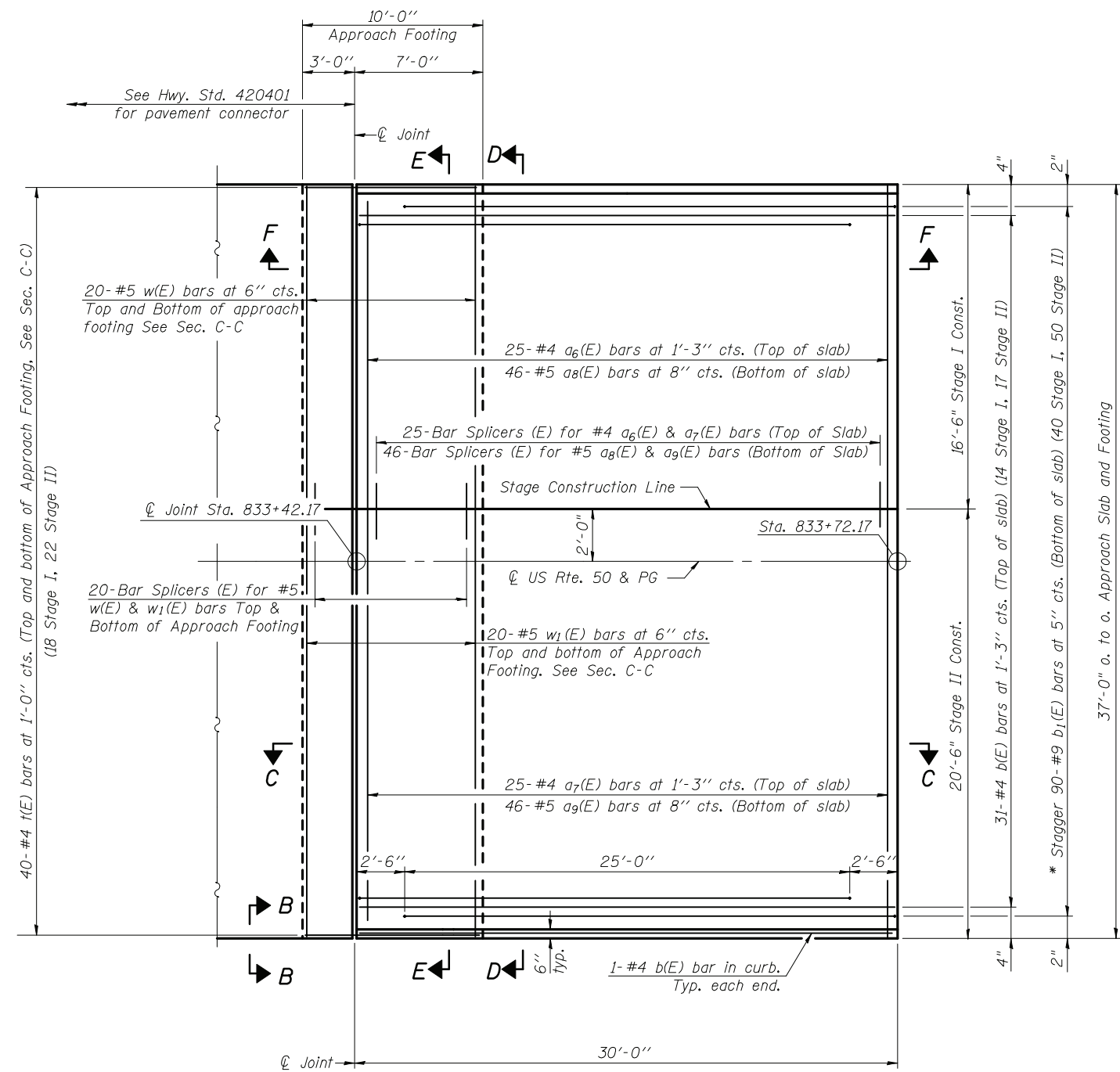

**PLAN**  
(West Approach)

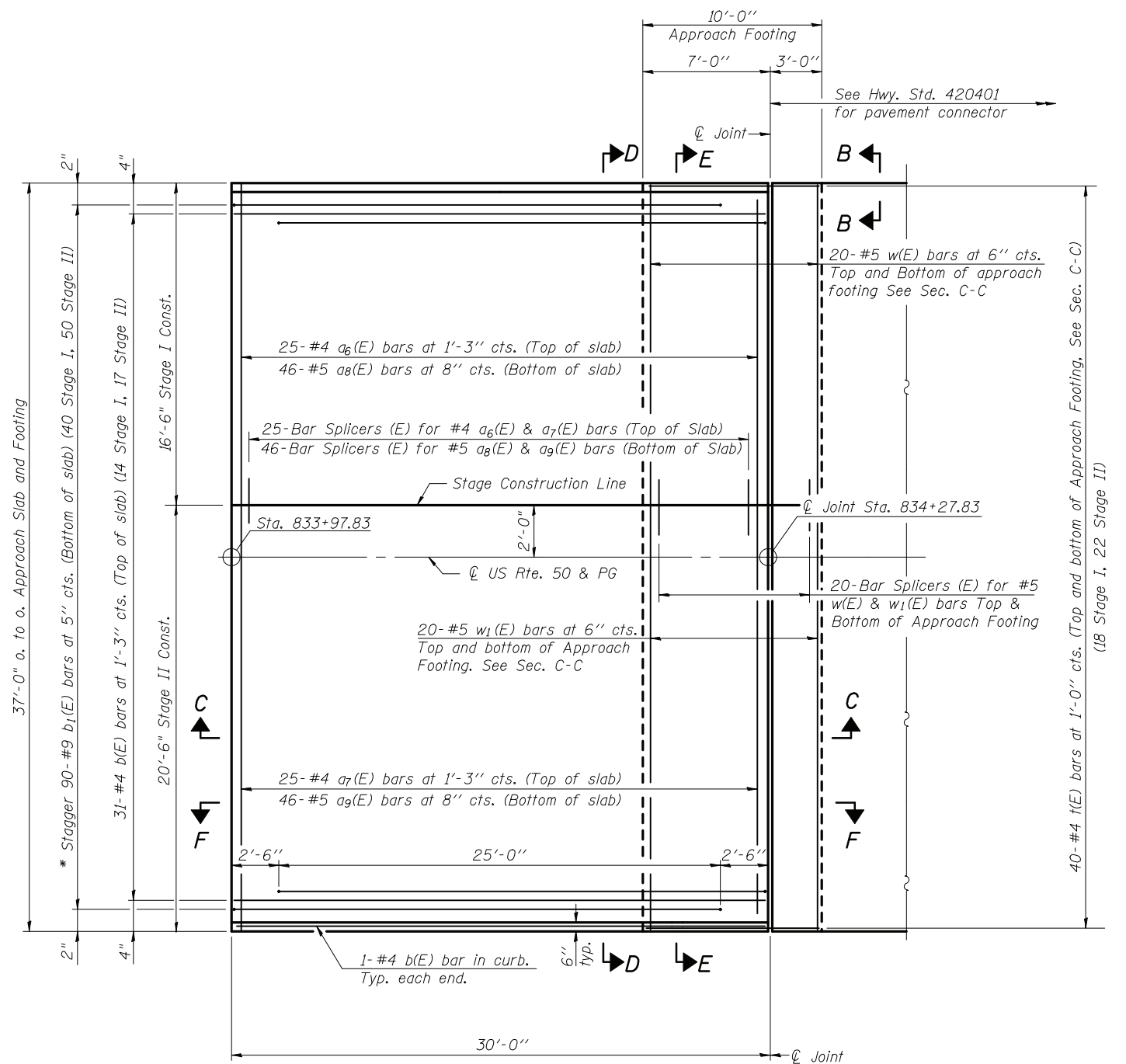

**PLAN**  
(East Approach)

\* Tilt #9 b<sub>1</sub>(E) bars as required to maintain clearance.

FILE NAME = \014202476B43-007-App Plan	DESIGNED - ACS
PROJECT NAME =	CHECKED - BB
Illinois Design Firm Number 184,001670	DRAWN - JG
PLOT SCALE =	CHECKED - CJF
PLOT DATE = 8:54:41 AM 12/14/2011	REVISED -

DESIGNED - ACS	REVISED -
CHECKED - BB	REVISED -
DRAWN - JG	REVISED -
CHECKED - CJF	REVISED -

**STATE OF ILLINOIS**  
**DEPARTMENT OF TRANSPORTATION**

**BRIDGE APPROACH SLAB DETAILS**  
**STRUCTURE NO. 014-2024**

SHEET NO. 7 OF 15 SHEETS

F.A.P. RTE.	SECTION	COUNTY	TOTAL SHEETS	SHEET NO.
327	20BR	CLINTON	51	33
CONTRACT NO. 76B43				
FED. ROAD DIST. NO. - [ILLINOIS] FED. AID PROJECT				