

STATE OF ILLINOIS
DEPARTMENT OF TRANSPORTATION

CAUTION
OVERHEAD
WIRES

12 - #16 h bars
Place as shown - See Sections

2 - #13 h₃ bars at (Top of Seat) (Typ. each end)
Place as shown - See Section A-A

N.G.S. Bench Mark J-228 in Limestone
Abutment
(Do Not Disturb)

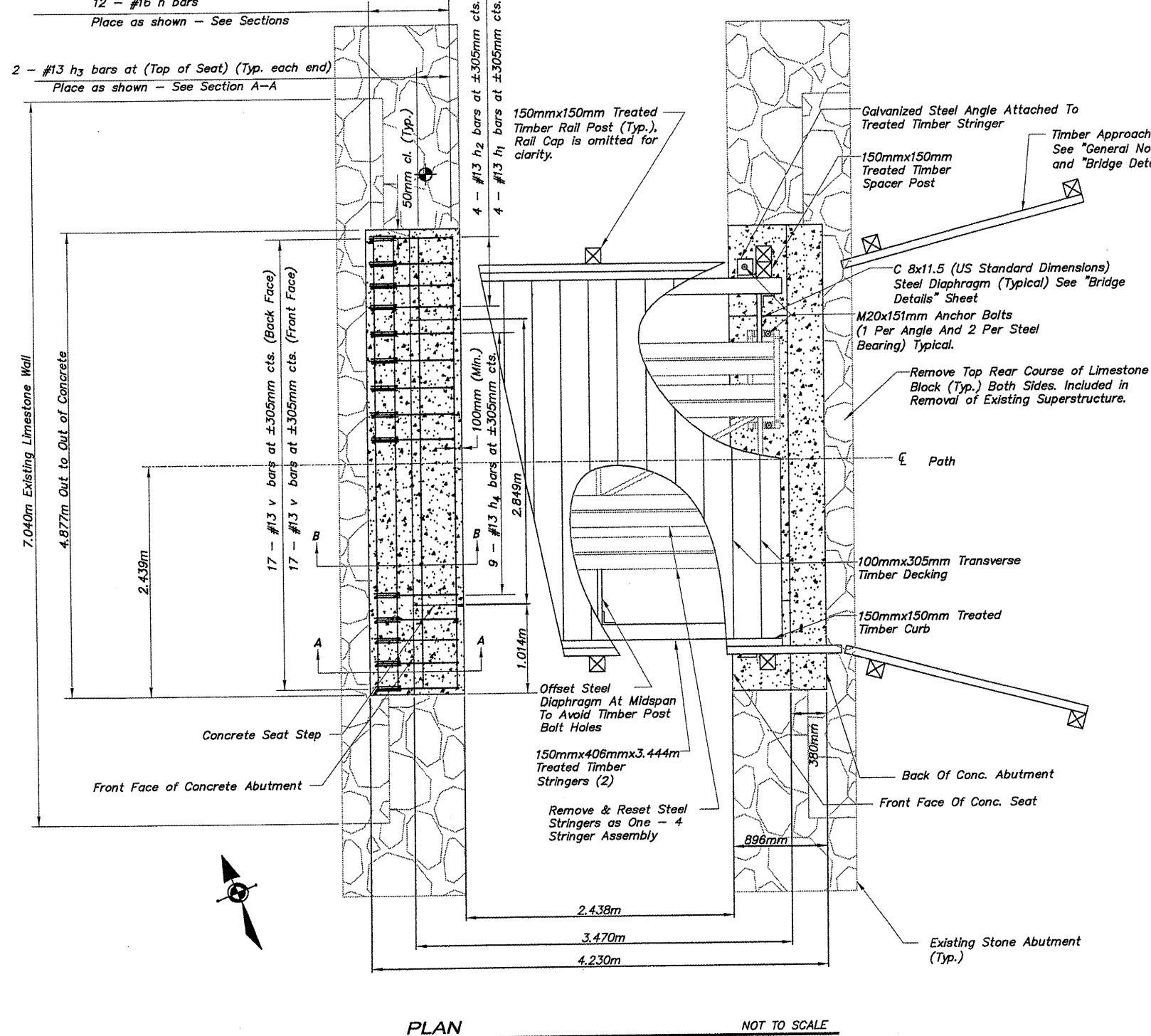

PLAN NOT TO SCALE

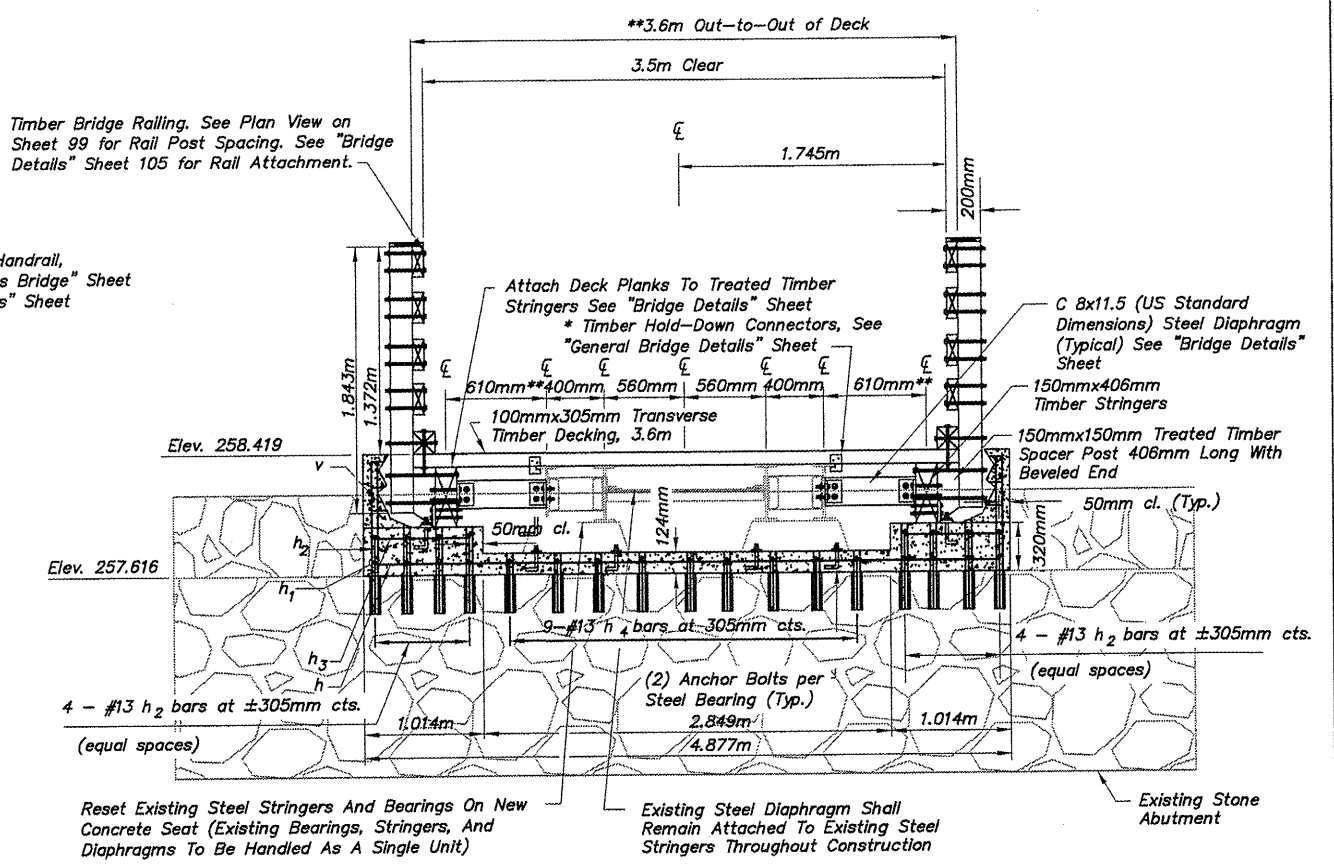

SECTION THRU DECK NOT TO SCALE

* Note: The Contractor may use an alternative method of using a 10mm thick plate washer and lag screw in place of the Timber Deck Angle as shown on the General Bridge Details and General Bridge Notes.
** Note: Dimensional lumber may vary in furnished size. Clear width of the deck shall be 3.5m minimum.

Note: Space reinforcing to avoid Anchor Bolt locations

BRIDGE DETAILS
BRIDGE 129
OVER A TRIBUTARY TO THE
COOLIDGE CREEK
WINNEBAGO COUNTY
SECTION NO. 94-00267-00-BT
STATION 40+864.19

SHEET 2 OF 3

SHEET REVIEW		REVISIONS		SCALE: N/A	<p>7282 Argus Drive Rookford, Illinois 61107-6837 (815) 398-2332 FAX: (815) 398-2486 Design Firm License: Illinois 184-000818 Copyright 2011 By McClure Engineering Associates, Inc.</p>	BRIDGE NO. 129 DETAILS I		SHEET NO. 100 OF 107
AGENCY	DATE	NO.	ITEM	DATE		PECATONICA PRAIRIE PATH		
						WINNEBAGO COUNTY HIGHWAY DEPARTMENT SECTION 94-00267-00-BT		
						FILE: H:\10-042 WINN CO PEC PATH\DESIGN\DRAWINGS\BRIDGES\10-042 B129-130.DWG JOB: 04-30-10-042		