

TRAFFIC CONTROL AND PROTECTION

TRAFFIC CONTROL AND PROTECTION SHALL BE PERFORMED IN ACCORDANCE WITH THE TRAFFIC CONTROL PLAN, SECTION 701 OF THE STANDARD SPECIFICATIONS AND THE SPECIAL PROVISIONS.

TWO WAY TRAFFIC SHALL BE ACCOMMODATED AT ALL TIMES EXCEPT DURING ISOLATED FLAGGER CONTROLLED LANE CLOSURES.

EXISTING TRAFFIC CONTROL SIGNS AND DEVICES WILL BE REMOVED BY THE CONTRACTOR AFTER THE PROPOSED TRAFFIC CONTROL REQUIREMENTS ARE MET, OR AS AUTHORIZED BY THE ENGINEER. SIGNS OR DEVICES LEFT IN PLACE AT THIS TIME ARE TO BE PROTECTED FROM DAMAGE BY THE CONTRACTOR.

DRUMS WITH WORKING LIGHTS ARE REQUIRED TO DELINEATE THE TRAVEL WAY. THE MAXIMUM SPACING SHALL BE 100 FEET, CENTER TO CENTER ALONG TANGENTS, 50 FEET ALONG TAPERS AND 25 FEET, CENTER TO CENTER ALONG RADII TO SIDE ROADS AND ENTRANCES.

THE FOLLOWING TRAFFIC CONTROL STANDARDS ARE THE MINIMUM REQUIREMENTS FOR THE TRAFFIC CONTROL FOR THIS PROJECT: 701001, 701006, 701011, 701201, 701301, 701326, & 701901.

STAGE 1 CONSTRUCTION

CONSTRUCT THE TEMPORARY PAVEMENT FROM STA. 47+22.2 (LT.) TO STA. 49+88.0 (LT.), AND FROM STA. 50+11.7 (RT.) TO STA. 53+14.9 (RT.).

INSTALL PROPOSED PIPE CULVERTS, AND TEMPORARY 42' EXTENSION AT STA. 49+00.0 AND STA. 99+00.0.

TWO-WAY TRAFFIC IS TO BE MAINTAINED AT ALL TIMES UTILIZING EXISTING PAVEMENT.

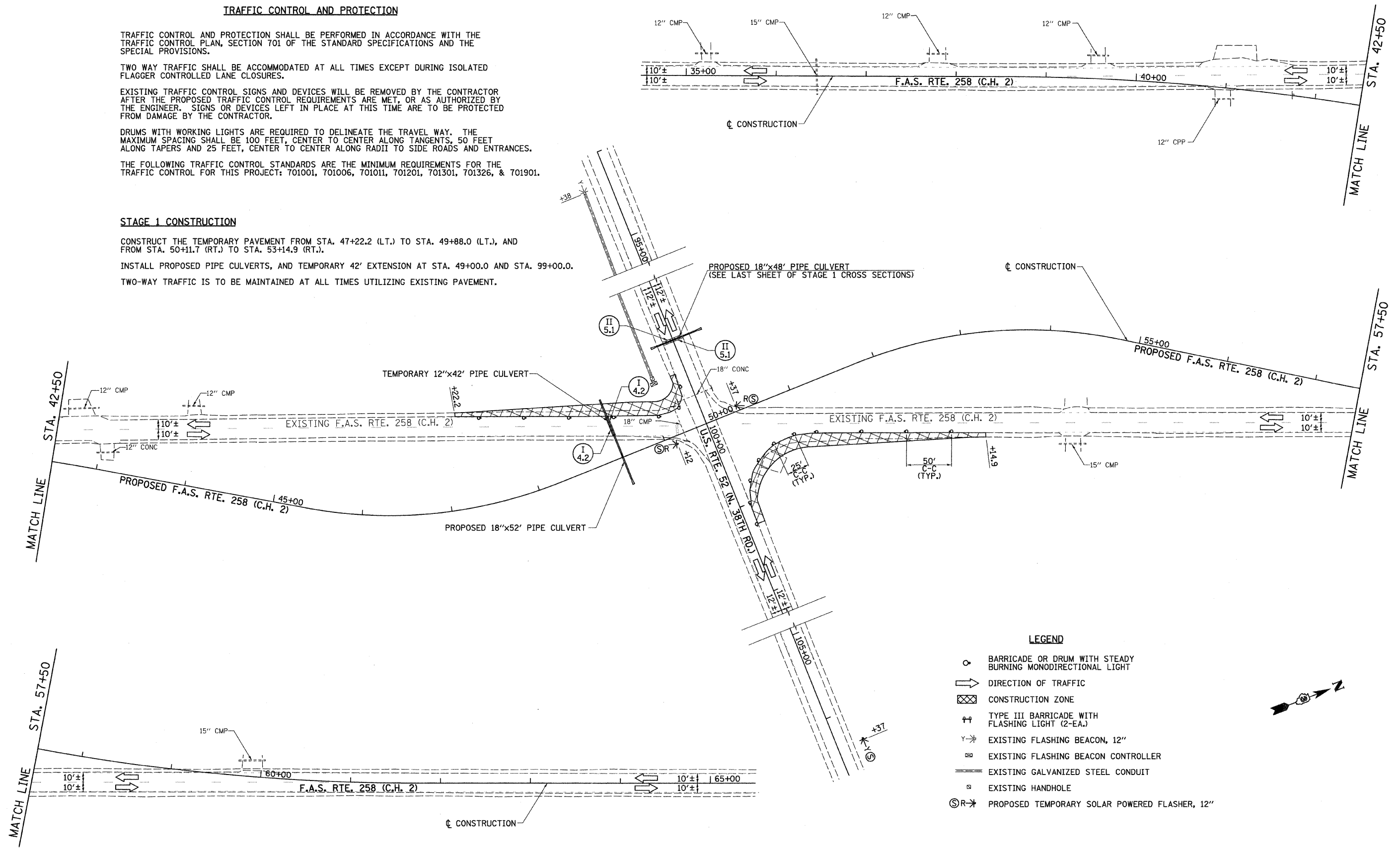

- LEGEND**
- ⊙ BARRICADE OR DRUM WITH STEADY BURNING MONODIRECTIONAL LIGHT
 - ➔ DIRECTION OF TRAFFIC
 - ⊗ CONSTRUCTION ZONE
 - † TYPE III BARRICADE WITH FLASHING LIGHT (2-EA.)
 - ⚡ EXISTING FLASHING BEACON, 12"
 - ⊞ EXISTING FLASHING BEACON CONTROLLER
 - EXISTING GALVANIZED STEEL CONDUIT
 - ⊠ EXISTING HANDHOLE
 - ⊙➔ PROPOSED TEMPORARY SOLAR POWERED FLASHER, 12"



FILE NAME = v:\2844\2844f101.dgn	USER NAME = bdeoraene	DESIGNED -	REVISED -
		DRAWN -	REVISED -
	PLOT SCALE = 50.0000' / IN.	CHECKED -	REVISED -
	PLOT DATE = 12/22/2011	DATE -	REVISED -

**STATE OF ILLINOIS
DEPARTMENT OF TRANSPORTATION**

**F.A.S. RTE. 258 (C.H. 2) STAGE 1 CONSTRUCTION PLAN AND
TEMPORARY FLASHING BEACON PLAN**

SCALE: 1"=50' SHEET NO. 1 OF 1 SHEETS STA. 34+50 TO STA. 65+50

F.A.S. RTE.	SECTION	COUNTY	TOTAL SHEETS	SHEET NO.
258	11-00325-00-SP	LA SALLE	84	19
			CONTRACT NO. 87479	
ILLINOIS FED. AID PROJECT				