

NOTE:  
 THE TEMPORARY SOLAR POWERED RED FLASHERS ABOVE THE STOP SIGNS AND THE TEMPORARY SOLAR POWERED YELLOW FLASHER ABOVE THE WESTBOUND CROSSROAD SIGN SHALL BE REMOVED BY THE CONTRACTOR AND REMAIN HIS PROPERTY FOLLOWING THE INSTALLATION OF NEW STOP SIGNS AND RED LED FLASHING BEACONS ABOVE THE STOP SIGNS, AND RECONNECTION OF THE YELLOW FLASHER ON THE WESTBOUND CROSSROAD SIGN BACK TO FLASHING POWER AT THE EXISTING FLASHER CONTROLLER.

THE COST AND LABOR TO INSTALL 1/2" TO 2" CONDUIT ADAPTORS SHALL BE INCLUDED IN THE UNIT PRICE FOR 2" CONDUIT.

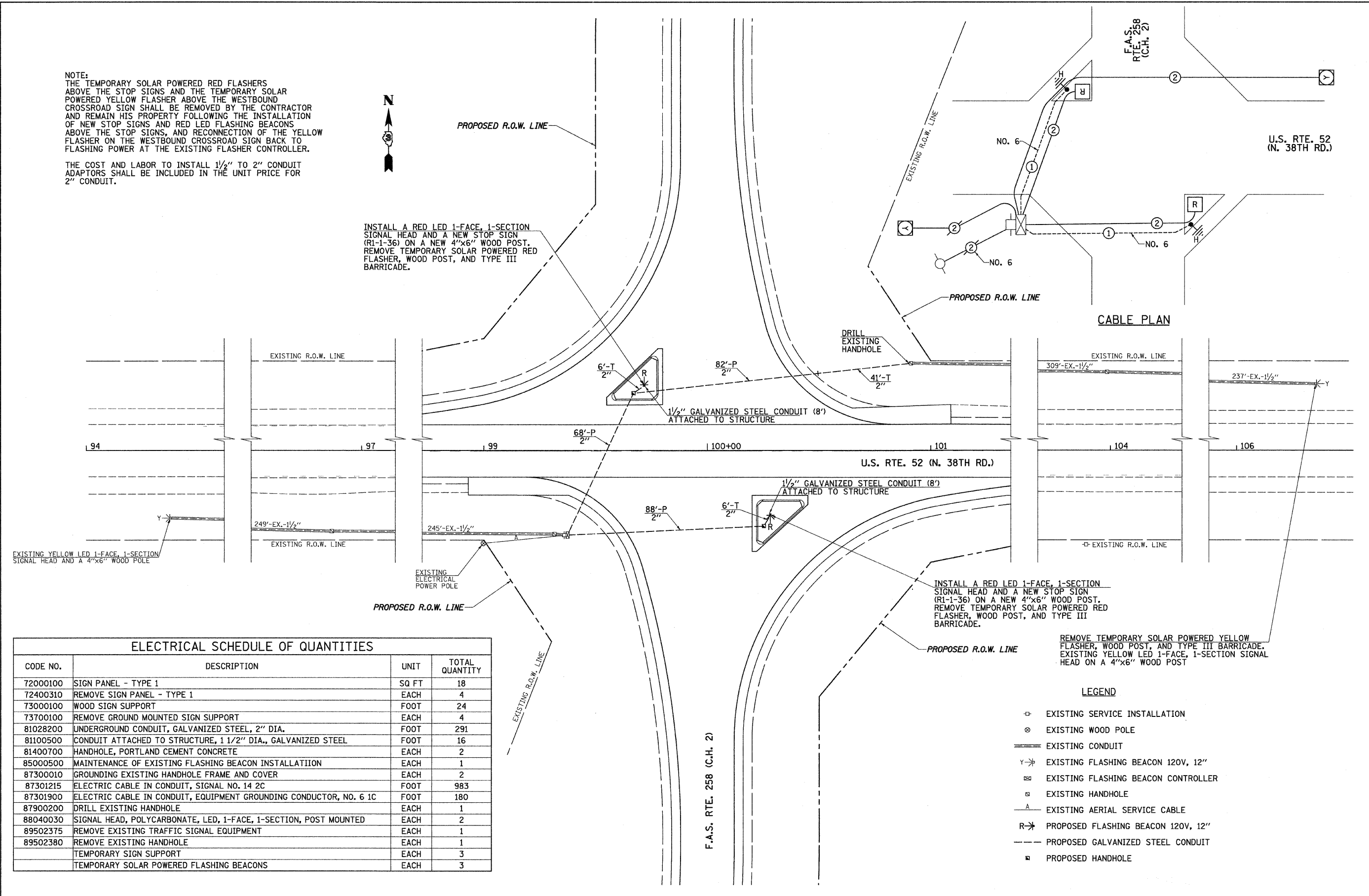

ELECTRICAL SCHEDULE OF QUANTITIES			
CODE NO.	DESCRIPTION	UNIT	TOTAL QUANTITY
72000100	SIGN PANEL - TYPE 1	SQ FT	18
72400310	REMOVE SIGN PANEL - TYPE 1	EACH	4
73000100	WOOD SIGN SUPPORT	FOOT	24
73700100	REMOVE GROUND MOUNTED SIGN SUPPORT	EACH	4
81028200	UNDERGROUND CONDUIT, GALVANIZED STEEL, 2" DIA.	FOOT	291
81100500	CONDUIT ATTACHED TO STRUCTURE, 1 1/2" DIA., GALVANIZED STEEL	FOOT	16
81400700	HANDHOLE, PORTLAND CEMENT CONCRETE	EACH	2
85000500	MAINTENANCE OF EXISTING FLASHING BEACON INSTALLATION	EACH	1
87300010	GROUNDING EXISTING HANDHOLE FRAME AND COVER	EACH	2
87301215	ELECTRIC CABLE IN CONDUIT, SIGNAL NO. 14 2C	FOOT	983
87301900	ELECTRIC CABLE IN CONDUIT, EQUIPMENT GROUNDING CONDUCTOR, NO. 6 1C	FOOT	180
87900200	DRILL EXISTING HANDHOLE	EACH	1
88040030	SIGNAL HEAD, POLYCARBONATE, LED, 1-FACE, 1-SECTION, POST MOUNTED	EACH	2
89502375	REMOVE EXISTING TRAFFIC SIGNAL EQUIPMENT	EACH	1
89502380	REMOVE EXISTING HANDHOLE	EACH	1
	TEMPORARY SIGN SUPPORT	EACH	3
	TEMPORARY SOLAR POWERED FLASHING BEACONS	EACH	3

FILE NAME =  
 v:\2844\28441802.dgn

USER NAME = bdecaene  
 DESIGNED -  
 DRAWN -  
 PLOT SCALE = 20.0000' / IN.  
 PLOT DATE = 12/22/2011

DESIGNED -  
 REVISIONS:  
 REVISIONS:  
 REVISIONS:  
 REVISIONS:  
 REVISIONS:

STATE OF ILLINOIS  
 DEPARTMENT OF TRANSPORTATION

U.S. RTE. 52 (N. 38TH RD.) & F.A.S. RTE. 258 (C.H. 2)  
 PROPOSED FLASHER BEACON, SCHEDULE OF QUANTITIES & CABLE PLAN  
 SCALE: 1"=20' SHEET NO. 2 OF 2 SHEETS STA. 94+38 TO STA. 106+37

F.A.S. RTE. 258	SECTION 11-00325-00-SP	COUNTY LA SALLE	TOTAL SHEETS 84	SHEET NO. 46
CONTRACT NO. 87479			ILLINOIS FED. AID PROJECT	