

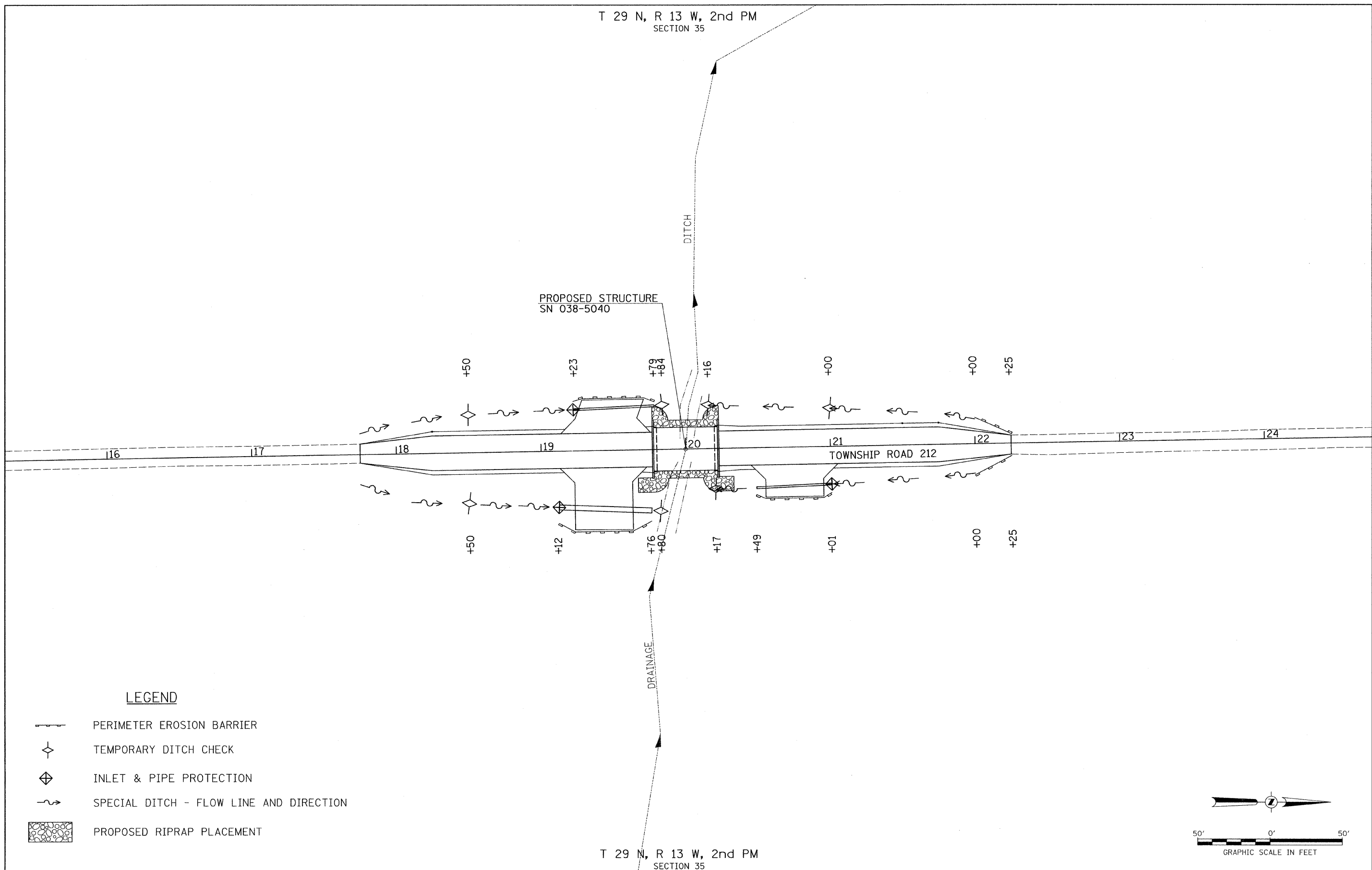





T 29 N, R 13 W, 2nd PM
SECTION 35

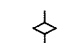

LEGEND

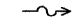
-  PERIMETER EROSION BARRIER
-  TEMPORARY DITCH CHECK
-  INLET & PIPE PROTECTION
-  SPECIAL DITCH - FLOW LINE AND DIRECTION
-  PROPOSED RIPRAP PLACEMENT

T 29 N, R 13 W, 2nd PM
SECTION 35

FILE NAME = V:\Bridg\2968-Iroquois\29685001.dgn	USER NAME = ethomas	DESIGNED -	REVISED -	IROQUOIS COUNTY TOWNSHIP ROAD 212 OVER DRAINAGE DITCH	EROSION CONTROL PLAN	RTE	SECTION	COUNTY	TOTAL SHEETS	SHEET NO.
		DRAWN -	REVISED -			TR 212	08-21119-00-BR	IROQUOIS	24	5
	PLOT SCALE = 30,0000' / IN.	CHECKED -	REVISED -			CONTRACT NO. 87501				
	PLOT DATE = 9/29/2011	DATE -	REVISED -			FED. ROAD DIST. NO. 7 ILLINOIS FED. AID PROJECT BROS-00751147				
					SCALE: 1" = 30'	SHEET NO. 1 OF 1 SHEETS		STA. 17+75.00 TO STA. 22+25.00		