

EDGE OF NORTH PARAPET

Location	Station	Offset	Theoretical Grade Elevations
Bk E. Abutment	100+48.62	-15.01	588.59
A	100+58.66	-15.01	588.64
B	100+68.70	-14.97	588.69
End E. Approach Pvmnt.	100+78.73	-14.92	588.74

NORTH EDGE OF ROADWAY PAVEMENT

Location	Station	Offset	Theoretical Grade Elevations
Bk E. Abutment	100+48.58	-12.00	588.65
A	100+58.61	-12.00	588.70
B	100+68.64	-12.00	588.75
End E. Approach Pvmnt.	100+78.67	-12.00	588.80

☉ ROADWAY & PROFILE GRADE

Location	Station	Offset	Theoretical Grade Elevations
Bk E. Abutment	100+48.43	0.00	588.84
A	100+58.43	0.00	588.89
B	100+68.44	0.00	588.94
End E. Approach Pvmnt.	100+78.43	0.00	588.99

SOUTH EDGE OF ROADWAY PAVEMENT

Location	Station	Offset	Theoretical Grade Elevations
Bk E. Abutment	100+48.28	12.00	588.65
A	100+58.26	12.00	588.70
B	100+68.23	12.00	588.75
End E. Approach Pvmnt.	100+78.20	12.00	588.80

EDGE OF SOUTH PARAPET

Location	Station	Offset	Theoretical Grade Elevations
Bk E. Abutment	100+48.24	15.32	588.58
A	100+58.21	15.32	588.63
B	100+68.17	15.35	588.68
End E. Approach Pvmnt.	100+78.13	15.41	588.73

DESIGNED	NPH
CHECKED	BAN
DRAWN	RMD
CHECKED	BAN

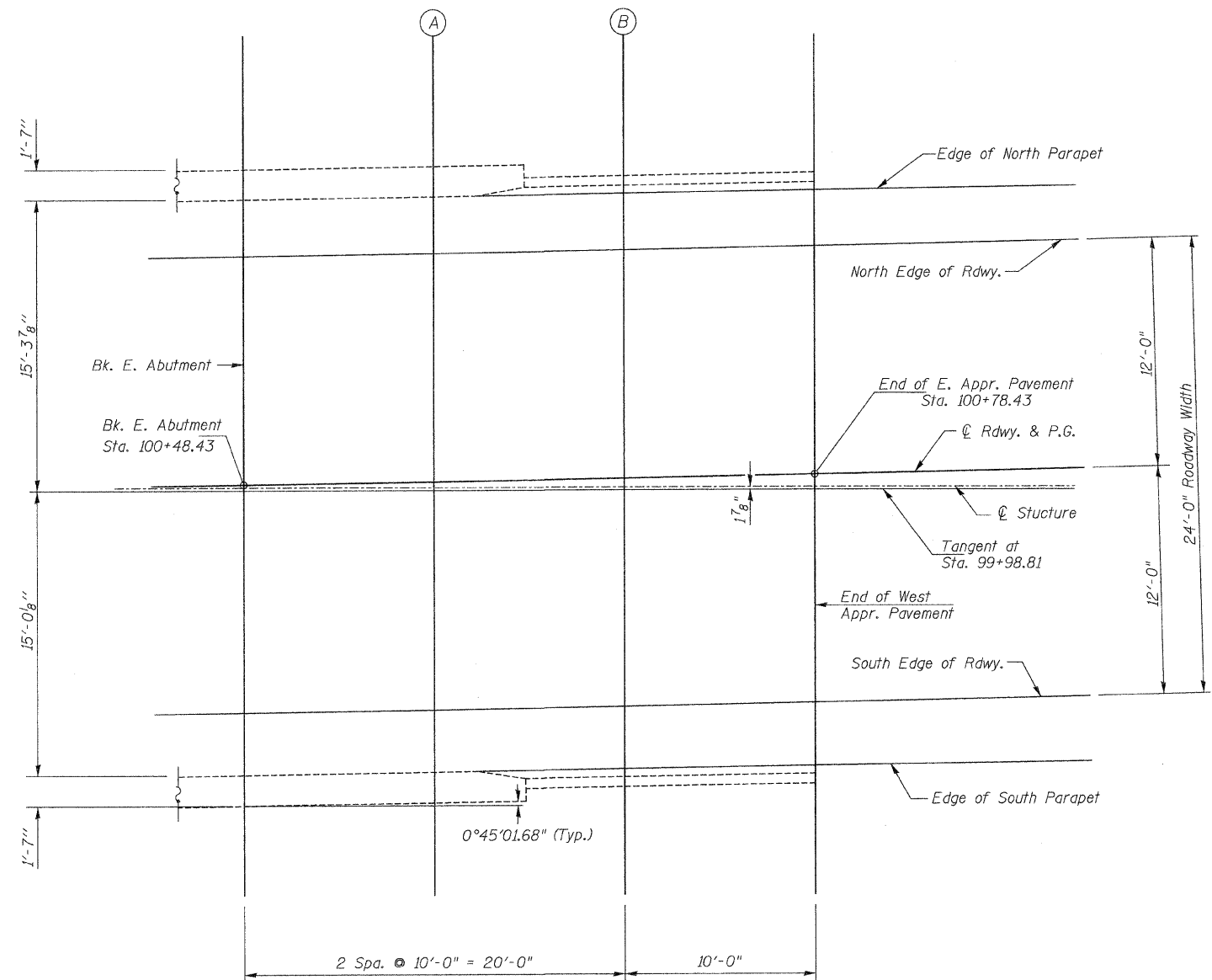
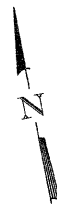

PLAN EAST APPROACH PAVEMENT

TOP OF EAST APPROACH PAVEMENT ELEVATIONS
RIVER RD. (F.A.U. 3799) OVER
BLACKBERRY CREEK
SECTION 08-00036-00-BR
KENDALL COUNTY
STATION 99+98.81

SHEET NO. 6 23 SHEETS	ROUTE NO.	SECTION	COUNTY	TOTAL SHEETS	SHEET NO.
	FAU 3799	08-00036-00-BR	KENDALL	54	27
	SN 047-6500		CONTRACT NO. 87509		
	FED. ROAD DIST. NO. 7 ILLINOIS		FED. AID PROJECT BRM-9003(883)		