

SUMMARY OF QUANTITIES

CODE NUMBER	PAY ITEM	UNIT	TOTAL
20200100	EARTH EXCAVATION	CU YD	459
20300100	CHANNEL EXCAVATION	CU YD	74
20400800	FURNISHED EXCAVATION	CU YD	134
28000305	TEMPORARY DITCH CHECKS	FOOT	46
28000400	PERIMETER EROSION BARRIER	FOOT	249
28000500	INLET AND PIPE PROTECTION	EACH	4
28100207	STONE RIPRAP, CLASS A4	TON	88
28100209	STONE RIPRAP, CLASS A5	TON	203
28200200	FILTER FABRIC	SQ YD	318
35101400	AGGREGATE BASE COURSE, TYPE B	TON	427
40200800	AGGREGATE SURFACE COURSE, TYPE B	TON	135
40300100	BITUMINOUS MATERIALS (PRIME COAT)	GALLON	352
40300300	BITUMINOUS MATERIALS (COVER AND SEAL COATS)	GALLON	984
40300500	COVER COAT AGGREGATE	TON	22
40300600	SEAL COAT AGGREGATE	TON	11
48101200	AGGREGATE SHOULDERS, TYPE B	TON	144
50100100	REMOVAL OF EXISTING STRUCTURES	EACH	1
50105220	PIPE CULVERT REMOVAL	FOOT	110
50200100	STRUCTURE EXCAVATION	CU YD	82
50300225	CONCRETE STRUCTURES	CU YD	19.5
50300280	CONCRETE ENCASMENT	CU YD	2.8
50400305	PRECAST PRESTRESSED CONCRETE DECK BEAMS (17" DEPTH)	SQ FT	984
50800205	REINFORCEMENT BARS, EPOXY COATED	POUND	2,880
Δ 50900205	STEEL RAILING, TYPE S1	FOOT	85
51201600	FURNISHING STEEL PILES HP12x53	FOOT	301
51202305	DRIVING PILES	FOOT	301
51203600	TEST PILE STEEL HP12x53	EACH	1
51500100	NAME PLATES	EACH	1
542A0235	PIPE CULVERTS, CLASS A, TYPE 1 30"	FOOT	26
542D0220	PIPE CULVERTS, CLASS D, TYPE 1 15"	FOOT	64
542D0223	PIPE CULVERTS, CLASS D, TYPE 1 18"	FOOT	50
542I3675	PRECAST REINFORCED CONCRETE FLARED END SECTIONS 30"	EACH	2
550B0050	STORM SEWERS, CLASS B, TYPE 1 12"	FOOT	48
Δ 63100075	TRAFFIC BARRIER TERMINAL, TYPE 5A	EACH	2
Δ 63100167	TRAFFIC BARRIER TERMINAL, TYPE 1 (SPECIAL) TANGENT	EACH	2
67100100	MOBILIZATION	LSUM	1
70101830	TRAFFIC CONTROL AND PROTECTION, STANDARD BLR 21	LSUM	1
Δ 78201000	TERMINAL MARKER-DIRECT APPLIED	EACH	2
• X2501000	SEEDING, CLASS 2 (SPECIAL)	ACRE	0.6

• SPECIAL PROVISION
 Δ SPECIALTY ITEMS
 CONSTRUCTION TYPE CODE: 0011
 BRIDGE TYPE CODE: X080

GENERAL NOTES

- WHERE PERMANENT SURVEY MARKERS ARE ENCOUNTERED, THE ENGINEER SHALL BE NOTIFIED BEFORE SUCH MONUMENTS ARE DISTURBED. THE CONTRACTOR SHALL PROTECT AND PRESERVE ALL PROPERTY MARKERS AND MONUMENTS UNTIL THE OWNER AND AN AUTHORIZED SURVEYOR HAS WITNESSED OR OTHERWISE REFERENCED THE LOCATION.
- THE ENGINEER SHALL NOT GUARANTEE THE WORK OF ANY CONTRACTOR OR SUBCONTRACTOR, SHALL HAVE NO SUPERVISION OF THE PERSONS DOING THE WORK, SHALL HAVE NO CHARGE OF THE WORK, SHALL NOT BE RESPONSIBLE FOR SAFETY IN, ON, OR ABOUT THE JOB SITE OR HAVE ANY CONTROL OF THE SAFETY OR ADEQUACY OF ANY EQUIPMENT, BUILDING COMPONENT, SCAFFOLDING, SUPPORT, FORMS OR OTHER WORK AIDS.
- ALL ELEVATIONS ARE BASED ON NAVD 88. THE PROPOSED GRADE ELEVATIONS SHOWN ON THE PLAN AND PROFILE SHEET AND STATION CROSS SECTIONS ARE THE ELEVATIONS FOR THE FINISHED SURFACE AT THE LOCATIONS INDICATED.
- THE FOLLOWING RATES WERE USED IN CALCULATING QUANTITIES FOR THIS PROJECT:
 RIPRAP: 1.5 TONS/CU YD
 AGGREGATE BASE COURSE/AGGREGATE SHOULDERS: 2.05 TONS/CU YD
 BITUMINOUS MATERIALS (PRIME COAT) : 0.375 GALLONS/SQ YD
 BITUMINOUS MATERIALS (COVER & SEAL COAT) : 0.35 GALLONS/SO YD
 COVER COAT & SEAL COAT AGGREGATE : 23 POUNDS/SO YD
- CONTRACTOR SHALL FOLLOW CONSTRUCTION REQUIREMENTS OF SECTION 611 WHEN EXISTING FIELD TILE IS ENCOUNTERED UNLESS DIRECTED OTHERWISE BY ENGINEER. THIS WORK WILL BE PAID FOR IN ACCORDANCE WITH SECTION 109.04 OF THE STANDARD SPECIFICATIONS.
- UTILITIES ARE SHOWN IN ACCORDANCE WITH BEST AVAILABLE INFORMATION AND THEIR TRUE LOCATION IS NOT GUARANTEED TO BE AS SHOWN ON THE PLANS. IT IS THE CONTRACTOR'S RESPONSIBILITY TO DETERMINE THE EXACT LOCATION OF ALL UTILITIES AND CARRY ON HIS WORK OPERATIONS ACCORDINGLY.

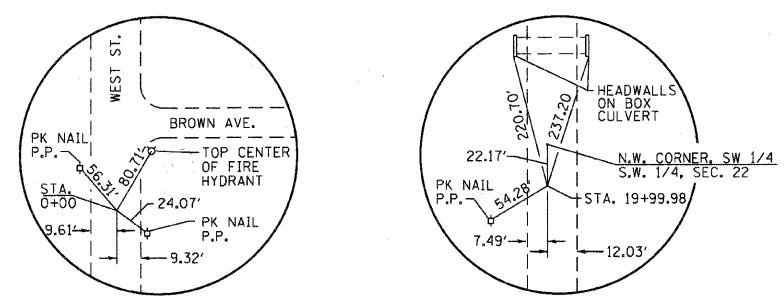

TR 216
CONTROL POINT COORDINATES

POINT #5	N - 11,531.26
	E - 9,984.63
POINT #7	N - 9,531.29
	E - 9,988.69

STA. 0+00.00, 2.41' RT. STA. 19+99.98, 1.65' LT.

EARTH WORK SCHEDULE

LOCATION	1	2	3	4
	20200100 EARTH EXCAVATION (CU. YD.)	EXCAVATION TO BE USED IN EMBANKMENT (ADJUSTED FOR SHRINKAGE) (COL 1 x 0.75) (CU. YD.)	EMBANKMENT (FILL) (CU. YD.)	EARTHWORK BALANCE WASTE (+) AND SHORTAGE (-) (CU. YD.)
TR 216 7+65.00 TO 13+25.00	459	345	479	-134
EARTH EXCAVATION SHRINKAGE FACTOR = 25%				
ITEMS MARKED WITH AN ASTERISK (*) ARE FOR INFORMATIONAL PURPOSES ONLY				

I:\jobs\christiancounty\7166 tr 126 over buckhart creek\cadd\sheet\0607166-sht-gen.dgn

USER NAME = dhaberling	DESIGNED - TJZ	REVISED
PLOT SCALE = 0.1" = 1' IN.	DRAWN - DLH	REVISED
PLOT DATE = 11/14/2011	CHECKED - SDS	REVISED
	DATE - 2/22/11	REVISED

WHKS & CO.
ENGINEERING

7018 KINGSMILL CT.
SPRINGFIELD, IL
(217) 483-9457
DESIGN FIRM #184001036

STATE OF ILLINOIS
DEPARTMENT OF TRANSPORTATION

GENERAL NOTES AND SUMMARY OF QUANTITIES

SCALE: SHEET NO. OF SHEETS STA. TO STA.

T.R. RTE.	SECTION	COUNTY	TOTAL SHEETS	SHEET NO.
216	08-16112-00-BR	CHRISTIAN	26	2
FED. ROAD DIST. NO. ILLINOIS FED. AID PROJECT			CONTRACT NO. 9359	