

F.A.S. RTE.	SECTION	COUNTY	TOTAL SHEETS	SHEET NO.
733	06-00088-00-BR	MACOUPIN	35	13
FED. ROAD DIST. NO.		ILLINOIS FED. AID PROJECT		
		CONTRACT NO.		

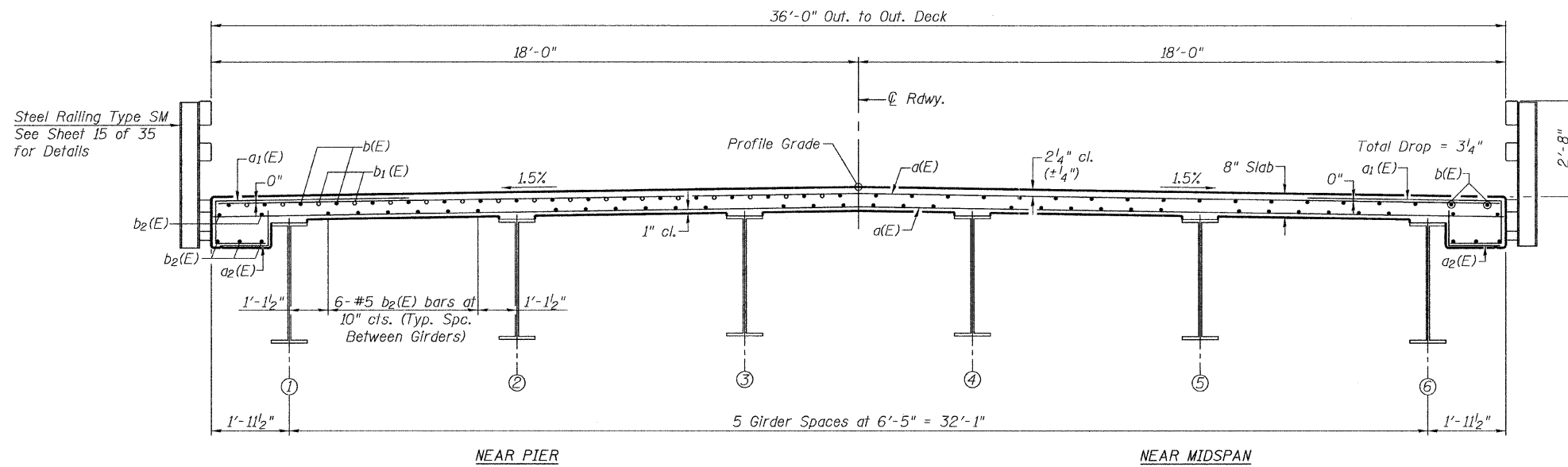
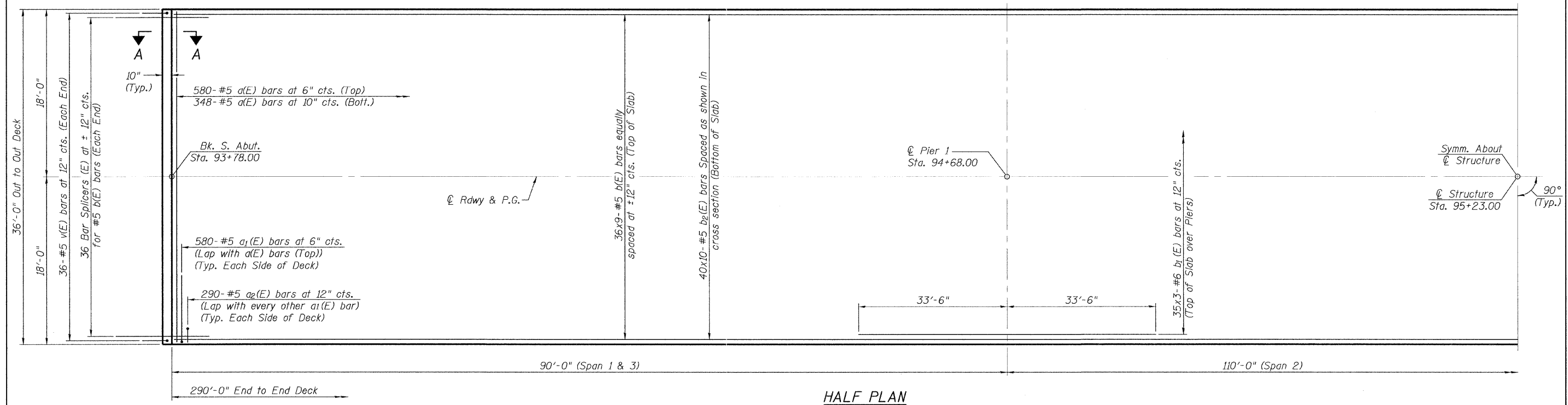
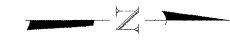

MIN. BAR LAP

#5 bar = 1'-8"
#6 bar = 2'-7"

**SUPERSTRUCTURE
BILL OF MATERIAL**

Bar	No.	Size	Length	Shape
a(E)	928	#5	35'-8"	—
a1(E)	1160	#5	6'-3"	—
a2(E)	580	#5	2'-1"	—
b(E)	324	#5	34'-0"	—
b1(E)	210	#6	25'-0"	—
b2(E)	400	#5	30'-8"	—
m(E)	10	#6	35'-8"	—
mi(E)	24	#6	9'-2"	—
m2(E)	10	#6	6'-0"	—
ms(E)	4	#6	1'-7"	—
s(E)	82	#5	5'-11"	—
si(E)	72	#4	11'-0"	□
v(E)	72	#5	3'-4"	—
Reinforcement Bar, Epoxy Coated		Pound	77770	
Concrete Superstructure		Cu. Yd.	313.2	
Bar Splicers		Each	72	

Note: Reinforcement in the top of the deck may be placed with a 1/2" min. clearance in the area of the rail post anchor devices. The studs of the anchor devices shall be placed below the top reinforcement bars and outermost longitudinal reinforcement bar shall be placed directly above the studs of the rail post anchor device.

See Sheet 14 of 35 for Superstructure details & Section A-A. For details of a1(E), a2(E) and v(E) bars see sheet 14 of 35. Bars indicated thus 36x9- #5 etc. indicates 36 lines of bars with 9 lengths per line.