

**HOT-MIX ASPHALT BASE COURSE WIDENING 10"**

LT 1270+30 TO 1273+00 75.0 SQ YD  
 RT 1270+30 TO 1273+00 75.0 SQ YD  
 TOTAL = 150.0 SQ YD

**TEMPORARY BRIDGE TRAFFIC SIGNALS**

SN 040-8645 1.0 EACH  
 TOTAL = 1.0 EACH

**TRAFFIC CONTROL AND PROTECTION,  
 STANDARD 701321 (SPECIAL)**

SN 040-8645 0.5 EACH  
 TOTAL = 0.5 EACH

F.A.P. RTE.	SECTION	COUNTY	TOTAL SHEETS	SHEET NO.
95		JASPER	546	273D
STA. 1268+00		TO STA. 1274+00		
FED. ROAD DIST. NO.		ILLINOIS	FED. AID PROJECT	
• (5,6)Y,RS-2,6BR-7				



**TEMPORARY CONCRETE BARRIER**

1270+09 TO 1273+21 312.5 FOOT  
 TOTAL = 312.5 FOOT

**PIPE CULVERTS (TEMPORARY),  
 CLASS D, TYPE 1, 18"**

1272+25 TO 1273+10 85.0 FOOT  
 TOTAL = 85.0 FOOT

**CLASS D PATCHES, TYPE IV, 14 INCH**

1271+40 TO 1271+90 86.1 SQ YD  
 TOTAL = 86.1 SQ YD

**IMPACT ATTENUATORS, TEMPORARY  
 (NON-REDIRECTIVE), TEST LEVEL 2**

1270+09 1.0 EACH  
 1273+21 1.0 EACH  
 TOTAL = 2.0 EACH

**METAL END SECTIONS 18"**

1272+25 1.0 EACH  
 1273+10 1.0 EACH  
 TOTAL = 2.0 EACH

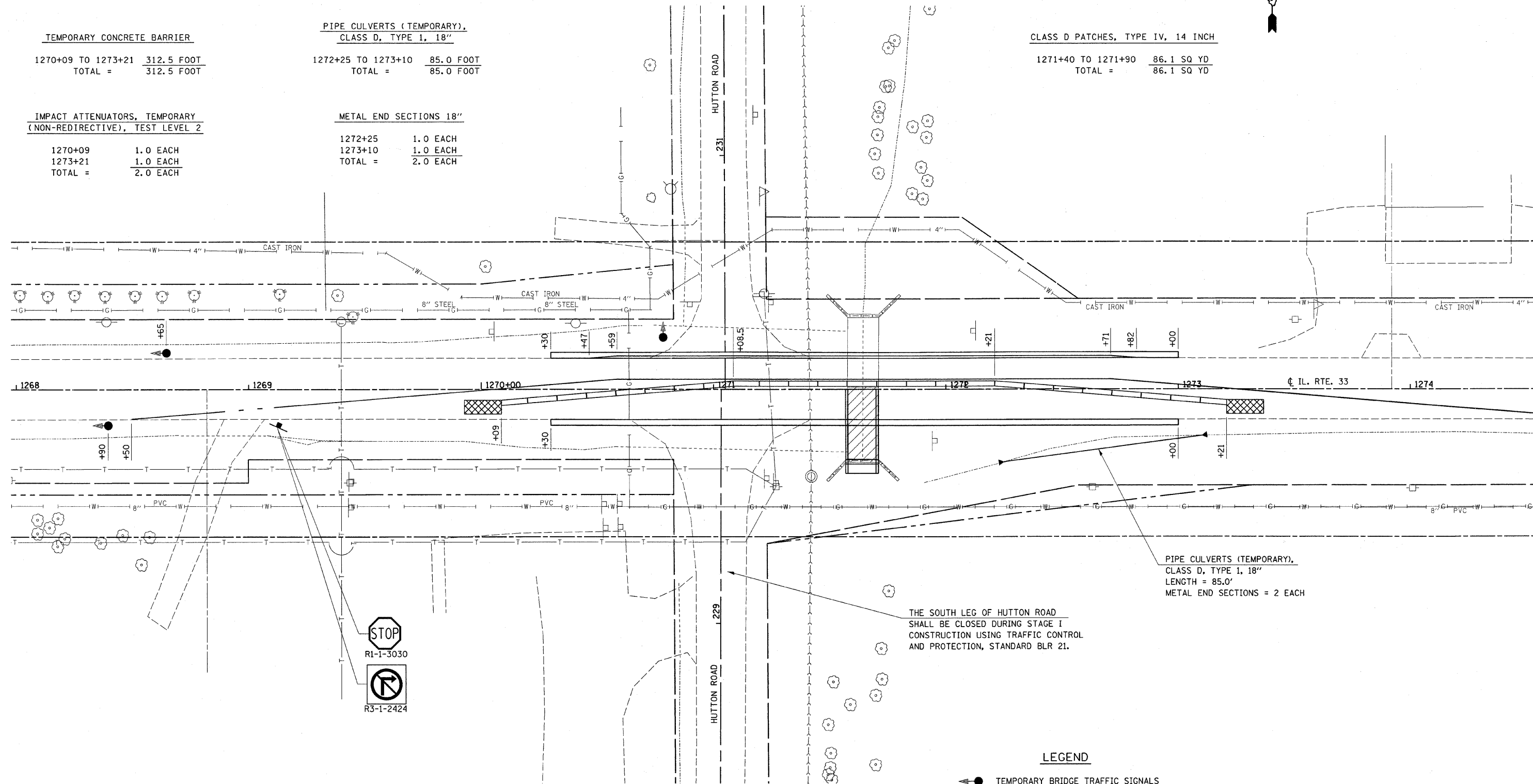

PIPE CULVERTS (TEMPORARY),  
 CLASS D, TYPE 1, 18"  
 LENGTH = 85.0'  
 METAL END SECTIONS = 2 EACH

THE SOUTH LEG OF HUTTON ROAD  
 SHALL BE CLOSED DURING STAGE I  
 CONSTRUCTION USING TRAFFIC CONTROL  
 AND PROTECTION, STANDARD BLR 21.

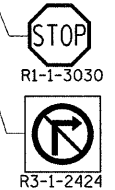

**LEGEND**

- TEMPORARY BRIDGE TRAFFIC SIGNALS
- IMPACT ATTENUATORS, TEMPORARY (NON-REDIRECTIVE) TEST LEVEL 2
- TEMPORARY CONCRETE BARRIER
- STOP BAR
- REMOVAL OF EXISTING STRUCTURE NO. 22

REVISIONS	
NAME	DATE

ILLINOIS DEPARTMENT OF TRANSPORTATION  
**STAGE I**  
**S. N. 040-8645**  
 SCALE: VERT. \_\_\_\_\_  
 HORIZ. 20  
 DATE 02-07-12  
 DRAWN BY RWS  
 CHECKED BY \_\_\_\_\_

▲ SHEET ADDED 2/22/12

PLOT DATE = 2/16/2012  
 FILE NAME = c:\p\work\pudot\work\tr\adms\1514\0794437-ahc-staging.dgn  
 PLOT SCALE = 28.00000 / in.  
 USER NAME = mactey