



LEGEND

-  WORK ZONE (STAGE AS SPECIFIED)
-  TEMPORARY PAVEMENT
-  COMPLETED TEMPORARY PAVEMENT
-  TEMPORARY RAMP
-  COMPLETED TEMPORARY RAMP
-  COMPLETED PAVEMENT

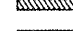
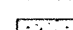
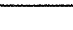
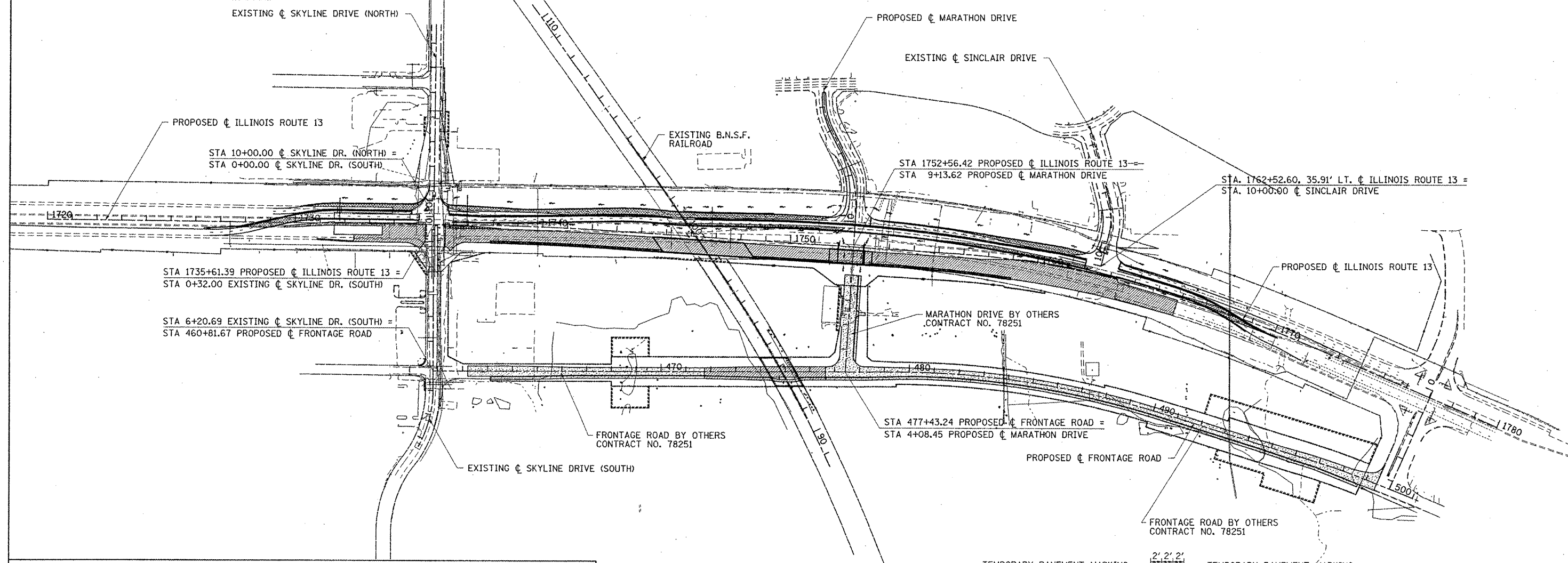
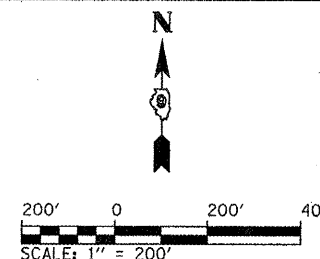

**STAGE 1B
ILLINOIS RTE. 13**

- NOTES:
1. ADDITIONAL TRAFFIC CONTROL DEVICES MAY BE NECESSARY AS DIRECTED BY THE ENGINEER.
 2. TRAFFIC CONTROL FOR THIS WORK SHALL BE PAID FOR AS TRAFFIC CONTROL AND PROTECTION, (SPECIAL), LUMP SUM.
 3. PLACE TEMPORARY TRAFFIC BARRIER, IMPACT ATTENUATORS AND TRAFFIC CONTROL DEVICES AS SHOWN FOR STAGE 1B.
 4. ILLINOIS ROUTE 13 EB AND WB TRAFFIC TO USE EXISTING WB LANES AND TEMPORARY PAVEMENT.
 5. BEGIN CONSTRUCTION OF THE ILLINOIS ROUTE 13 EB DRAINAGE, EMBANKMENT, PAVEMENT, MSE WALLS, BRIDGES AND ASSOCIATED IMPROVEMENTS IN THE WORK ZONES SHOWN.
 6. BEGIN CONSTRUCTION OF THE FRONTAGE ROAD IMPROVEMENTS FROM STA. 471+74.29 TO STA. 476+65.
 7. EXISTING PAVEMENT MARKINGS SHALL BE REMOVED AND APPROPRIATE TEMPORARY PAVEMENT MARKINGS SHALL BE INSTALLED AS SHOWN ON THE MOT SHEETS.
 8. THE CONTRACTOR WILL BE ALLOWED TO USE THE EXISTING EB LANE RAILROAD CROSSING FOR CONSTRUCTION ACCESS DURING THIS STAGE. A RAILROAD FLAGGER WILL BE REQUIRED.
 9. A 2' WIDE 2" THICK STRIP OF HOT-MIX ASPHALT BINDER COURSE, IL-19.0, N90 PAVEMENT SHALL BE PLACED ON THE MEDIAN SIDE OF THE EB LANES PRIOR TO SWITCHING TO STAGE 2 TO SERVE AS THE PAD TO PLACE AND PIN THE TEMPORARY CONCRETE BARRIER. THE LIMITS OF THE TEMPORARY PAVEMENT STRIP INCLUDES ALL LOCATIONS WHERE THE TEMPORARY CONCRETE BARRIER AND ATTENUATORS ARE OUTSIDE THE LIMITS OF THE PROPOSED PAVEMENT AND SHOULDERS.

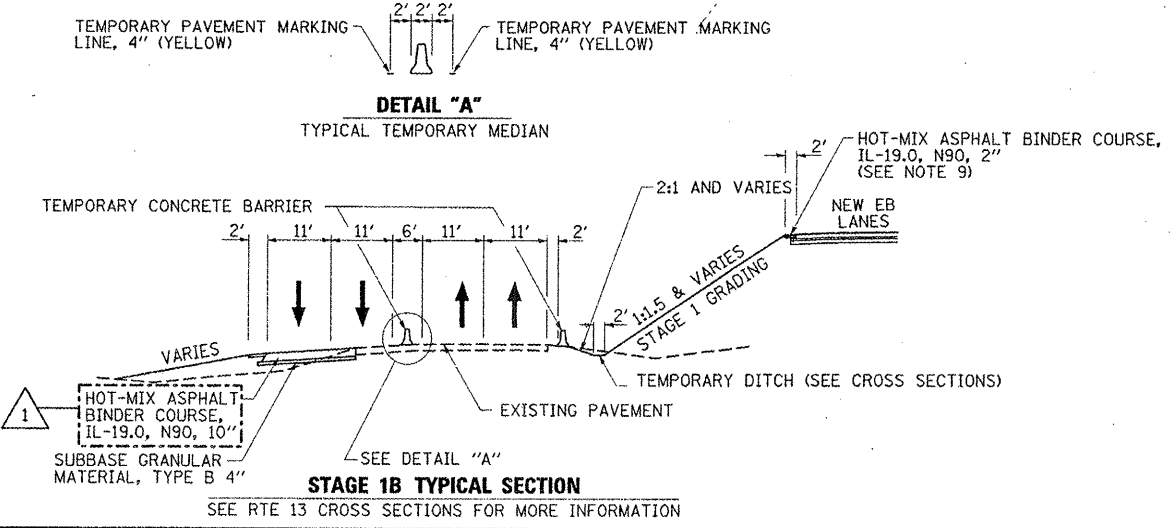

REVISION
 **REVISED 2/24/12**

FILE NAME =	USER NAME = OpenH&B Springfield	DESIGNED - KPF	REVISED - 2/21/2012 BMB
Plot Scale = 250.0000 "/>	Plot Date = 2/23/2012	CHECKED - SPH	REVISI

**STATE OF ILLINOIS
DEPARTMENT OF TRANSPORTATION**

**STAGE 1B CONSTRUCTION
OVERALL TRAFFIC CONTROL PLAN**

SCALE: 1" = 200' SHEET NO. OF SHEETS STA. 1720+00.00 TO STA. 1780+00.00

F.A. RTE.	SECTION	COUNTY	TOTAL SHEETS	SHEET NO.
331	(1X-1) VB-1, B-1, N-4, R-3	WILLIAMSON	367	71
			CONTRACT NO. 98859	
ILLINOIS FED. AID PROJECT				