

BARS s24(E), s25(E) & s27(E)

Bar	A
s24(E)	2'-6 1/2"
s25(E)	2'-2"
s27(E)	2'-11 1/4"

BARS s23(E), s26(E) & s3(E)

Bar	B	C
s23(E)	3'-5"	2'-7"
s26(E)	5'-8"	5'-0"
s3(E)	3'-7 1/4"	2'-7"

BILL OF MATERIAL

Bar	No.	Size	Length	Shape
h20(E)	24	#5	25'-9"	
h21(E)	48	#6	22'-8"	
h22(E)	32	#8	31'-9"	
p21(E)	16	#8	20'-9"	
p22(E)	8	#7	33'-2"	
p23(E)	16	#7	24'-0"	
p24(E)	4	#5	12'-7"	
p27(E)	4	#5	11'-5"	
s23(E)	70	#5	12'-11"	
s24(E)	32	#5	7'-8"	
s25(E)	12	#5	6'-11"	
s26(E)	61	#5	22'-3"	
s27(E)	44	#5	8'-6"	
s3(E)	54	#5	13'-4"	
sp(E)	5	#5	47'-9"	
sp1(E)	5	#5	23'-11"	
u20(E)	6	#5	11'-10"	
u21(E)	10	#5	15'-4"	
v20(E)	50	#11	24'-0"	
v21(E)	50	#11	25'-7"	
v24(E)	100	#11	27'-7"	
v26(E)	50	#11	21'-0"	
v27(E)	50	#11	28'-7"	

Structure Excavation	Cu. Yd.	48.0
Concrete Structures	Cu. Yd.	317.1
Reinforcement Bars, Epoxy Coated	Pound	53,410
Mechanical Splicers	Each	100
Drilled Shaft in Soil	Cu. Yd.	149.1
Drilled Shaft in Rock	Cu. Yd.	14.7

MINIMUM BAR LAP

- #5(E) Bar = 3'-3"
- #6(E) Bar = 3'-10"
- #7(E) Bar = 5'-2"
- #8(E) Bar = 6'-9"

Cast steps monolithically with cap. Space cap reinforcement to miss anchor bolts. ** Length is height of spiral.

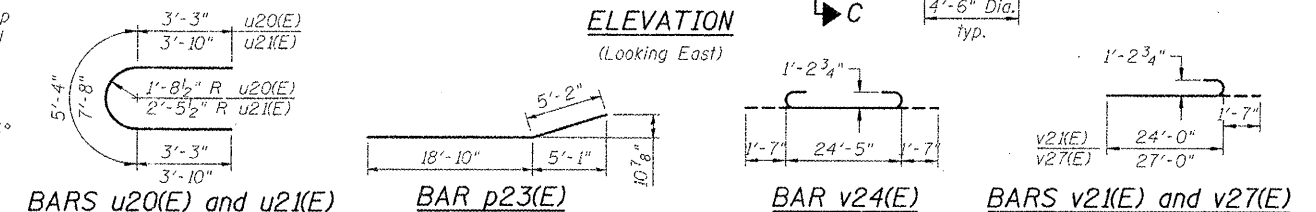

SECTION C-C

* The quantities and reinforcement detailing are based on the top of shaft and the estimated top of rock elevations shown and may change based on the actual top of rock encountered at each shaft and the final top of shaft elevation.

** Allowable substitution: Provide 1/2 extra turns top and bottom with 135° standard hook into core at ends of spiral.

*** Splicing of reinforcement will not be allowed in this region.

CMT
CRAWFORD MURPHY & TILLY, INC.
CONSULTING ENGINEERS
SPRINGFIELD, IL ■ ALTOONA, IL ■ ST. LOUIS, MO
ROCKFORD, IL ■ PEORIA, IL ■ CHICAGO, IL

USER NAME = Gary Davis	DESIGNED - MCC	REVISED -	REVISED -
	CHECKED - ATI	REVISED -	REVISED -
PLOT SCALE =	DRAWN - GLD	REVISED -	REVISED -
PLOT DATE = 1/31/2012	CHECKED - ATI	REVISED -	REVISED -

STATE OF ILLINOIS
DEPARTMENT OF TRANSPORTATION

PIER 1 DETAILS
STRUCTURE NO. 100-0094 (E.B.)

F.A.P. RTE.	SECTION	COUNTY	TOTAL SHEETS	SHEET NO.
331	(1X-1)VB-1	WILLIAMSON	367	198
			CONTRACT NO.	98859
ILLINOIS FED. AID PROJECT				

FILE NAME = I:\victoria\98859\3d\100-0094\structure\pier1\plan\pier1_s_bridg.dgn