

ILLINOIS CENTRE MALL

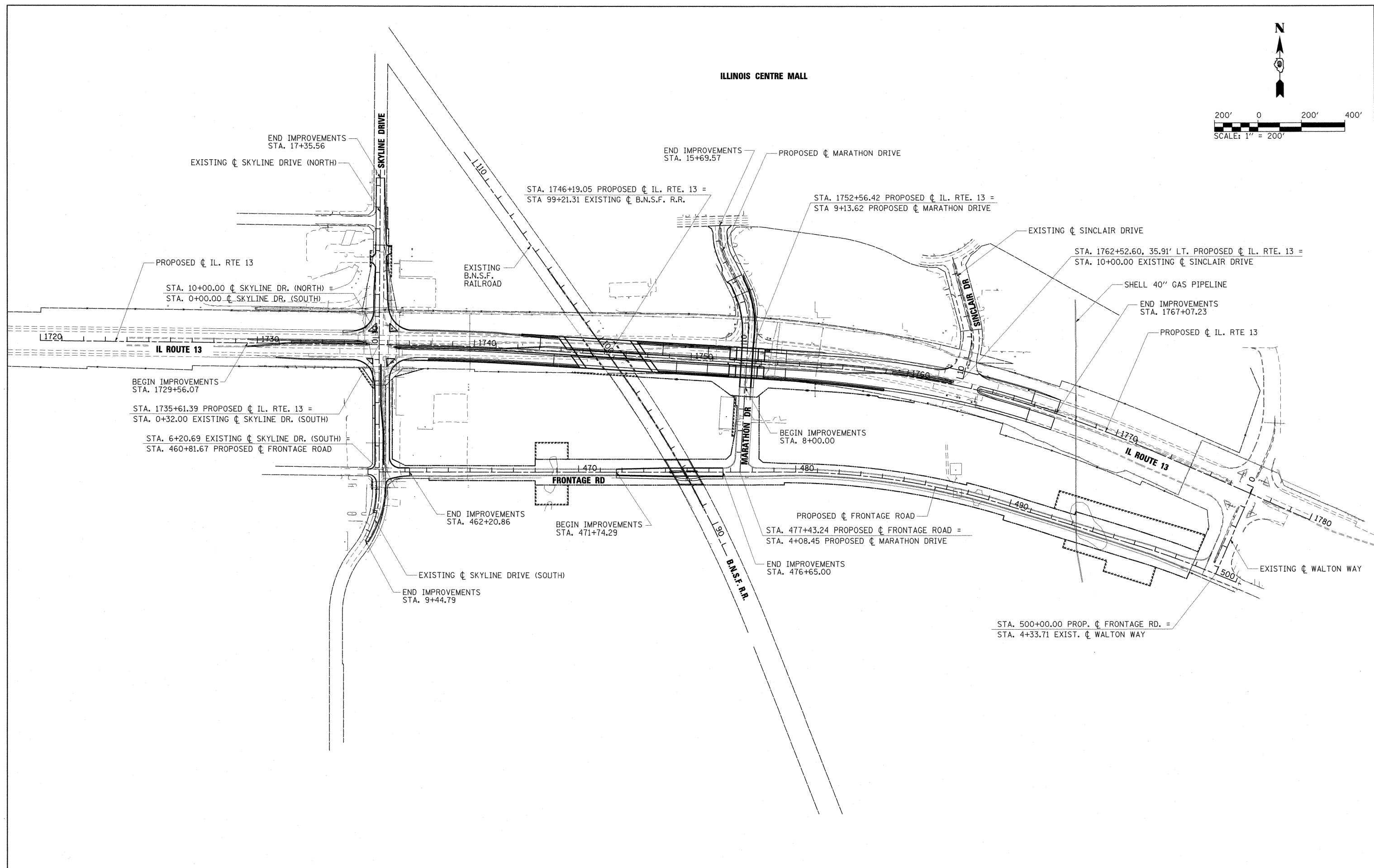

FILE NAME = I:\dot\0986603\draw\cadd\sheet\099885	USER NAME = OpenH&B Springfield	DESIGNED - BMB	REVISED -	STATE OF ILLINOIS DEPARTMENT OF TRANSPORTATION	SITE PLAN ILLINOIS ROUTE 13			F.A. RTE.	SECTION	COUNTY	TOTAL SHEETS	SHEET NO.
	331	(1X-1) VB-1, B-1, N-4, R-3	WILLIAMSON		367	50						
PLOT SCALE = 200.0000' / IN.	CHECKED - SPH	REVISED -	CONTRACT NO. 98859									
PLOT DATE = 12/14/2011	DATE - 12/9/11	REVISED -	ILLINOIS FED. AID PROJECT									