







LEGEND

-  WORK ZONE (STAGE AS SPECIFIED)
-  TEMPORARY PAVEMENT
-  COMPLETED TEMPORARY PAVEMENT
-  TEMPORARY RAMP
-  COMPLETED TEMPORARY RAMP
-  COMPLETED PAVEMENT

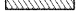

**STAGE 3
ILLINOIS RTE. 13**

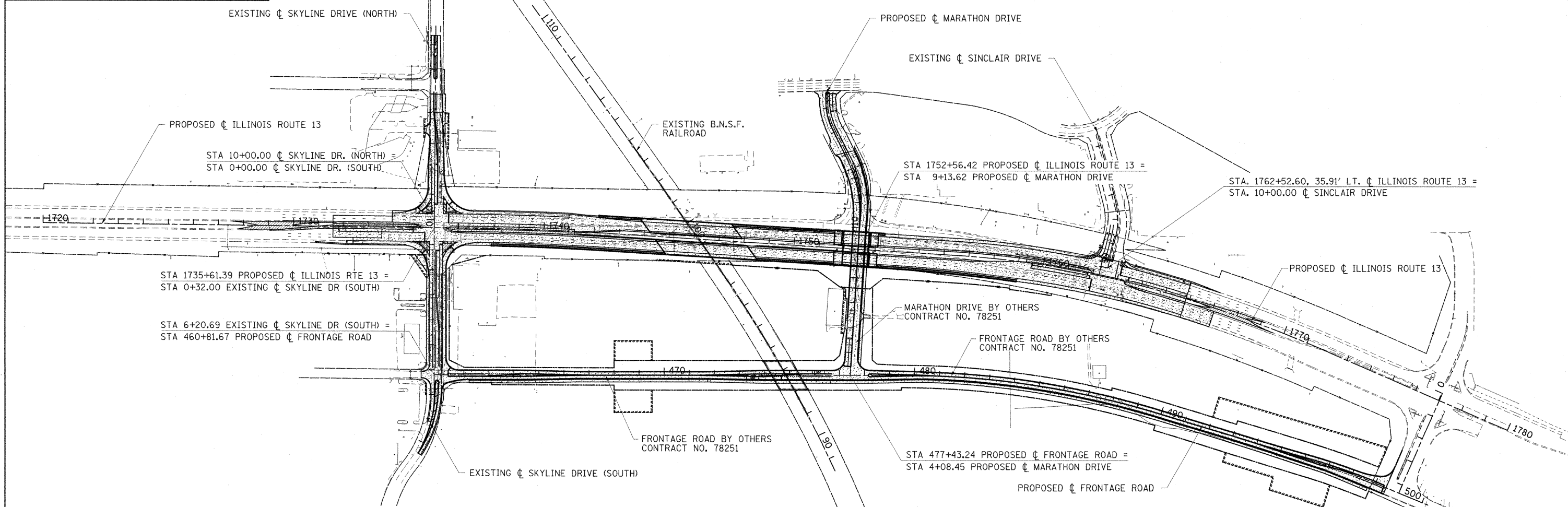
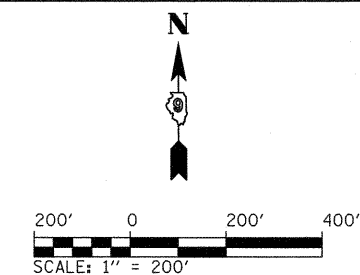
- NOTES:
1. ADDITIONAL TRAFFIC CONTROL DEVICES MAY BE NECESSARY AS DIRECTED BY THE ENGINEER.
 2. TRAFFIC CONTROL FOR THIS WORK SHALL BE PAID FOR AS TRAFFIC CONTROL AND PROTECTION, (SPECIAL), LUMP SUM.
 3. INSTALL PROPOSED PERMANENT PAVEMENT MARKINGS AND HIGHWAY SIGNS ON IL ROUTE 13 AND SIDE ROADS.
 4. UTILIZE THE PROPOSED TRAFFIC SIGNALS AT THE INTERSECTION OF SINCLAIR DRIVE AND IL ROUTE 13 AND REMOVE THE TEMPORARY SIGNALS.
 5. AT THE INTERSECTION OF SKYLINE DRIVE AND IL ROUTE 13 UTILIZE TEMPORARY SIGNALS DURING THE COMPLETION OF THE INSTALLATION OF THE PROPOSED TRAFFIC SIGNALS AND CONSTRUCTION OF THE ISLANDS ON THE NW, SW, AND SE CORNERS. INITIATE THE USE OF THE PROPOSED TRAFFIC SIGNALS AND REMOVE THE TEMPORARY SIGNALS.
 6. CONSTRUCT THE RAISED MEDIAN ON SKYLINE DRIVE SOUTH FROM STA. 1+21.92 TO STA. 5+86.29. CONSTRUCT THE REMAINING DRAINAGE ITEMS, CURB AND GUTTERS, AND MEDIANS ON IL ROUTE 13 FROM STA. 1731+57.13 TO STA. 1734+94.93, STA. 1736+28.25 TO STA. 1741+22.21, AND STA. 1759+30.35 TO STA. 1761+95.12.
 7. CONSTRUCT THE REMAINING PROPOSED WB IL ROUTE 13 LEFT TURN LANE AT SKYLINE DRIVE.
 8. REMOVE THE ATTENUATORS AND TEMPORARY TRAFFIC BARRIER AND INSTALL THE PROPOSED GUARDRAIL STABILIZATION AND THE PROPOSED GUARDRAIL ON THE MEDIAN SIDE OF EB IL ROUTE 13.
 9. REMOVE ALL REMAINING TEMPORARY PAVEMENTS AS SHOWN.
 10. COMPLETE FINAL GRADING, CLEANUP, SEEDING AND MULCHING.
 11. WORK THIS STAGE SHALL BE COMPLETED UTILIZING TEMPORARY OFF-PEAK LANE CLOSURES.

FILE NAME =	USER NAME = OpenH&B Springfield	DESIGNED - KPF	REVISED -
I:\dot\0906603\draw\CADD_Sheets\D998859	3-sh1-mot-stage3-1.dgn	DRAWN - TAP	REVISED -
	PLOT SCALE = 200.0000' / IN.	CHECKED - SPH	REVISED -
	PLOT DATE = 12/14/2011	DATE - 12/9/11	REVISED -

**STATE OF ILLINOIS
DEPARTMENT OF TRANSPORTATION**

**STAGE 3 CONSTRUCTION
OVERALL TRAFFIC CONTROL PLAN**

SCALE: 1" = 200' SHEET NO. OF SHEETS STA. 1720+00.00 TO STA. 1780+00.00

F.A. RTE.	SECTION	COUNTY	TOTAL SHEETS	SHEET NO.
331	(1X-1) VB-1, B-1, N-4, R-3	WILLIAMSON	367	94
CONTRACT NO. 98859				
ILLINOIS FED. AID PROJECT				