

**DETOUR-STAGE 1E**  
SKYLINE DRIVE SOUTH

NOTES:  
SIGNS SHOWN ARE IN ADDITION TO SPECIFIED TRAFFIC CONTROL STANDARDS AND SIGNS SHOWN IN MAINTENANCE OF TRAFFIC STAGING PLANS EXCEPT THE BARRICADES AND ROAD CLOSED SIGNS SHALL BE AS SHOWN ON THE MAINTENANCE OF TRAFFIC STAGING PLANS.

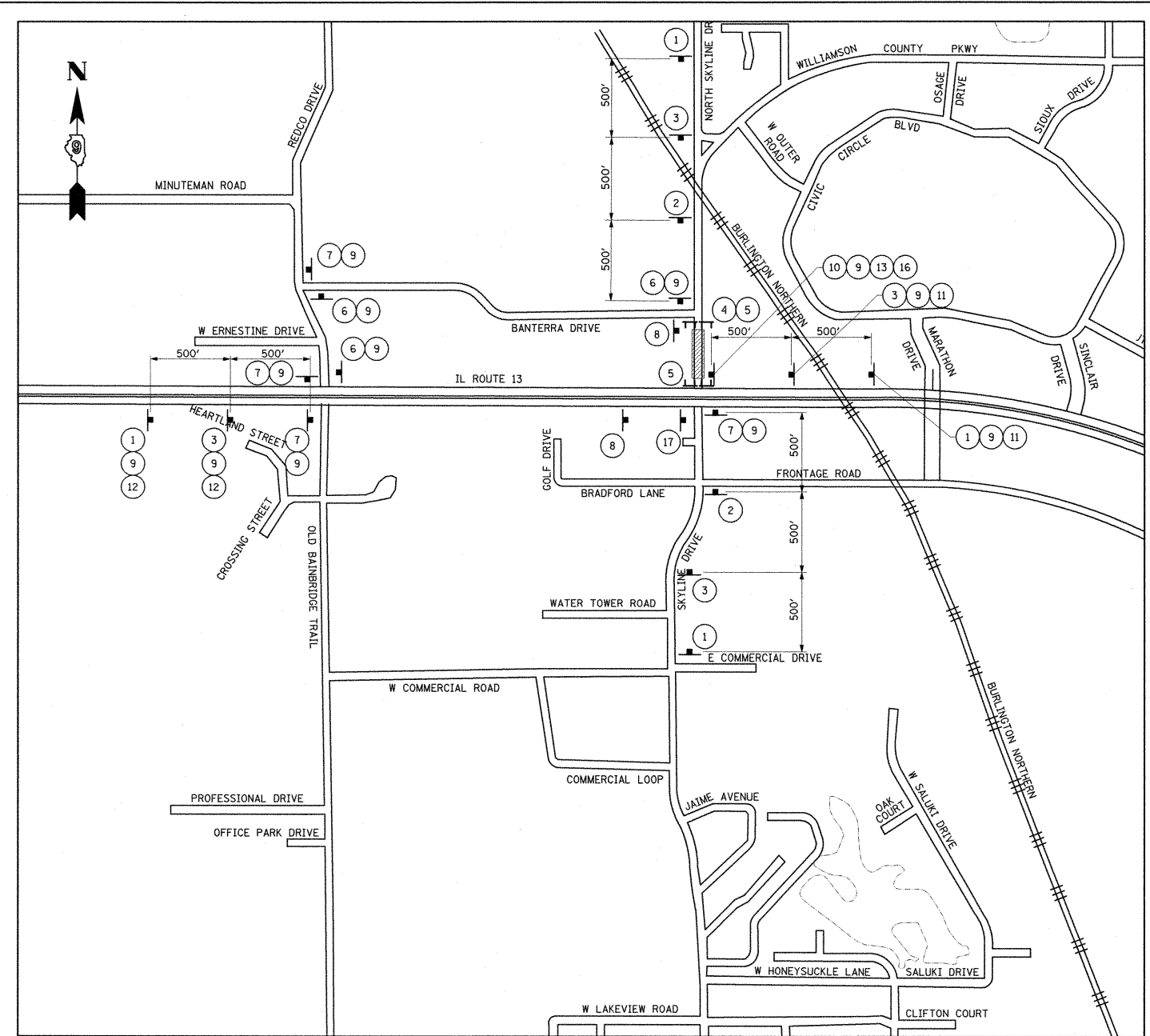

**DETOUR-STAGE 2E**  
SKYLINE DRIVE NORTH

NOTES:  
SIGNS SHOWN ARE IN ADDITION TO SPECIFIED TRAFFIC CONTROL STANDARDS AND SIGNS SHOWN IN MAINTENANCE OF TRAFFIC STAGING PLANS EXCEPT THE BARRICADES AND ROAD CLOSED SIGNS SHALL BE AS SHOWN ON THE MAINTENANCE OF TRAFFIC STAGING PLANS.

CLOSURE SHALL BE LIMITED TO 14 CALENDAR DAYS.

