

CLOSURE-STAGE 2A THROUGH 2F
MARATHON DRIVE

NOTES:
SIGNS SHOWN ARE IN ADDITION TO SPECIFIED TRAFFIC CONTROL STANDARDS AND SIGNS SHOWN IN MAINTENANCE OF TRAFFIC STAGING PLANS EXCEPT THE BARRICADES AND ROAD CLOSED SIGNS SHALL BE AS SHOWN ON THE MAINTENANCE OF TRAFFIC STAGING PLANS.

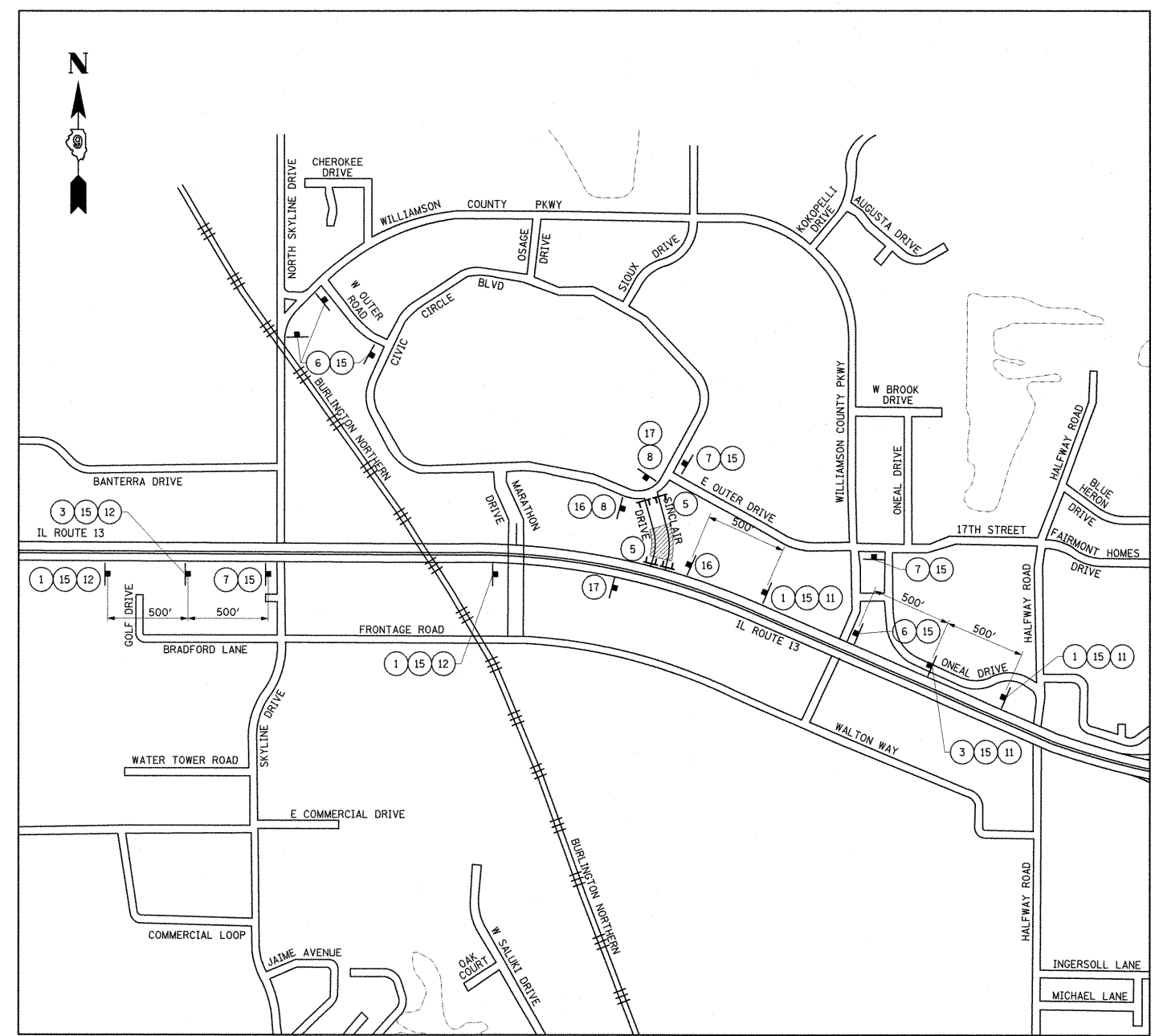

DETOUR-STAGE 2G
SINCLAIR DRIVE

NOTES:
SIGNS SHOWN ARE IN ADDITION TO SPECIFIED TRAFFIC CONTROL STANDARDS AND SIGNS SHOWN IN MAINTENANCE OF TRAFFIC STAGING PLANS EXCEPT SINCLAIR DRIVE BARRICADES AND ROAD CLOSED SIGNS SHALL BE AS SHOWN ON THE MAINTENANCE OF TRAFFIC STAGING PLANS.

CLOSURE SHALL BE LIMITED TO 10 CALENDAR DAYS.
MARATHON DRIVE AND SKYLINE DRIVE SHALL BE OPEN DURING THE SINCLAIR DRIVE CLOSURE.

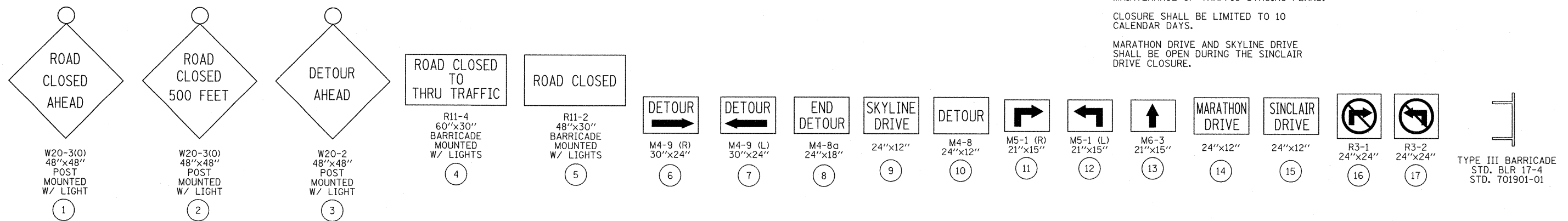

FILE NAME =	USER NAME = OpenH&B Springfield	DESIGNED - KPF	REVISED -	STATE OF ILLINOIS DEPARTMENT OF TRANSPORTATION	MAINTENANCE OF TRAFFIC MARATHON DRIVE CLOSURE AND SINCLAIR DRIVE DETOUR	F.A. RTE.	SECTION	COUNTY	TOTAL SHEETS	SHEET NO.	
1:\dot\0986603\draw\CADD_Sheets\099885	shht-Detour@02.dgn	DRAWN - TAP	REVISED -			331	(1X-1) VB-1, B-1, N-4, R-3	WILLIAMSON	367	102	
	PLOT SCALE = 200.0000' / IN.	CHECKED - SPH	REVISED -			CONTRACT NO. 98859					
	PLOT DATE = 12/14/2011	DATE - 12/9/11	REVISED -			ILLINOIS FED. AID PROJECT					