

DATE _____
 BY _____
 SURVEYED _____
 ORIGINAL SURVEY _____
 NOTE BOOK _____
 NO. _____

DATE _____
 BY _____
 SURVEYED _____
 ORIGINAL SURVEY _____
 NOTE BOOK _____
 NO. _____

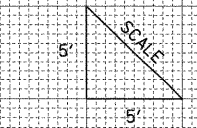
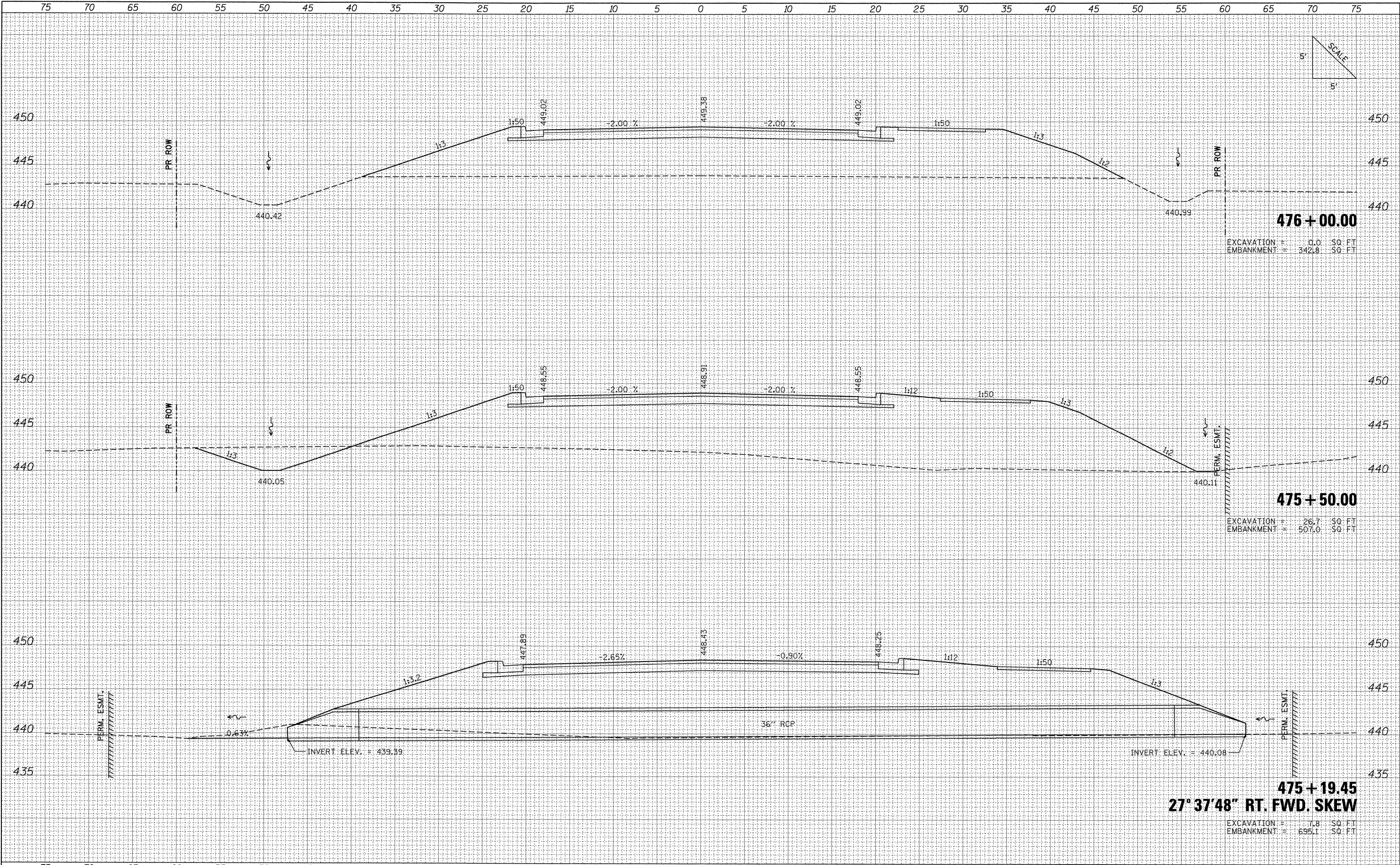

476 + 00.00
 EXCAVATION = 0.0 SQ. FT.
 EMBANKMENT = 342.8 SQ. FT.

475 + 50.00
 EXCAVATION = 26.7 SQ. FT.
 EMBANKMENT = 507.0 SQ. FT.

475 + 19.45
27° 37' 48" RT. FWD. SKEW
 EXCAVATION = 7.8 SQ. FT.
 EMBANKMENT = 695.1 SQ. FT.

FILE NAME =
 I:\dot\906603\draw\cadd\sheets\0998859-sht-x\Frontage.dgn

USER NAME = Matt Overbey
 PLOT SCALE = 5.0000' / IN.
 PLOT DATE = 12/13/2011

DESIGNED - BMB
 DRAWN - RAH
 CHECKED - SPH
 DATE - 12/9/11

REVISED -
 REVISED -
 REVISED -
 REVISED -

**STATE OF ILLINOIS
 DEPARTMENT OF TRANSPORTATION**

**PROPOSED CROSS SECTIONS
 FRONTAGE ROAD**

SCALE: SHEET NO. OF SHEETS STA. 475+19.45 TO STA. 476+00.00

F.A. RTE.	SECTION	COUNTY	TOTAL SHEETS	SHEET NO.
331	(1X-1) VB-1, B-1, N-4, R-1	WILLIAMSON	367	337
				CONTRACT NO. 98859
ILLINOIS FED. AID PROJECT				